

## Bow components

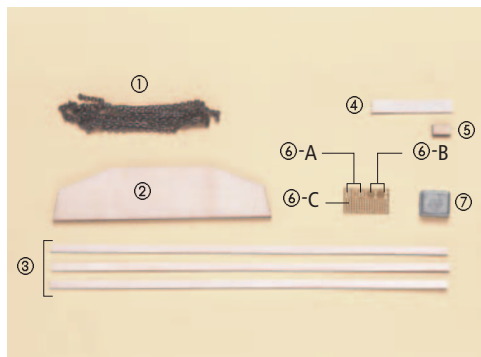

- ① Chain
- ② Wooden board to adjust the gap in the deck
- ③ Wooden plank x 3
- ④ Wooden slat
- ⑤ Piece of wood
- ⑥ Board etched with acid
- ⑦ Metal block

### Recommended tools and materials

- Fast-drying glue
- Wood glue
- Metal file
- Sandpaper (grain nos. 400 and 800)
- Putty
- Wooden spatula
- Craft knife
- Double-sided adhesive tape
- Tracing paper
- Pencil
- Pliers
- Paintbrush
- Paint primer
- Metal primer
- Spray paint (battleship grey)
- Watercolour (battleship grey, matt black)

### HAWSE PIPE

**1** Smooth piece **7** with the metal file to eliminate irregularities in shape, then smooth again with sandpaper grain no. 800.



**4** Fix the two pieces **6B** on the surface of piece **6C**, as shown in the photo. Apply fast-drying glue, using the tip of the craft knife, taking care not to spread it over the other parts of the pieces.

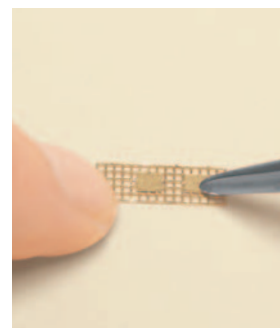

**2** If there are holes or hollows on the surface of piece **7**, correct them by applying putty with a wooden spatula. Push the putty to the bottom of the cavity and, when dry, smooth with sandpaper grain no. 800.

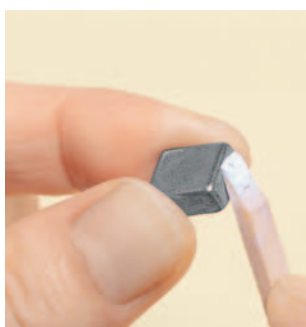

**5** Cut piece **6C** along the edges of the pieces **6B** by running the craft knife along the edges several times. You have now made the grilles of the air intake. Make another.

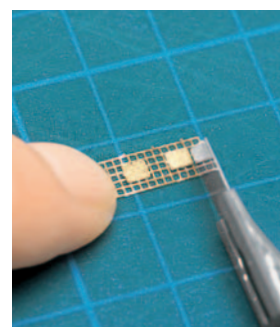

**3** Separate pieces **6** by running the craft knife along the joins until they separate. Smooth the edges of the pieces with the metal file.

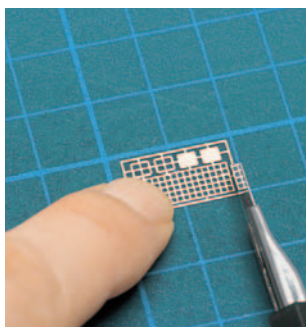

**6** Spray paint primer on piece **5**, evenly and from a distance of about 30cm. The operation will be simpler if you secure the piece to a base with double-sided adhesive tape, as shown in the photo. When thoroughly dry, smooth the piece with sandpaper grain no. 400.



💡 When using paint primer, ventilate the room well and follow the instructions on the packaging.

**7** Spray metal primer evenly on the grilles of the air intake – piece **6A** and piece **7** – from a distance of about 30cm. The operation will be simpler if you secure the pieces to a base with double-sided adhesive tape.



⚠ **When using metal primer, ventilate the room well and follow the instructions on the packaging.**

**8** When the metal primer is dry, give pieces **6A**, **7** and **5** a light and even coat of battleship grey. Allow to dry and repeat the operation from different angles, allowing the paint to dry between each coat.



⚠ **When using spray paint, ventilate the room well and follow the instructions on the packaging.**

**9** Fix the grilles of the air intake to a wooden plank with double-sided adhesive tape. Paint the pieces with a mixture of one part matt black watercolour with two parts battleship grey watercolour.

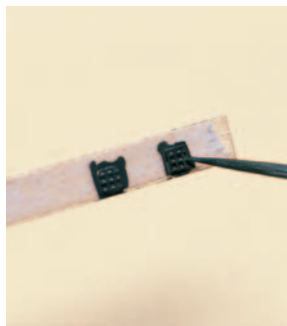

**10** Place the grilles of the air intake with the mesh facing upwards, and fix to piece **6A** with fast-drying glue. You have now made the air intakes. When the glue is dry, paint the sides of the pieces with battleship grey watercolour.



**11** Apply thinned paint to one of the pieces **3** and piece **4**, only on three sides (one flat side and two edges). Follow the instructions on page 122 of Despatch 11 ('How to paint the deck'). Do not paint the other pieces **3**.



**12** Place piece **7** as shown in the photo (right). Cut piece **4** to a length of 7mm and fit to piece **7** with fast-drying glue. The upper edge of piece **4** should be 1mm from the edge of piece **7** (Figure A).

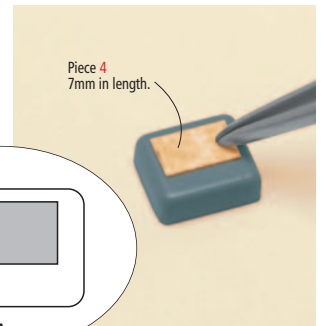
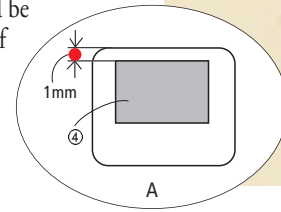

**13** Take the piece so far assembled, as shown in the photo (right, above). With fast-drying glue, fix an air intake in the bottom right corner, 0.5mm away from both the right-hand side and the bottom edge of piece **7**. Fix the other air intake on the opposite side, as shown in the photo (right, below).

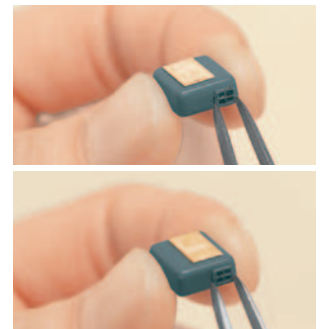

**14** Steps 14 to 19 are relevant only if the gap between the deck fixed in Despatch 17, Step 61, and the foredeck is greater than 2mm. Place piece **2** as shown in the photo, draw a line through the centre and fix a 1cm-long segment of piece **3**, so that it extends past the edge of the piece by 0.5mm.

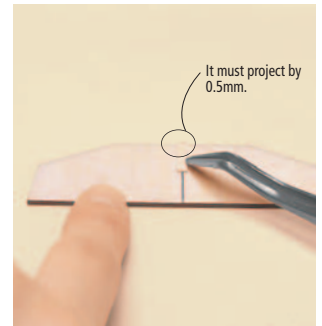

**15** Using wood glue, continue to fix 1cm sections of piece **3** to the upper edge of piece **2**, aligning them with planks of the deck. Allow the glue to dry, then remove any excess on pieces **3** with the craft knife.

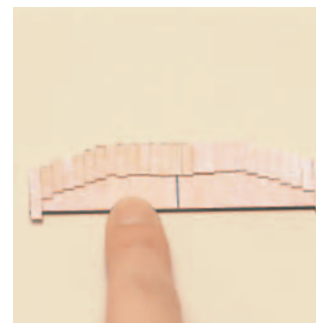

**16** As in Step 11, paint the pieces **3**, matching the colour to the deck. Trace the shape of the gap you wish to fill onto a piece of tracing paper and cut it out.

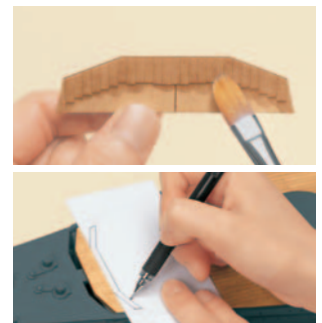

**17** Position the tracing paper cut out on the part assembled in Step 16 and, with a pencil, transfer the shape onto the piece. Run the craft knife around the outline several times until you have a piece the shape and size of the gap.

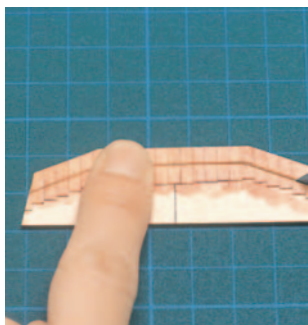

**18** Insert the piece of decking made in Step 17 into the gap between the two decks, and fix with wood glue.



**19** Fix the piece made in Step 13 and the piece 5 to the deck near the bow, in the position shown in Figure B.

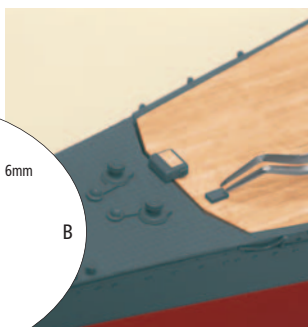
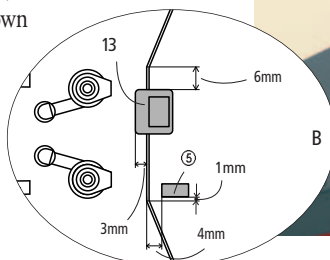

**20** Begin to glue the sections of piece 3 painted in Step 11 on the joins between the deck and the foredeck, as shown in Figure C of Step 21. First, place piece 3 on the left edge of the port side and make a pencil mark at the point where the foredeck changes angle.



**21** Cut piece 3 with the craft knife at the point marked, and fix with fast-drying glue. The piece should cover the point where the two decks join. Fix other painted sections of piece 3.

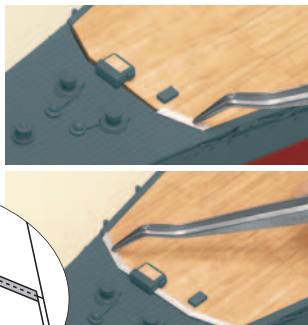
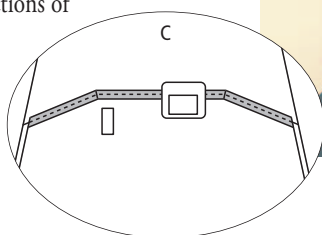

**22** With the pliers, cut piece 1 in half and insert one end into the hole of the hawse pipe, fixing it with fast-drying glue.

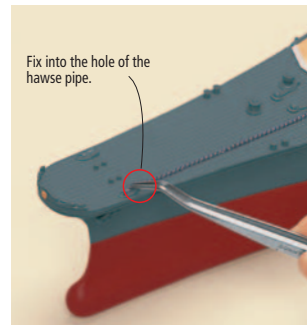

**23** Attach the other end of piece 1 to the fairlead, as shown in the photo. Adjust the length, cut the excess and fix the chain to the hawse hole with fast-drying glue. Fix at several points, with a few drops of glue, so that it is secure.

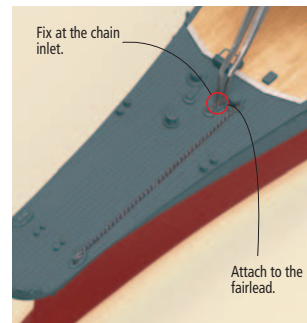

**24** From the remainder of piece 1, cut in Step 22, cut another segment (shown in red in Figure D) and fix it with fast-drying glue. After adjusting the length, cut and fix one end into the mouth of the hawse pipe and the other to the deck.

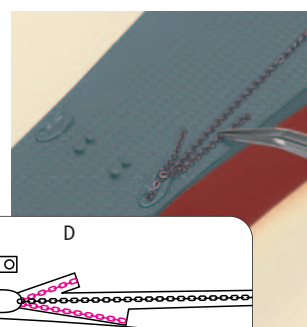
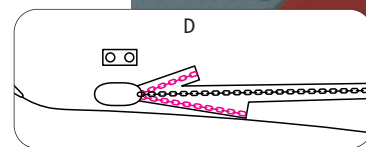

**25** Repeating Steps 22 to 24, fix the other piece 1 to the opposite side of the deck.



## COMPLETED PIECES

### BOW COMPONENTS

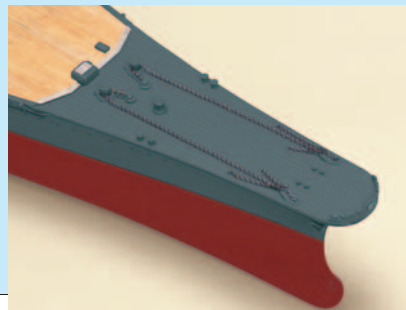





# Bow components and stern components

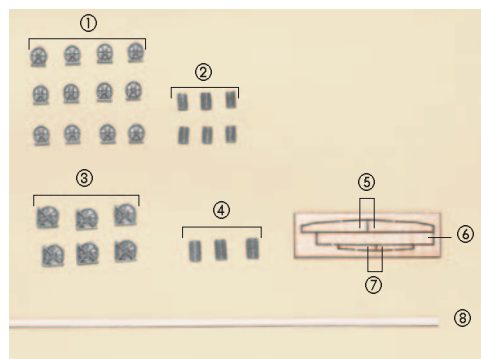

- ① Capstan side part (small) x 12
- ② Capstan drum (small) x 6
- ③ Capstan side part (large) x 6
- ④ Capstan drum (large) x 3
- ⑤ Board x 2
- ⑥ Board
- ⑦ Board x 2
- ⑧ Strip

## Recommended tools and materials

- Fast-drying glue
- Metal file
- Sandpaper (grain nos. 400 and 800)
- Craft knife
- Double-sided adhesive tape
- Pencil
- Ruler
- Paint primer
- Tracing paper
- Metal primer
- Spray paint (battleship grey)
- Watercolour paint (matt white, Tamiya red)
- Paintbrush

## BOW COMPONENTS

**26** Using the metal file, remove any irregularities in the surface of pieces 1 to 4.

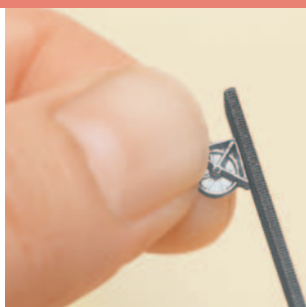

**29** Smooth the edges of pieces 5 to 7 with sandpaper grain no. 400.



**27** Where the file cannot reach, use the tip of the craft knife. Smooth the surfaces of the pieces with sandpaper grain no. 800, taking care not to alter the original shape.

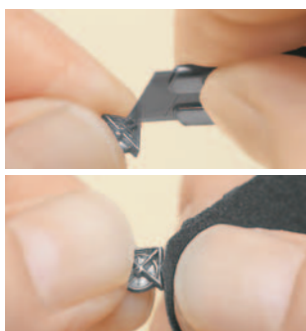

**30** Spray paint primer evenly on pieces 5 to 7 from a distance of about 30cm. The operation will be simpler if you secure the pieces to a base with double-sided adhesive tape. When the paint is dry, remove irregularities with sandpaper grain no. 400.

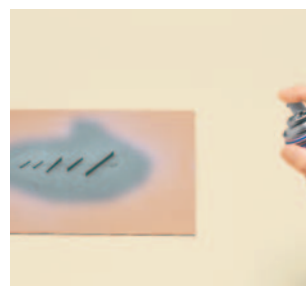

When using paint primer, ventilate the room well and follow the instructions on the packaging.

**28** Remove pieces 5 to 7 from the backing board, using the craft knife.

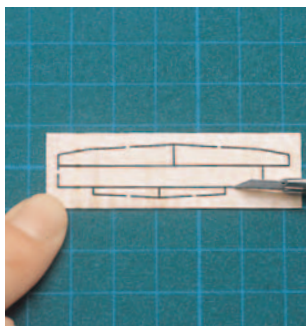

**31** Spray metal primer evenly on pieces 1 to 4, from a distance of about 30cm. The operation will be simpler if you secure the pieces to a base with double-sided adhesive tape.

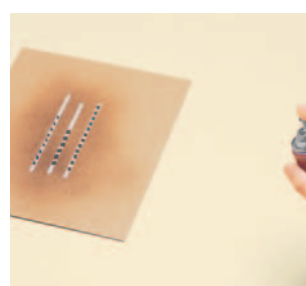

When using metal primer, ventilate the room well and follow the instructions on the packaging.

**32** When the primer is dry, fix pieces **2** and **4** to a leftover plank with double-sided adhesive tape, and paint them with an equal mixture of matt white and Tamiya red watercolour.

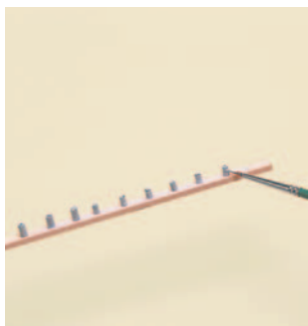

**33** When the primer is completely dry, spray a light coat of battleship grey on pieces **1**, **3**, **5**, **6** and **7**, from a distance of about 30cm.

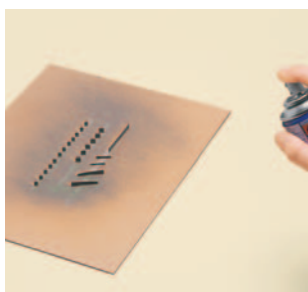

When using spray paint, ventilate the room well and follow the instructions on the packaging.

**34** When the paint is dry, repeat the operation, spraying several times from different angles.

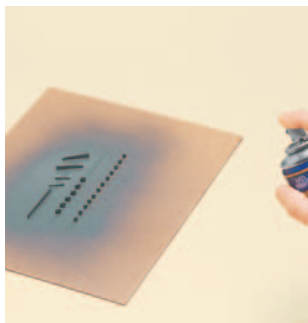

**35** Position a piece **1** with the flat side facing upwards. In the centre of the circle, fix a piece **2** with fast-drying glue, as shown.

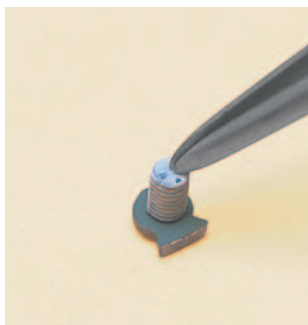

**36** At the other end of piece **2** fixed in Step 35, fix another piece **1** with the fast-drying glue. Place it on a flat surface, in the position shown in the photo, and match the bases of the two pieces **2**. You have made the small capstan. Make another five.

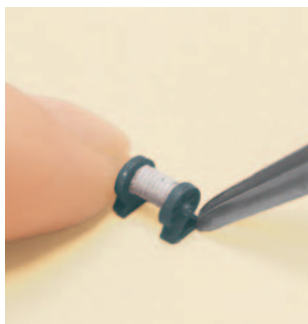

**37** Place a piece **3** with the flat side facing upwards. In the centre of the circle, fix a piece **4** with the fast-drying glue, in the position shown in the photo.

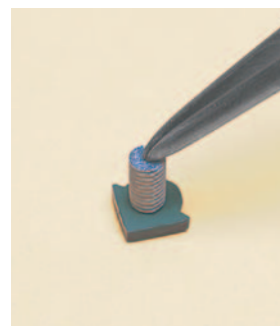

**38** At the other end of the piece **4** fixed in the previous step, fix another piece **3** with fast-drying glue. Fix it to the flat surface, resting it on the ruler and matching both the base and the inside of the two pieces **3**, as shown in the photo. You have made the large capstan. Make another two.

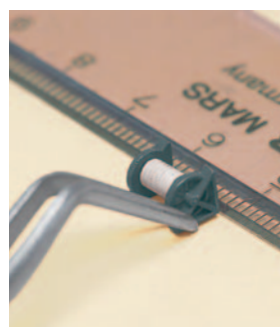

**39** Place the tracing paper on the flat area of the deck plan (bow area) included in this despatch. Trace over all the lines with a pencil. The parts in red in Figure A will be assembled first. Remove the tracing paper, turn it face down and trace over the lines again.

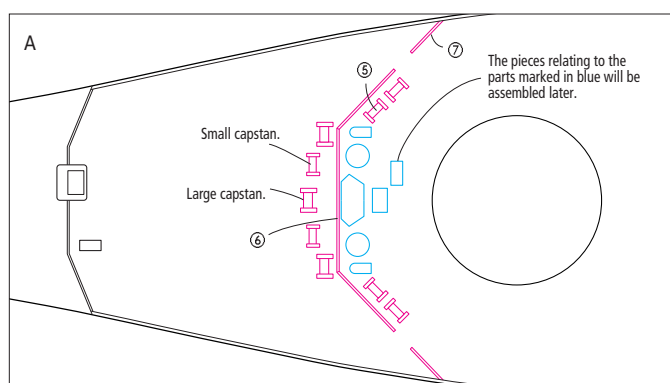
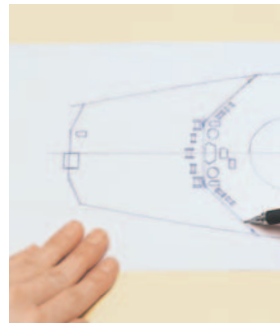

**40** Take the boat so far assembled, and place it as shown in the photo. On the bow part of the deck, lay the tracing paper prepared in the previous step, matching the black lines in Figure A with the edge of the hull. With a pencil, transfer the red and blue lines onto the hull.

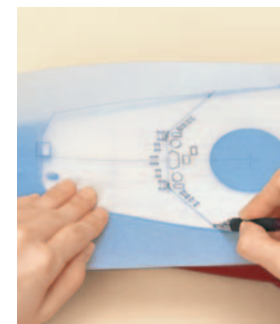

**41** With fast-drying glue, fix piece 6 at the point marked on the hull, as shown in the photo.

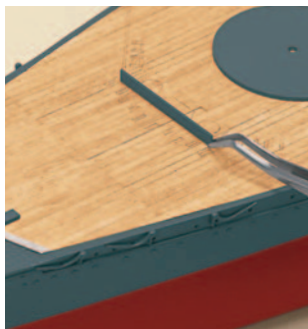

**42** With fast-drying glue, fix pieces 5 to the right and left of piece 6, as shown in the photo. It may be necessary to lightly file the surfaces that come into contact with piece 6, so that they fit perfectly (Figure B).

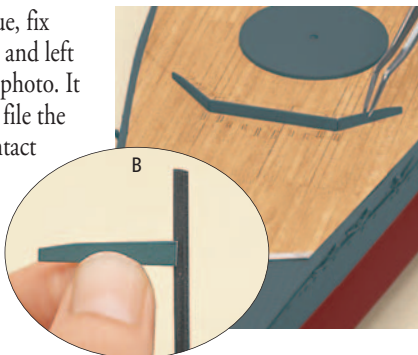

**43** At the point marked on the hull, fix pieces 7 with fast-drying glue, in the position shown in the photo. Turn the narrow ends toward the sides and place them at the outer edge of the deck.

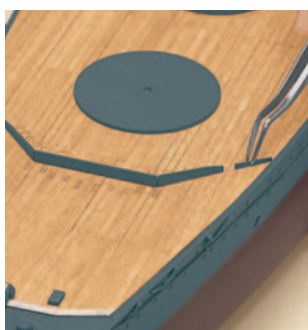

**44** At the points marked, fix the three large capstans with fast-drying glue, as shown in the photo. Then, fix the small capstans at the points marked on the hull.



**46** As shown in Figure C (below), after cutting to the required length, fix the segments of piece 8 at the join of the deck and rear bridge. Start with the section between the end of the starboard deck and rear bridge.

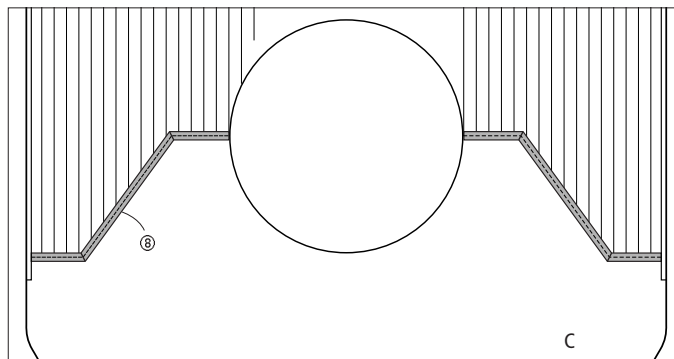

**47** Following Step 46, fix the other segments of piece 8 to the base of the guns.



**48** Following Steps 46 and 47, fix the sections of piece 8 to the port side.



## STERN COMPONENTS

**45** Paint one face and the edges of piece 8 with paint, diluted as indicated on the packaging.



## COMPLETED PIECES

STERN COMPONENTS

BOW  
COMPONENTS

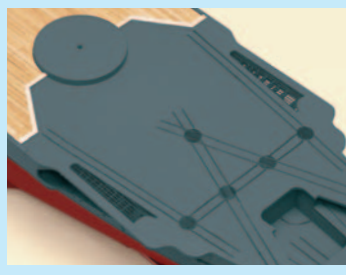





# Bow components and bollards

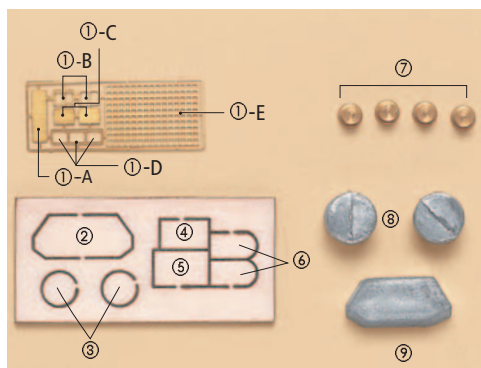
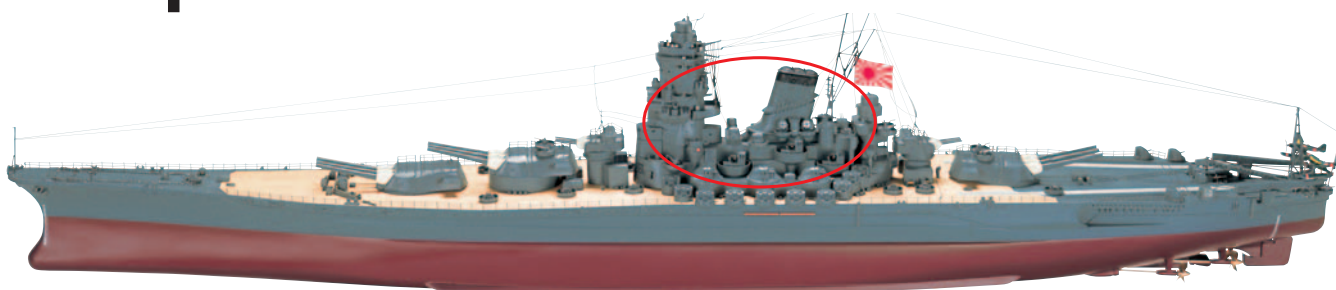

- ① Board etched with acid
- ② Wooden board
- ③ Wooden board x 2
- ④ Wooden board
- ⑤ Wooden board
- ⑥ Wooden board x 2
- ⑦ Bollard x 4
- ⑧ Metal part x 2
- ⑨ Metal part

## Recommended tools and materials

- Fast-drying glue
- Metal file
- Sandpaper (grain nos. 400 and 800)
- Putty
- Craft knife
- Wooden spatula
- Double-sided adhesive tape
- Paint primer
- Metal primer
- Spray paint (battleship grey)
- Watercolour paint (battleship grey, matt black)

## BOW COMPONENTS AND BOLLARDS

**49** Remove any irregularity on pieces **7** to **9** with the metal file.



**52** With a craft knife, separate parts **A** to **E** of piece **1**, then smooth them with the metal file.

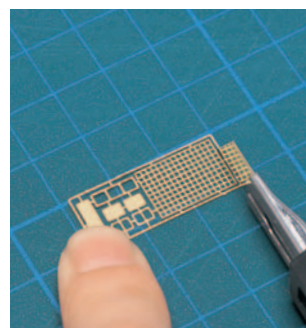

**50** Smooth pieces **7** to **9** with sandpaper grain no. 800, being careful not to alter the original shape.



**53** Fix piece **1A** and the two pieces **1C** on the surface of piece **1E** with fast-drying glue, as shown in the photo. Do not use too much glue; just take a bit with the tip of the craft knife and apply it to the pieces.

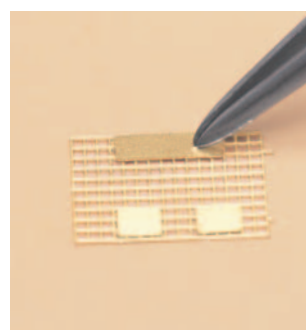

**51** If there are holes or hollows on the surfaces, apply putty with a wooden spatula. Push the putty deeply into the cavities and, after allowing to dry, smooth with sandpaper grain no. 800 to remove any excess.



**54** Cut piece **1E** with the craft knife along the edges of pieces **1A** and **1C**. Piece **1A** is the grille of the large air intake, while pieces **1C** are the grilles of the small air intakes.

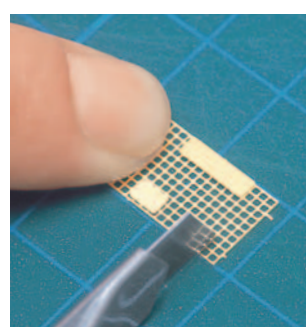

**55** Detach pieces **2** to **6** from the backing board with the craft knife.

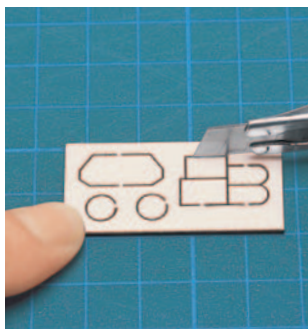

**56** Smooth all the pieces with sandpaper grain no. 400.



**57** From a distance of 30cm, spray paint primer evenly on pieces **2** to **6**, securing them temporarily with double-sided adhesive tape. When they are dry, smooth them with sandpaper grain no. 400 to eliminate irregularities in the surface.

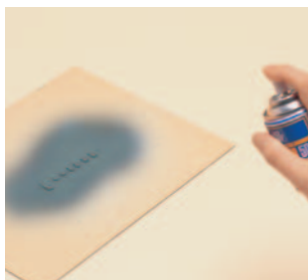

⚠ When using paint primer, ventilate the room well and follow the instructions on the packaging.

**58** From a distance of 30cm, spray metal primer evenly on the grilles of the air intake, on pieces **1B** and **1D** and pieces **7** to **9**. It is easier if you secure the pieces on cardboard with double-sided adhesive tape, as shown in the photo.

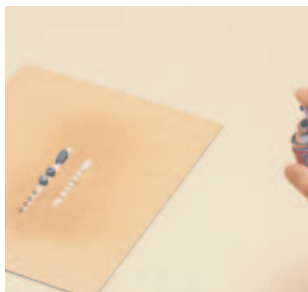

⚠ When using metal primer, ventilate the room well and follow the instructions on the packaging.

**59** When the metal primer is dry, hold piece **8** in the position shown in the photo and fix piece **3** in the centre of the top with fast-drying glue. Make two such pieces.

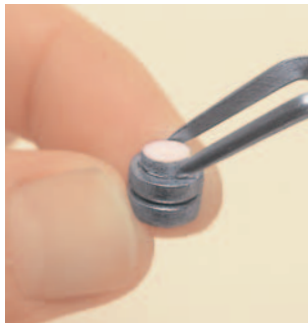

**60** Hold piece **9** in the position shown in the photo, and fix piece **2** in the centre of the top (where there is a hole) with fast-drying glue. You have now made the base of the air intake pipe.



**61** Spray a light and even coat of battleship grey paint on the grilles of the air intake, on pieces **1B**, **1D**, on the base of the air intake duct and pieces **4**, **5** and **6**, keeping the canister about 30cm away.



⚠ When using spray paint, ventilate the room well and follow the instructions on the packaging.

**62** When the pieces are dry, spray again from a different angle. Repeat several times, always allowing the paint to dry between coats.



**63** After securing the grilles of the air intake on a wooden rod with double-sided adhesive tape, paint them with a mixture of the two watercolours in a ratio of 1 (matt black) to 2 (battleship grey).

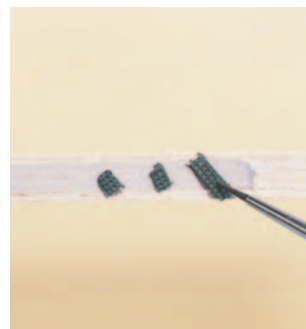

**64** Fix piece **1D** on the grilles of the large air intake, and pieces **1B** on the mesh side of the small ones, with fast-drying glue. You have now made the air intakes. When the glue is dry, paint the edges with battleship grey watercolour.

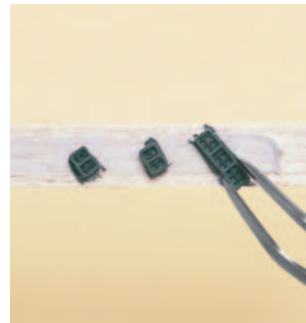



**65** Hold the base of the air intake duct, as shown in the photo, and fix the large air intake on the side nearest to you with fast-drying glue. The air intake must be positioned in the centre, and its top edge must be within 1.5mm of the top edge of the base.



**70** With fast-drying glue, fix the two pieces assembled in Step 59 at the point marked earlier.

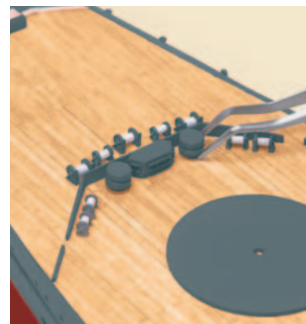

**66** Take what has been made in the previous step, as shown in the photo, and fix a small air intake on the right side of the base. Place it in the middle with the top edge 1.5mm from the top edge of the base. Fix the other small air intake on the left side. You have now made the air intake duct.



**71** With fast-drying glue, fix the two pieces **6** in the position marked earlier.



**67** Place the hull in the position shown in the photo and position the air intake duct on the reference mark made in Step 39. Fix it with fast-drying glue.



**72** With fast-drying glue, fix two pieces **4** and **5** in the position marked earlier.



**68** With fast-drying glue, fix two pieces **7** in the position on the port side of the aftdeck shown in the photo. Place them on the flat part, in the position shown in Figure A.

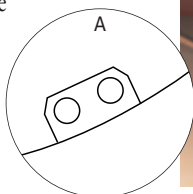

**69** Following Step 68, fix two pieces **7** on the starboard side, in the symmetrical position.



## COMPLETED PIECES

BOW COMPONENTS

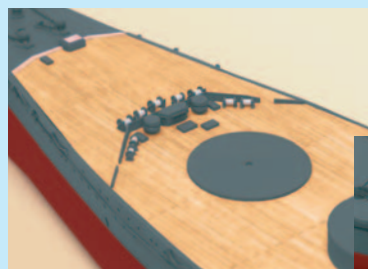

BOLLARDS





# Anti-aircraft guns with shielding and air ducts

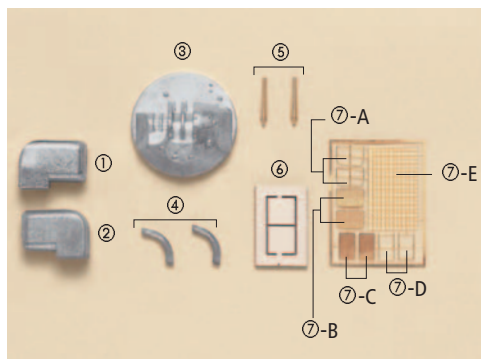
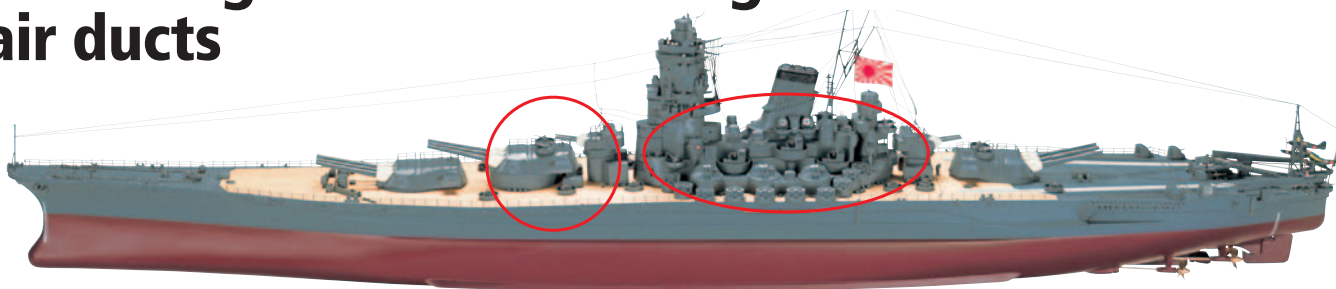

- ① Air duct (starboard)
- ② Air duct (port)
- ③ Base of anti-aircraft guns
- ④ Support of anti-aircraft guns x 2
- ⑤ Barrels of anti-aircraft guns x 2
- ⑥ Board
- ⑦ Finishing board

## Recommended tools and materials

- Fast-drying glue
- Metal file
- Sandpaper (grain nos. 400 and 800)
- Putty
- Wooden spatula
- Craft knife
- Double-sided adhesive tape
- Pencil
- Paint primer
- Metal primer
- Tracing paper
- Paintbrush
- Spray paint (battleship grey)
- Watercolour paints (battleship grey, matt back)

## ANTI-AIRCRAFT GUNS WITH SHIELDING

**73** Using the metal file, remove all irregularities and projections from pieces 3 to 5.



**76** Referring to Step 77, fit piece 4 to piece 3. If piece 4 is difficult to fit, adjust its outline with the metal file.

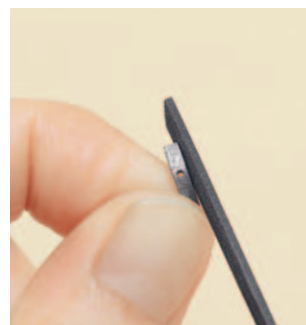

**74** Where the file will not reach, use the tip of the craft knife, being careful not to damage the surrounding parts. Smooth the surfaces of pieces 3 to 5 with sandpaper grain no. 800, taking care not to alter the original shape.

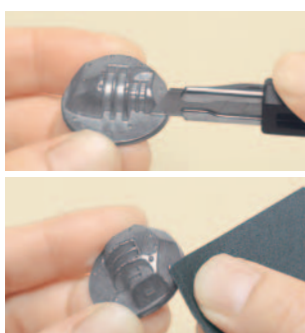

**77** Holding piece 3, as shown in the photo (right, above), fix a piece 4 in each groove with fast-drying glue. Assemble pieces 4 with the hole at the bottom. In each hole of pieces 4, insert a piece 5, positioned as shown in the photo (right, below). You have made the anti-aircraft guns with shielding.

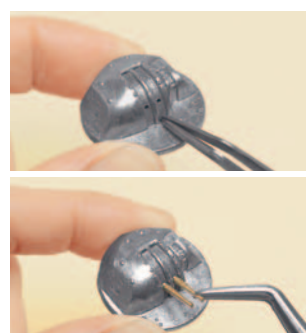

**75** Correct any hollows in pieces 3 to 5 by applying putty with a wooden spatula. Once dry, smooth the pieces with sandpaper grain no. 800 to remove excess putty.



**78** From a distance of 30cm, spray metal primer evenly on the anti-aircraft guns with shielding. It is easier if you secure them with double-sided adhesive tape on cardboard.



⚠ When using metal primer, ventilate the room well and follow the instructions on the packaging.

**79** When the primer is dry, spray a light coat of battleship grey on the anti-aircraft guns with shielding from a distance of 30cm. Repeat several times from different angles, always allowing the paint to dry between coats.

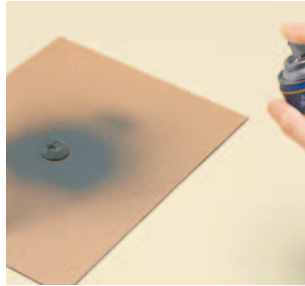

⚠ When using spray paint, ventilate the room well and follow the instructions on the packaging.

**80** When the paint is dry, paint the grooves with a mixture of matt black and battleship grey watercolour in a ratio of 1 to 2, as shown in the photo.

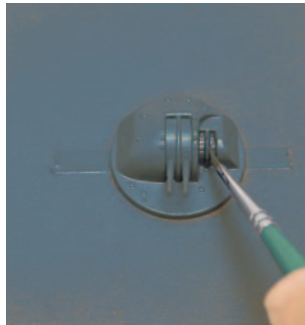

**84** With the craft knife, cut the joins of piece 7, separating all the elements (A to E) and smooth the cuts with sandpaper.

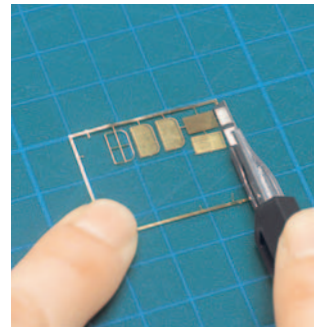

**85** Fix two pieces 7B, and two pieces 7C on the upper surface of the piece 7E, at the corners of the mesh, with fast-drying glue. It is advisable to take the glue with the tip of a craft knife and apply a small amount around the edge.

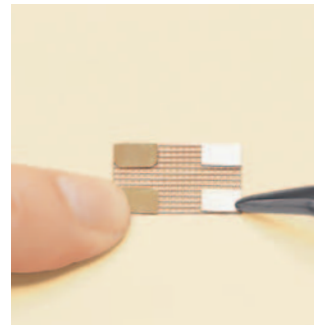

## AIR DUCTS

**81** With the metal file, remove any irregularities and projections from pieces 1 and 2.



**86** With the craft knife, cut piece 7E along the edges of each piece 7B and 7C. The pieces 7B are the grilles of the large air ducts; pieces 7C are the grilles of the small air ducts.

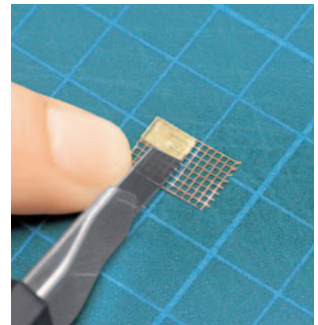

**82** With sandpaper grain no. 800, smooth the surfaces of pieces 1 and 2, taking care not to alter the original shape.



**87** With the craft knife, separate pieces 6 from the backing board and smooth the cuts with sandpaper grain no. 400.

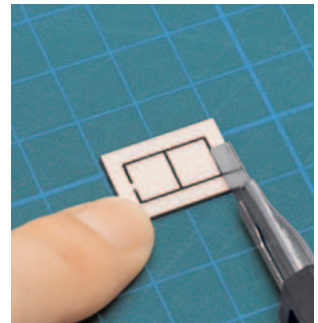

**83** If there are any holes or hollows on the surface of the piece, fill them by applying the putty with a wooden spatula. Push the putty to the bottom of the cavity and, after allowing it to dry, smooth with sandpaper grain no. 800 to remove any excess.



**88** From a distance of 30cm, spray paint primer evenly on pieces 6. It is easier if you secure the pieces with double-sided adhesive tape on a piece of cardboard. When the paint is dry, remove any irregularities with sandpaper grain no. 400.

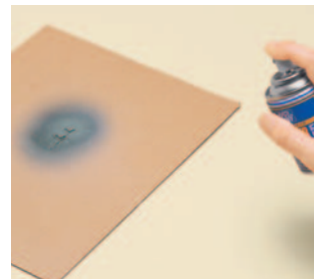

⚠ When using paint primer, ventilate the room well and follow the instructions on the packaging.



**89** From a distance of 30cm spray metal primer evenly on the grilles of the air ducts, on pieces **7A**, **7D**, **1** and **2**. It is easier if you secure them with double-sided adhesive tape to a piece of cardboard.

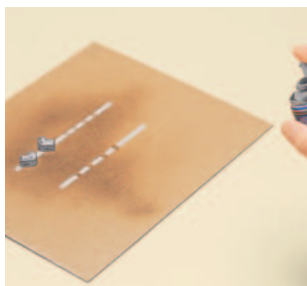

When using metal primer, ventilate the room well and follow the instructions on the packaging.

**90** When the primer is dry, spray from a distance of 30cm a light coat of battleship grey on the pieces **7A**, **7D**, **1**, **2** and **6**. Repeat several times from different angles, always allowing the paint to dry between coats.



When using spray paint, ventilate the room well and follow the instructions on the packaging.

**91** Fix all the grilles of the air ducts, with the mesh upwards, on a rod with double-sided adhesive tape. Paint them with a mixture of matt black and battleship grey watercolour in proportions of 1 to 2.

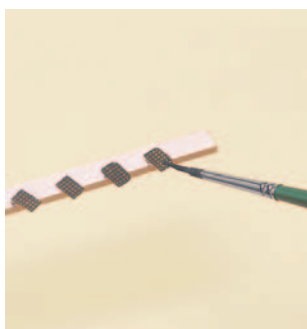

**92** With fast-drying glue, fix a piece **7A** on the grilles of the large air ducts, and a piece **7D** on the small ones. The components with pieces **7A** are the large air ducts; the components with pieces **7D** are the small air ducts. When the glue is dry, paint the edges of each air duct with battleship grey watercolour.

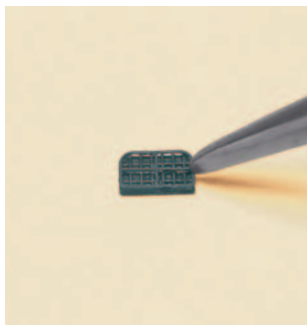

**93** On piece **1**, fix a large air duct facing you (photo right, above) and a small air duct on the left side of the surface facing towards you (photo right, below) with fast-drying glue. Place them so that the lower edge is 1.5mm higher than the lower edge of piece **1**. Similarly, fix the air ducts, large and small, on piece **2**.

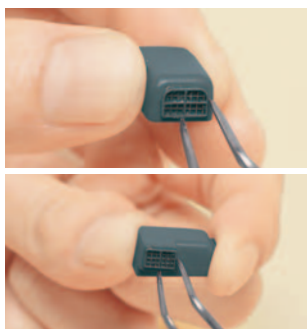

**94** Place tracing paper on the drawing below and go over the red and black lines in pencil. Cut out the part surrounded by the red line. As shown in the photo, place the paper against the hull, inserting the area corresponding to the circle in the second base of the main guns starting from the bow, and transfer the black lines onto the hull.

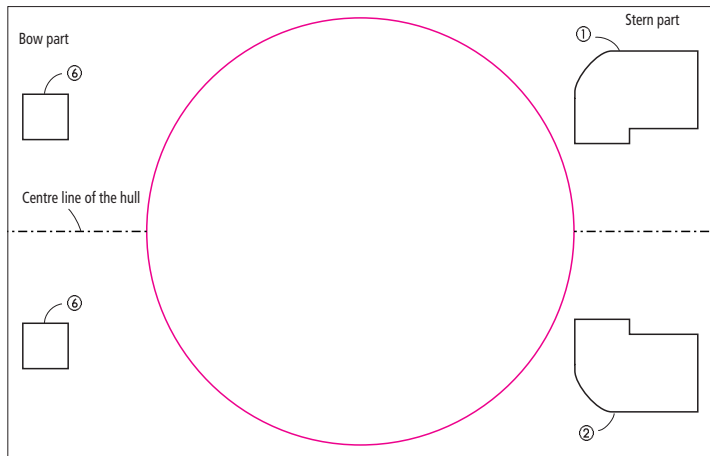

**95** On the points transferred onto the hull, fix with fast-drying glue pieces **1** and **2**, positioning them as shown in the photo. If the bases of the pieces **1** and **2** do not sit flush with the deck, adjust them with the metal file.



**96** Fix the two pieces **6** in the position traced onto the deck with fast-drying glue.



## COMPLETED PIECES

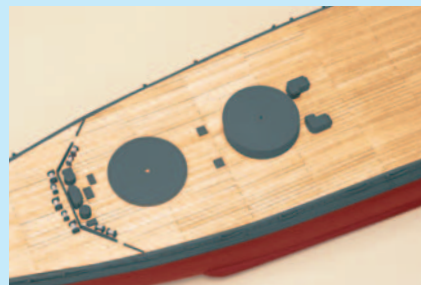

AIR DUCTS

ANTI-AIRCRAFT GUNS WITH SHIELDING

