

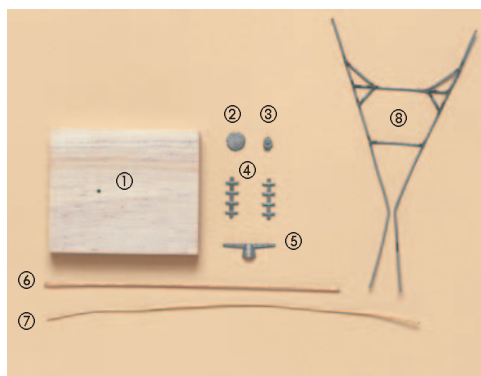

Antenna, mast and signalling lamp



- ① Support
- ② Base of the signalling lamp
- ③ Signalling lamp
- ④ Antenna x 2
- ⑤ Antenna
- ⑥ Metal rod
- ⑦ Wire
- ⑧ Mast

Recommended tools and materials

- Fast-drying glue
- Metal file (flat, round)
- Sandpaper (grain no.800)
- Double-sided adhesive tape
- Pliers
- Craft knife
- Long-nosed pliers
- Pencil
- Hand drill (1mm and 1.2mm diameter bits)
- Metal primer
- Spray paint (battleship grey)
- Watercolour paint (silver, matt black)
- Paintbrush
- Tracing paper
- Drawing pin

ANTENNA, MAST AND SIGNALLING LAMP

1 Smooth pieces 2 to 5 with the metal file to remove irregularities in shape. Where the file cannot reach, use the tip of the craft knife, being careful not to damage other parts of the pieces, then smooth with sandpaper grain no. 800.

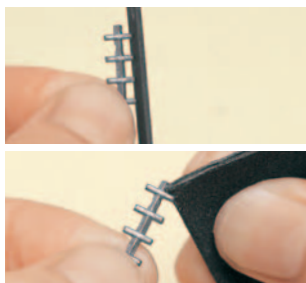

2 If the joints of piece 8 are not smooth, file them with the metal file. Take care not to damage the piece.

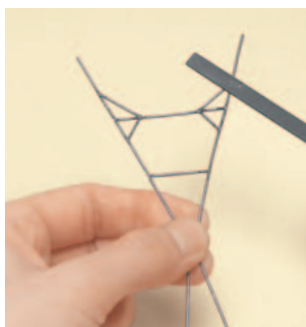

3 With the long-nosed pliers, bend piece 6 as in the full-scale drawing (above Step 7). Place piece 6 on the drawing and bend the lower part where shown. Cut to the length specified (preferably slightly longer, to allow for adjustments).

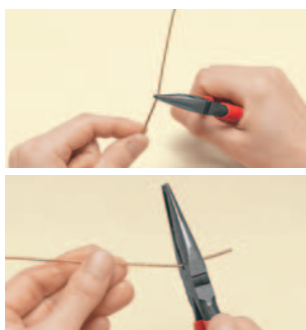

4 Following Step 3, bend piece 8 to the angle shown in the drawing above Step 7. Given the fragility of the piece, it should be bent slowly, pressing gently with your fingers. As shown in the photo, the lower part of piece 8 should point to the deck.

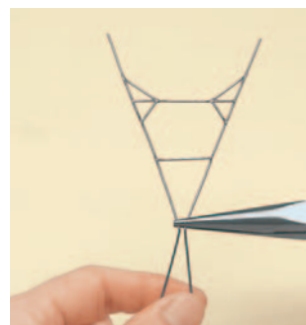

5 Take piece 8, as shown in the photo, and, with fast-drying glue, attach piece 5 at the point where the two rods of piece 8 meet (Figure A). Insert two rods of piece 8 into the cavity of the piece 5.

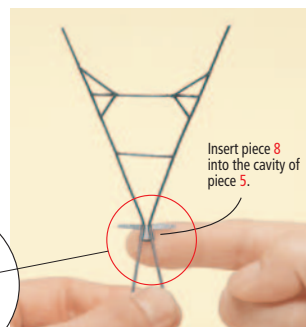
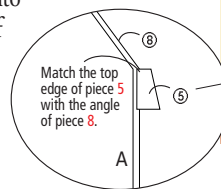

6 Place piece 1 on a flat surface. As shown in the photo, insert piece 6 into the large hole and piece 8 into the two smaller holes. Fix pieces 5 and 6 with fast-drying glue. Insert piece 6 into the cavity of piece 5.

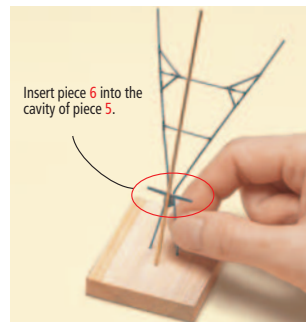

MAST AT FULL SCALE

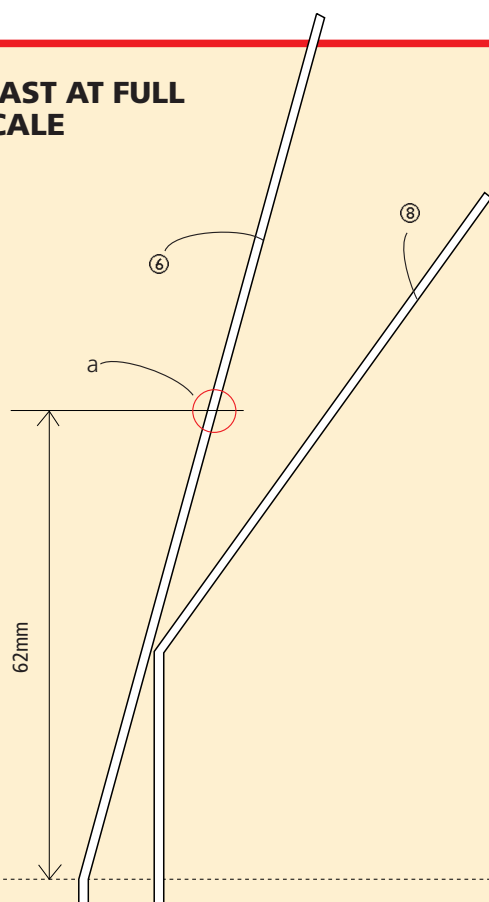

7 Using fast-drying glue, fix piece **2** at the point shown in the photo. The notches of piece **2** should fit easily with pieces **6** and **8**. If they do not, adjust them using the round metal file, as shown in Figure B.

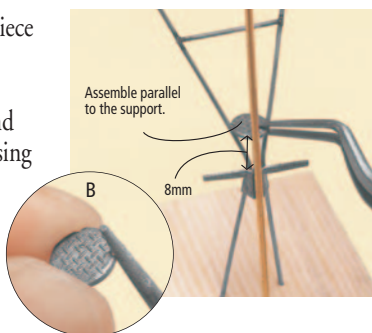

8 Place the mast so far assembled as shown in the photo, and, with fast-drying glue fix pieces **4** to the respective edges of piece **5**, one by one. The markings on pieces **4** must face outwards. Assemble them vertically.

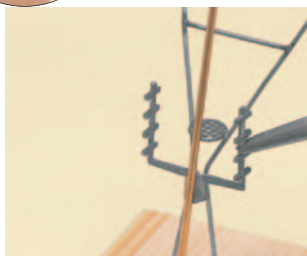

9 Place the mast as shown in the photo. With fast-drying glue, fix a segment of piece **7** between the upper edges of piece **4** and piece **6**. Calculate the required length of the wire by placing it on the support and cut with the pliers.



10 Place the mast as shown in the photo. With the fast-drying glue, fix two other lengths of piece **7** between pieces **6** and **8**. The wire must be cut beforehand after calculating the required length, and assembled in the position shown in the photo.

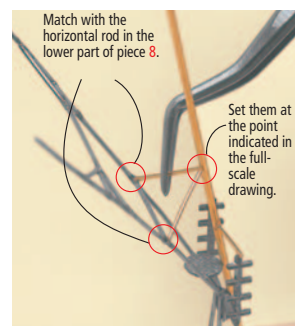

11 With fast-drying glue, fix another length of piece **7** at the junction of the pieces **7** glued in Step 10, and piece **8**.

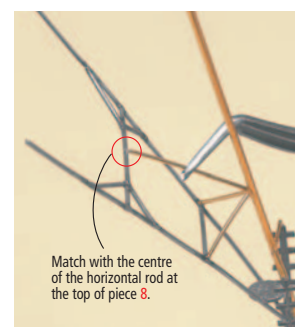

12 Place the part so far assembled as shown in the photo. With fast-drying glue, fix two segments of piece **7** between pieces **6** and **8**. The segments must be cut beforehand after calculating the required length, and assembled in the position shown in the photo.

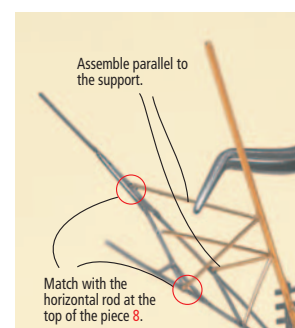

13 With fast-drying glue, fix another length of piece **7** at the junction of pieces **7** fixed in Step 12 and piece **8**. The sections must be cut beforehand after calculating the required length. You have now made the radio mast of the ship.

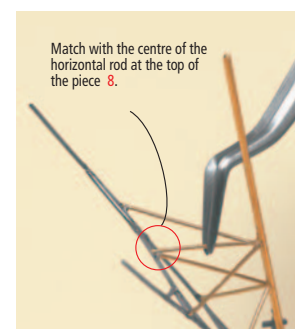

14 Spray metal primer on the mast, without taking it from the support, and on piece **3**, evenly from a distance of about 30cm.

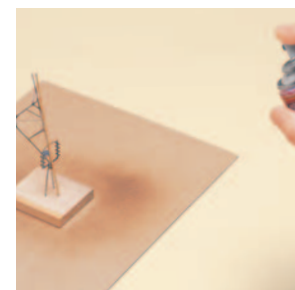

When using metal primer, ventilate the room well and follow the instructions on the packaging.

15 Allow the metal primer to dry, and spray a light and even coat of battleship grey paint, keeping the canister about 30cm away. Repeat several times from different angles, allowing the paint to dry thoroughly between each coat.

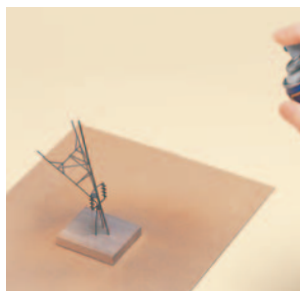

When using spray paint, ventilate the room well and follow the instructions on the packaging.

16 Paint the lamp section of piece 3 with silver watercolour paint. The operation will be simpler if you secure the piece to a wooden rod with double-sided adhesive tape. Any paint smudges can be painted over when the paint is dry.



20 Place the part assembled in Step 19, as shown in the photo, and fix piece 3 in the centre of the surface of piece 2 with the fast-drying glue. The lamp should face forwards. Remove the mast from piece 1.



21 Take a piece of tracing paper 2cm x 2cm and draw the outline shown in Figure C. Place the tracing paper on the base of the command bridge, as shown in the photo, and lightly trace the red dashes in Figure C with the tip of the craft knife, transferring the lines to the base of the command bridge.

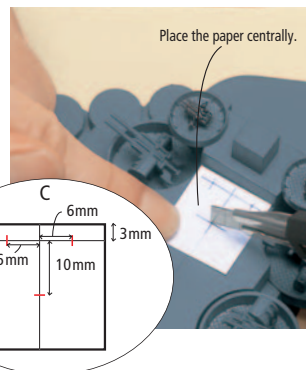

17 Place the funnel made in the previous despatch on a flat surface, as indicated in the photo. On the side closest to you, place a leftover plank vertically and draw a reference line at that point corresponding to the lower edge of the area of the funnel painted black.

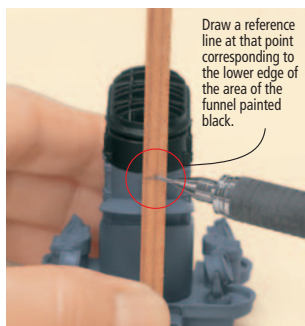

22 Remove the paper and drill holes at the points marked in Step 21, starting them with a drawing pin. The two holes sternwards should have a diameter of 1mm, while the forward one should be of 1.2mm, all three to a depth of 3mm.

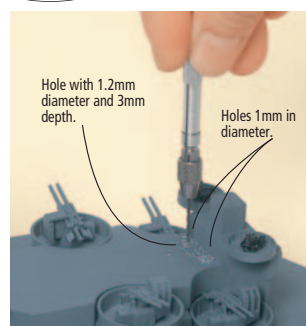

18 Place the mast with support on a flat surface, as shown in the photo. Rest the plank vertically against the piece and transfer the mark made in Step 17 onto pieces 6 and 8.



23 Set the mast in the holes of Step 22, as indicated in the photo, and fix with fast-drying glue. If the holes are too small, adjust them with the round metal file. Finally, spray metal primer on the main guns firing control post from a distance of 30cm.



19 With matt black watercolour paint, repaint the part above the mark made on pieces 6 and 8. Also paint the sections of wire 7. Leave piece 4 unpainted.

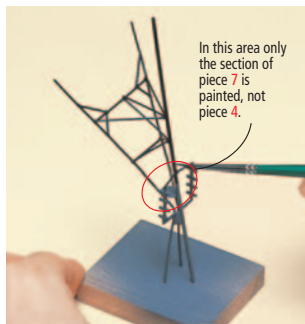

COMPLETED PIECES

MAST

ANTENNA

SIGNALLING LAMP

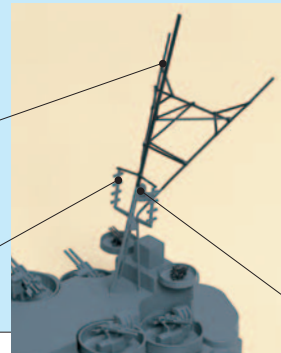



Parts of the command bridge

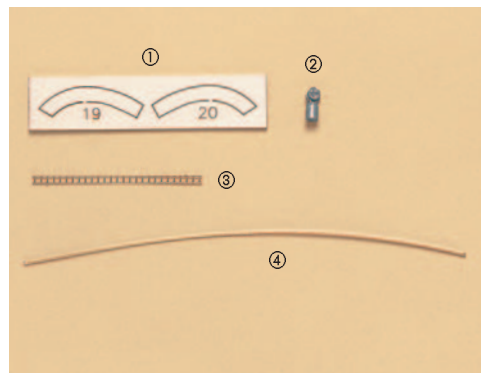
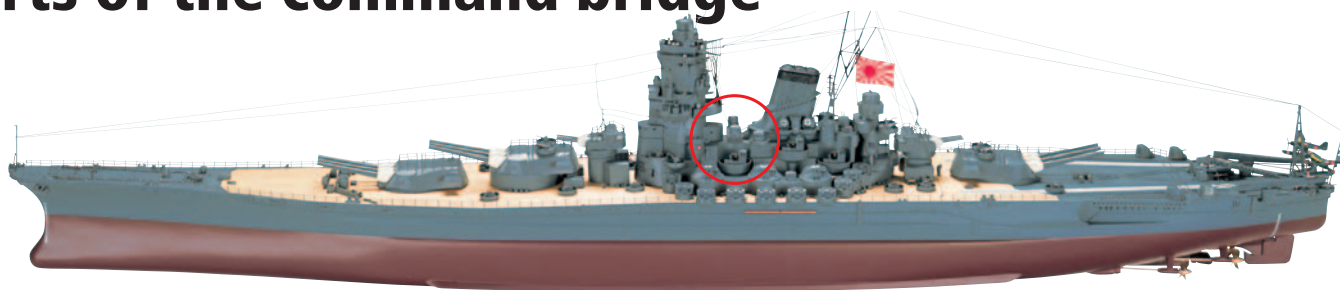

- ① Funnel passageway x 2
- ② Signal lamp
- ③ Rung ladder
- ④ Wire

The numbers on the board of pieces 1 were printed during manufacture and bear no relation to assembly procedures.

Recommended tools and materials

- Fast-drying glue
- Metal file
- Sandpaper (grain nos. 400, 800)
- Putty
- Craft knife
- Long-nosed pliers
- Pliers
- Double-sided adhesive tape
- Paint primer
- Metal primer
- Spray paint (battleship grey)
- Watercolour paint (silver, battleship grey)

PARTS OF THE COMMAND BRIDGE

24 Smooth piece 2 with the metal file to remove any irregularities. Where the file cannot reach, use the craft knife, being careful not to damage the surrounding parts.

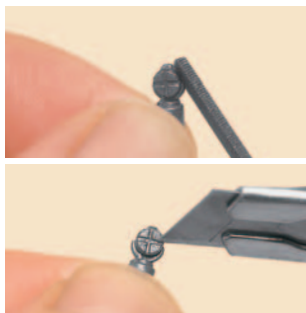

25 Smooth the surface of piece 2 with sandpaper grain no. 800, taking care not to damage the original shape. Correct any holes or hollows in the surface with putty.



26 Using the long-nosed pliers, bend piece 4 to an angle of 90 degrees, 5mm from the end of the wire.



27 11mm from the bend made in Step 26, bend the wire again at an angle of 90 degrees (Figure A of Step 28).



28 Using the pliers, cut the wire as shown in Figure A and the photo (right). Use the remaining wire to make another piece exactly the same.

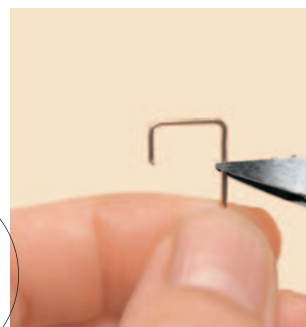
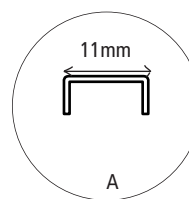

29 Bend the longest side of the pieces made in Step 28, as shown in Figure B. Make two symmetrical parts, which will become the command bridge rails.

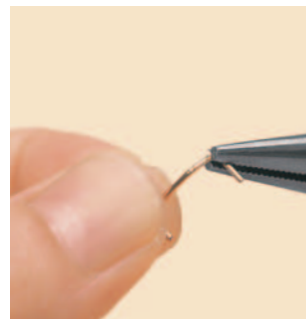
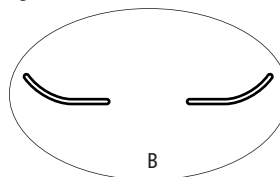

30 Remove pieces **1** from the backing by inserting the craft knife gently into the joins.

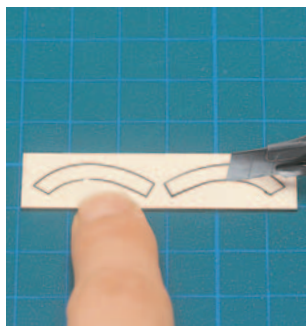

31 Smooth the edges of the pieces with sandpaper grain no. 400.



32 Spray pieces **1** evenly with paint primer from a distance of about 30cm. The operation will be simpler if you secure the pieces to a base with double-sided adhesive tape.

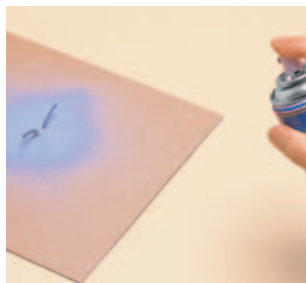

⚠ When using paint primer, ventilate the room well and follow the instructions on the packaging.

33 When the paint primer is dry, smooth with sandpaper grain no. 400.



34 Spray the metal primer evenly on pieces **2** and **3**, from a distance of about 30cm. The operation will be simpler if you secure the pieces to a base with double-sided adhesive tape.

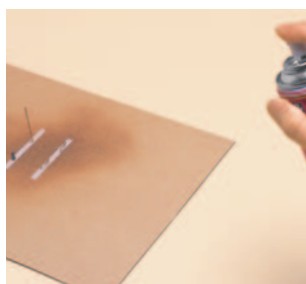

⚠ When using metal primer, ventilate the room well and follow the instructions on the packaging.

35 Allow the metal primer to dry, then spray a light and even coat of battleship grey on the parts treated in Step 34 and on pieces **1**.

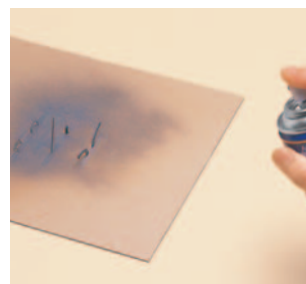

⚠ When using spray paint, ventilate the room well and follow the instructions on the packaging.

36 Allow the paint to dry thoroughly, and repeat the operation from different angles, allowing the paint to dry each time.

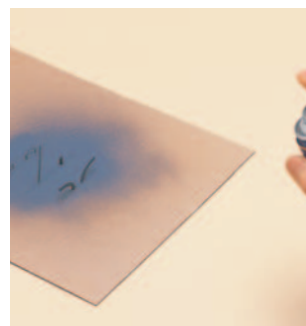

37 As in the photos, secure piece **2** to a strip of wood with double-sided adhesive tape, and paint the front of the lamp with silver watercolour. Allow to dry, then paint the cross at the centre of the lamp with battleship grey. You have now made the signal lamp.

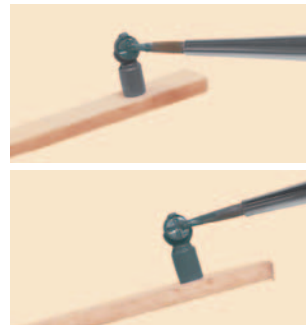

38 Take the command bridge so far assembled, and fix the signal lamp starboard of the flag bridge with fast-drying glue, symmetrically opposite the one fixed on the port side.

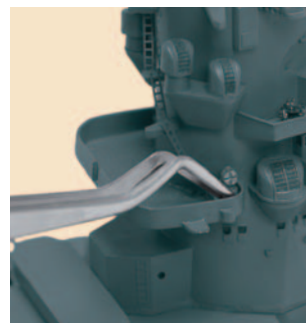

39 Apply a small amount of fast-drying glue to the ends of a command bridge rails and secure it to the flag bridge, shaping it to the curvature of the bridge.



40 Following Step 39, fix the other rails to the port side of the flag bridge with fast-drying glue.



45 At the position on the funnel shown in the photo, fix piece 3 cut in Step 44 with fast-drying glue.

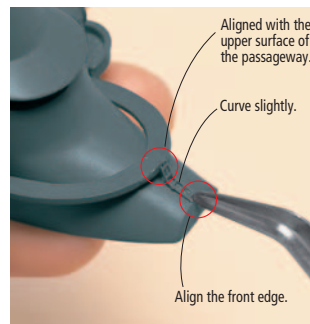

41 Take the funnel so far assembled, as shown in the photo. In the position indicated, fix a piece 1 with fast-drying glue so that it is parallel to the base of the funnel.

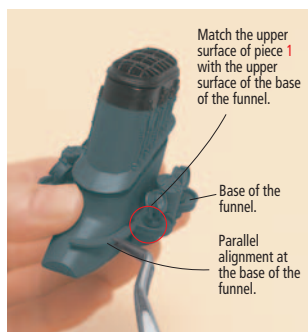

46 Following Steps 43 and 44, give the remaining segment of piece 3 the correct shape and with fast-drying glue fix it in the position on the funnel shown in the photo.

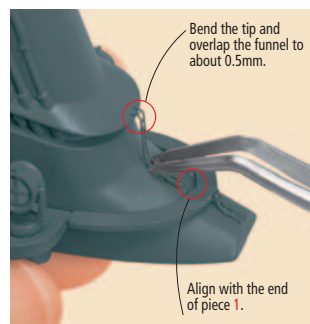

42 Following Step 41, fix the other piece 1 on the other side.



47 Take the base of the command bridge built so far and, holding it as shown in the photo, fix the funnel between the mast and the command bridge with fast-drying glue.

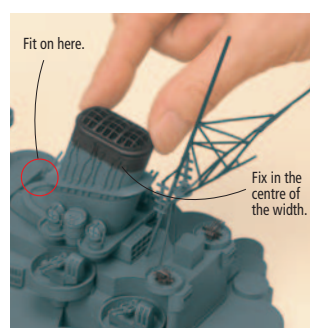

43 Checking against Step 45, place piece 3 in the position shown and, with the long-nosed pliers, give it the same curve as the funnel. Wrap the tips of the nose with tape to prevent damage to the paint.



48 Fix the rear command bridge, built in previous despatches, forward of the base of the command bridge with fast-drying glue.

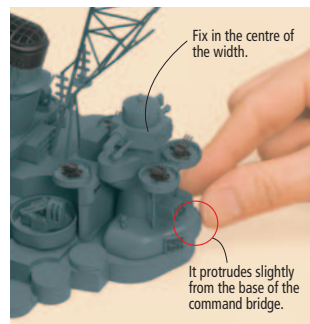

44 Place piece 3 bent in Step 43 in the required position on the funnel and cut it with pliers to fit the length.



COMPLETED PIECES



SIGNAL LAMP
RAILS
FUNNEL PASSAGEWAY
RUNG LADDER

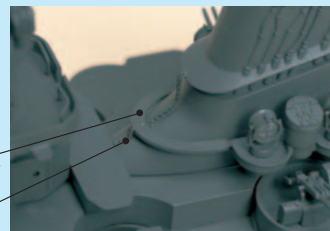



Parts of the command bridge and exhaust pipe

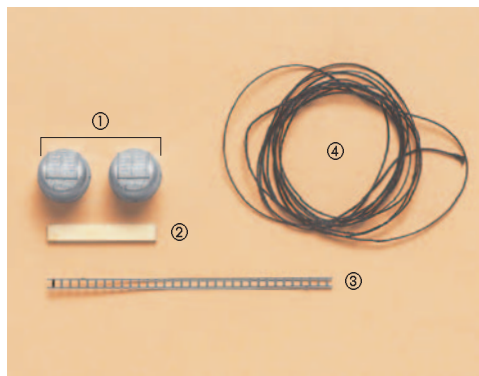

- ① Machine-gun firing control mechanism x 2
- ② Board
- ③ Ladder
- ④ Wire

Recommended tools and materials

- Fast-drying glue
- Metal file
- Sandpaper (grain nos. 400 and 800)
- Putty
- Pliers
- Craft knife
- Pencil
- Tracing paper
- Scissors
- Double-sided adhesive tape
- Metal primer
- Paint primer
- Spray paint (battleship grey)
- Watercolour (matt black, battleship grey)

PARTS OF THE COMMAND BRIDGE AND EXHAUST PIPE

49 Cut piece **4** with scissors, making ten smaller lengths of 13cm.



50 Cut a piece of tracing paper 12cm x 12cm. Along one edge, mark lines at intervals of 3mm. Position the rectangle next to the command bridge in the position shown in the photo. Transfer the marks onto the protruding part of the command bridge.

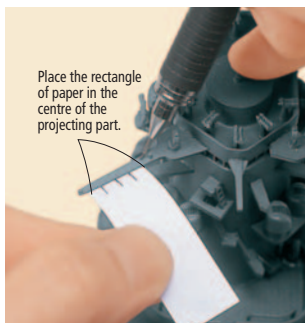

51 Fold a piece of wire **4** in half, and hang it on the projecting part of the command bridge, as shown in the photo. Position the wire on the innermost mark of the command bridge and fix with the fast-drying glue.



52 Pass one end of the wire fixed in Step 51 through the rail of the flag bridge and fix with the fast-drying glue. The wire should be about 1mm away from the inner edge of the rail. Do the same with the other end of the wire.



53 When the glue has dried, use the pliers to cut the ends of the wire to a length of 0.5mm.



54 Following Steps 51 to 53, on the outermost mark on the projection of the command bridge fix another 13cm wire. The ends of the wire must be 1mm from the outer edge of the command bridge rail.



⚠ Take care when adjusting the position of the wire, so that you do not damage the projecting part of the command bridge.

55 Fix the three other wires on their respective marks between the two fixed in Steps 51 to 54.



56 Repeat the operation on the opposite projection of the command bridge, first drawing marks as in Step 50. Following Steps 51 to 55, fix the five other 13cm-long wires with fast-drying glue.

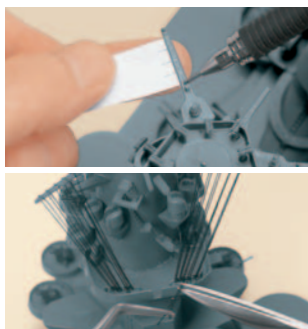

57 Smooth pieces 1 with the metal file to remove irregularities in shape. Where the metal file cannot reach, use the tip of the craft knife, taking care not to damage other parts of the pieces.



58 Smooth pieces 1 with sandpaper grain no. 800 and fill any small holes with the putty. Smooth the sides of piece 3 with the metal file to remove irregularities in shape.



59 Spray piece 2 evenly with the paint primer from a distance of about 30cm. The operation will be simpler if you secure the piece to a base with double-sided adhesive tape.

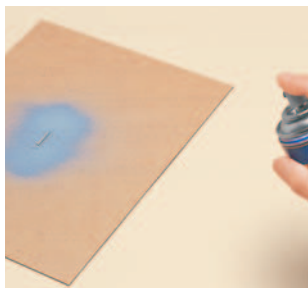

When using paint primer, ventilate the room well and follow the instructions on the packaging.

60 Allow the primer to dry and then smooth with sandpaper grain no. 400.

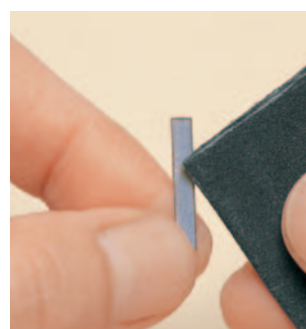

61 Spray metal primer evenly on pieces 1 and 3 from a distance of about 30cm. The operation will be simpler if you secure the piece on a base with double-sided adhesive tape.

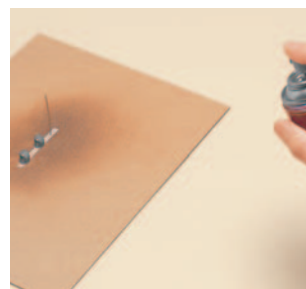

When using the metal primer, ventilate the room well and follow the instructions on the packaging.

62 Allow the metal primer to dry and spray a light and even coat of battleship grey, from a distance of about 30cm. Repeat several times and from different angles, allowing the paint to dry each time.

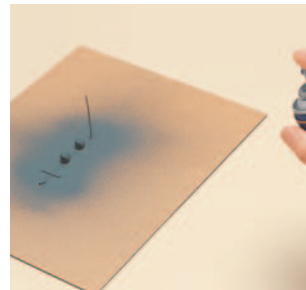

When using spray paint, ventilate the room well and follow the instructions on the packaging.

63 As shown in the photo, secure the pieces 1 with double-sided adhesive tape on a wooden board and paint the front cavities, mixing the two watercolours in the following proportions: one part matt black to two parts battleship grey.

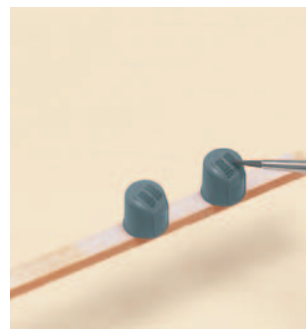

64 Fix pieces 1 to the base of the command bridge with fast-drying glue, as shown in the photo. The hollow parts of the pieces must face the opposite side of the ship.

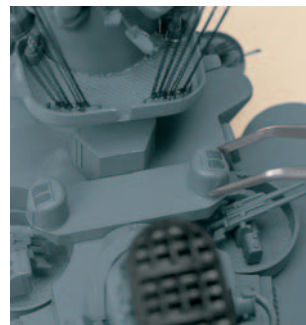

65 Checking against Step 68, fit piece 3 against the funnel, as shown in the photo. Make a pencil mark on the top and bottom edges of the area painted in black.

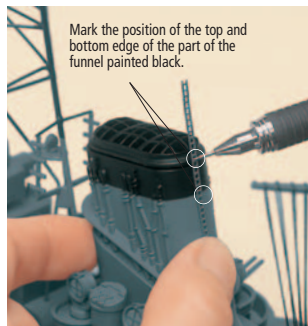

70 Remove the plan, place piece 2 on the mark and transfer the position of the rope around the bulwarks onto piece 2.

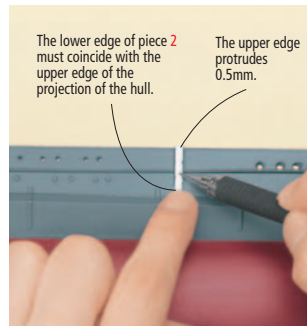

66 Take piece 3 and, with the pliers, cut the ladder on the mark corresponding to the upper edge of the funnel.



71 Place piece 2 on a flat surface and lightly scrape with the craft knife the part that touches the projection of the rope (where the sign is), forming a 'V'-shaped groove, 0.5mm deep.

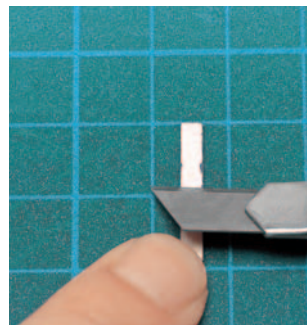

67 Take piece 3 as shown in the photo and paint the upper part with the matt black watercolour paint, starting from mark indicating the bottom edge of the funnel.



72 Smooth the groove made in Step 71 with the round metal file. Take care not to file too much.

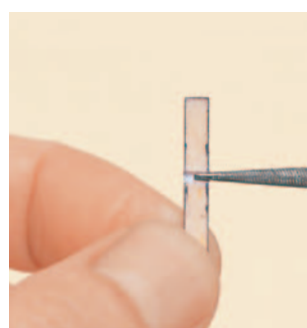

68 With fast-drying glue, fix piece 3 in the position shown in the photo.

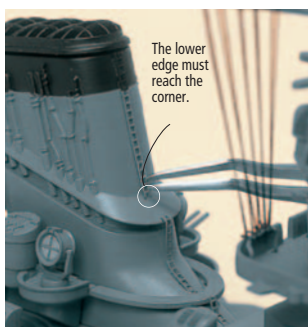

73 With fast-drying glue, fix piece 2 in the position indicated in Step 70.

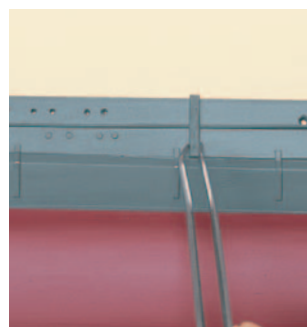

69 Take the hull so far assembled and rest the plan of the hull (port) on the port side, as shown in the photo. Hold the drawing firmly and mark the position of the left and right exhaust pipes with a pencil.

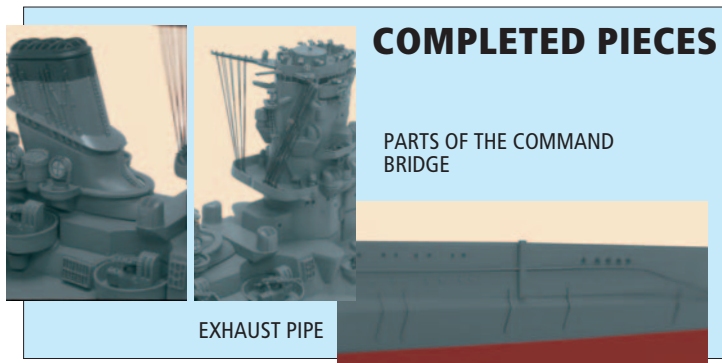
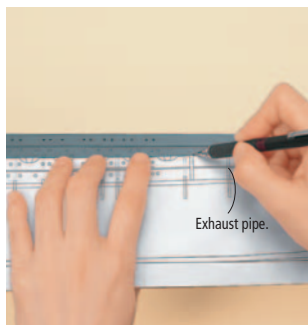



High-elevation firing mechanisms, machine-gun firing control mechanisms and parts of the command bridge

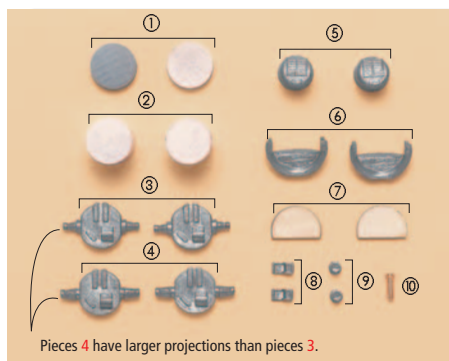
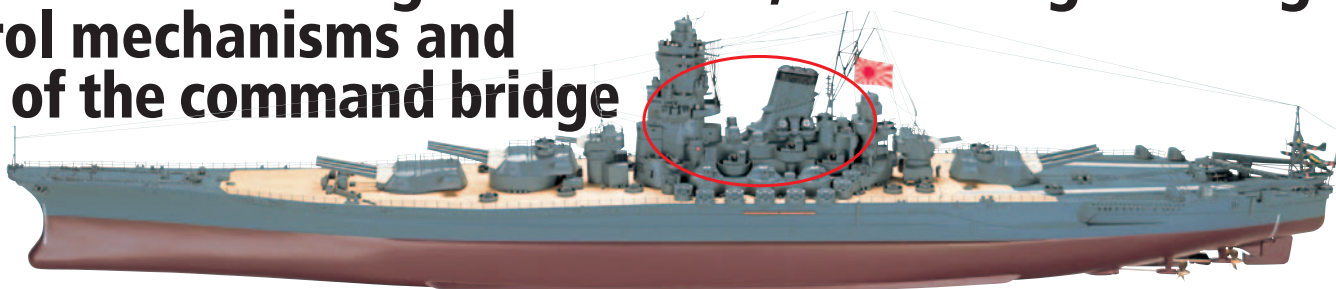

- ① Cylinder (small) x 2
- ② Cylinder (large) x 2
- ③ High-elevation firing mechanism (rear) x 2
- ④ High-elevation firing mechanism (front) x 2
- ⑤ Machine-gun firing control mechanism x 2
- ⑥ Base of machine-gun firing control mechanism x 2
- ⑦ Board x 2
- ⑧ Bulwark searchlight x 2
- ⑨ Compass x 2
- ⑩ Parts of the command bridge x 2

Pieces 4 have larger projections than pieces 3.

Recommended tools and materials

- Fast-drying glue
- Metal file
- Sandpaper (grain nos. 400 and 800)
- Putty
- Wooden spatula
- Craft knife
- Metal primer
- Paint primer
- Double-sided adhesive tape
- Spray paint (battleship grey and 800)
- Watercolour (matt white, matt black, battleship grey)
- Acrylic markers (red, green)

FIRING MECHANISM – PARTS OF THE BRIDGE

74 Remove any irregularities in shape of pieces 1 to 6 and 8 to 10 with the metal file. Where the file cannot reach, use the tip of the craft knife, being careful not to damage the surrounding parts.



75 Smooth the surfaces of pieces 1 to 6 and 8 to 10 with sandpaper grain no. 800, without altering the original shape.



76 Fill any cavities in the surface of the pieces with putty, using a wooden spatula. Once dried, remove irregularities with sandpaper grain no. 800.



77 Spray pieces 7 evenly with paint primer from a distance of about 30cm. The operation will be simpler if you secure the pieces to a base with double-sided adhesive tape. When the primer is dry, smooth the pieces with sandpaper grain no. 400.



⚠ When using paint primer, ventilate the room well and follow the instructions on the packaging.

78 Following Step 77, spray metal primer evenly on the pieces 1 to 6 and 8 to 10, from a distance of about 30cm.

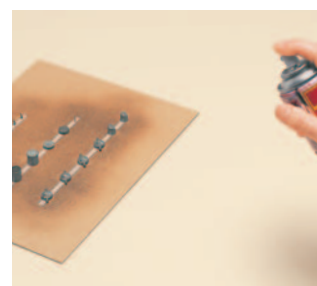

⚠ When using the metal primer, ventilate the room well and follow the instructions on the packaging.

79 When the metal primer is dry, spray a light and even coat of battleship grey on pieces 1 to 10 from a distance of about 30cm.

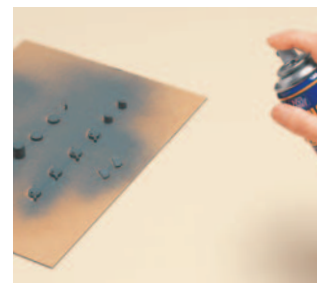

⚠ When using spray paint, ventilate the room well and follow the instructions on the packaging.

80 Repeat the operation several times from different angles, allowing the paint to dry each time.

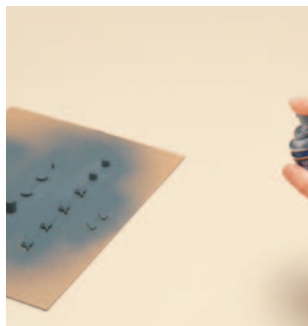

81 Secure pieces **4** to a rod with double-sided adhesive tape and paint cavities in the protruding parts with matt white watercolour, as shown in the photo.

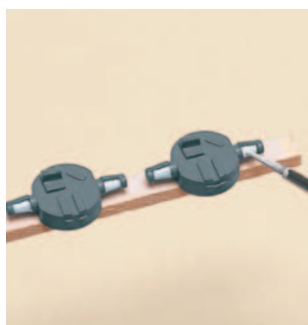

82 Secure pieces **8** to a rod with double-sided tape, and paint the cavities with the matt white watercolour.

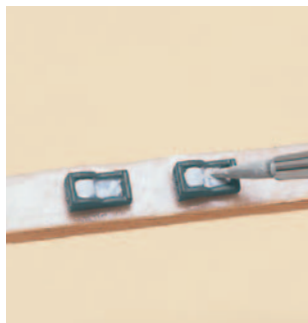

83 With acrylic markers, colour the cavities of pieces **8**, one red and one green. If you prefer, you can use red and green watercolours.

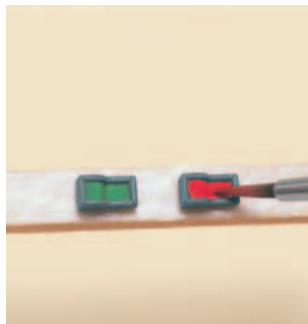

84 Secure pieces **5** to a rod with double-sided tape, and, mixing equal quantities of battleship grey and matt black watercolours, paint the cavities.

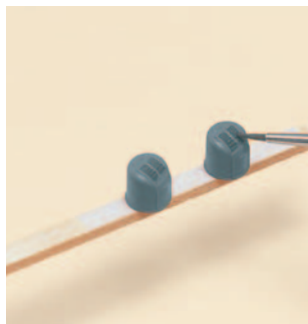

85 Take the command bridge so far assembled and fix piece **10** in the position shown in the photo, using fast-drying glue. Apply glue to the small projection of piece **10** and insert the projection into the hole of the command bridge.

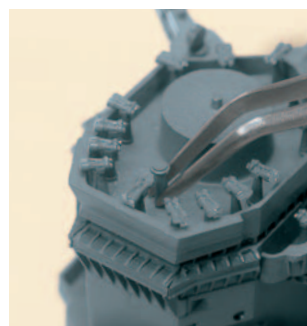

86 With fast-drying glue, fix a piece **9** in position on the command bridge (photo, right). Turn the flat side of the piece towards the bulwarks, and fit the outer edge to the edge of the command bridge. Fix the other piece **9** in the same position on the opposite side.

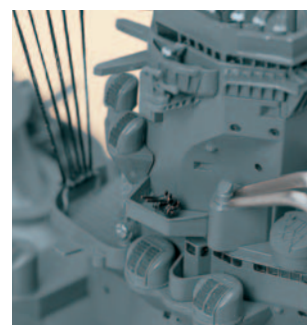

87 With fast-drying glue, fix the pieces **4** on the upper surface of pieces **1**.



88 Position one of the pieces obtained in Step 87, as shown in the photo, and, with fast-drying glue, fix piece **8** previously painted red to the front. The wider edge of piece **8** should be on the right. You have made the port high-elevation firing mechanism (front).

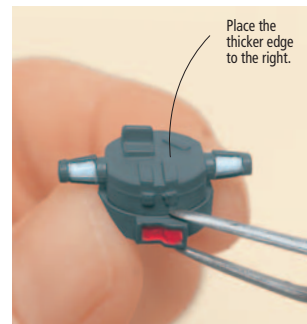

89 Following Step 88, fix the green piece **8** to the other piece made in Step 87. The wider edge of piece **8** should be facing left. You have made the starboard high-elevation firing mechanism (front).

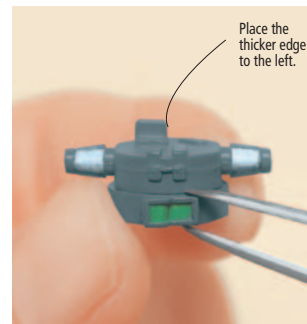

90 Take the port high-elevation firing mechanism (front) and fix to the port side of the base of the command bridge with fast-drying glue, as shown in the photo. Align the outer edge of the mechanism with the edge of the command bridge.



91 Following Step 90, fix the starboard high-elevation firing mechanism (front) to the starboard side of the base of the command bridge with fast-drying glue.



92 On the tops of the pieces **2**, fix the pieces **3** with fast-drying glue. You have made the high-elevation firing mechanism (back).



95 Taking pieces **6**, as shown in the photo, and fix them to pieces **7**. If pieces **7** do not fit easily, adjust with sandpaper grain no. 400.



96 With fast-drying glue, fix piece **5** in the centre of the upper surface of the piece made in Step 95, as shown in the photo. You have made the machine-gun firing control mechanism. Make another.



97 Fix the machine-gun firing control mechanism on the starboard side of the base of the command bridge using fast-drying glue, in the position shown in the photo and Figure B.

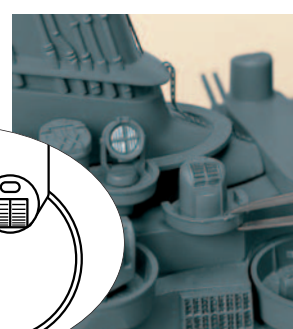
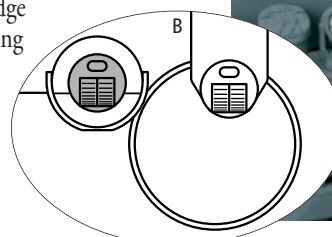

93 With fast-drying glue, fix one of the high-elevation firing mechanisms (back) on the starboard side of the base of the command bridge, in the position shown in the photo and Figure A.

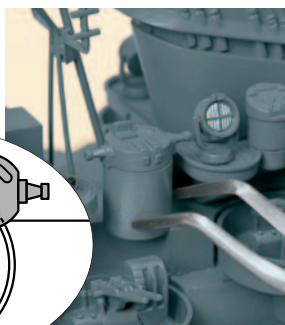
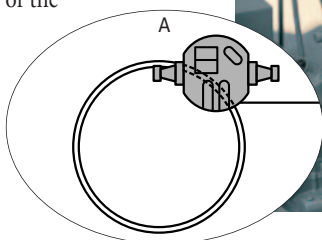

98 Following Step 97, fix the second machine-gun firing control mechanism on the port side of the base of the command bridge, in the position shown in the photo. Position the piece symmetrically opposite the one fixed in Step 97.



94 Following Step 93, fix the second high-elevation firing mechanism (back) on the port side of the base of the command bridge in the position shown in the photo. Mount it symmetrically opposite to the starboard side mechanism.



COMPLETED PIECES

HIGH-ELEVATION FIRING MECHANISMS AND MACHINE-GUN FIRING CONTROL MECHANISMS

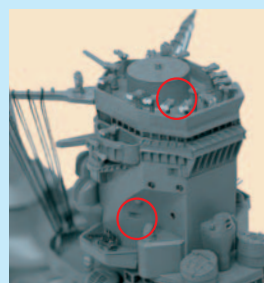

PARTS OF THE COMMAND BRIDGE

