

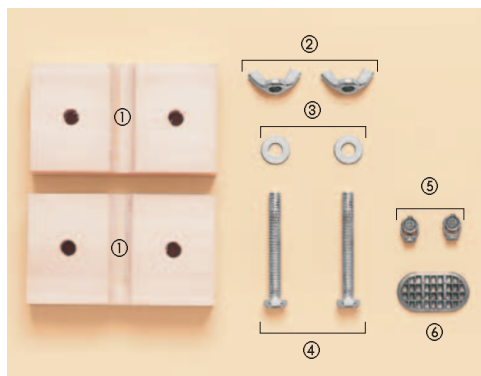

Top of the funnel, searchlights and the hull

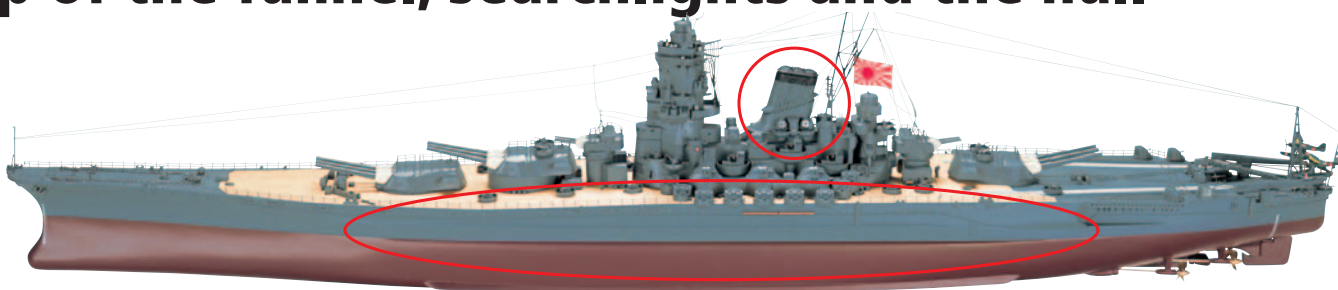

- ① Auxiliary support x 2
- ② Wing nuts for auxiliary support x 2
- ③ Washers for auxiliary support x 2
- ④ Bolts for auxiliary support x 2
- ⑤ Searchlights x 2
- ⑥ Top of the funnel

Recommended tools and materials

- Fast-drying metal glue
- Metal file
- Sandpaper (grain no. 800)
- Putty
- Wooden spatula
- Craft knife
- Double-sided adhesive tape
- Pencil
- Masking tape
- Metal primer
- Paint primer
- Spray paint (battleship grey, maroon red for the bottom of the hull)
- Watercolour (matt black, silver, battleship grey)
- A4 paper

TOP OF THE FUNNEL AND SEARCHLIGHTS

1 Remove any irregularities in pieces 5 and 6 with the metal file. Smooth with sandpaper grain no. 800, taking care not to alter the original shape.



2 If there are any holes or hollows on the surface, correct them by applying putty with a wooden spatula.

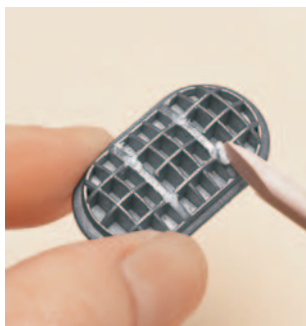

3 When the putty is completely dry, smooth with sandpaper grain no. 800. Clear any residue from the mesh of piece 6, using the blade of the craft knife, as shown in the photo.



4 Spray the metal primer on pieces 5 and 6, from a distance of about 30cm. The operation will be simpler if you place the pieces on a base and secure them with double-sided adhesive tape, as shown in the photo.

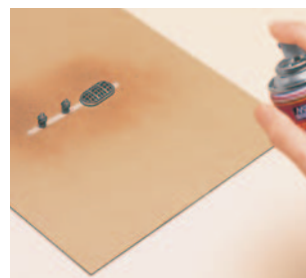

⚠ When using metal primer, ventilate the room well and follow the instructions on the packaging.

5 Allow the primer to dry thoroughly. Apply a light and even coat of battleship grey spray paint from a distance of about 30cm. Repeat several times from different angles, allowing the paint to dry between coats.

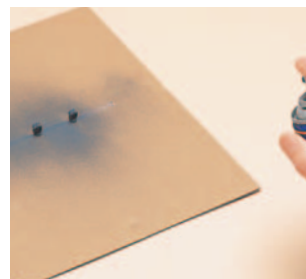

⚠ When using spray paint, ventilate the room well and follow the instructions on the packaging.

6 Paint piece 6 with matt black watercolour. Paint the inside of the mesh and a 3mm rim around the edge of the back of the piece, as shown in the photos.



7 Allow the paint to dry. Take the funnel assembled earlier, and fix piece **6** in place with fast-drying metal glue, as shown in the photo.



8 Referring to the photos, fix pieces **5** to a rod with double-sided adhesive tape and paint the front of the pieces with silver watercolour. Allow to dry, then paint the two cross bars with battleship grey, as shown in the photo (right, below).

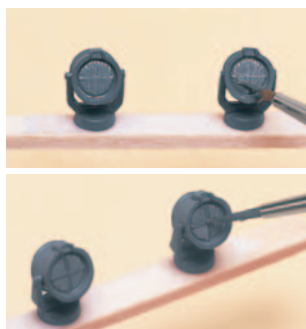

12 Place the hull on a flat surface, as shown in the photo, and hold the tool at the middle of the hull. The tip of the pencil must coincide with the concave line of the hull: if not, take apart the tool and trim the pencil hole (Fig. A). Tighten up the tool and check again.

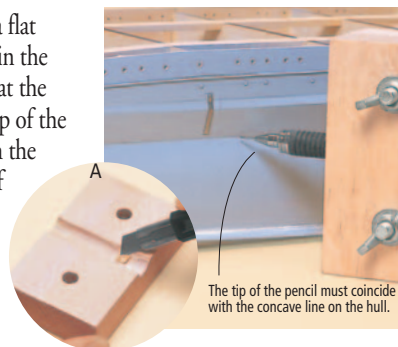

13 Hold the tool on the flat surface and trace the waterline all around the hull. Begin from the centre and trace the line towards the bow or towards the stern.

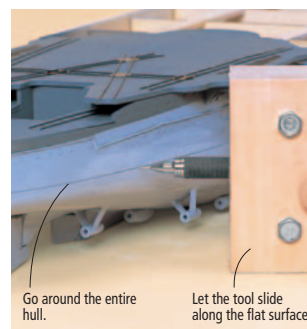

THE HULL

9 Take the hull already assembled and remove the propellers. Check for any irregularities and cracks and correct them with putty. When the putty is dry, smooth with sandpaper grain no. 800.

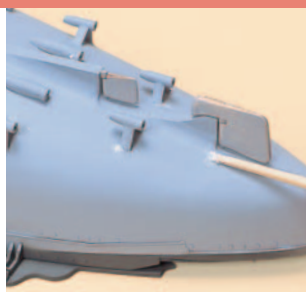

10 Spray the stern rudder and the hull with paint primer. When dry, smooth with sandpaper grain no. 800, removing the dust with a soft cloth.



! When using paint primer, ventilate the room well and follow the instructions on the packaging.

11 Join pieces **1**, as shown in the photo (top right), and insert bolts **4** into the two holes. On the opposite side, insert the washers **3** and then the wing nuts **2**. Tighten the bolts to approximately 80 per cent, then insert the pencil into the hole, as shown in the photo (bottom right), and tighten again. You have now assembled the tool to draw the waterline.

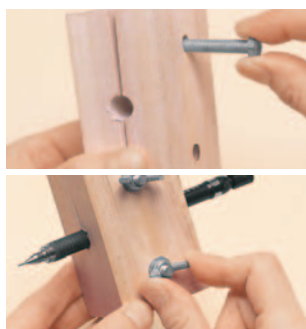

14 Fix a piece of masking tape above the waterline. The lower edge of the tape should coincide with the waterline. Keep the tape in one piece to prevent paint from seeping between any joints.

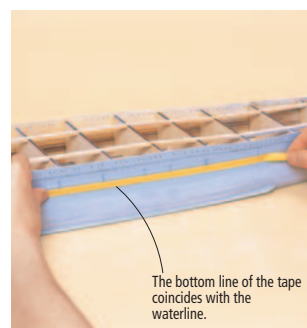

15 At the bow, angle the tape upwards slightly, so that it is 1mm above the waterline. Fix the tape on the opposite side.

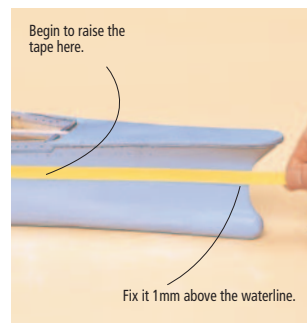

16 Following Step 15, fix the tape along the port side. In the stern area, slightly raise the tape between the tip of the hangar and the stern. At the tip of the stern the tape should be 0.5mm above the waterline.

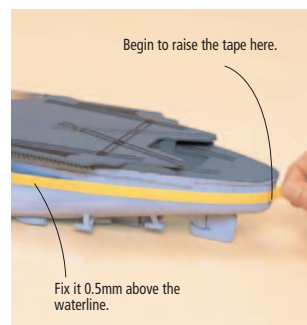

17 Press the tape down firmly with the tip of a wooden spatula, so that the paint cannot penetrate underneath.



22 Paint the part of the ship above the waterline. Following the instructions in Steps 14 to 17, fix masking tape along the bottom edge of the waterline.

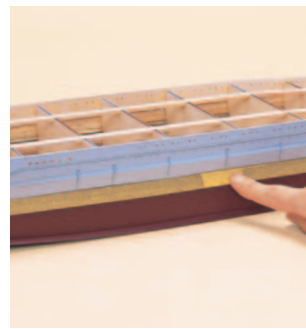

18 Fix masking tape over the join of the two pieces of paper.

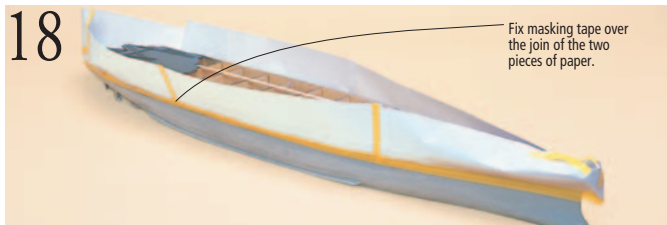

Cut a sheet of A4 paper into 10cm-wide strips. Using masking tape, fix the paper along the upper edge of the waterline, as shown in the photo. Take care not to leave gaps between the paper and the tape.



Following the instructions in Steps 18 and 19, cover the bottom area of the ship with strips of 10cm-wide A4 paper and seal with masking tape.



As shown in the photo, fold the top of the paper to cover the upper half of the ship, and fix with masking tape. Add more pieces of paper if there are any areas left uncovered.

24 Spray the battleship grey paint, following the instructions in Step 21. When it is completely dry, remove the masking tape and covering paper.



20 Invert the hull, and place it on a flat surface to paint the bottom of the ship with the colour suggested in the colour chart provided in Despatch 14. Beginning at the stern, spray evenly from different directions. Paint the rudder and propeller shaft brackets, too.

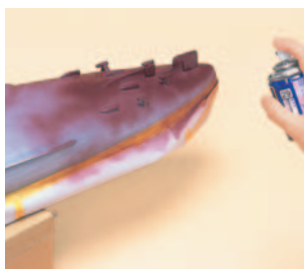

! When using spray paint, ventilate the room well and follow the instructions on the packaging. Since the paint may splash around, it is advisable to work outdoors if possible.

25 Any imperfections can be corrected by painting with a thin-tipped brush. Spray the paint on a separate piece of cardboard and take a small amount on the brush. Re-assemble the propellers and insert them in their correct position, referring to the photo (bottom, right).

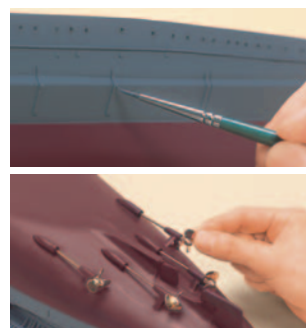

21 Spray the entire bottom of the ship. Ensure the coverage is light and even, so that the paint does not drip. Give several coats. When the paint is dry, remove the masking tape and paper.

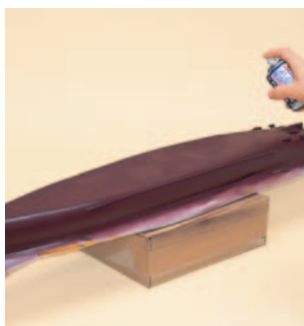

COMPLETED PIECES

SEARCHLIGHTS



TOP OF THE FUNNEL



HULL

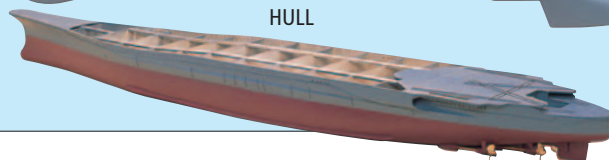



Rear command bridge, searchlights and command bridge

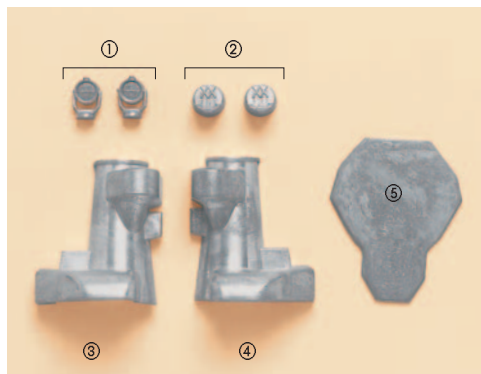
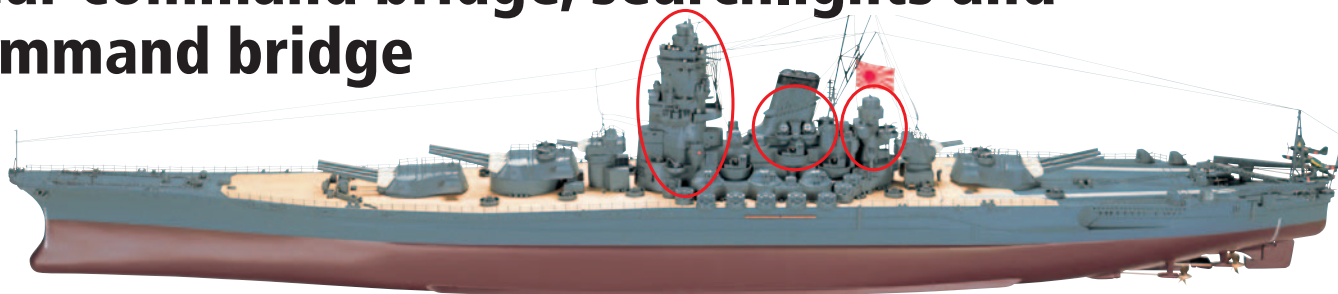

- ① Searchlights x 2
- ② Machine-gun firing mechanism x 2
- ③ Rear command bridge (starboard side)
- ④ Rear command bridge (port side)
- ⑤ Command bridge adjustment plate

Recommended tools and materials

- Fast-drying metal glue
- Metal file
- Sandpaper (grain no. 800)
- Putty
- Craft knife
- Wooden spatula
- Double-sided adhesive tape
- Metal primer
- Spray paint (battleship grey)
- Watercolour (silver, battleship grey)

REAR COMMAND BRIDGE AND SEARCHLIGHTS

26 Join pieces **3** and **4**, as shown in the photo, and fix them with metal glue. You have now prepared the rear command bridge.



29 Using a wooden spatula, fill the join between pieces **3** and **4** with putty, then fill any holes or hollows on the surface of the piece.



27 With the metal file, eliminate any irregularities in shape. Where the file cannot reach, use the tip of the craft knife, being careful not to damage the surrounding parts.



30 Allow the putty to dry, and remove any excess with sandpaper grain no. 800. Use the metal file to eliminate any irregularities in the shape of pieces **1** and **2**.

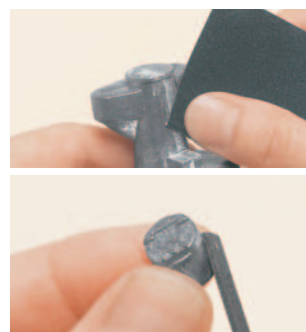

28 Smooth the surface of the rear command bridge with sandpaper grain no. 800. Take care not to alter the original shape.



31 Where the metal file cannot reach, use the tip of the craft knife, taking care not to damage the surrounding parts. Then, smooth with sandpaper grain no. 800.



32 Correct any grooves or hollows in the pieces **1** and **2**, using putty applied with the wooden spatula. Once dry, remove the excess putty using sandpaper grain no. 800.



37 Place the piece so far assembled, as shown in the photo. Using fast-drying metal glue, fix a piece **2**, with the stamped side facing outwards, over the round support to port, in the middle of the base of the funnel.



33 Spray the rear command bridge and pieces **1** and **2** with metal primer, evenly and from a distance of about 30cm. As shown in the photo, it is easier if you secure the bottom of the pieces on cardboard with double-sided adhesive tape.



⚠ When using metal primer, ventilate the room well and follow the instructions on the packaging.

38 To the left of the piece **2**, fix a piece **1** with metal glue (Figure A of Step 39).



34 From a distance of about 30cm, spray the rear command bridge and pieces **1** and **2** with a light and even coat of battleship grey. When the paint is dry, repeat the operation from various angles.

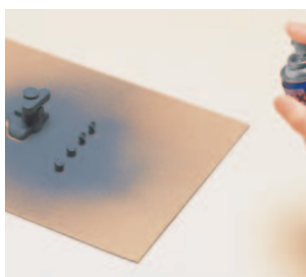

⚠ When using spray paint, ventilate the room well and follow the instructions on the packaging.

39 Following the same procedure, fix the remaining piece **1** on the right of piece **2**.

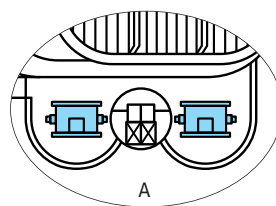

35 Referring to the photo, fix pieces **1** to a wooden rod with double-sided adhesive tape. Paint the front of the pieces with silver watercolour. Allow to dry, then paint the two crossbars with battleship grey watercolour.

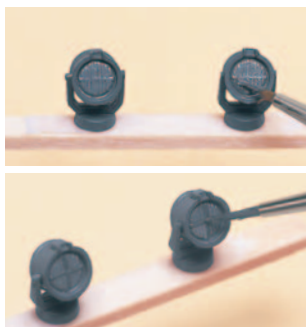

40 Following the procedure in Step 37, fix a piece **2** on the round port support in the middle of the base of the funnel.



36 As shown in the photo, join the funnel and the base of the funnel, prepared in previous phases of assembly. Fix with fast-drying metal glue.



41 Following the procedure in Steps 38 and 39, fix the searchlights built in the previous stage of assembly to the left and right of piece **2**.



COMMAND BRIDGE

42 Set the command bridge on its base, as shown in the photo, without applying any glue. If there is a gap, as shown in Figure B, follow the steps below.

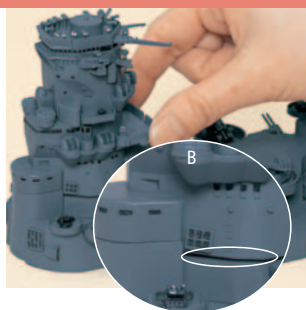

43 Without applying fast-drying glue, place piece 5 on the base of the command bridge, as shown in the photo.



44 Place the command bridge on piece 5. If the tower does not fit the command bridge because of the thickness of piece 5, adjust it by filing.

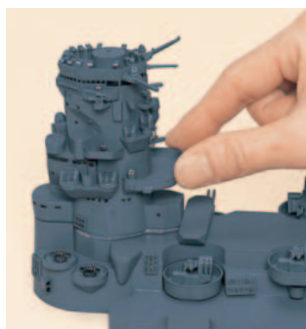

45 The base of the command bridge is curved, so use the metal file only on the surface of one side of piece 5, leaving 3mm around the edge of the piece.



46 When the correct fit has been obtained for the base of the command bridge, fix piece 5 to the surface of the base of the command bridge with fast-drying metal glue, as shown in the photo.

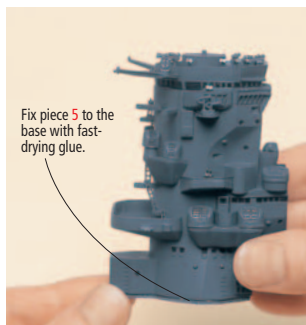

47 Apply putty to fill the gap between piece 5 and the command bridge. Push the putty inside the gaps with the wooden spatula.

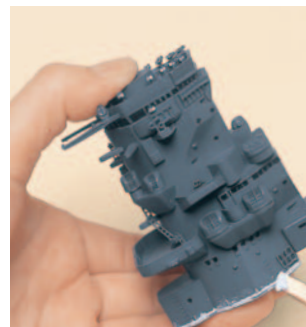

48 Allow to dry, and remove the excess putty using sandpaper grain no. 800. Take care not to scratch the adjacent parts.



49 With a cloth, remove the dust caused by sanding, and paint the putty and piece 5 with battleship grey watercolour.



50 When the paint is completely dry, fix the command bridge to the base of the command bridge with fast-drying metal glue.



COMPLETED PIECES

REAR COMMAND BRIDGE



SEARCHLIGHTS



COMMAND BRIDGE

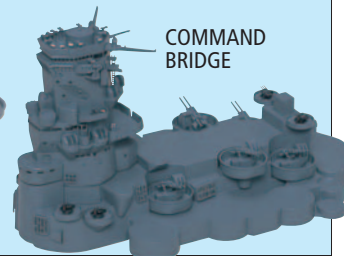



Rangefinding radar and main guns firing control post

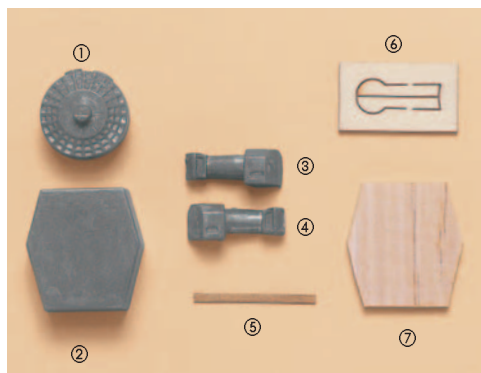
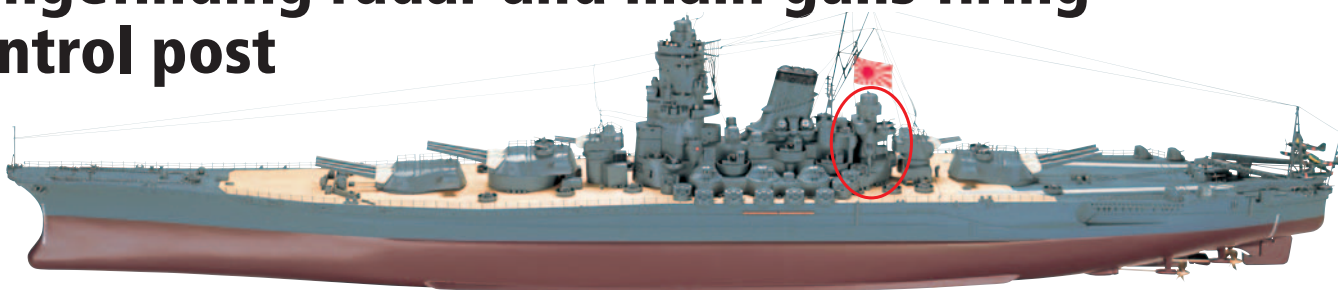

- ① Main guns firing control post
- ② Base
- ③ Rangefinding radar (port)
- ④ Rangefinding radar (starboard)
- ⑤ Metal sheet
- ⑥ Wooden board
- ⑦ Bottom board for the main guns firing control post

Recommended tools and materials

- Fast-drying glue
- Metal file
- Sandpaper (grain nos. 400, 800)
- Putty
- Wooden spatula
- Craft knife
- Long-nosed pliers
- Double-sided adhesive tape
- Metal primer
- Paint primer
- Spray paint (battleship grey)
- Watercolour (battleship grey, matt black, silver)

RANGEFINDER RADAR AND MAIN GUNS FIRING CONTROL POST

51 Smooth the pieces 1 to 4 with the metal file to remove any irregularities in shape.



54 Allow to dry thoroughly, and remove any excess putty using sandpaper grain no. 800.



52 Where the metal file cannot reach, use the blade of the craft knife, being careful not to damage other parts of the pieces. Smooth with sandpaper grain no. 800.

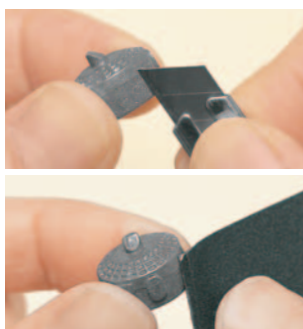

55 Detach the two pieces 6 from the wooden board, using the tip of the craft knife. Smooth the edges of the pieces with sandpaper grain no. 400.

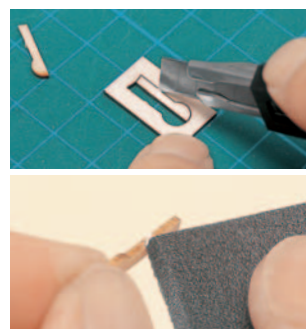

53 Correct any holes or hollows in the surface of the pieces by applying putty. Use a wooden spatula to push the putty to the bottom of the cavities.



56 Apply fast-drying glue to the edges of piece 7 and fix to the underside of piece 2. Piece 7 should fit completely inside piece 2, forming a flat surface. If it does not fit properly, smooth the edges of piece 7 until it fits, as shown in Figure A.

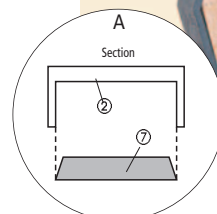
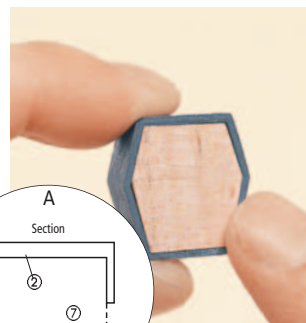

💡 According to recent research, the top of piece 1 was smooth, not ridged. You can make the surface completely flat using putty.

57 Hold piece **2**, as shown in the photo, and, with fast-drying glue, fix pieces **3** and **4** on either side (Figure B). Adjust the position of pieces **3** and **4**, aligning the bottom edge with the corner of piece **2** and the top side with the upper slanted side.

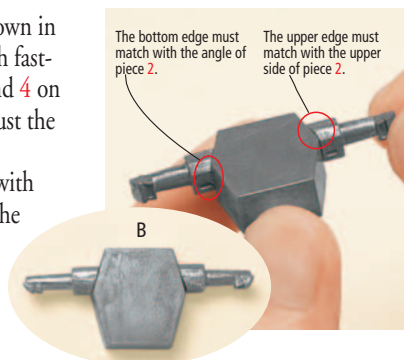

58 Cut piece **5** in half using the long-nosed pliers.



59 Bend one of pieces **5** at a right angle, 1mm from the end (Figure C). Do the same with the other piece **5**.

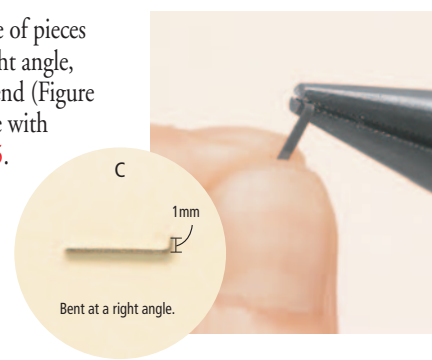

60 Place a piece **6** on a flat surface, as shown in the photo, and fix a piece of **5** with fast-drying glue. Match the angle of piece **5** with the edge of piece **6**. Assemble the other piece symmetrically (Figure D). You have now made the bases of the rangefinding radar.

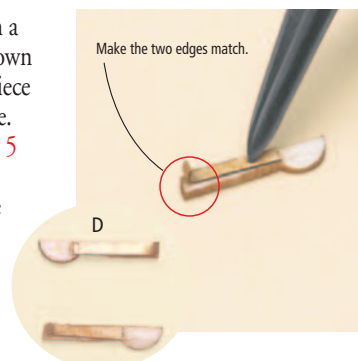

61 Now spray the bases of the rangefinding radar evenly with paint primer, from a distance of about 30cm. The operation will be simpler if you secure the bases on cardboard with double-sided adhesive tape, as shown in the photo.



! When using paint primer, ventilate the room well and follow the instructions on the packaging.

62 Take the part so far assembled in Step 57, as shown in the photo. With fast-drying glue, fix the bases of the rangefinding radar on both sides of the part. The bottom edge of the pieces must match the angle of piece **2**, and the top should align with the underside of pieces **3** and **4**.

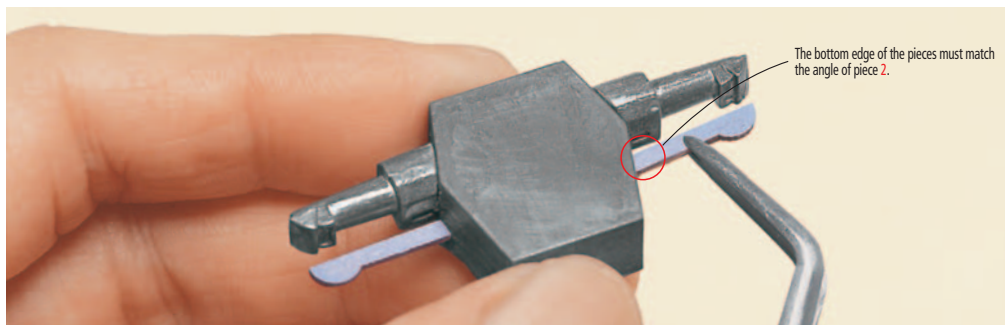

63 Take the piece so far assembled, as shown in the photo. With fast-drying glue, fix piece **1** to the centre of piece **2**. The main guns firing control post is now ready.



64 Lightly spray the part assembled in Step 63 with metal primer, from a distance of about 30cm.



⚠ When using metal primer, ventilate the room well and follow the instructions on the packaging.

65 Allow the metal primer to dry, and apply a light and even coat of battleship grey paint, from a distance of about 30cm. Repeat the procedure several times from different angles, allowing the paint to dry between each coat.

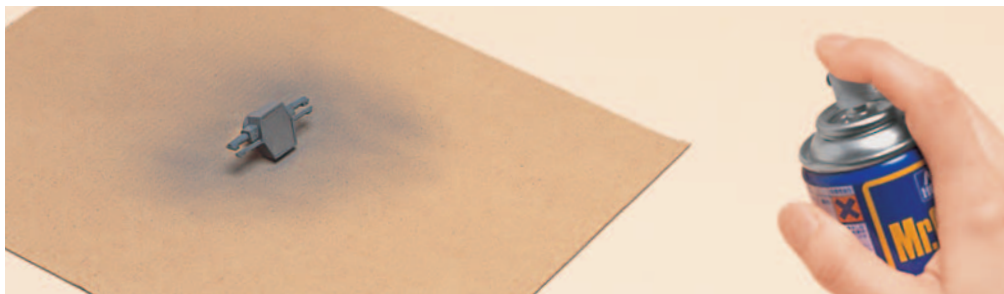

⚠ When using spray paint, ventilate the room well and follow the instructions on the packaging.

66 Take the main guns firing control post, as shown in the photo. Paint the internal cavities of pieces 3 and 4 with a mixture of equal parts of the two watercolours (battleship grey and matt black). Take care not to let the paint go beyond the cavities.



67 Similarly, paint the cavities at the tip of pieces 3 and 4 with the silver watercolour.



68 Take the rear command bridge assembled in Steps 26–34. With fast-drying glue, fix the main guns firing control post. Piece 1 should be positioned to look like an extension of the cylinder of the rear command bridge, as shown in the photo.



COMPLETED PIECES

RANGEFINDING
RADAR

MAIN GUNS FIRING
CONTROL POST

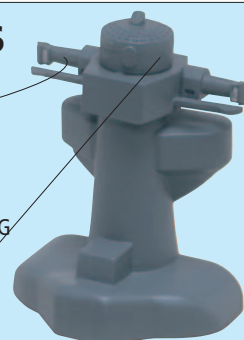



Components of the rear command bridge

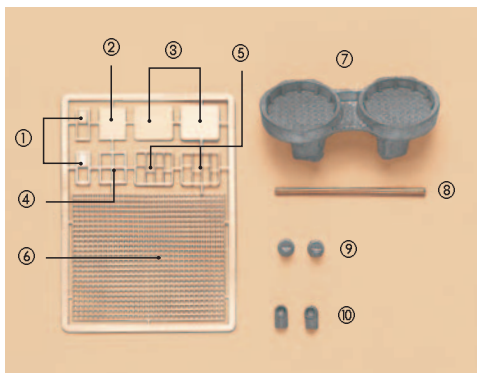
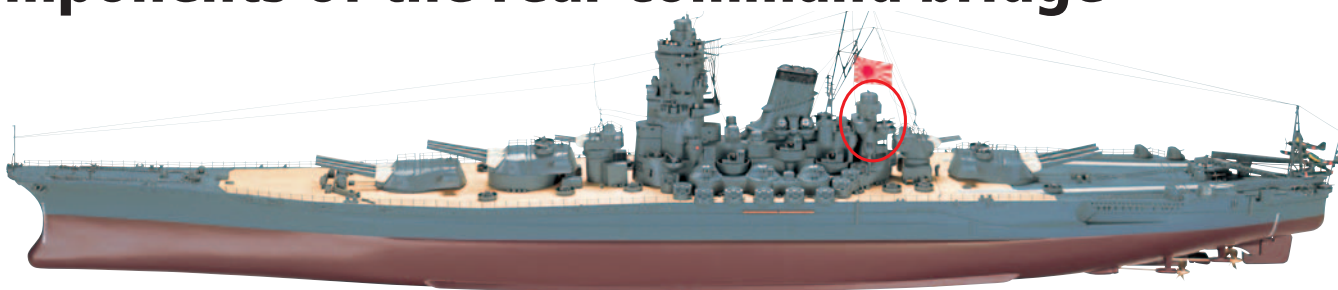

- ① Finishing board x 2
- ② Finishing board
- ③ Finishing board x 2
- ④ Finishing board
- ⑤ Finishing board x 2
- ⑥ Finishing board
- ⑦ Base of rear command bridge machine-guns
- ⑧ Metal rod
- ⑨ Components of the rear command bridge x 2
- ⑩ Components of the rear command bridge x 2

Recommended tools and materials

- Fast-drying glue
- Metal file
- Sandpaper (grain no. 800)
- Putty
- Craft knife
- Long-nosed pliers
- Pliers
- Double-sided adhesive tape
- Metal primer
- Spray paint (battleship grey)
- Watercolours (battleship grey, matt black)

COMPONENTS OF THE REAR COMMAND BRIDGE

69 Detach pieces 1 to 6 from the frame by running the craft knife along the joints.

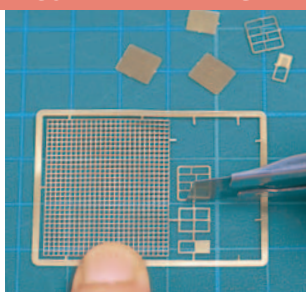

72 With fast-drying glue, fix the 5mm x 6.5mm rectangle to one side of piece 2, and the two large rectangles on one side of each of the two pieces 3. To prevent the fast-drying glue filling the holes in the mesh, apply the glue with the tip of the craft knife, applying a small amount to the edges only.

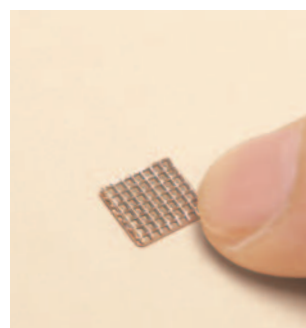

70 With the metal file, smooth the edges of pieces 1 to 6.

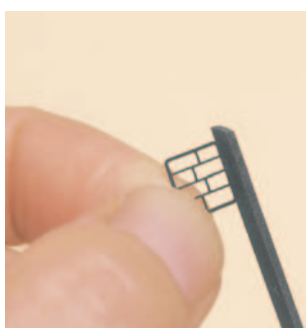

73 On each of pieces 6 fixed in Step 72, fix the respective pieces 4 and 5 with fast-drying glue. Take care with the orientation of pieces 5, ensuring they are positioned accurately. The component on which piece 4 is mounted is the central ventilation vent, while parts 5 are the lateral vents.

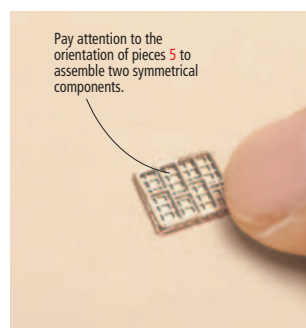

71 With the craft knife, cut piece 6 to obtain a rectangle, 5mm x 6.5mm and two rectangular pieces 7mm x 8mm.

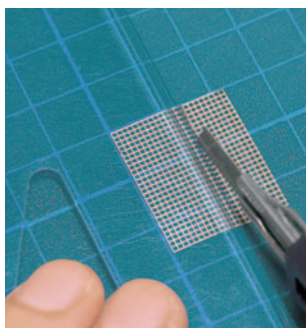

74 On each of the vents, file the protruding edges of pieces 4 and 5 with the metal file.

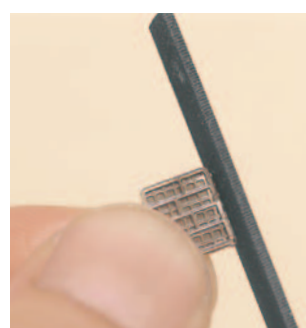

75 Apply putty to the edges of each vent, using a wooden spatula. Take care not to get putty on the other parts of the piece. Allow the putty to dry, and smooth with sandpaper grain no. 800.

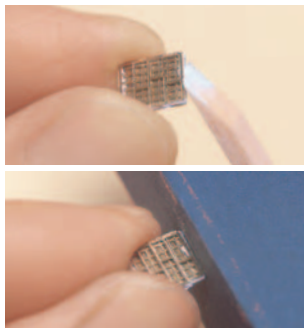

76 Use the metal file to remove any irregularities in the shape of piece 7. Where the metal file cannot reach, use the tip of the craft knife, taking care not to damage the surrounding parts.

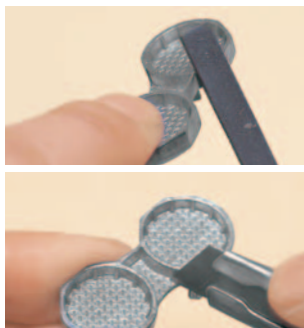

77 After removing the irregularities and unwanted protrusions, smooth the surfaces of piece 7 with sandpaper grain no. 800, taking care not to damage the original shape.



78 Correct any holes or hollows in the surface of piece 7 with putty, using the wooden spatula. Allow the putty to dry and remove any excess with sandpaper grain no. 800.



79 Take the command bridge assembled earlier, and, checking against Step 86, place piece 7 in the desired position. If it does not fit, file piece 7 so that it fits exactly.



80 Following the procedure described in Steps 76 to 78, adjust the shape of pieces 9 and 10.

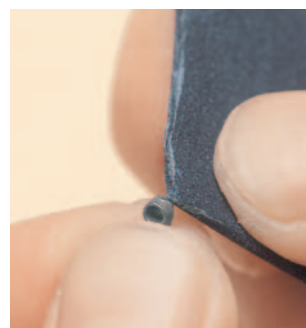

81 With long-nosed pliers, cut piece 8 into two sections, each 12mm in length. The operation will be simpler if you cut the sections slightly longer and file them to length with the metal file.



82 Turn over piece 7 and, as shown in the photo, fix each of the sections of piece 8 into the holes with fast-drying glue. Ensure the sections of metal rod are vertical. You have made the base of the machine-guns of the rear command bridge.

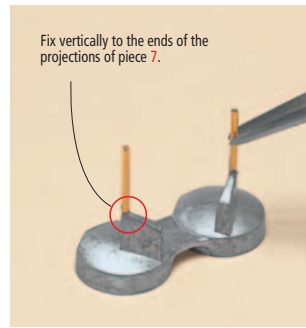

83 Spray a thin coat of metal primer from a distance of about 30cm on each vent, on the base of the machine-guns of the rear command bridge and on pieces 1, 9 and 10. It is easier if you secure the parts to a cardboard base with double-sided adhesive tape.

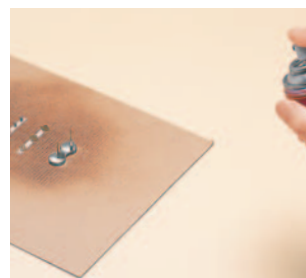

⚠ When using metal primer, ventilate the room well and follow the instructions on the packaging.

84 Allow the paint to dry, and, from a distance of about 30cm, spray a thin coat of battleship grey. Repeat this procedure several times, changing angle each time.

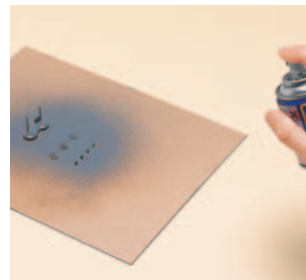

⚠ When using spray paint, ventilate the room well and follow the instructions on the packaging.

85 Allow the spray paint to dry, then paint the cavities of pieces **4** and **5** with an equal mix of battleship grey and matt black watercolour. Take care not to spread paint beyond the cavities.



90 Fix the front vent to the point of the rear command bridge, as shown in the photo, using fast-drying glue.



86 With fast-drying glue, fix the base of the guns made in Step 82 to the rear command bridge. Glue piece **7** next to the command bridge, ensuring that pieces **8** are vertical. Use the tip of the craft knife to apply glue to the bottoms of the pieces.



91 Fix the lateral vents to the rear command bridge in the position shown in the photo, using fast-drying glue. Pieces **5** should be positioned carefully, so they are symmetrical.

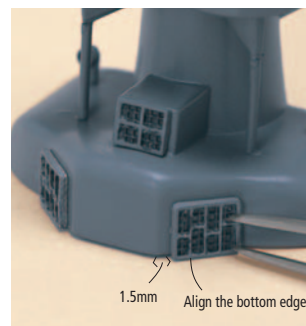

87 Using fast-drying glue, fix one of the parts of piece **1** (Figure A) into the points of the rear command bridge shown in the photo.

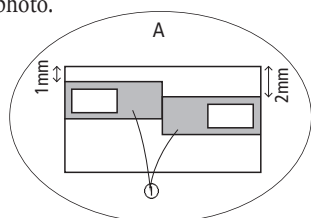

92 Take two sets of machine-guns previously assembled and cut off the protrusions on the base using the pliers. Smooth the edge with the metal file.

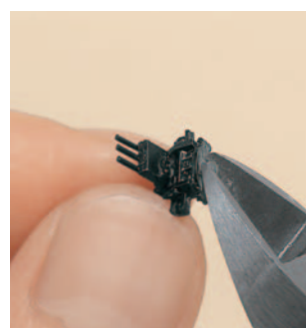

88 Using fast-drying glue, fix a part of piece **9** (Figure B) to the part of the rear command bridge indicated in the photo. Turn the flat side of piece **9** towards the sides of the rear command bridge.

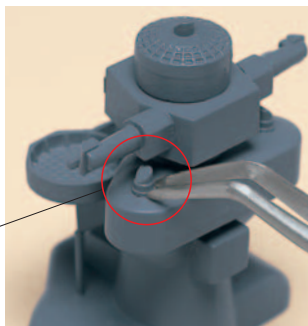
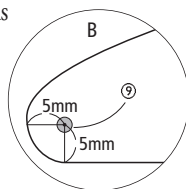

93 At the centre of the bases of the rear command bridge machine-guns, fix the machine-guns prepared in Step 92. The machine-guns can be oriented as you like, but it is recommended that you turn them to face the sides.



89 Using fast-drying glue, fix a part of piece **10** (Figure C) to the part of the rear command bridge, as shown in the photo. Turn the side of piece **10** so that the hole is facing forwards.

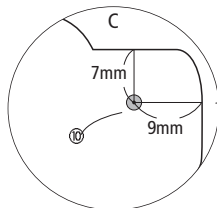

COMPLETED PIECES

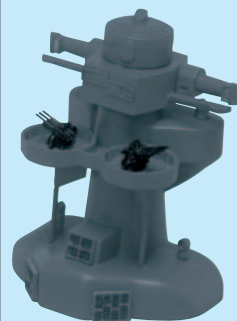

COMPONENTS OF THE REAR
COMMAND BRIDGE