

## The hull and the bridge

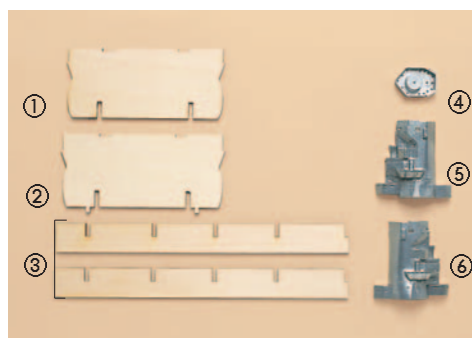
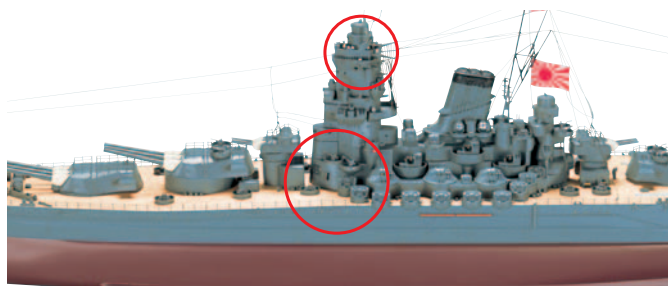

- ① Frame no. 7
- ② Frame no. 8
- ③ Keel of the main body  
(2 pieces)
- ④ Anti-aircraft command post
- ⑤ Bridge (right)
- ⑥ Bridge (left)

1 Take the keel (3) and apply PVA wood glue in the second slot from the left: a toothpick may make it easier. **Take care: the left end is the one that has a projection.**

### THE HULL

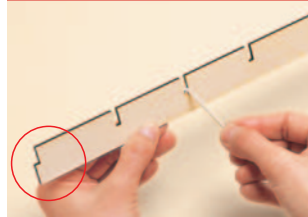

### Recommended tools and materials

- PVA wood glue
- Set square
- Sandpaper (grain no. 800)
- Metal file
- Craft knife
- Brush (small)
- For metal: Super Glue Gel or Two-part epoxy glue
- Putty
- Toothbrush
- Toothpick
- Model-making spray paint (battleship grey)
- Model-making watercolour (matt black)
- Metal primer (spray)

2 Place frame no. 7 (1) in the slot where you applied the glue, pushing it down all the way and making sure it is securely fitted. Set the angle between the frame and the keel at 90 degrees with the help of the set square.

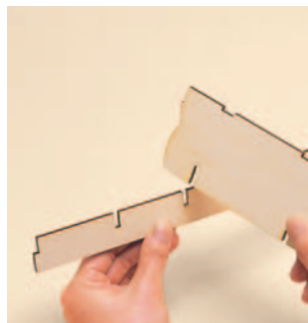

3 After applying PVA wood glue, insert frame no. 7 (1) into the second slot of the other keel (3), as shown in the photo, keeping the projections in the same direction. Set the angle between the frame and the keel at 90 degrees with the help of the set square.

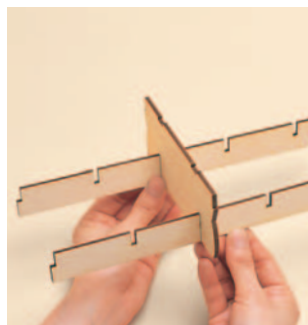

4 Apply glue to the third pair of slots (starting from the left) of the two keels (3). Insert the two slots of frame no. 8 (2). Before the glue dries, set the angle between the frame and the keel at 90 degrees with the help of the set square.

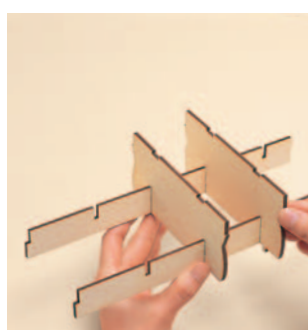

5 Take pieces no. 5 and no. 6 and, with a metal file, remove the burrs on the edges to be glued. Make sure that you do not remove the projection on piece no. 5. By placing it on a smooth table, as shown in the photo, you will notice irregularities better.

### THE BRIDGE

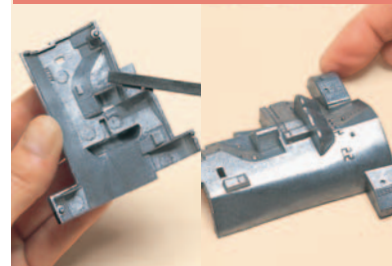

6 Smooth any irregularities on the surface of the two bridge parts (nos. 5 and 6) with the metal file. Rub gently, so that the file does not leave marks on the surface.

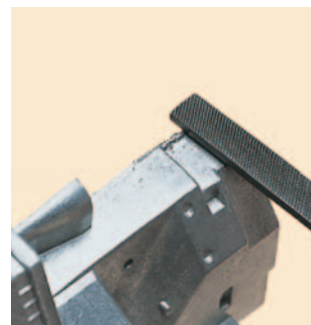

7 Smooth the entire surface of the bridge sections with grain no. 800 sandpaper, being careful not to damage the original details such as the windows.

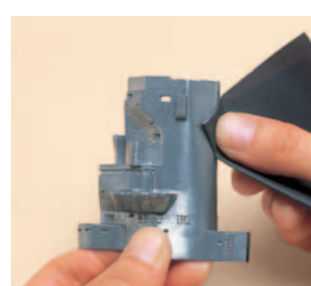

**8** Carefully smooth the edges of the concave parts, the projections and corners, using the sandpaper folded at an angle. By doing this well, the finish will look better.

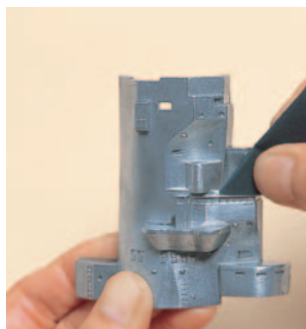

**9** To eliminate irregularities where it is difficult to insert the sandpaper, use the tip of the craft knife. After you have sanded the pieces, remove all the metal dust, if necessary with a toothbrush.

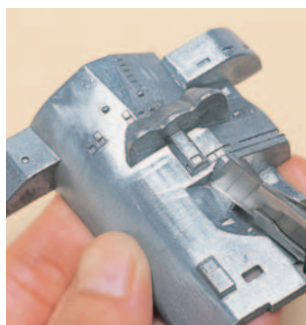

**10** To glue pieces no. **5** and no. **6**, apply metal glue on the edge of the back of bridge no. **5**. Apply it drop by drop at intervals to avoid forming drips.

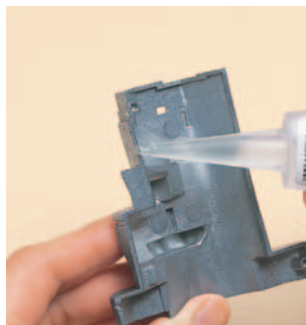

**11** Fit pieces no. **5** and no. **6** together as shown in the photo. Hold them firmly as you attach them. Any gaps will be eliminated by the next step.

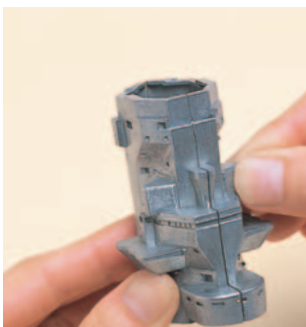

**12** To fill possible gaps, take a toothpick and cut off the tip diagonally. Put a little quick-drying glue on the tip of the stick and press it in the gaps. When gluing piece no. **4** (photo A), any gaps can be filled in the same way.

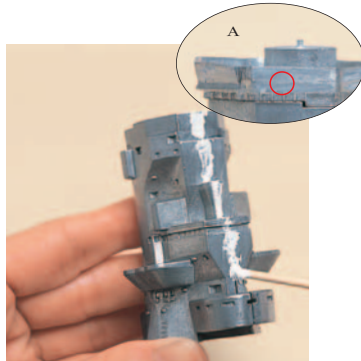

**13** When the glue is completely dry, eliminate any excess with grain no. 800 sandpaper, to make the entire surface even and smooth. It may happen that, when dry, the join comes apart. In this case, repeat the operation. The main body of the bridge is now ready.

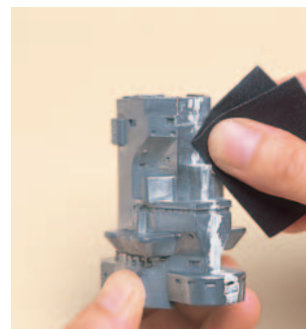

**14** Prepare anti-aircraft command post no. **4**. First, smooth the flat areas with the metal file.



**15** Smooth the filed piece with grain no. 800 sandpaper. The smaller parts can be smoothed with a point of the sandpaper folded at an angle.



**16** Where the sandpaper will not reach, use the point of the craft knife. Work on the angles to shape them perfectly. Change the point of the craft knife as soon as it shows signs of wear.

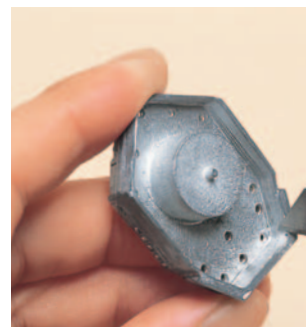

**17** The small square incisions are windows. Finish them as shown in Photo B, using the tip of the craft knife, taking care not to accidentally remove other details.

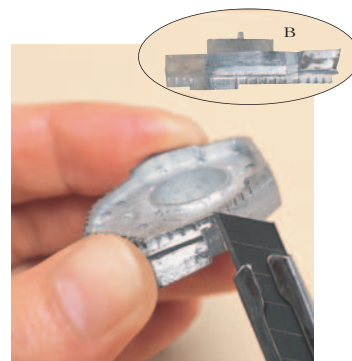

**18** Fill in any cavities with glue. If the area is flat, it can be fixed by applying glue evenly over the entire surface, so as to cover small imperfections. Once it is completely dry, smooth it with grain no. 800 sandpaper to make it perfectly flat and to remove glue smears.



**19** Place the bridge on a raised board, with folded cardboard underneath. Spray with the metal primer, from a distance of 30cm. Repeat 2 or 3 times to homogenize the paint bonding. Also spray the primer on piece no. 4.



💡 When you use metal primer, ventilate the area well and follow the manufacturer's instructions.

**20** Now it's time to use battleship grey model-making paint. Spray the paint lightly and evenly, from 30cm away, over the entire bridge. A good method is to spray with linear movement from a distance to close up.



💡 When using spray paint, ventilate the area well and follow the manufacturer's instructions.

**21** Once the piece is completely dry, repeat the operation from the opposite direction, avoiding over-spraying any one area. An excess of paint could alter the original shape.

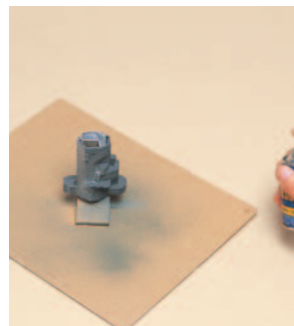

**22** When the piece is dry, repeat the operation for a final time. Proceed as described above with part no. 4, spraying the paint 2-3 times, and then let it dry completely. After painting, clean the nozzle of the spray paint canister before closing it.



**23** Paint the windows of the bridge matt black with water-based model-making paint. Before using the paint be sure to mix well. Paint all the windows as shown in photo C and the photo of the completed piece.

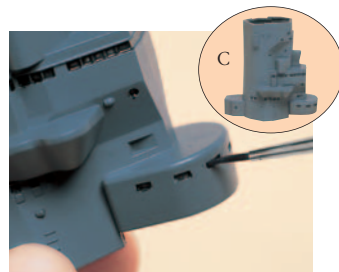

💡 By resting your wrist on the work surface, you can avoid any inaccuracy in painting the smallest parts.

**24** If the black paint accidentally spills on parts it shouldn't, you can cover it with the battleship grey colour – spray the paint on a saucer and put a little on the tip of the brush to correct the smudging.



**25** Following the instructions given in Steps 23 and 24, colour the small cavities of piece no. 4 matt black. Wash the brush well after use.



**26** Holding the bridge as shown in the photo, glue piece no. 4 to the bridge with metal glue. When the two pieces are firmly glued, avoid touching the assembly with anything sharp that could scratch the paint. Keep it in a safe place.

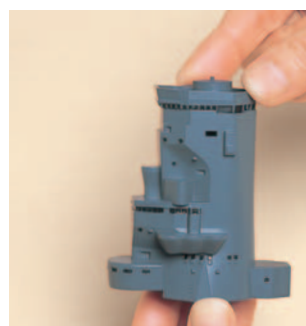

BRIDGE

## COMPLETED PIECES

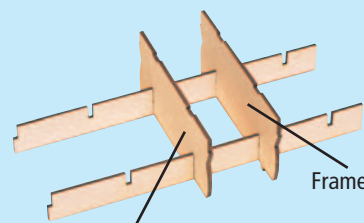

Frame no. 7  
Frame no. 8  
HULL OF THE SHIP



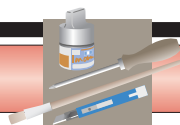

## Hull, command post and main guns support tower

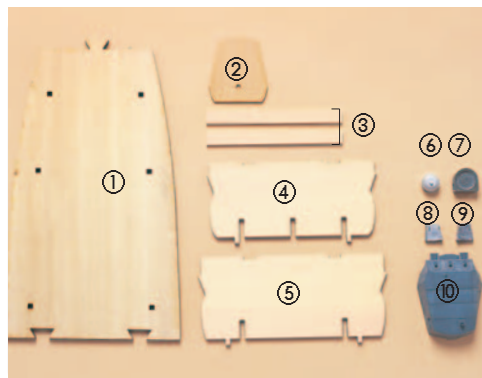
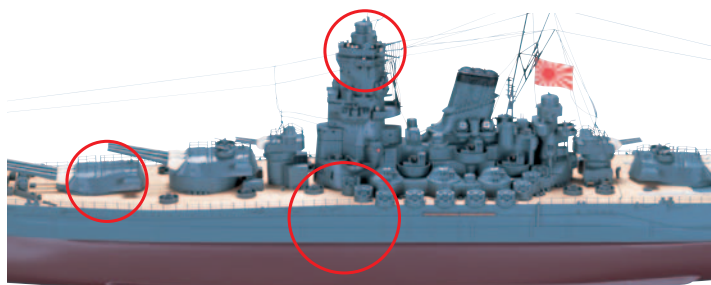

- ① Base 1
- ② Base of the main guns support tower
- ③ Beams x 2
- ④ Frame no. 6
- ⑤ Frame no. 9
- ⑥ Main guns command post
- ⑦ Base of the command post
- ⑧ Right rangefinder
- ⑨ Left rangefinder
- ⑩ Main guns support tower

### HULL

**27** Take the main body assembled in the previous steps and, with a toothpick, apply wood glue in the first slot from the left of the two keels. It is important not to confuse the ends. Begin from the protruding part circled in the photo.

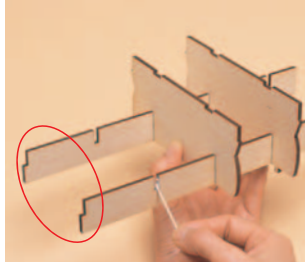

**28** Insert frame no. 6 (4) in the slots, pushing firmly down. Set the angle between the frame and the keel at 90 degrees with the help of the set square.



**29** Similarly, after applying glue in the first slot from the right of the keels, insert frame no. 9 (5), as shown in the photo. Set the angle between the frame and the keel at 90 degrees with the help of the set square.



**30** Position the base (1) as shown in the photo. Glue it, but first make sure that the lugs on the lower side of frames no. 6 and no. 9 are inserted in the corresponding holes in the base. Leave the glue to dry, pressing down on the assembly with something heavy, such as a dictionary. Make sure the assembly is perfectly flat against the base to avoid an uneven hull.

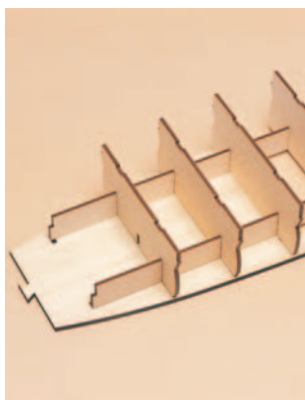

### Recommended tools and materials

- PVA wood glue
- Sandpaper (grain no. 800)
- Craft knife
- Penknife
- Metal file
- Silver foil
- Toothbrush
- Model-making putty spray
- Metal primer
- Model-making spray
- paint (battleship grey)
- Pliers
- For metal: Super Glue Gel or Two-part epoxy glue

**31** Glue the two beams (3) in the slots of frames nos. 6 and 8. Their ends should rest on 50 per cent of the thickness of the frames.

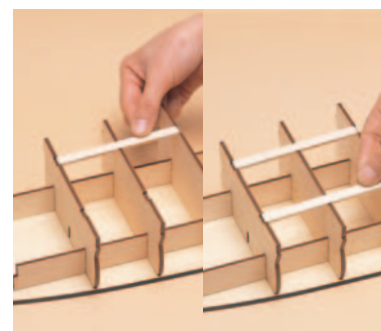

### COMMAND POST AND MAIN GUNS SUPPORT TOWER

**32** Smooth the rear contour of the tower (10) with the metal file. Be careful not to injure yourself with metal shavings.



**33** Smooth the surface of the tower (10) with the metal file to remove any irregularities. Be careful not to eliminate important features such as the stairs. Remember, also, that a too heavy hand can leave scratches difficult to correct.

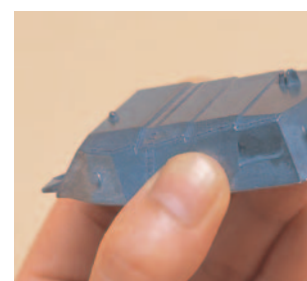

**34** After eliminating unnecessary projections, smooth the surface of the tower (10) with grain no. 800 sandpaper.

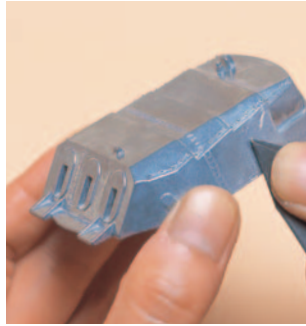

**39** Follow the instructions in step 35 and prepare the base of the command post (7) with the metal file and sandpaper.



**35** Clean up the command post (6). Start with the file and then finish the piece with sandpaper. The areas the file won't reach can be smoothed with the corner of the folded sandpaper.

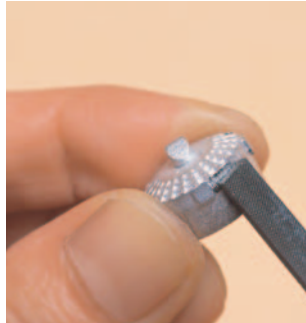

**40** The upper part of piece 7 is concave. As can be seen in Figure A, the piece becomes more realistic by blunting the edge. Smooth with the metal file to obtain an even finish.

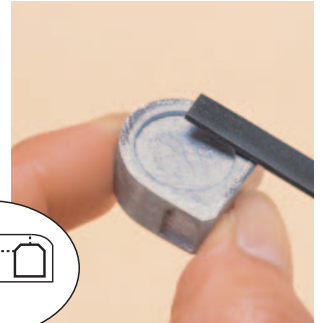
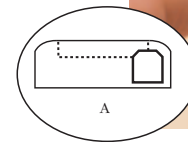

**36** To eliminate irregularities where you cannot insert the sandpaper, use the tip of the craft knife: taking the blade between two fingers will make the operation easier.

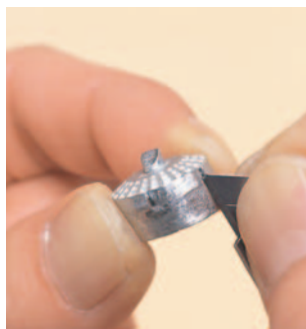

**41** Complete the smoothing with sandpaper grain no. 800.



**37** Using the same procedure, prepare the right and left rangefinders (8 and 9), first with the metal file, then with grain no. 800 sandpaper.



**42** Insert part no. 6 into part no. 7, taking care of the projection highlighted in the photo (red circle), and fix with quick-drying glue.



**38** Use the craft knife where the sandpaper won't reach. The small square-shaped incisions are windows. With the tip of the craft knife, work on the angular parts, until they are perfectly shaped.



**43** Fill any gaps between pieces nos. 6 and 7 with glue. A small spatula, made by cutting the tip off a toothpick diagonally, will make this operation easier.



💡 Recent research suggests that the surface of this piece was smooth. If you agree, then you can eliminate the relief with a craft knife.

**44** When the glue is dry, remove any excess with sandpaper. Once dry, if the glue should come unstuck, repeat the operation. Similarly, correct any loose joints in pieces nos. 8 and 10.



**49** Insert the base (2) in the lower section of the tower (10) and fix it with metal glue.



**45** With reference to photo 49, match the base of the tower of the main gun (2) with the base of the command post, removing any excess with sandpaper. From a distance of 30cm, spray a little putty on piece no. 2, repeating the operation several times.

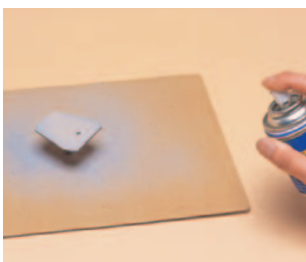

⚠ When you use putty in spray, ventilate the room well and follow the manufacturer's instructions.

**50** Fix the direction devices of the rangefinders. Cut out 3x3mm squares of silver foil and, using pliers, fit them into the holes of pieces nos. 8 and 9 with quick-drying glue, as shown in the photo.

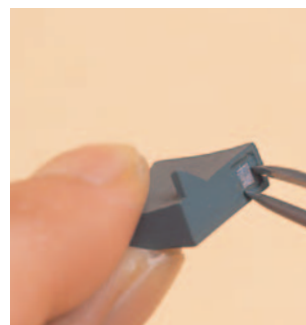

**46** From a distance of 30cm, evenly spray the metal primer on command post no. 6 and on pieces nos. 8, 9 and 10. Repeat 2-3 times. It will be easier if you set them on a piece of cardboard.

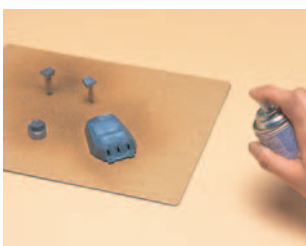

⚠ When using metal primer, ventilate the room well and follow the manufacturer's instructions.

**51** Place the tower as shown in the photo and fix piece no. 9 in the recess at the end of the left side with metal glue.



**47** Spray the base of the tower (2), the command post (6) and the pieces nos. 8, 9 and 10 with model-making battleship grey paint. Spray the paint lightly and evenly from 30cm away. Allow all the pieces to dry completely.

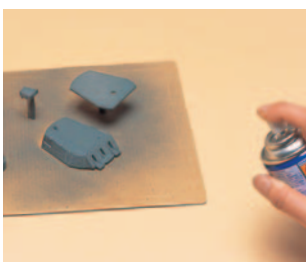

⚠ When using spray paint, ventilate the room well and follow the manufacturer's instructions.

**52** In the same way, glue piece no. 8 on the opposite side.



**48** Once the pieces are dry, repeat the operation in the opposite direction, avoiding spraying the paint at the same point. Any excess paint can alter the original shape.

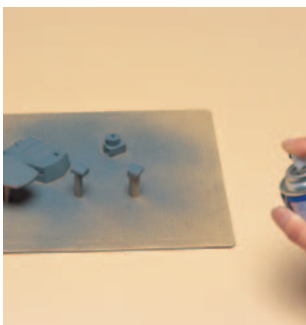

## COMPLETED PIECES

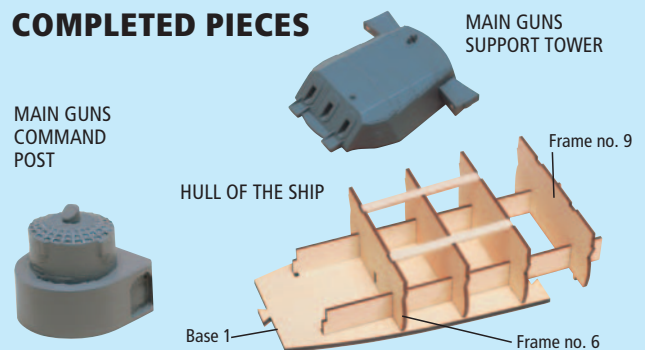





## Hull, main guns, deck for flag signalling and lamp signalling

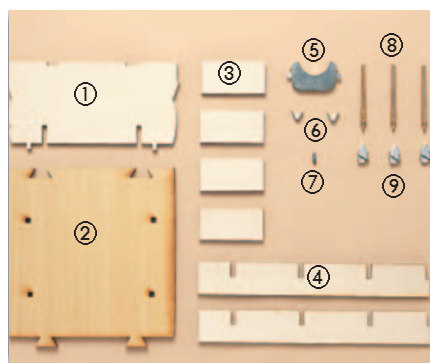
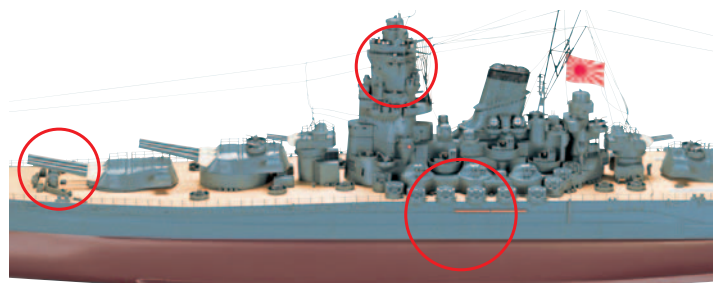

- ① Frame no. 10
- ② Base 2
- ③ Beams x 4
- ④ Keel of the central body x 2
- ⑤ Deck for flag signalling
- ⑥ Parts of the bridge x 2
- ⑦ Lamp for signalling
- ⑧ Main guns x 3
- ⑨ Main gun bases x 3

### THE HULL

**53** Attach the base part 2 to the main body assembled in the previous stage. As shown in the photo, match the slots and insert the lugs in the lower part of frame no. 9 into the respective holes of the base. Apply wood glue and fix well.



**54** Place the model as shown in the photo and glue one of the four beams (3) on the side of the keel of the central body. The left end must be well fixed to frame no. 9.

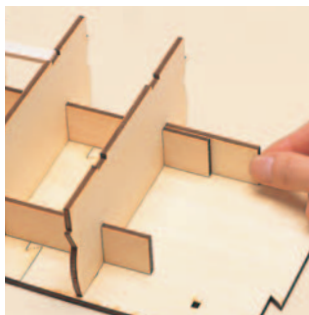

**55** On the keel you have reinforced in the previous step, attach another keel (4) with wood glue (the end to glue is flat and un-notched). Apply glue to the sides of the reinforcement and fix well.

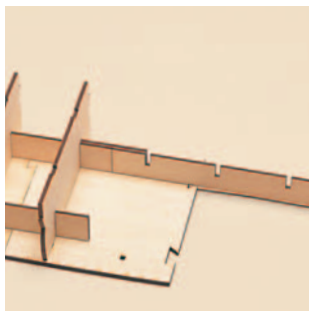

**56** Glue another beam reinforcement (3) on the front side of the keel (4) and fix it well.

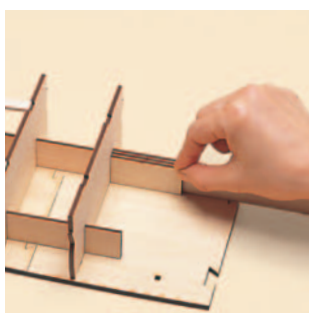

### Recommended tools and materials

- PVA wood glue
- Metal file
- Sandpaper (grain no. 800)
- Craft knife
- Putty
- Pliers
- Metal primer
- Model-making paint spray (battleship grey no. 2)
- Model-making watercolours (silver, white, bronze)
- For metal: Super Glue Gel or Two-part epoxy glue

**57** Following the procedure described in steps 53-56, also assemble the second keel (4) with the remaining two beams (3) on the other side of the keel.

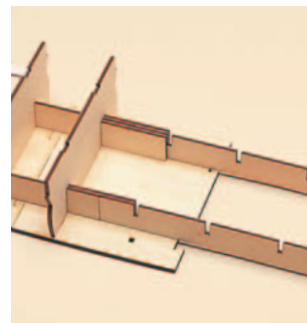

**58** Place the model as shown in the photo and apply glue in the first slot from the left, then insert frame no. 10 (1). At the same time insert the lugs of the lower section of frame no. 10 (1) in the two holes in the base (2).



### MAIN GUNS, DECK FOR FLAG SIGNALLING AND LAMP SIGNALLING

**59** Prepare the surface of the deck for flag signalling (5). With the metal file, smooth the flat part, eliminating any rough projections. Remember that a too heavy hand can leave scratches difficult to correct.



**60** Smooth the entire surface of the piece with sandpaper (grain no. 800). Be careful not to remove the projections that are part of the design of the piece.



**65** Now smooth the two ends of piece no. 6 so it will stick perfectly to the deck, keeping referring to Step 78. To do this, cut both ends diagonally with the craft knife. Be careful not to damage the paint with the corners.

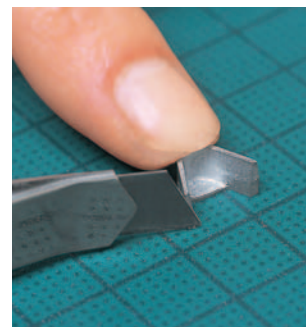

**61** Where the sandpaper won't reach you can use the point of the craft knife. Work on the angular parts so they are perfectly shaped.



**66** Prepare the bases of the main guns (9). Following Steps 59–60, eliminate any projections or irregularities, and smooth with the sandpaper.

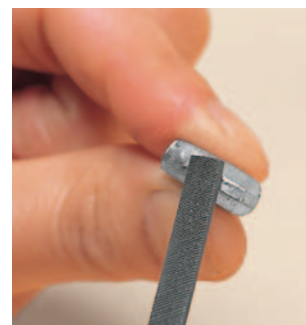

**62** Patch any cavities in piece no. 5 with putty. If the area is flat, you can apply putty evenly over the entire surface to cover small imperfections. When it is completely dry, smooth it with sandpaper (grain no. 800) to make it flat and remove any excess putty.



**67** Finish by smoothing pieces no. 9 with sandpaper (grain no. 800).



**63** Refer to Step 76 before you glue piece no. 5 to the bridge, being careful not to damage the paint. If the concave part of no. 5 does not adhere perfectly, smooth it with the metal file or sandpaper. Any holes can be filled with putty. Once dried, eliminate any excess.

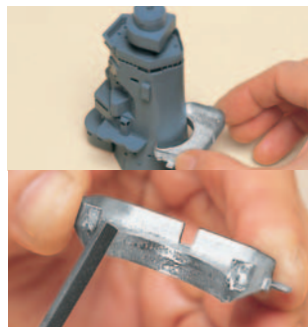

**68** Prepare part no. 7. Follow the directions in Steps 59–62. The base must be flat as shown in the photo.

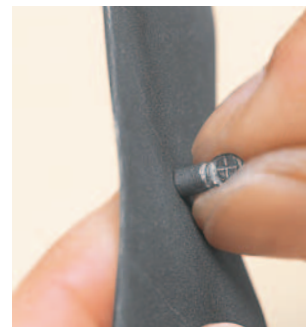

**64** Prepare part no. 6 by following the directions in Steps 59–62.



**69** Also prepare part no. 8. To smooth the entire surface of each gun evenly, wrap it completely in the sandpaper and rub carefully.





**70** From a distance of 30cm, evenly spray the metal primer on pieces no. 5 to 8. The small parts of pieces 5 and 6 are easier to paint if stuck on a strip of adhesive tape. For parts nos. 7 and 8, stand them up and put them on a card as indicated in the photo.

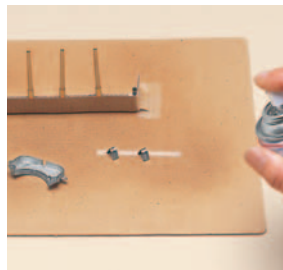

💡 When using metal primer, ventilate the room well and follow the manufacturer's instructions.

**71** When the primer is dry, paint pieces from nos. 5 to 8 with model-making battleship grey spray paint. Spray the entire bridge lightly and evenly from a distance of 30cm, and then allow the paint to dry completely.

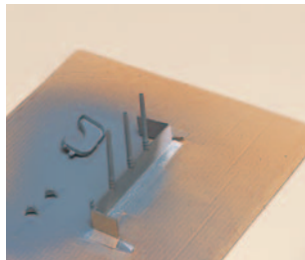

💡 When using spray paint, ventilate the area well and follow the instructions on the packaging.

**72** Paint the lamp of the beacon (7) with model-making watercolour silver paint: put a bit on the tip of the brush and paint with repeated taps, without dripping. It will be easier if you fix the beacon to cardboard with adhesive tape.



**73** Mix two watercolour pigments in a saucer: one part bronze to two white. Adjust the tone as you like, then paint the three pieces no. 9 and, if necessary, repeat the process.

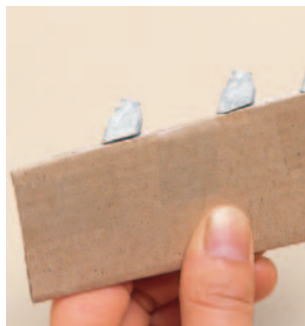

**74** Apply metal glue on the projections of pieces no. 8 and insert them into the holes of pieces no. 9. The first set of three main guns is ready. If the holes in pieces no. 9 are too small, enlarge them with an awl.



**75** Take the main gun turrets as shown in the photo, and insert the projections of pieces no. 9 in the corresponding holes in the tower, fixing them firmly with metal glue.



**76** Now take the bridge assembled earlier and glue piece no. 5 on the right side, as shown in the photo. Assemble it horizontally, aligning the projections of the bridge with the base of piece no. 5.

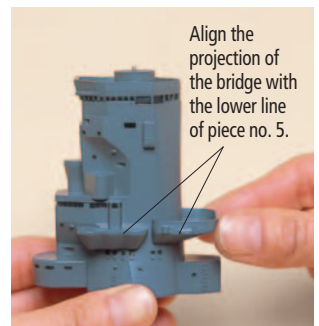

**77** When dry, take the bridge and with metal glue stick piece no. 7 in the corner of piece no. 5, as shown in the photo. The flat side of piece no. 5 is to be fixed to the surface of piece no. 7. Finally, turn the beacon outwards.

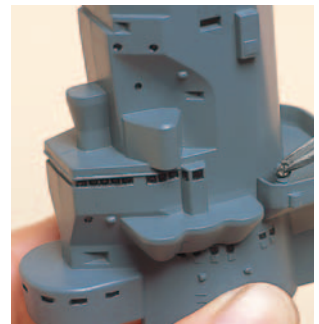

**78** On the projection in the centre of one side of the bridge, fix piece no. 6 with the metal glue, slightly shifting the edge as shown in Photo A. Glue another piece no. 6 symmetrically on the opposite side of the bridge.

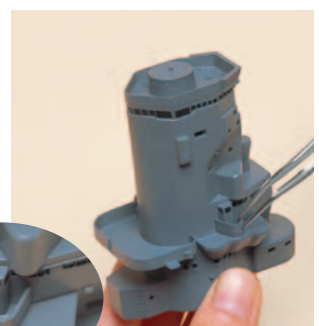
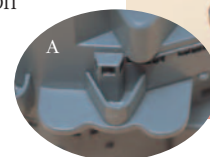

## COMPLETED PIECES

### BRIDGE

Deck for flag signalling  
Lamp for signalling

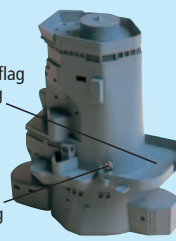

### MAIN GUNS

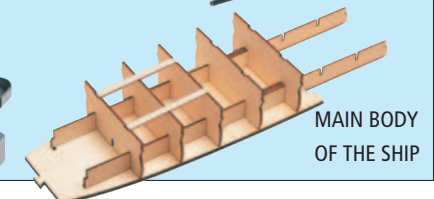

MAIN BODY OF THE SHIP

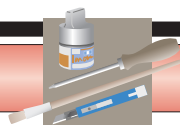

## Hull, rangefinders and parts of the bridge

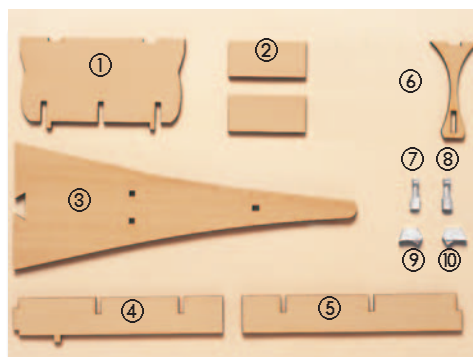
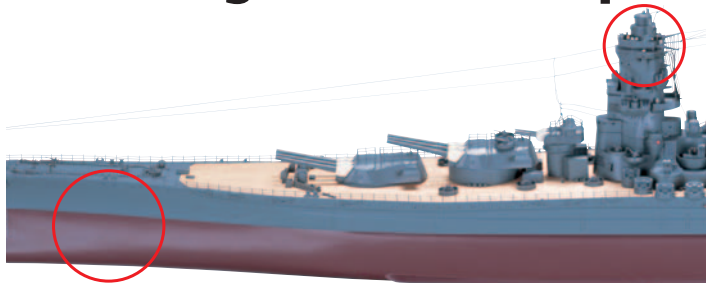

- ① Frame no. 5
- ② Reinforcement x 2
- ③ Base of the ship (bow)
- ④ Keel of the ship (bow)
- ⑤ Keel of the ship (bow)
- ⑥ Frame no. 1
- ⑦ Rangefinder (left)
- ⑧ Rangefinder (right)
- ⑨ Part of the bridge
- ⑩ Part of the bridge

### THE HULL

**79** Take the keel no. 4 (the encircled projection must be on the left) and glue on the right edge of one of no. 2 reinforcements with the wood glue. Make sure that the reinforcement is perfectly aligned with the keel and does not go beyond the groove on the right.

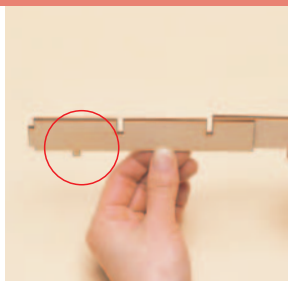

**80** In continuation with the keel no. 4, glue the keel no. 5 on the protruding side of reinforcement no. 2, applying the glue both on the side and on the left edge of the keel itself. Attach the two pieces, making sure that the encircled projection is to the right.

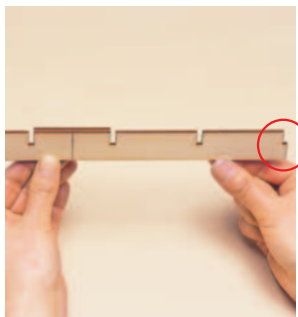

**81** In parallel with the first reinforcement, glue the second reinforcement to the opposite side of the keel with wood glue. If the corners of the reinforcements cover the two adjacent grooves, file down or cut off the excess. The keel of the bow is now ready.

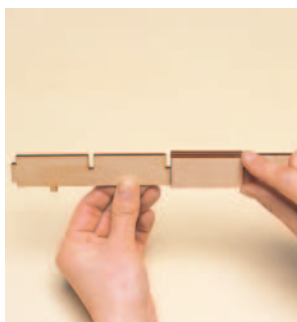

### Recommended tools and materials

- PVA wood glue
- Metal file
- Sandpaper (grain no. 800)
- Putty
- Model-making spray paint (battleship grey)
- Metal primer
- Model-making watercolours (battleship grey, matt black, silver)
- For metal: Super Glue Gel or Two-part epoxy glue

**83** Place what was assembled in the previous step as shown in the photo. Then, insert the projection of keel (4), first in the slot of frame no. 6, then in the hole in the base (3), finally fixing the whole together with glue. Make sure the projection keel is set 90 degrees to the base.



**84** After applying the glue, insert frame no. 5 (1) in the slots, as shown in the picture, and fix thoroughly.



**82** Place the body of the ship assembled previously as indicated in the photo. After applying glue, fix the base of the vessel (bow) (3) to the body of the ship.

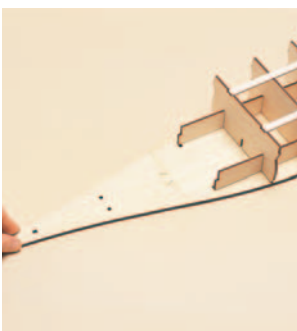

**85** After applying glue in the specific slot, insert the frame no. 1 (6) at the end of keel (4). Make sure the frame is set vertically at 90 degrees.



## RANGEFINDERS – PARTS OF THE BRIDGE

**86** Now prepare the pieces no. **7** and no. **8**. File down the flat part with the metal file, eliminating unnecessary projections. Remember that too much force can leave marks difficult to erase.



**87** Smooth the entire surface of pieces no. **7** and **8** with sandpaper grain 800. Be careful not to rub off the original reliefs.



**88** Fill in with putty any holes in pieces no. **7** and no. **8**. If need be, you can put putty on the entire surface to cover any small imperfections. When it is dry, smooth the pieces with sandpaper to remove any excess. If the putty breaks away, repeat the operation.



**89** At this point, refer to steps 93 and 94 to make sure that pieces no. **7** and **8** adhere perfectly to the recesses of the command post with the main gun. Be careful not to damage the paint.



**90** If pieces no. **7** and no. **8** do not join perfectly, smooth the surface with the metal file or with sandpaper.



**91** Now set pieces no. **9** and no. **10** in place. Treat the flat side first. Rub off unnecessary projections using the metal file. Remember to work the pieces gently.



**92** After eliminating unnecessary projections, smooth the entire surface of pieces no. **9** and no. **10** with grain no. 800 sandpaper. Be careful not to erase the original reliefs.

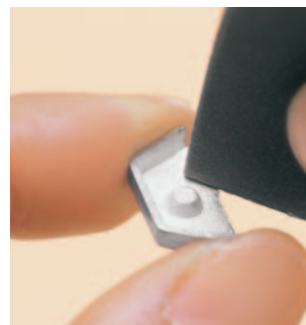

**93** Fill any holes in pieces no. **9** and no. **10** with putty. Again, if necessary, you can apply the putty evenly over the entire surface to cover small imperfections. When it is dry, smooth well with sandpaper grain no. 800. If the putty should break away, repeat the operation.

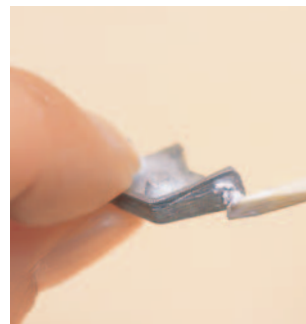

**94** Referring to Steps 102 and 103, insert pieces no. **9** and no. **10** in the space provided in the bridge taking care not to scratch the paint. If the pieces do not adhere perfectly to the bridge, then smooth with the metal file or with sandpaper and fill any gaps or cracks with putty.

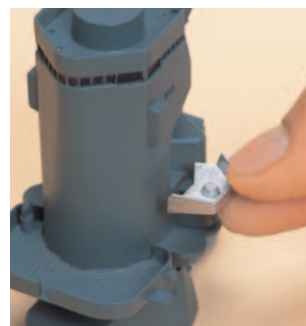

**95** Now paint pieces from nos. **7** to **10**. Spray the metal primer evenly from a distance of 30cm. The small parts will be easier to paint if fixed on adhesive tape.

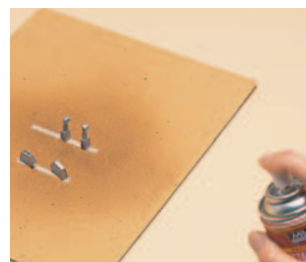

⚠ When using the metal primer, ventilate the room well and follow the manufacturer's instructions.



**96** Once dry, paint the pieces from **7** to **10** with model-making battleship grey spray paint. Spray lightly and evenly from 30 cm away.

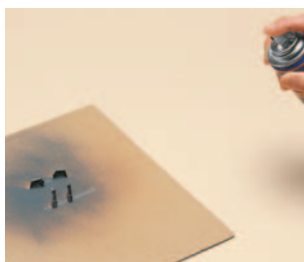

⚠ When using spray paint, ventilate the area well and follow the manufacturer's instructions.

**97** Spray evenly and changing direction. Be careful not to cover the original small reliefs, then let the pieces dry.



**100** When the glue is completely dry, paint the small square recess at the base of pieces nos. **7** and **8**: mix the battleship grey and matt black model-making watercolours in equal amounts. Paint with the tip of the brush using a small amount of paint.

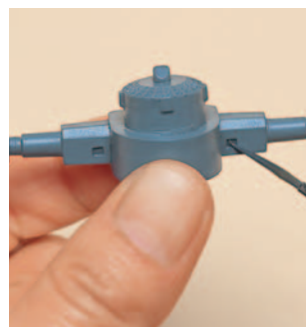

**101** In the same way, paint the recesses located on top of pieces no. **7** and **8** with model-making silver watercolour.

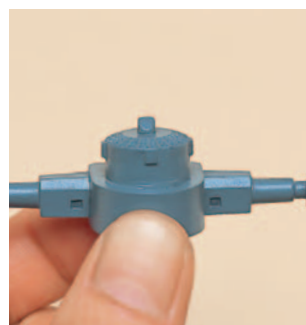

**98** Take the command post assembled earlier and fix piece no. **8** in the recess on the right with metal glue. As shown in the photos of Step 99, the piece must be perpendicular to the base of the command post. Do not use too much glue to avoid altering the colour of the paint.



**102** Take the bridge as shown in the photo and fix piece no. **9** in place with metal glue.

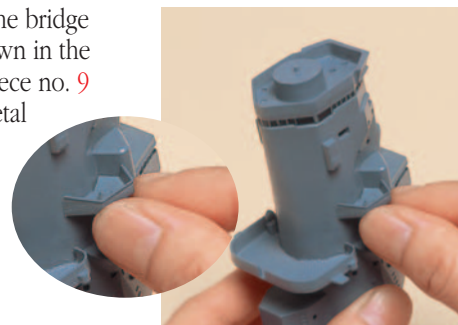

**99** Similarly, glue piece no. **7** on the opposite side of the command post. Ensure that the two pieces no. **7** and **8** are positioned symmetrically.



**103** In the same way, glue piece no. **10** on the opposite side.

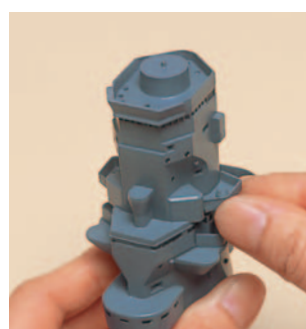

## COMPLETED PIECES

