

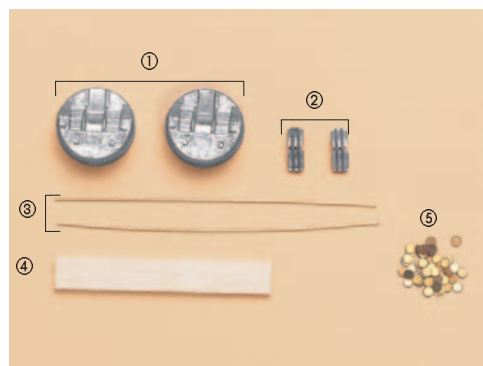

Machine-guns with shielding and the portholes



- ① Machine-guns with shielding x 2
- ② Machine-guns with shielding x 2
- ③ Wire x 2
- ④ Slat
- ⑤ Portholes x 50

Recommended tools and materials

- Metal glue
- Metal file
- Sandpaper (grain no. 800)
- Craft knife
- Double-sided adhesive tape
- Pliers
- Adhesive tape
- Hand drill (diameter 1.5mm)
- Putty
- Awl
- Wooden spatula
- Metal primer
- Spray paint (battleship grey, iron grey)
- Watercolour (battleship grey, matt black)

MACHINE-GUNS WITH SHIELDING

1 Smooth pieces 1 and 2, eliminating irregularities in shape with the metal file. These guns have rounded edges. Checking against Figure A, take care to maintain the rounded shape.



2 After an initial filing, smooth pieces 1 and 2 with sandpaper grain no. 800, being careful not to damage the original shapes.



3 Where the sandpaper cannot reach, use the blade of the craft knife, being careful not to damage other parts of the pieces or cut yourself. If there are holes or hollows on the surface, correct them by applying putty with the tip of the craft knife, or a wooden spatula.

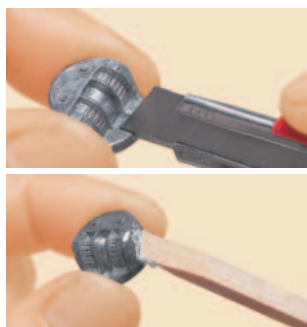

4 When the putty is completely dry, smooth with sandpaper grain no. 800.



5 Checking against Step 6, insert a piece 2 in the central cavity of a piece 1. If it does not fit perfectly, smooth it with the file and sandpaper. Take piece 2, as shown in the photo, and smooth the edge to make it fit perfectly to the curve of piece 1.

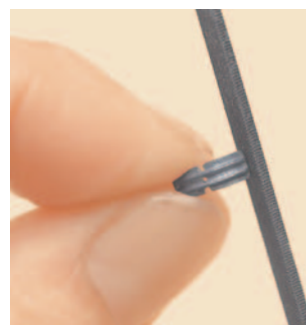

6 Holding the piece 1, as shown in the photo, fix to piece 2 with metal glue. You have now made a base of a machine-gun with shielding. Following the same procedure, assemble the other one.

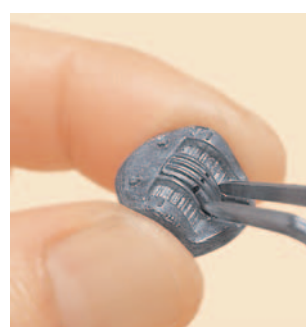

7 Cut the wire **3** with the pliers to get six pieces 6mm in length. To perform this operation, take piece **4** and, as shown in the photo, match one end of the wire to it and secure with double-sided adhesive tape.

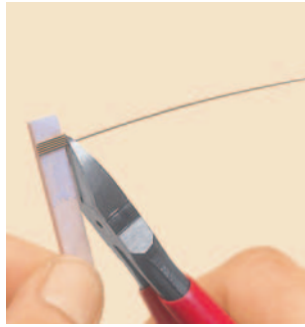

8 With the metal file, smooth the ends of the wires **3**, so that they are all the same length. You have now made the barrels of the machine-guns.



9 Spray the metal primer evenly on the bases of the machine-guns with shielding, from a distance of about 30cm. The operation will be simpler if you secure the pieces to a base with double-sided adhesive tape.



⚠ When using metal primer, ventilate the room well and follow the instructions on the packaging.

10 When the metal primer is completely dry, spray a light and even coat of battleship grey paint from a distance of about 30cm, taking care not to disguise the original shape.

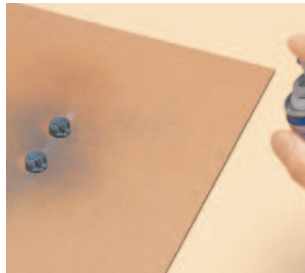

⚠ When using spray paint, ventilate the room well and follow the instructions on the packaging.

11 Repeat this procedure several times from different angles, allowing the paint to dry thoroughly each time.

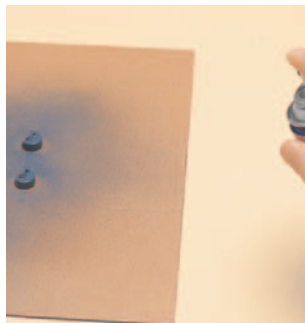

12 Following Steps 9, 10 and 11, paint the barrels of the machine-guns. After spraying the metal primer, give a light and even coat of iron grey paint. Repeat as necessary.

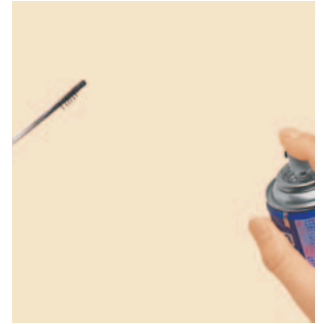

13 Take the bases of the machine-guns with shielding, as shown in the photo. Mix equal parts of battleship grey and matt black watercolour, and paint the two cavities on the right and left. Take care not to let the paint go beyond the cavity.

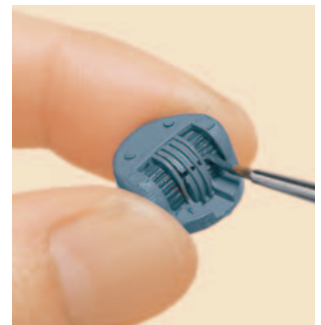

14 Take the bases of the machine-guns and insert the barrels in the respective holes in pieces **2**. Apply fast-drying glue to the tips of the barrels. Fix them firmly. When ready, store the machine-guns carefully. They will be mounted in later stages of the assembly.



THE PORTHOLES

15 Take the hull and glue pieces **5** on the starboard side, aft. Following the marks already made, glue one piece **5**, starting from the bow on the line of portholes below the hangar. Take care not to use too much glue.



16 When fixing the portholes, align the centre of the pieces accurately along the line.



17 Following the process described in Steps 15 and 16, fix the portholes along the upper line.



18 Glue the portholes to the line below the rear deck, on the aft side of the line.

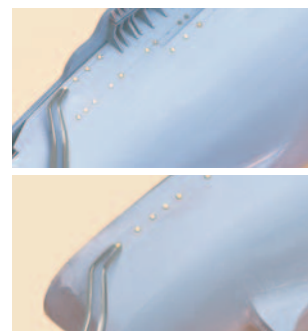

19 Now proceed with the larger portholes indicated on the plan. First, make a small hole by pressing the awl on the mark made in the previous stage of assembly.



20 Finish the hole with the 1.5mm-diameter drill.



21 Using the drill, the awl or a small round file, enlarge the hole to 2mm. If you use the latter, enlarge the hole by inserting the file and rotating it, as shown in the photo.



22 Repeat the operation, making another four holes.

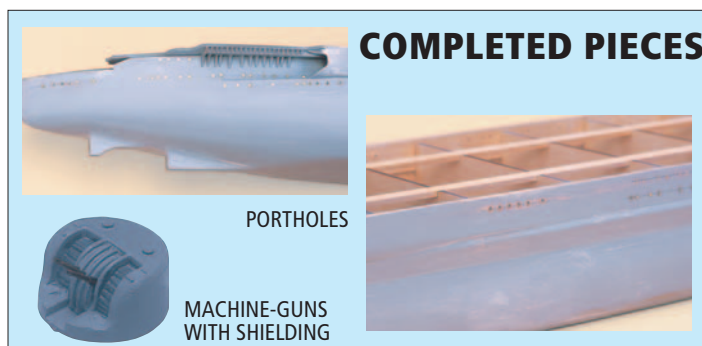
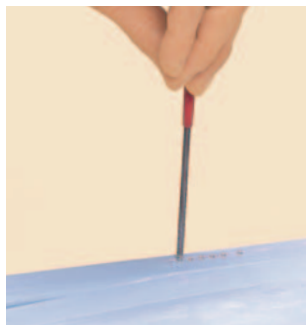



Machine-guns with shielding and the loadline (bow part)

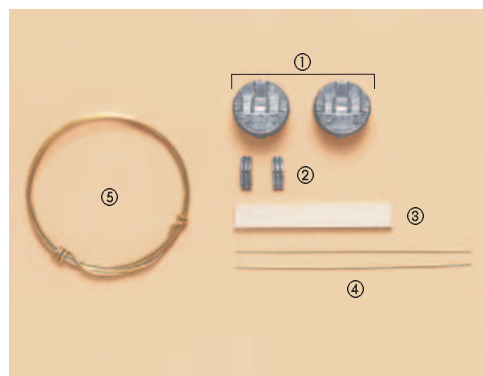

- ① Machine-guns with shielding x 2
- ② Machine-guns with shielding x 2
- ③ Slat
- ④ Wire x 2
- ⑤ Loadline

Recommended tools and materials

- Metal glue
- Metal file
- Sandpaper (grain no. 800)
- Craft knife
- Double-sided adhesive tape
- Putty
- Pliers
- Pencil
- Wooden spatula
- Metal primer
- Spray paint (battleship grey, iron grey)
- Watercolour (battleship grey, matt black)

MACHINE-GUNS WITH SHIELDING

23 Smooth pieces 1 and 2, eliminating irregularities in shapes with the metal file. These guns have rounded edges. Checking against Figure A, take care to maintain the rounded shape.

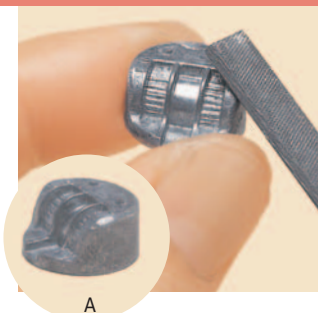

26 Checking against Step 27, insert a piece 2 in the central cavity of a piece 1. If it does not fit perfectly, smooth it with the file and sandpaper. Take piece 2, as shown in the photo, and smooth the edge to make it fit perfectly to the curve of piece 1.

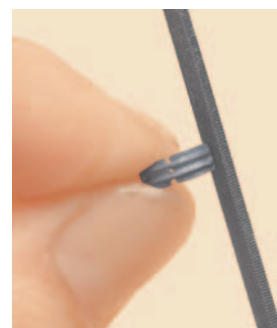

24 After an initial filing, smooth pieces 1 and 2 with sandpaper grain no. 800, being careful not to damage the original shapes. Where the sandpaper cannot reach, use the blade of the craft knife, taking care not to damage other parts of the pieces.

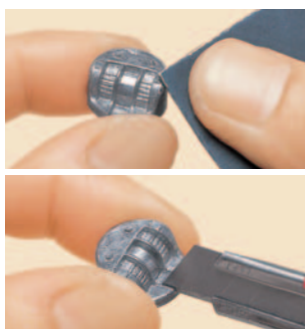

27 Holding the piece 1, as shown in the photo, fix it to piece 2 with fast-drying glue. You have now made a base of a machine-gun with shielding. Assemble the other.

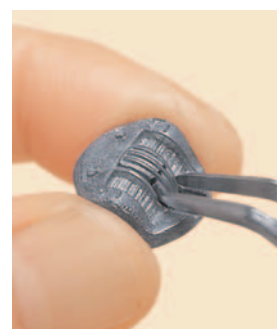

25 If there are holes or hollows on the surface, correct them by applying putty with the tip of the craft knife, or a wooden spatula. When the putty is completely dry, smooth with sandpaper grain no. 800.

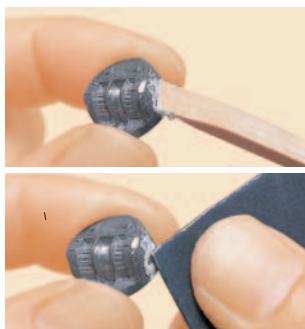

28 Cut the wire 4 with the pliers to get six pieces 6mm in length. The operation will be simpler if you first take piece 3 and, as shown in the photo, match one end of the wire to it and secure with double-sided adhesive tape.

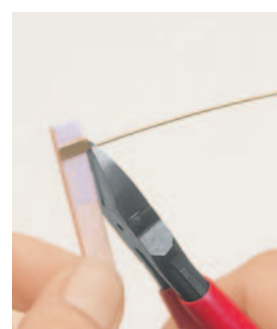

29 With the metal file, smooth the ends of the wires **4**, so that they are all the same length. You have now made the barrels of the machine-guns.

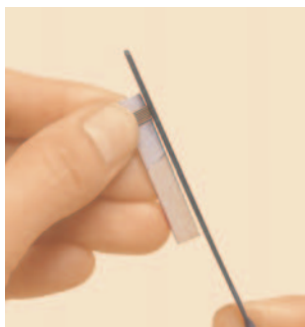

34 Take the bases of the machine-guns with shielding, as shown in the photo. Mix equal parts of battleship grey and matt black watercolour, and paint both cavities. Take care not to let the paint go beyond the cavities.

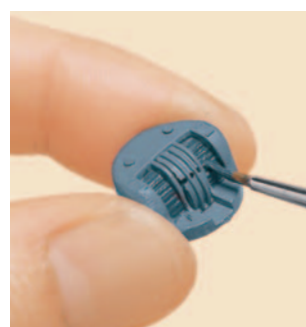

30 Spray the metal primer evenly on the bases of the machine-guns with shielding from a distance of about 30cm. The operation will be simpler if you secure the pieces to a base with double-sided adhesive tape.

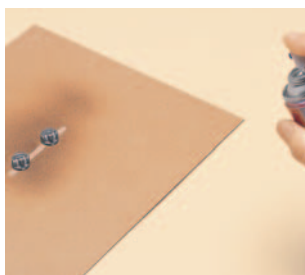

⚠ When using metal primer, ventilate the room well and follow the instructions on the packaging.

35 Take the bases of the machine-guns and insert the barrels in the respective holes in pieces **2**. Apply fast-drying glue to the tips of the barrels. Fix them firmly. When ready, store the machine-guns carefully. They will be mounted in later stages of the assembly.



31 When the metal primer is completely dry, spray a light and even coat of battleship grey paint from a distance of about 30cm, taking care not to obscure the original details.

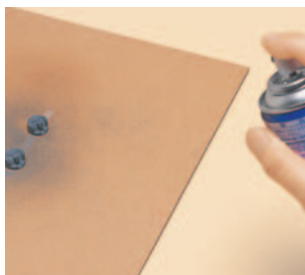

⚠ When using spray paint, ventilate the room well and follow the instructions on the packaging.

LOADLINE

36 Take the plan of the starboard side of the ship. Starting from the bow, measure the distance between the red line, the deck and the portholes and using a ruler or a leftover strake, draw the red line in Figure A on the hull.

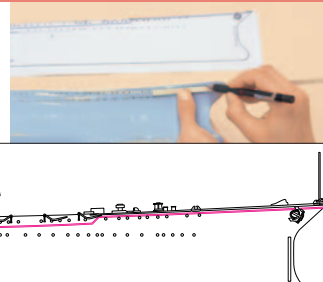

32 Repeat this procedure several times from different angles, allowing the paint to dry thoroughly each time.

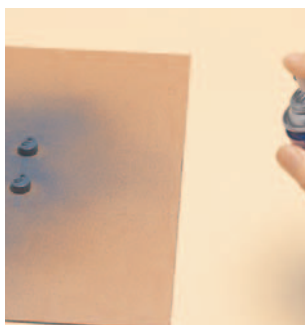

37 Following Step 36, mark the loadline at the stern onto the hull.

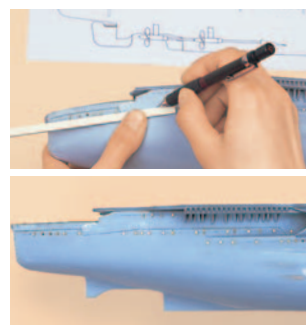

33 Following Steps 30, 31 and 32, paint the barrels of the machine-guns. After spraying the metal primer, give a light and even coat of iron grey paint. Repeat as necessary.



38 Continue the loadline up to the central area of the hull. At the point where the loadline changes angle, proceed by marking dots and then join them with a line. Transfer the line from the bow to below the hangar.

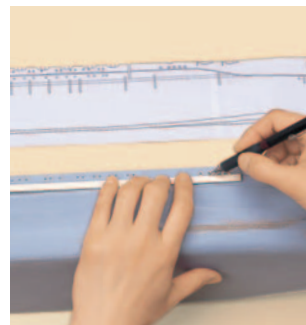

39 Following the same procedure, draw the loadline on the port side. The port and starboard lines should join at the front of the bridge. Cut a strip of paper the width of the gap between the bridge and the line, and secure with double-sided adhesive tape to the front, for use as a ruler. Similarly, draw the loadline on the face of the stern.



40 With the craft knife, cut a groove 0.5mm deep along the lines drawn. Cut from the front of the bow up to the point where the line changes angle, including the sloping part.



41 Insert the tip of the craft knife into the cut made in Step 40 and make a groove in the shape of a 'V' (Figure B). Be careful not to make the groove too deep.

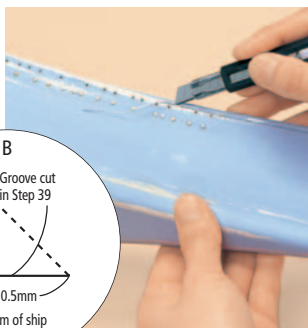
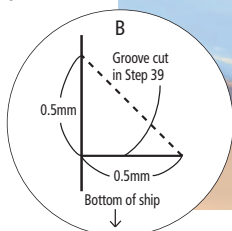

42 Using a round metal file, smooth the groove to a semicircular shape. You can also use sandpaper wrapped around a thin rod. Take care not to file too much.



43 Stretch the loadline (piece 5) by pulling it with the tips of your fingers. Make it as straight as possible.



44 Shape the loadline to the curve of the bow. First, bend the loadline in half and, checking against Step 47, fit it to the hull as accurately as possible.



45 Starting at the bow, fix the loadline to the ship with fast-drying glue. Match the curve given in Step 44 to the bow and fix the loadline into the groove of the hull. Take care not to spread glue on the body of the ship.



46 After attaching the loadline on the forward part, continue gluing into the grooves on either side. Beginning from the bow, glue it to the point where the line drawn in Step 38 angles downwards.

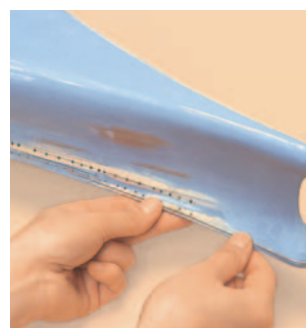

47 After attaching the loadline on the forward part, proceed by gluing it into the grooves on both sides. Insert the loadline, beginning from the bow, and glue it up to the point where the loadline angles downward.

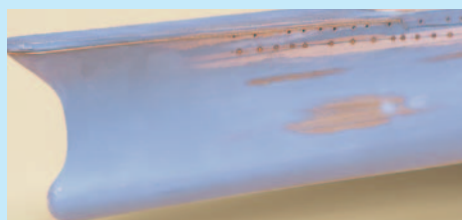

COMPLETED PIECES

LOADLINE
(BOW PART)

MACHINE-GUNS
WITH SHIELDING



Machine-guns with shielding and the loadline (stern area)

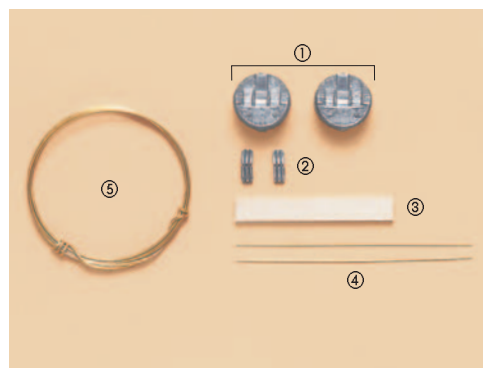

- ① Machine-guns with shielding x 2
- ② Machine-guns with shielding x 2
- ③ Slat
- ④ Wire x 2
- ⑤ Loadline

Recommended tools and materials

- Fast-drying metal glue
- Metal file
- Sandpaper grain no. 800
- Craft knife
- Pliers
- Double-sided adhesive tape
- Putty
- Metal primer
- Wooden spatula
- Spray paint (battleship grey, iron grey)
- Watercolour (battleship grey, matt black)

MACHINE-GUNS WITH SHIELDING

48 Smooth pieces 1 and 2, eliminating irregularities in shape with the metal file. Checking against Figure A, smooth with the file and blunt the edges of the pieces 1, giving a rounded shape.

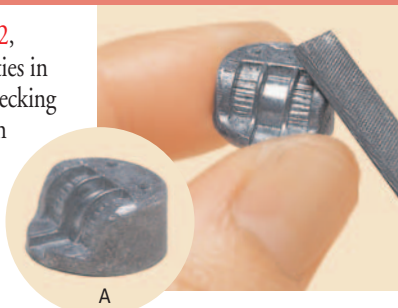

51 Checking against Step 52, insert a piece 2 in the central cavity of a piece 1. If it does not fit perfectly, smooth it with the file and sandpaper. Take piece 2, as shown in the photo, and smooth the edge to make it fit perfectly to the curve of piece 1.

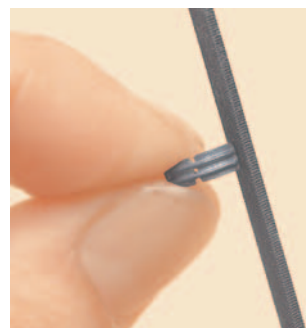

49 After an initial filing, smooth pieces 1 and 2 with sandpaper grain no. 800, being careful not to damage the original shapes. Where the sandpaper cannot reach, use the blade of the craft knife, being careful not to damage other parts of the pieces.

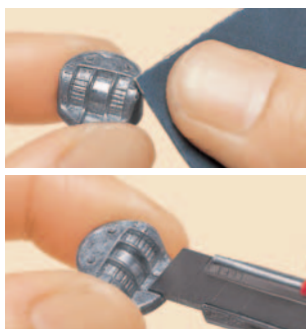

52 Holding the piece 1 as shown in the photo, fix to piece 2 with metal glue. You have now made a base of a machine-gun with shielding. Assemble the other one.



50 If there are holes or hollows on the surface, correct them by applying putty with the tip of the craft knife, or a wooden spatula. When the putty is completely dry, smooth with sandpaper grain no. 800.

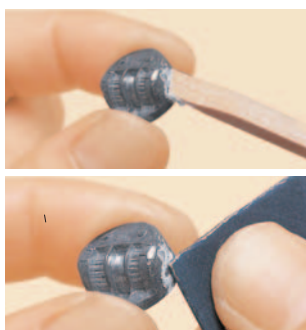

53 Cut the wire 4 with the pliers to get six pieces 6mm in length. It will be easier to cut the correct length if you first take piece 3 and, as shown in the photo, match one end of the wire to it and secure with double-sided adhesive tape.

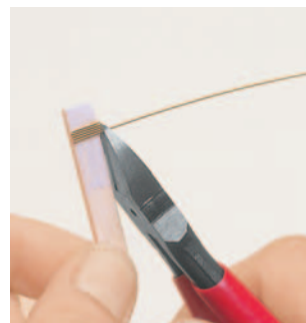

54 With the metal file, smooth the ends of the wires **4**, so that they are all the same length. You have now made the barrels of the machine-guns.

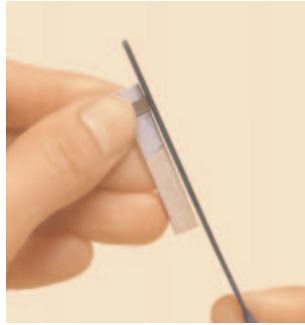

59 Take the bases of the machine-guns with shielding, as shown in the photo. Mix equal parts of battleship grey and matt black watercolour, and paint both cavities. Take care not to let the paint go beyond the cavities.

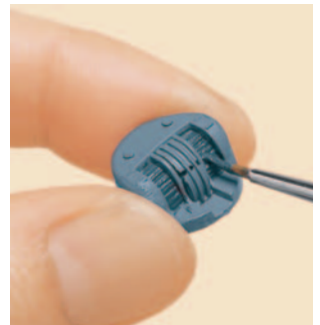

55 Spray the metal primer evenly on the bases of the machine-guns with shielding from a distance of about 30cm. The operation will be simpler if you secure the pieces to a base with double-sided adhesive tape.



⚠ When using metal primer, ventilate the room well and follow the instructions on the packaging.

60 Take the bases of the machine-guns and insert the barrels in the respective holes in pieces **2**. Apply fast-drying glue to the tips of the barrels, and fix firmly. When ready, store the machine-guns carefully. They will be mounted in later stages of assembly.



56 Allow the metal primer to dry and spray a light and even coat of battleship grey paint, from a distance of about 30cm. Be careful not to fill in the original details.

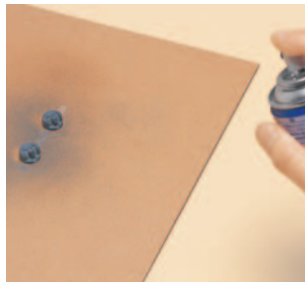

⚠ When using spray paint, ventilate the room well and follow the instructions on the packaging.

57 Repeat several times from different angles, allowing the paint to dry thoroughly between each coat.

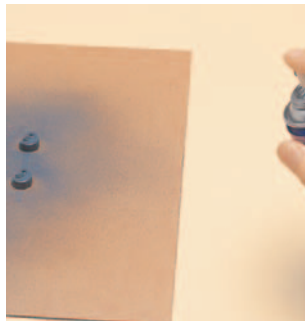

58 Following Steps 55, 56 and 57, paint the barrels of the machine-guns. After spraying the metal primer, give a light and even coat of iron grey paint. Repeat as necessary.



LOADLINE (STERN AREA)

61 With the craft knife, cut a groove 0.5mm deep along the reference line drawn previously on the front of the stern, and the area between the stern and the hangar.



62 Insert the tip of the craft knife into the cut made in Step 61, to make a groove in the shape of a 'V' (Figure B). Be careful not to cut too deep.

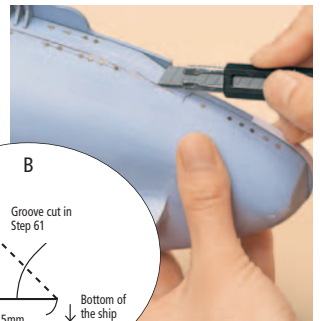
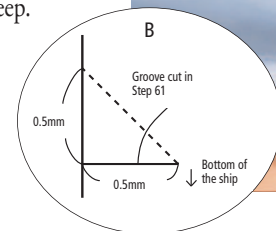

63 As shown in the photo, use a round metal file to give the groove a semicircular shape. You can also use sandpaper wrapped round a thin rod. Take care not to smooth excessively.

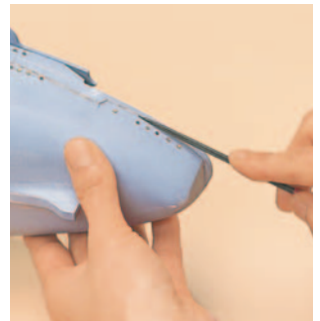

64 Stretch the loadline (piece 5) by pulling it with the tips of your fingers. Try to make it as straight as possible.



69 Cut a piece of the loadline to fit the sloping part of the line, and glue in place. Make sure that any cuts made to the loadline are oblique.



65 Shape the loadline to the curve of the stern. First, bend the loadline in half and, checking against Step 66, fit it to the hull as accurately as possible.

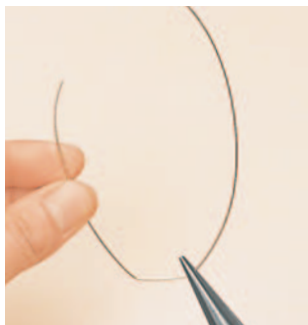

70 As in Step 69, fix a piece of the loadline on the sloping section of the line.

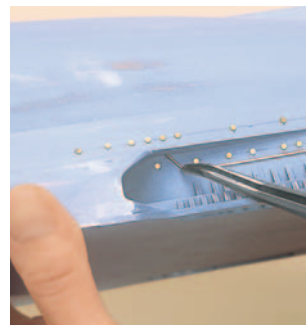

66 Starting at the stern, glue the loadline to the ship with fast-drying glue. Glue it to the point where the line drawn previously angles downwards. Be careful not to use too much glue.



71 Place the hull in the position shown in the photo and fix another segment of the loadline on the upper part of the hangar. The piece should be parallel with the edge, starting below the segment that was glued in Step 70, and continuing to the outer edge of the hull.



67 When the glue is dry, cut the excess loadline with the pliers before the line angles downwards. Take care not to shorten it more than necessary. Repeat this procedure on the other side.



72 Following Steps 68 to 71, fix the loadline on the opposite edge.



68 Glue another segment of the loadline in the straight groove going towards the hangar, skipping the sloping part of the line. Curve the piece around the shape of the hull and adjust the length. Then, fix with fast-drying glue.



COMPLETED PIECES

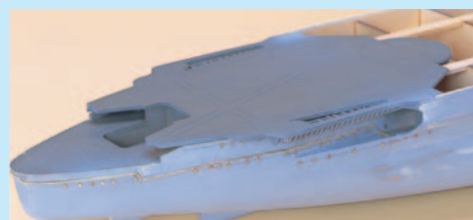

LOADLINE

MACHINE-GUNS WITH SHIELDING

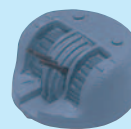



Machine-guns with shielding and the loadline (port)

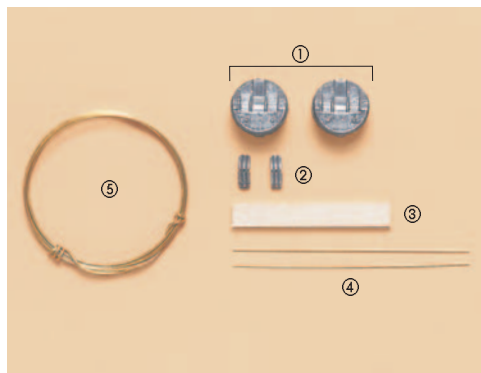
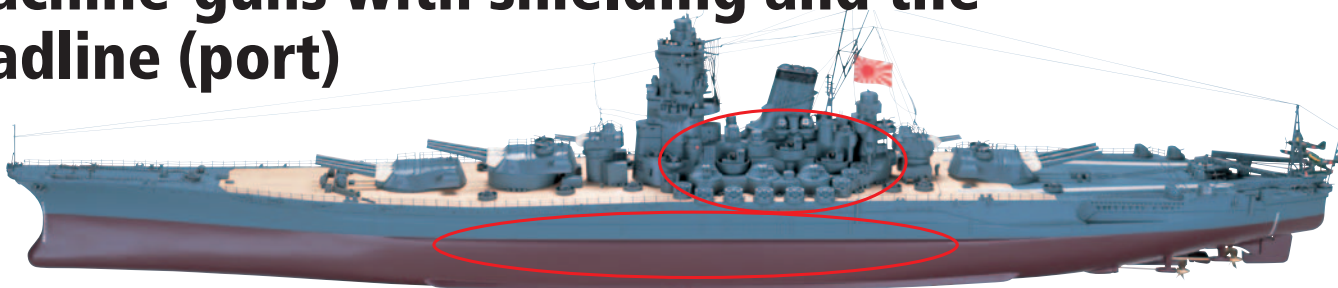

- ① Machine-guns with shielding x 2
- ② Machine-guns with shielding x 2
- ③ Slat
- ④ Wire x 2
- ⑤ Loadline

Recommended tools and materials

- Metal glue
- Metal file
- Sandpaper (grain no. 800)
- Craft knife
- Double-sided adhesive tape
- Pliers
- Putty
- Wooden spatula
- Metal primer
- Spray paint (battleship grey, iron grey)
- Watercolour (battleship grey, matt black)

MACHINE-GUNS WITH SHIELDING

73 Smooth pieces 1 and 2, eliminating irregularities in shape with the metal file. These pieces have a rounded edge. Checking against Figure A, smooth with the file, taking care to maintain the rounded shape.

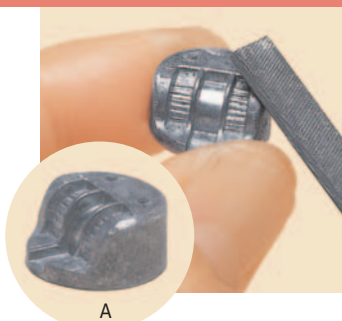

74 After an initial filing, smooth with sandpaper grain no. 800, being careful not to damage the original shapes. Where the sandpaper cannot reach, use the blade of the craft knife, taking care not to damage other parts of the pieces.

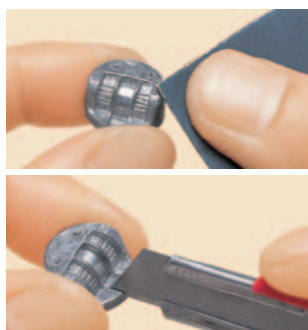

75 If there are holes or hollows on the surface, correct them by applying putty with the tip of the craft knife, or a wooden spatula. When the putty is completely dry, smooth with sandpaper grain no. 800.

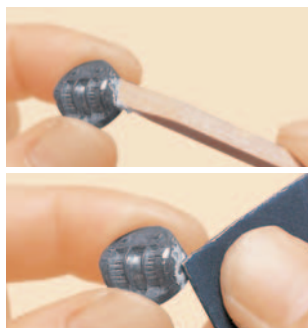

76 Checking against Step 77, insert a piece 2 in the central cavity of a piece 1. If it does not fit perfectly, smooth it with the file and sandpaper. Take piece 2 as shown in the photo, and smooth the edge to make it fit perfectly to the curve of piece 1.

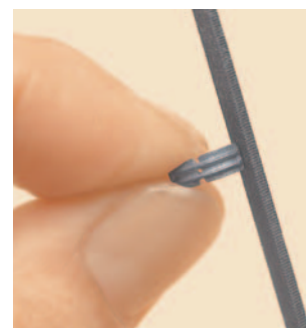

77 Holding the piece 1 as shown in the photo, fix to piece 2 with metal glue. You have now made a base of a machine-gun with shielding. Assemble the other one.

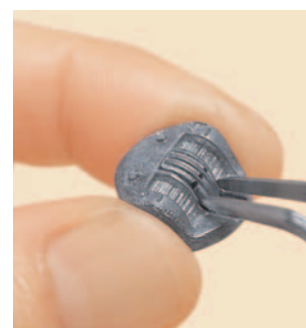

78 Cut the wire 4 with the pliers to get six pieces 6mm in length. It will be easier to cut the correct length if you take piece 3 and, as shown in the photo, match one end of the wire to it and secure with double-sided adhesive tape.

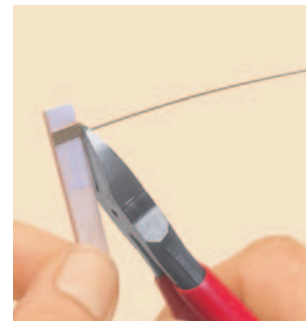

79 With the metal file, smooth the ends of the wires **4**, so that they are all the same length. You have now made the barrels of the machine-guns.



84 Take the bases of the machine-guns with shielding, as shown in the photo. Mix equal parts of battleship grey and matt black watercolour and paint both cavities. Take care not to let the paint go beyond the cavities.

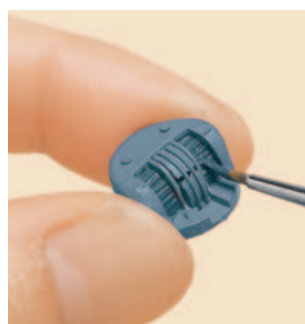

80 Spray the metal primer evenly on the bases of the machine-guns with shielding from a distance of about 30cm. The operation will be made simpler if you secure the pieces to a base with double-sided adhesive tape.

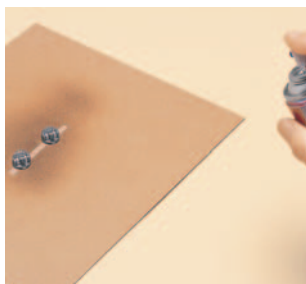

85 Take the bases of the machine-guns and insert the barrels in the respective holes in pieces **2**. Apply metal glue to the tips of the barrels. Fix them firmly. When ready, store the machine-guns carefully. They will be mounted in later stages of the assembly.



⚠ When using metal primer, ventilate the room well and follow the instructions on the packaging.

81 Allow the metal primer to dry, and spray a light and even coat of battleship grey paint, from a distance of about 30cm. Be careful not to fill in the original details.

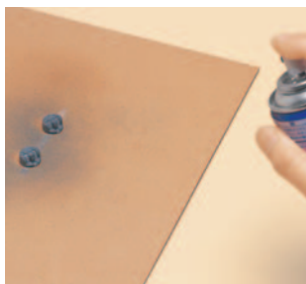

⚠ When using spray paint, ventilate the room well and follow the instructions on the packaging.

82 Repeat several times from different angles, allowing the paint to dry thoroughly between each coat.

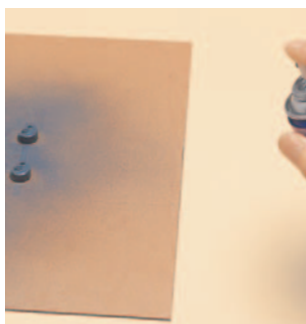

LOADLINE (PORT)

86 With the craft knife, cut a groove 0.5mm deep along the reference line previously drawn on the port side. Use a leftover strake as a ruler.



87 Following the lower end of the rounded part of the ship, cut a 0.5mm groove below the stern hangar.



83 Following Steps 80, 81 and 82, paint the barrels of the machine-guns. After spraying with metal primer, give several light and even coats of iron grey paint.

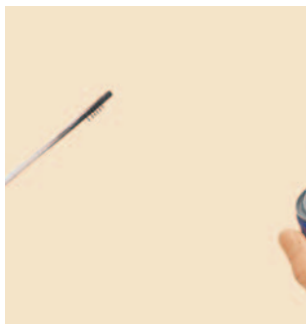

88 In the grooves made in Steps 86 and 87, insert the tip of the craft knife and make a groove in the shape of a 'V' (Figure B). Be careful not to cut too deep.

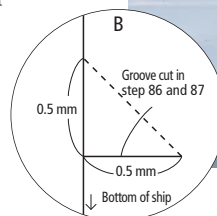
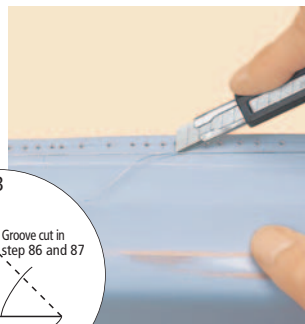

89 Use a round metal file to give the groove a semicircular shape. You can also use sandpaper wrapped around a thin rod. Take care not to smooth excessively.



90 Stretch the loadline (piece 5) by pulling it with the tips of your fingers. Make it as straight as possible. Starting at the prow, glue the loadline to the ship with fast-drying glue. Take care not to use too much glue.



91 Following the procedure described in Step 90, glue the loadline from the bow side of the hangar, to the point where the line angles downward (the red circle in the photo). When the glue is dry, cut the excess loadline on the stern side, taking care not to cut too much.

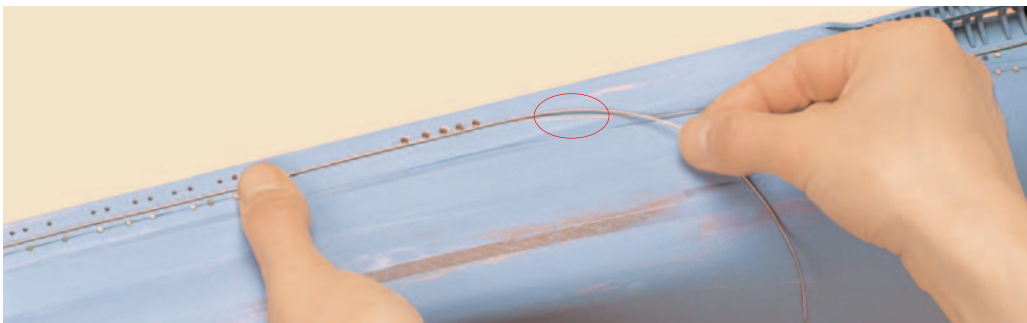

92 Cut a piece of the loadline to fit the sloping part of the line, and glue in place. Make sure that any cuts made to the loadline are oblique.

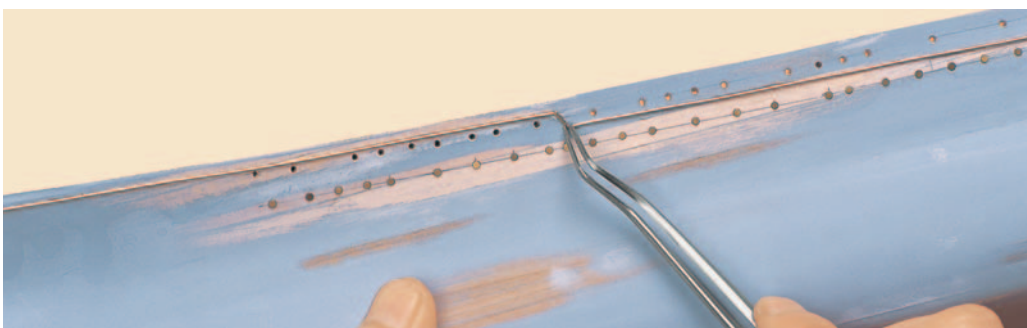

93 Following on from the part of the loadline glued in Step 91, glue the remaining loadline to the lower part of the hangar. The operation will be simpler if you bend the loadline to the shape of the hangar first.



94 Match the right-hand end of the loadline fixed in Step 93 to the loadline fixed on the surface of the hangar. When the glue is dry, use the pliers to cut the excess.



COMPLETED PIECES



LOADLINE (PORT)



MACHINE-GUNS WITH SHIELDING

