

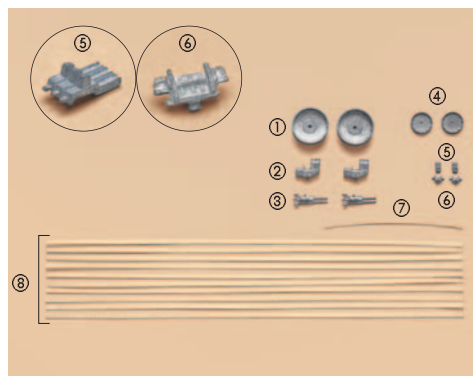

Machine-guns, anti-aircraft guns and decking



- ① Anti-aircraft gun base x 2
- ② Anti-aircraft gun (bottom) x 2
- ③ Anti-aircraft gun (top) x 2
- ④ Machine-gun base x 2
- ⑤ Machine-gun (top) x 2
- ⑥ Machine-gun (bottom) x 2
- ⑦ Wire x 2
- ⑧ Decking planks x 10

Recommended tools and materials

- Wood glue
- For metal: Super Glue Gel or Two-part epoxy glue
- Metal file
- Sandpaper (grain nos. 240 and 800)
- Craft knife
- Double-sided adhesive tape
- Adhesive tape
- Cutters
- Putty
- Pliers
- Metal primer
- Spray paint (iron grey and battleship grey)
- Watercolour (battleship grey and matt black)

MACHINE-GUNS

1 Smooth pieces 4, 5 and 6, using the metal file to remove any irregularities.



2 After an initial filing, smooth with sandpaper grain no. 800, taking care not to alter the original shape.



3 Where the sandpaper cannot reach, use the blade of the craft knife, taking care not to damage other parts of the pieces or cut yourself.



4 If there are holes or hollows on the surface, correct them by applying putty with the tip of the craft knife, or plank. When completely dry, smooth with sandpaper grain no. 800.

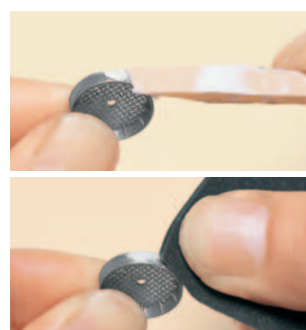

5 Cut the wire 7 with the pliers to get six pieces 5mm in length. To perform this operation, take a 5mm-wide strake and, as shown in the photo, match one end of the wire to it and secure with double-sided adhesive tape.



6 Following Step 5, arrange the six pieces of wire on the 5mm-wide strake, and with the metal file make them all the same length.



7 Take piece **5** as shown in the photo. With metal glue, fix three pieces of 5mm wire in the grooves, one by one. You have made the top of a machine-gun. Make another.

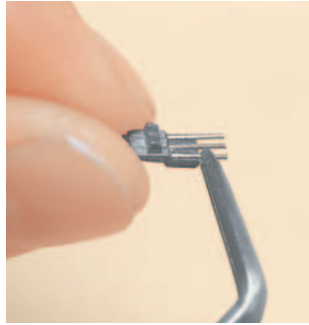

8 Take a 5mm-wide strake and make four holes, 1.2mm in diameter and 1mm in depth. Insert the projecting parts of pieces **6** in them and fix firmly. On the same plank, secure the machine-gun tops with double-sided adhesive tape. Spray the metal primer evenly on the pieces from a distance of about 30cm.



💡 When using metal primer, ventilate the room well and follow the instructions on the packaging.

9 When the metal primer is completely dry, spray a light and even coat of iron grey paint from a distance of about 30cm. Repeat the operation several times from different angles, allowing the paint to dry each time.



💡 When using spray paint, ventilate the room well and follow the instructions on the packaging.

10 Arrange pieces **6** as shown in the photo and, with metal glue, fix the machine-gun tops to the projections of each piece **6**. The machine-guns are ready.



11 Spray the metal primer evenly on pieces **4** from a distance of about 30cm. The operation will be simpler if you secure the pieces to a base with double-sided adhesive tape.

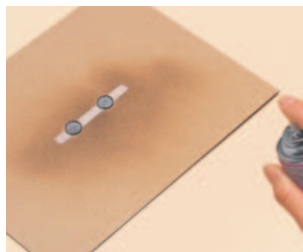

💡 When using metal primer, ventilate the room well and follow the instructions on the packaging.

12 When the metal primer is completely dry, spray a light and even coat of battleship grey paint from a distance of about 30cm, taking care not to cover the original shape. Repeat the operation several times from different angles, allowing the paint to dry each time.

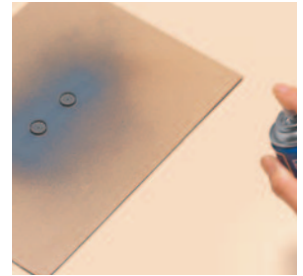

💡 When using spray paint, ventilate the room well and follow the instructions on the packaging.

13 Apply metal glue to the projection on the bottom of a machine-gun. Insert it into the hole in one of the pieces **4** and fix securely. Repeat with the other piece **4**.

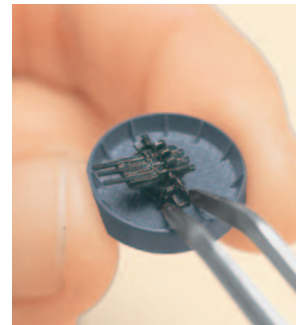

ANTI-AIRCRAFT GUNS

14 Smooth pieces **1**, **2** and **3** with the metal file to remove any irregularities. After an initial filing, smooth with sandpaper grain no. 800, taking care not to damage the original shape.

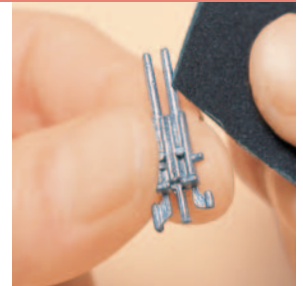

15 Where the sandpaper cannot reach, use the blade of the craft knife, being careful not to damage other parts of the pieces or cut yourself.

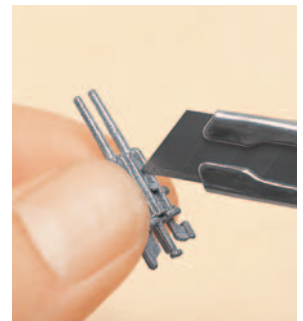

16 If there are any holes or hollows in the surface, correct them by applying putty with the tip of the craft knife, or plank. When the putty is completely dry, smooth with sandpaper grain no. 800.



17 As described in Steps 11 and 12, first spray the metal primer evenly from a distance of about 30cm, then spray battleship grey paint on pieces **1**, **2** and **3**. The operation will be simpler if you secure them to a base with double-sided adhesive tape.



⚠ **When using spray paint, ventilate the room well and follow the instructions on the packaging.**

18 Mixing equal parts of the two watercolours (battleship grey and matt black), take one of the pieces **2**, as shown in the photo, and paint the two cavities on the right side. Take care not to let the paint go beyond the cavity.



22 Stack five pieces **8**, keeping them together with adhesive tape. Cut off 1mm from one end of the block of stacked planks, then cut the block into segments of 98mm to get 15 planks and remove the tape. Repeat with the remaining planks **8**. In total, you will have 30 planks of 98mm.



23 Take the deck so far assembled, as shown in the photo. On the part indicated by the red circle, fix one of the 98mm-long planks with wood glue, continuing from the planks previously glued.

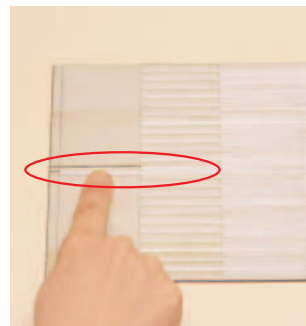

19 Taking pieces **2**, as shown in the photo, insert the semi-circular projections of pieces **3** in the grooves on the left side, and fix with metal glue. Angle the barrels to 30 degrees. You have made the anti-aircraft guns.



24 Below the plank fixed in Step 23, leave an empty space the equivalent size of a plank and, immediately below, glue another. To leave enough space, use a plank positioned on the left edge, as shown in the photo. Repeat to the end, alternating empty spaces.

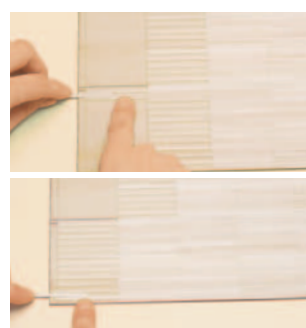

20 Apply metal glue to the projection on the bottom of one of the pieces **2**. Insert it into the hole of piece **1** and fix securely. The guns should face the flat side of piece **1**. Repeat the operation on the other piece **1**.



25 Repeat the operation in Steps 23 and 24 on the opposite side.



THE DECKING

21 Remove any roughness from the decking pieces **8**, rubbing gently with sandpaper grain no. 240. If they have different widths, work them with a sanding block, as shown in the photo. Fix the ends of the planks together with wood glue (Figure A).

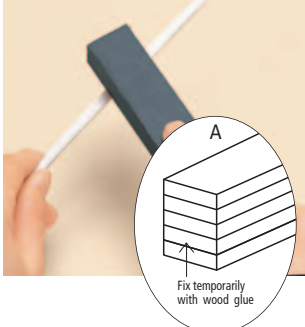

COMPLETED PIECES



ANTI-AIRCRAFT GUNS



DECK



MACHINE-GUNS



Anti-aircraft guns and decking

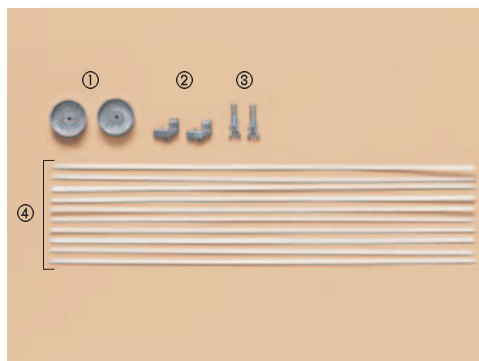
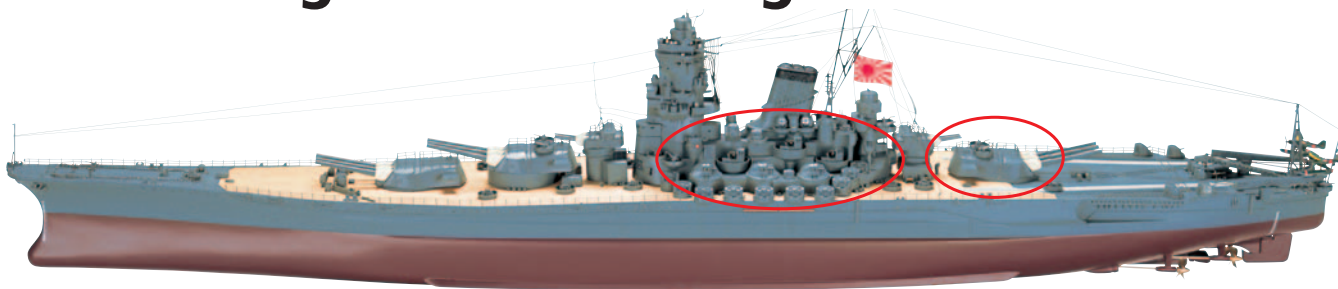

- ① Anti-aircraft gun base x 2
- ② Anti-aircraft gun (bottom) x 2
- ③ Anti-aircraft gun (top) x 2
- ④ Deck planking x 10

Recommended tools and materials

- Wood glue
- For metal: Super Glue Gel or Two-part epoxy glue
- Metal file
- Sandpaper (grain nos. 240 and 800)
- Craft knife
- Double-sided adhesive tape
- Adhesive tape
- Putty
- Pliers
- Metal primer
- Spray paint (battleship grey)
- Watercolour (battleship grey, matt black)

ANTI-AIRCRAFT GUNS

26 Smooth pieces 1, 2, 3 and 4 with the metal file to remove any irregularities.



29 If there are holes or hollows in the surface, correct them by applying putty with the tip of the craft knife, or plank.



27 After an initial filing, smooth with sandpaper grain no. 800, taking care not to damage the original shape.



30 When the putty is completely dry, smooth with sandpaper grain no. 800.



28 Where the sandpaper cannot reach, use the blade of the craft knife, being careful not to damage other parts of the pieces or cut yourself.

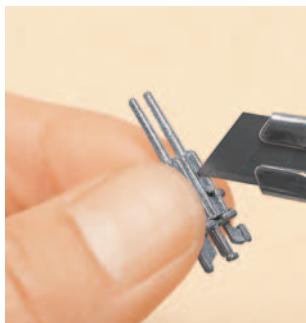

31 Spray metal primer evenly on all the pieces from a distance of about 30cm. To make the operation simpler, secure them to a base with double-sided adhesive tape.

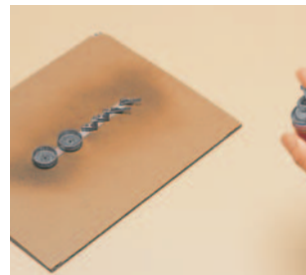

⚠ When using metal primer, ventilate the room well and follow the instructions on the packaging.

32 Once the primer is completely dry, spray a light and even coat of battleship grey paint from a distance of 30cm. Take care not to apply too much paint and mask the details.



⚠ When using spray paint, ventilate the room well and follow the instructions on the packaging.

33 Repeat the operation, spraying from different angles, and allowing the paint to dry each time.



34 Mix equal parts of the two watercolours (battleship grey and matt black). Take one of the pieces 2, as shown in the photo, and paint the two cavities on the right side. Take care not to let the paint go beyond the cavities.



35 Taking pieces 2, as shown in the photo, insert the semi-circular projections of pieces 3 in the grooves on the left side, and fix with metal glue. Angle the barrels to 30 degrees. You have made the anti-aircraft guns.



36 Apply metal glue to the projection on the bottom of one of the pieces 2. Insert it into the hole of piece 1 and fix securely. The guns should face the flat side of piece 1. Repeat the operation on the other piece 1.



37 Take the base of the command bridge, the six machine-guns and the four anti-aircraft guns built so far. Place the base of the bridge as shown in the photo and, with double-sided adhesive tape, fix an anti-aircraft gun in the semi-circular recess in the middle area towards the starboard bow. The barrel of the gun should be facing outwards.



38 Following Step 37, with double-sided adhesive tape, fix another anti-aircraft gun in the semicircular recess in the base of the bridge, at the middle area starboard towards the stern.



39 As in Steps 37 and 38, fix two anti-aircraft guns on the opposite side.



40 Take the piece so far assembled in Step 39, as shown in the photo. With double-sided tape, fix a machine-gun on the semi-circular projection of the middle area towards the starboard bow, the barrels pointing outwards.

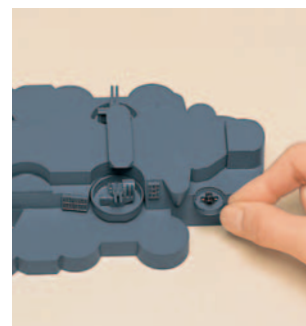

41 With double-sided adhesive tape, attach another machine-gun in front of the one mounted in Step 40, as shown in photo A. Place it with the barrels facing outwards, making it protrude slightly from the base of the command bridge.

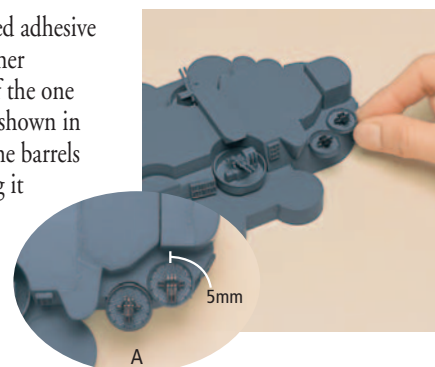

42 Take the piece so far assembled in Step 41, as shown in the photo. Attach another machine-gun on the starboard side on the upper part towards the stern (Photo B) using double-sided adhesive tape. Turn the barrels of the machine-gun to face outwards.

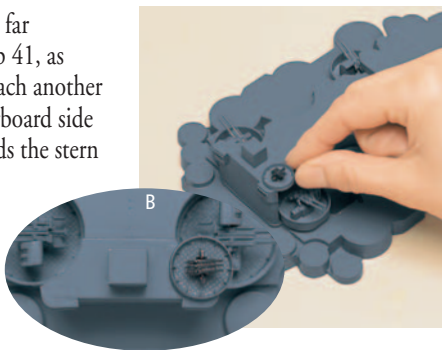

43 Following Steps 40 to 42, fix three machine-guns on the opposite side.



47 Take the decking and on the right end of the planks fixed so far, draw a vertical reference line perpendicular to the two central lines. Then, at a distance of 49mm to the right, draw a longitudinal reference line both on the top and on the bottom of the deck.

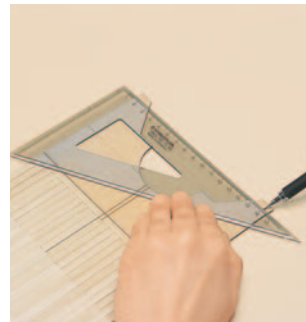

48 Take the piece, as shown in the photo, and fix a 98mm plank between the two central reference lines, aligning it with the left end of the planks fixed so far.

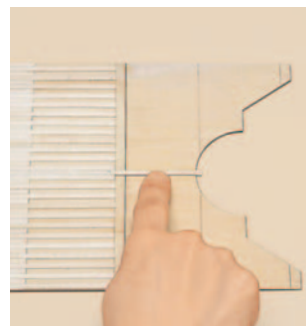

THE DECKING

44 Remove any roughness from the planks 4, rubbing gently with sandpaper grain no. 240. If they have different widths, work them with a sanding block, as shown in the photo. The operation will be easier if you temporarily fix the ends of the planks with wood glue (Figure C). Take care not to alter the original shape.

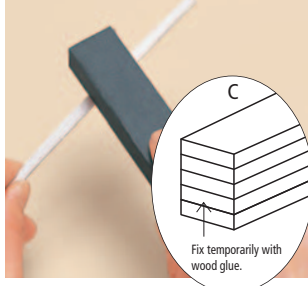

49 Take the piece as shown in the photo (right, above), and, below the plank fixed in Step 48, skip a column and fix a plank in the next one. To measure the space, use a leftover piece of plank, positioning it at the left side. Continue, skipping another column and fix another plank directly below, (right, below).

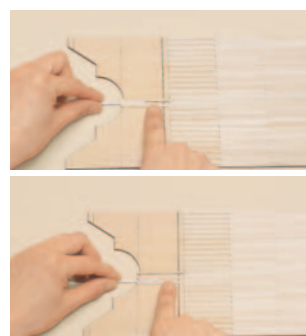

45 Stack five pieces 4, keeping them together with adhesive tape. With the craft knife, remove 1mm from one end of the stack of planks made in Step 44 to align the ends. Cut the block into sections of 98mm, to get 15 planks of that length. Remove the tape. Repeat with the other pieces 4, finishing with a total of 30 98mm planks.

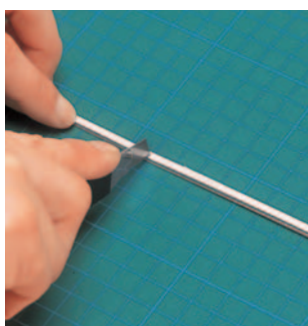

50 As in Step 49, glue the planks in sequence, each time skipping a column down to the lower edge. Following the same procedure, glue the planks on the opposite side (right, below).

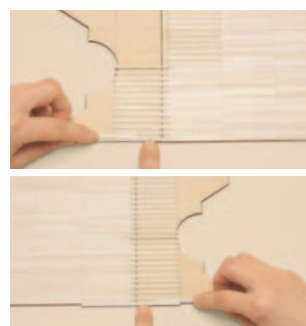

46 Take the deck so far assembled, as shown in the photo. With wood glue, fix the deck assembled in Despatch 9 to the right, ensuring that the two central lines are aligned.

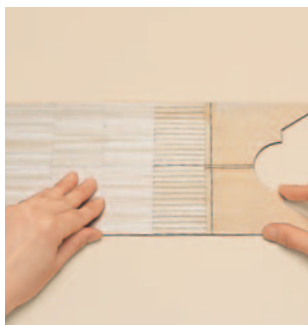

COMPLETED PIECES



THE DECKING

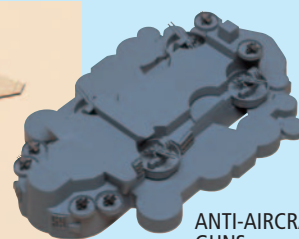

ANTI-AIRCRAFT GUNS

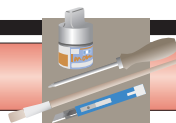

Anti-aircraft guns, details of the stern and decking

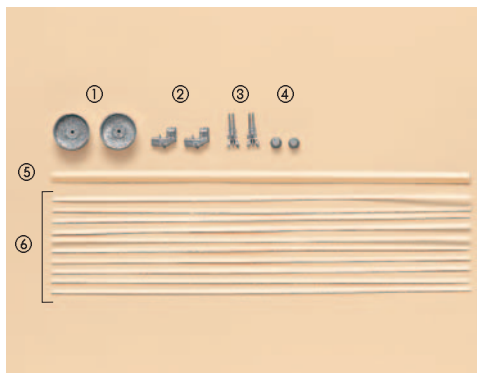

- ① Anti-aircraft gun base x 2
- ② Anti-aircraft gun (bottom) x 2
- ③ Anti-aircraft gun (top) x 2
- ④ Anti-aircraft gun (base) x 2
- ⑤ Plank
- ⑥ Decking x 10

Recommended tools and materials

- Wood glue
- For metal: Super Glue Gel or Two-part epoxy glue
- Metal file
- Sandpaper (grain nos. 240 and 800)
- Craft knife
- Double-sided adhesive tape
- Adhesive tape
- Putty
- Metal primer
- Spray paint (battleship grey)
- Watercolours (battleship grey and matt black)

ANTI-AIRCRAFT GUNS

51 Smooth pieces 1 to 4, using the metal file to remove irregularities, then rub them with sandpaper grain no. 800, taking care not to damage the original shape.



54 Referring to Step 62, fit pieces 1 in position on the base of the bridge. If they do not fit perfectly, smooth any projections using the metal file, as shown in the photo.



52 Where the sandpaper cannot reach, use the tip of the craft knife, being careful not to damage other parts of the pieces or cut your fingers.



55 Holding the piece 4, as shown in the photo, file one side so that it fits perfectly with piece 1 and with the base of the bridge.



53 If there are any holes or hollows in the surface, correct them by applying putty with a leftover plank. When the putty is completely dry, smooth with sandpaper grain no. 800.



56 Spray pieces 1 to 4 on all sides with metal primer from a distance of about 30cm. The operation will be simpler if you secure the pieces to a base with double-sided adhesive tape.

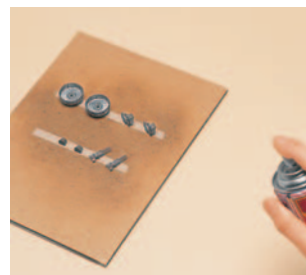

⚠ When using metal primer, ventilate the room well and follow the instructions on the packaging.

57 When the metal primer is thoroughly dry, spray a light and even coat of battleship grey spray paint from a distance of about 30cm. Repeat the operation from different angles, letting the paint dry thoroughly each time.



⚠ When using spray paint, ventilate the room well and follow the instructions on the packaging.

58 Mix equal parts of the two watercolours (battleship grey and matt black). Take one of the pieces **2**, as shown in the photo, and paint the two cavities on the right side. Take care not to let the paint go beyond the cavities.



59 Holding pieces **2**, as shown in the photo, insert the semicircular projections of pieces **3** into the grooves on the left-hand side. Adjust the barrels to a 30 degree angle. You have made the anti-aircraft guns.



60 Glue piece **4** to piece **1** in the position shown in the photo. The flat surfaces between the base of the bridge and pieces **1** and **4** should fit together securely (Photo A).

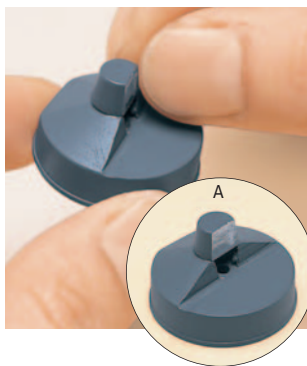

61 Apply fast-drying glue to the projection on the bottom of one of the pieces **2**. Insert it in the hole of piece **1** and fix it well. The guns should face towards the flat side of piece **1**. Repeat the operation on the remaining piece **1**.



62 Take the base of the command bridge built so far, as shown in the photo. With metal glue, fix an anti-aircraft gun in the semi-circular recess in the middle of the starboard side. Do the same on the other side.



DETAILS OF THE STERN

63 With the craft knife, cut piece **5** into two lengths of 75mm, and two of 50mm.

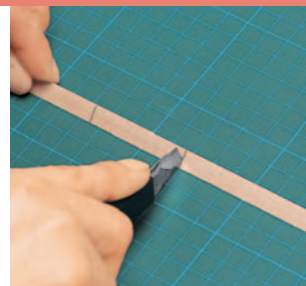

64 Take the hull, as shown in the photo. Place a 75mm plank on the keel at the stern, next to the fin nearest to the bow. Fit it to both the hull and the fin. There will be a small space between the keel and the plank (Figure B).

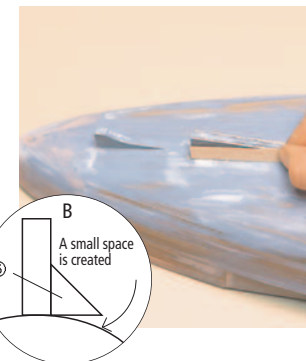

65 Remove the plank and shape the edge that touches the hull so that it fits perfectly, without gaps (Figure C). To achieve this, first scrape with the craft knife and then smooth with sandpaper.

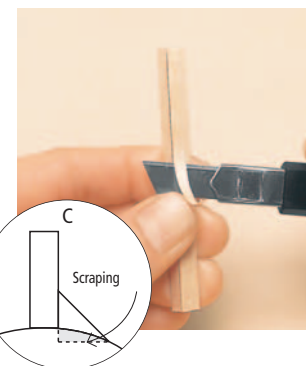

66 Smooth the surface of the piece with sandpaper to achieve a curve (Figure D). It is advisable to wrap the sandpaper around a rod with the diameter of a pencil.

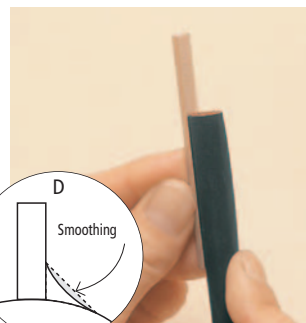

67 Glue the piece finished in Step 66 in the position shown in Step 64. Repeat the operation described in Steps 64 to 66 on the other 75mm piece and glue it on the opposite side of the hull. Repeat the same operation for the 50mm planks, gluing the pieces to the keel fin located further towards the stern.



68 With the craft knife, remove the protruding part of the piece glued in Step 67. Take care not to damage the keel.



69 With the craft knife, remove the part of the piece worked in Step 68, giving a slight curve to the section that touches the keel (Figure E). Repeat the operation with the 50mm plank glued to the keel fin closest to the stern.

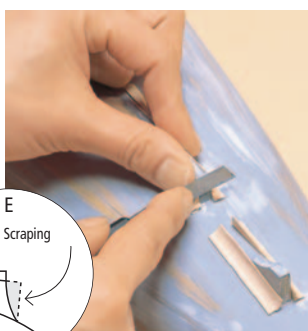
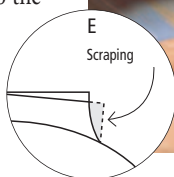

70 With sandpaper, finish the parts worked in Steps 68 and 69. Smooth the joints, as shown in the photo, to achieve an even surface. Be careful not to smooth the hull too much.



71 Using a rod, apply putty to fill the joints between the pieces fixed in Steps 68 and 69 and the keel. When the putty is completely dry, smooth with sandpaper. Then, spray evenly over the putty.

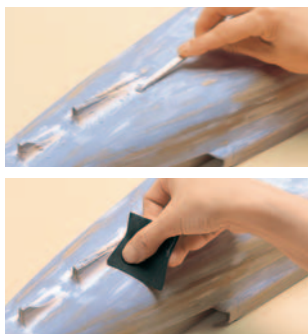

THE DECKING

72 Remove any roughness from the planks **6**, rubbing gently with sandpaper grain no. 240. If they have different widths, work them with a sanding block, as shown in the photo. The operation will be easier if you temporarily fix the ends of the planks with wood glue (Figure F).

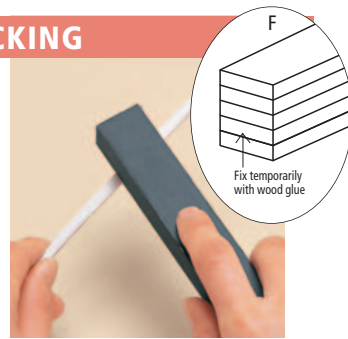

73 Stack five pieces **6**, keeping them together with adhesive tape. With the craft knife, remove 1mm from one end of the stack of planks made in Step 72 to align the ends. Cut the block into sections of 98mm, to get 15 planks of that length. Remove the tape. Repeat with the other pieces **6**, finishing with a total of 30 98mm planks.



74 Take the deck so far assembled, as shown in the photo. With wood glue, fix a 98mm-long plank in the space between those already set, in the centre of the deck. Fix the plank, inserting the right side in the space between the planks while the left projects from the deck. Leave a space below, and fix another plank directly below this.

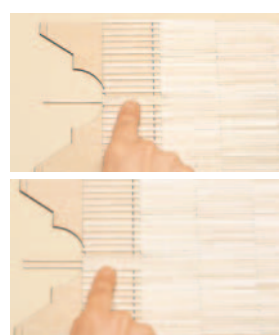

75 Repeat the operation down to the lower end of the deck, skipping a space between every plank. Measure the empty spaces, using a leftover piece of plank. Do the same on the other side. Take care not to damage the projecting parts.

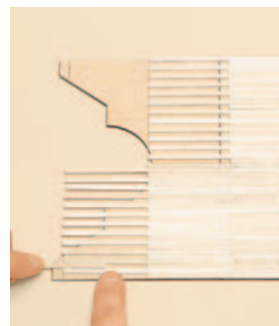

COMPLETED PIECES

ANTI-AIRCRAFT GUNS

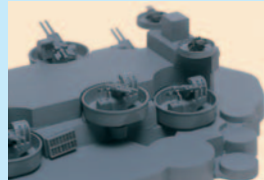

THE
DECKING



DETAILS OF
THE STERN

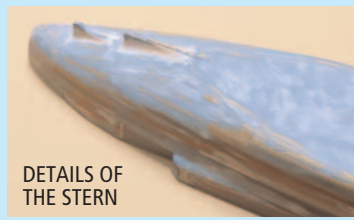



Machine-guns with shielding, decking and hangar supports

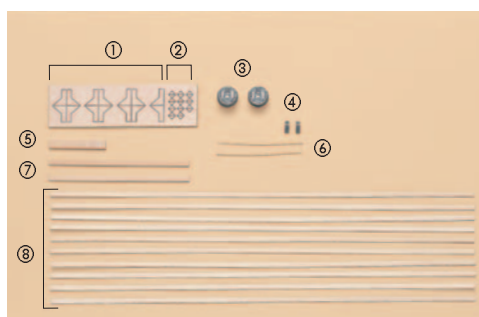

- ① Hangar supports x 14
- ② Hangar supports x 14
- ③ Machine-gun with shielding x 2
- ④ Machine-gun with shielding x 2
- ⑤ Plank
- ⑥ Wire x 2
- ⑦ Planks x 2
- ⑧ Deck planks x 10

Recommended tools and materials

- Fast-drying glue
- Wood glue
- For metal: Super Glue Gel or Two-part epoxy glue
- Metal file
- Sandpaper (no. 240, 800)
- Craft knife
- Tweezers
- Pliers
- Double-sided adhesive tape
- Adhesive tape
- Putty
- Pencil
- Tracing paper
- Metal primer
- Wood primer
- Spray paint (battleship grey, iron grey)
- Watercolour (battleship grey, matt black)

MACHINE-GUNS WITH SHIELDING

76 Smooth pieces 3 and 4, using the metal file to remove irregularities, then rub them with sandpaper grain no. 800, taking care not to damage the original shape. Correct any holes or hollows in the surface by applying putty.



79 Spray the bases of the machine-guns with metal primer and allow to dry thoroughly. Then, spray with battleship grey paint, repeating the operation several times from various angles.

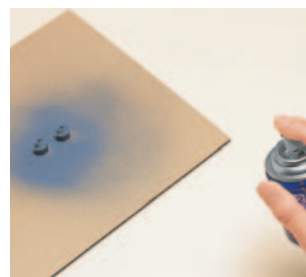

⚠ When using metal primer and spray paint, ventilate the room well and follow the instructions on the packaging.

77 Take a piece 3, as shown in the photo, and fix a piece 4 onto the central cavity with metal glue. If necessary, adjust it with the metal file and sandpaper grain no. 800. You have now created the base of a machine-gun with shielding. Assemble the other.



80 Spray the barrels of the machine-guns with metal primer and allow to dry. Then, spray with iron grey paint, repeating the operation if necessary. Allow the paint to dry thoroughly each time.



⚠ When using metal primer and spray paint, ventilate the room well and follow the instructions on the packaging.

78 With the pliers, cut six 5mm-long pieces of the wire. Do this by taking a 5mm-wide piece of strake and, as shown in the photo, match up one end of the wire and fix with double-sided adhesive tape. Smooth the ends of the wire with the metal file. These are the barrels of the machine-guns.

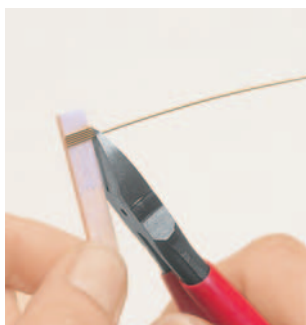

81 Mix equal parts of the watercolours (battleship grey and matt black). Take the bases of the machine-guns, as shown in the photo, and paint the left and right cavities. Take care not to let the paint go beyond the cavities.

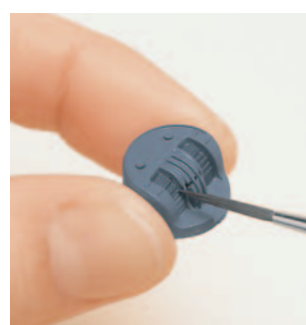

82 Apply a drop of metal glue to the tip of the barrels, and insert them into the respective holes of pieces **4**, fixing securely. When ready, keep the assembled pieces carefully. They will be mounted at a later stage.



87 When the paint is dry, take the foredeck built previously and join the two ends of the stern. Mark the parts that extend beyond the outer walls with a pencil.



THE DECKING

83 Take the deck so far assembled, as shown in the photo, and with wood glue fix a piece **8** plank in the area circled in red. Insert and glue the right end of the plank in the space between those already fixed, letting the left end protrude.

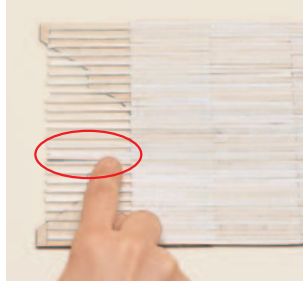

88 Remove the foredeck, and, with the craft knife, eliminate the part marked. Cut gradually, checking from time to time that the outline of the aft deck fits the hull so as not to cut too much.

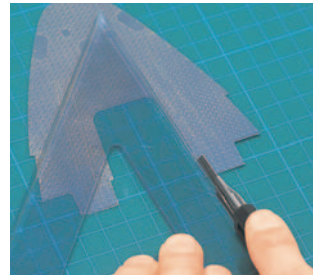

⚠ If necessary you can also use metal shears.

84 Repeat the operation described in Step 83 until the existing spaces are completely filled with planks. Planks must also be fixed where the deck below can be seen (highlighted by the red circle). Repeat the operation on the other side.

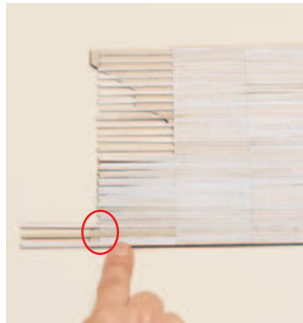

89 Fix the shaped foredeck to the hull with fast-drying glue (right). When the glue is dry, spray again with battleship grey paint, taking care to spray evenly and not to smear the paint.

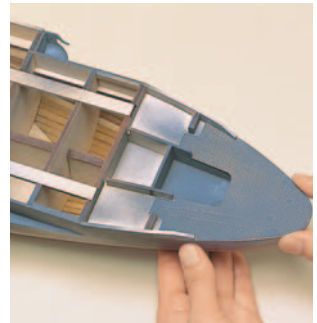

85 When the glue is dry, turn the deck over and remove the excess of the planks with a craft knife. Do not cut off everything at once, but repeat the operation with small cuts, then lightly smooth the areas with sandpaper wrapped around a block.



90 Take the foredeck previously assembled, and glue it to the hull, slotting the jutting part into its proper location, as shown in the photo (red circle). If the inside of the hull is visible through the triangular cuts on the sides, use leftovers of the outer covering between the 15th and 16th frames (Photo A).

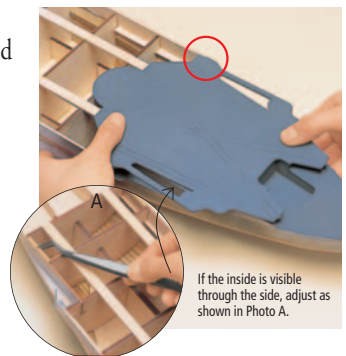

HANGAR SUPPORTS

86 Place the hull so far assembled, as shown in the photo. Spray the stores of ammunition left, right and centre aft (red circles) with wood primer. Allow to dry, then spray several times with battleship grey paint.

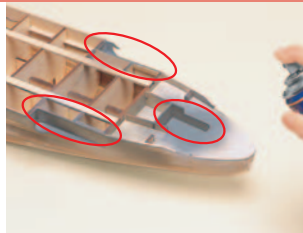

⚠ When using primer and spray paint, ventilate the room well and follow the instructions on the packaging.

91 Paint both sides of pieces **1**, **2** and **7**. First, spray with primer, and allow to dry thoroughly. Then, spray several times with battleship grey paint. The operation will be simpler if you prop the pieces on a raised base made from cardboard.

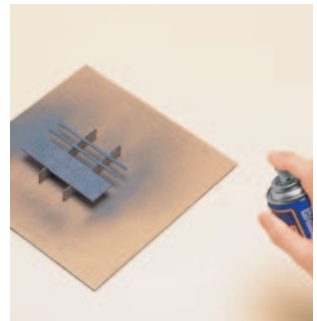

92 When the paint is dry, remove pieces **1** and **2** from the backing. Break the joints by inserting the blade of the craft knife in the cuts, then smooth the edges of the pieces with sandpaper.



97 Place a piece **1** between the two red lines on the stern side, in the position shown in the photo. In the part that touches the hull a small space will be created, while the other part will protrude slightly over the blue line.



93 As shown in the photo, take the plan contained in the package and place the tracing paper over it, matching the upper corner respectively with the lines a and b (Figure B). Trace the lines shown in red, blue and green. Keep the plan for later use.

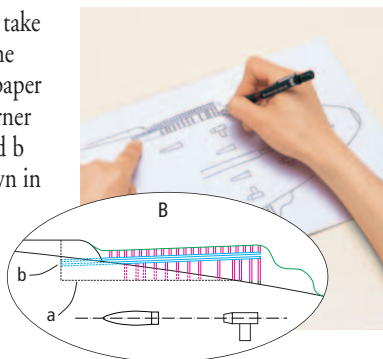

98 Temporarily remove the piece **1**, and, with sandpaper, smooth the edge that joins the hull, so that the piece fits without leaving any space. File it a little at a time, checking the shape against the hull so you do not remove too much. Also, file the other part that extends beyond the blue line.

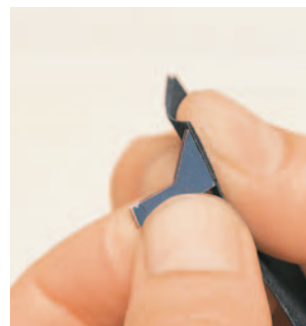

94 Turn the hull over and position it as shown in the photo. Insert the paper traced in the previous step upside down under the hull, as far as the ammunition store. If necessary, cut it so that it does not touch the metal parts.



99 Once the piece is adjusted, glue it in the position shown in Step 97. Then, glue the two pieces **7**, following the blue line in Figure B. First, however, insert the left end of pieces **7** as far as the ammunition store and cut the left edge to the required length.



95 If the metal parts of the munitions store touch the blue line, adjust them by bending their ends toward the stern with pliers. During this operation, take care not to damage the surrounding metal parts. It is a good idea to wrap the tips of the pliers with adhesive tape.



100 Glue the remaining pieces **1** to the points outlined by the red lines, between piece **7** and the hull. As for the empty area, fit the two edges of the pieces **1** both to the hull and to piece **7**. Then, glue the pieces **2** in front of piece **7**, fixing them to the deck securely. The painting will be completed along with the hull.



96 With a pencil, trace the lines marked in red and blue to transfer them onto the hull, holding the tracing paper with the green line of Figure B aligned with the deck. Referring to the drawing, make marks on the outer edges of the deck, where the cuts are, on the side of the hull.



COMPLETED PIECES

HANGAR SUPPORTS

MACHINE-GUNS
WITH SHIELDING

THE DECKING

