



Cosmo **SPORT**



PACK 04

DEAGOSTINI
MODELSPACE™
www.model-space.com



Cosmo **SPORT**

STAGE

24	DETAILS – 2
25	THE DISTRIBUTORS
26	THE FAN
27	THE RADIATOR
28	THE BODY – FRONT END
29	THE FRONT LEFT MUDGUARD
30	THE FRONT RIGHT MUDGUARD
31	THE FRONT SUSPENSION SYSTEM
32	THE FRONT PLATFORM

P.

51

53

57

59

61

63

65

67

71



DEAGOSTINI
MODELSPACE™
www.model-space.com

Designed and produced by Milanoedit srl – www.milanoedit.com

Published by De Agostini Publishing S.p.A., 28100 Novara,
Via G. da Verrazzano 15

All rights reserved © 2020

NOT SUITABLE FOR CHILDREN UNDER THE AGE OF 14.

THIS PRODUCT IS NOT A TOY AND MUST BE USED UNDER
THE SUPERVISION OF AN ADULT.

ITEMS MAY VARY FROM THOSE SHOWN.

24 DETAILS – 2

In this stage you will attach a few details, like the dynamo and water pump, to the engine of your 1:8 scale model. The pieces are very small, so be careful not to damage them.

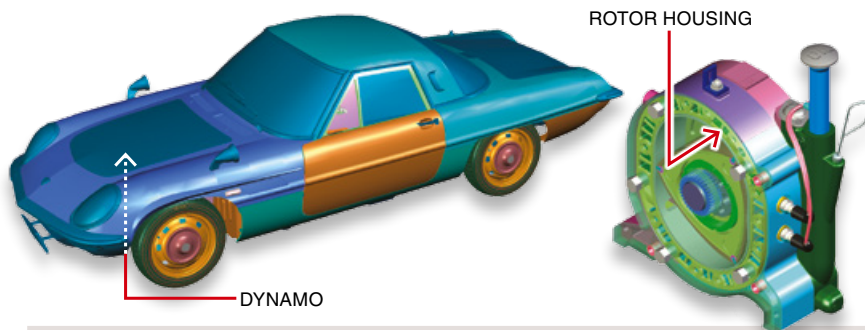

TOOLS NEEDED

- Cross screwdriver no. 1

LIST OF PIECES

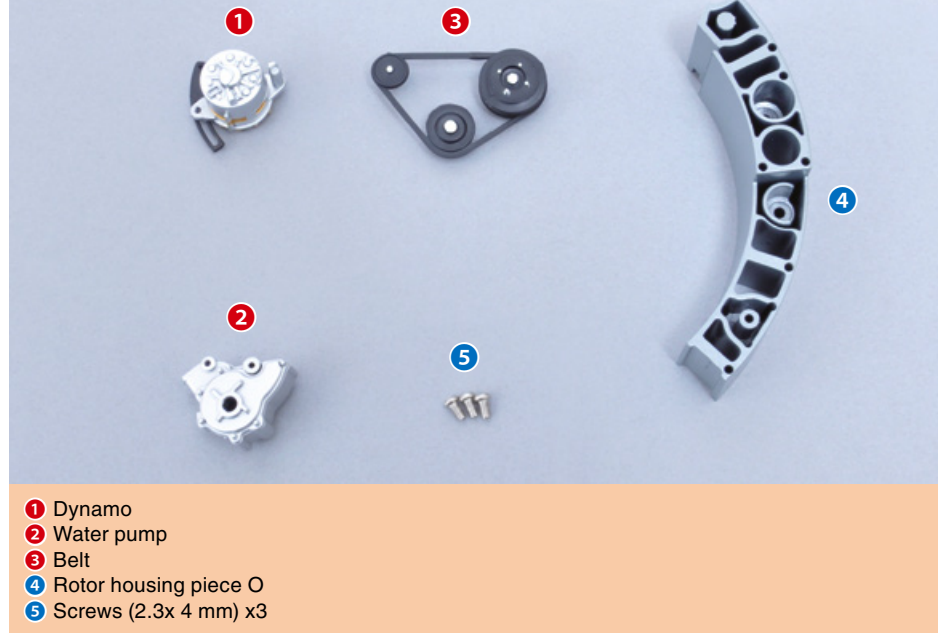

• Parts for the 1:8 scale Mazda Cosmo Sport model car • Parts for the 1:2 scale rotary engine

COSMO SPORT

Step

1

The water pump

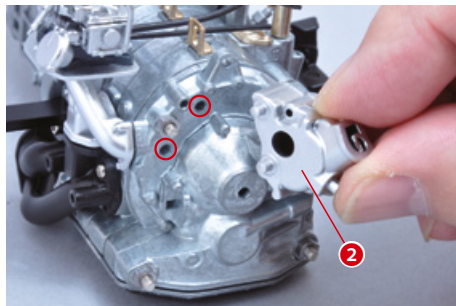

Attach the water pump to the engine block by inserting the linchpins on the pump into the holes in the block, circled in the photo.

Press until the pieces click into place.



COSMO SPORT

Step

2

The dynamo



Attach the dynamo using the corresponding interlocking elements indicated in the photo.

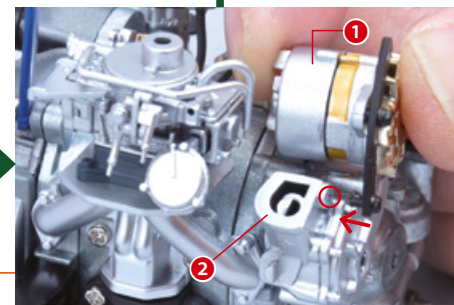

Now insert the small linchpin on the black part of the dynamo into the hole in the water pump, indicated in the photo.



The dynamo, installed correctly.



COSMO SPORT

Step 3 The belt

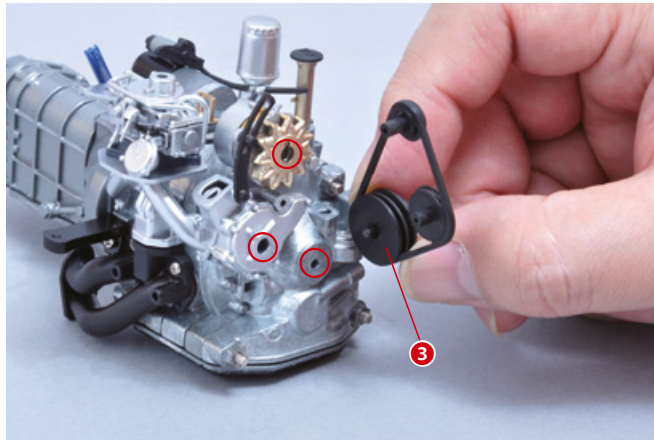

Now attach the belt and its pulleys by inserting the linchpins on the first into the holes in the dynamo and water pump, circled in the photo.

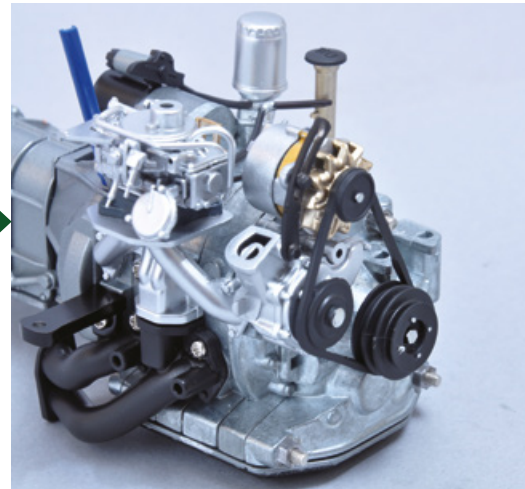

The belt attached correctly to the engine block.

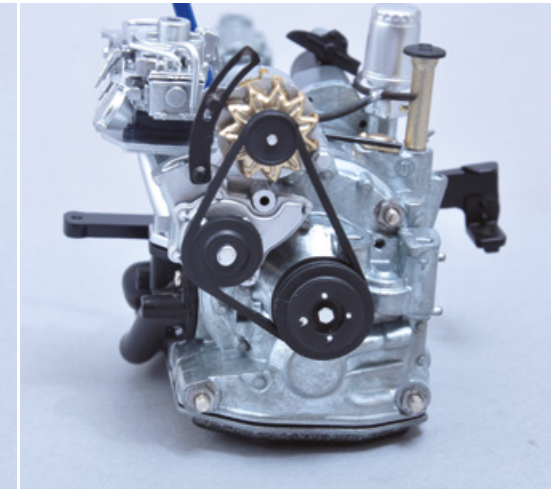

ROTARY ENGINE

Step 4 The rotor housing

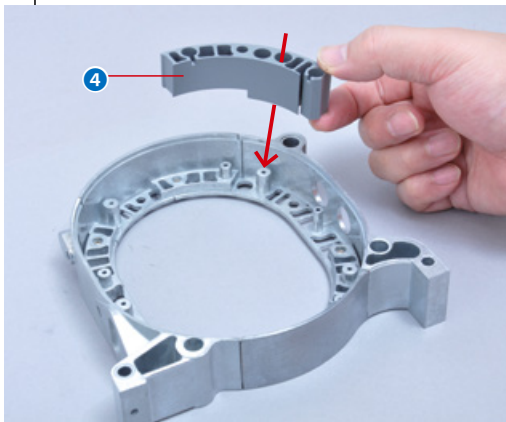

Attach piece O of the rotor housing to the part you assembled in the previous stages.

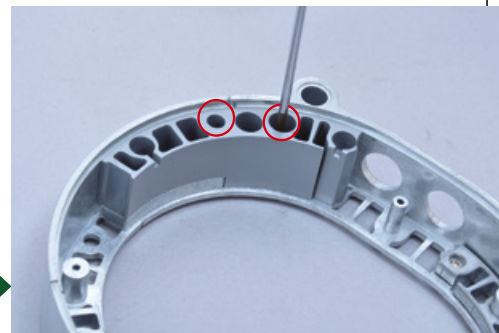

Insert and tighten two of the screws that came with this stage in the circled holes.

FINAL RESULT

This is the result of this easy assembly session. Keep the pieces in a safe place.



The next stage





25 THE DISTRIBUTORS

In this stage you will attach the distributors and other components to the engine block. Follow the instructions and explanatory photographs carefully.

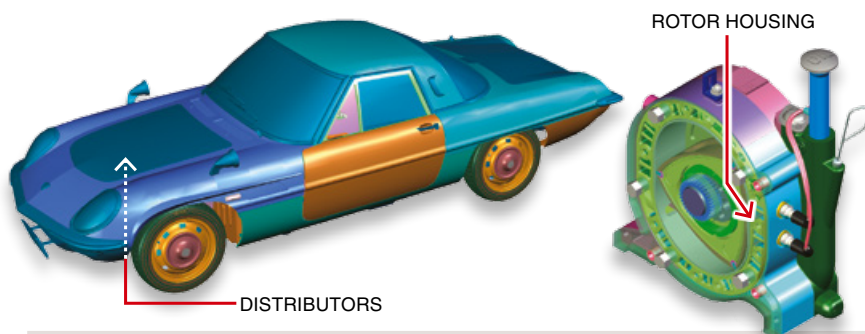

TOOLS NEEDED

- Cross screwdriver no. 1
- Instant glue
- Tweezers
- Pliers or cutting pliers

RECOMMENDED TOOLS

- Flat file or sandpaper
- Scissors

LIST OF PIECES

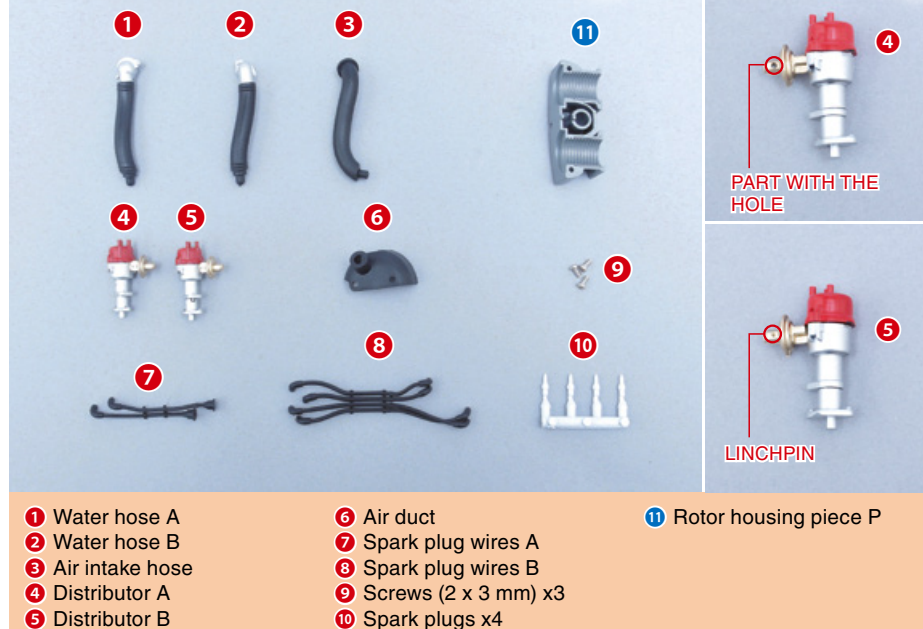

• Parts for the 1:8 scale Mazda Cosmo Sport model car • Parts for the 1:2 scale rotary engine

COSMO SPORT

Step

1

The spark plugs

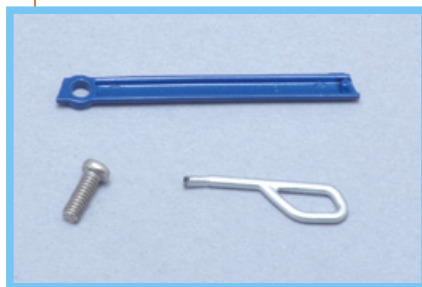

Before starting this assembly session, we recommend that you temporarily remove the more delicate pieces from the engine block, shown in the photo. You will reattach them in a later stage.

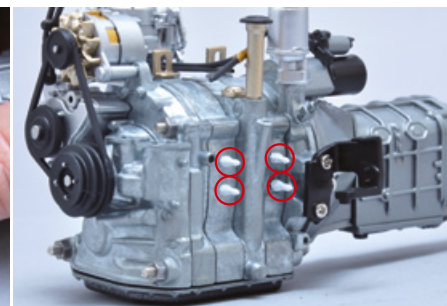
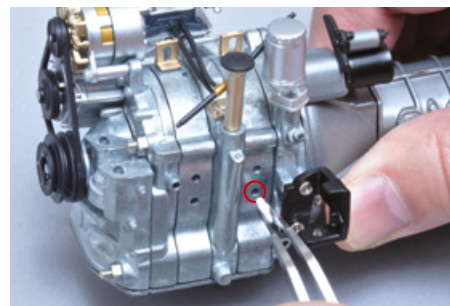

Insert the four spark plugs into the corresponding holes in the left side of the engine block. Look at the photo to see which way they should go.

Using a pair of pliers or cutting pliers, detach the four spark plugs from the mould.

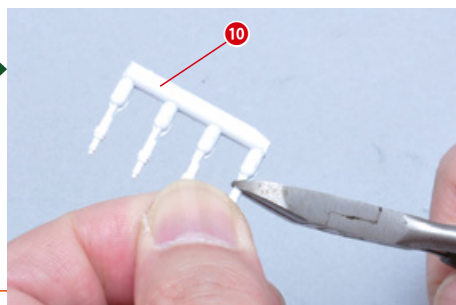

CUT ALONG THE RED LINE

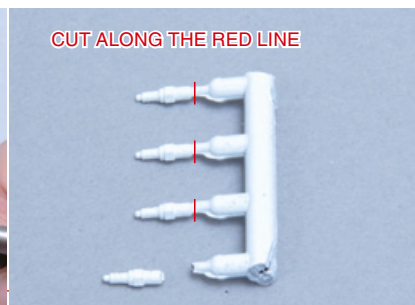

Apply a drop of glue to the bottom of the spark plugs to secure the pieces.





COSMO SPORT

Step

2

The spark plug wires – 1

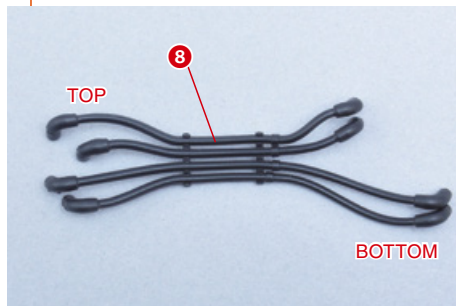

The type B spark plug wires have different lengths. Look at the photos on this page very carefully.

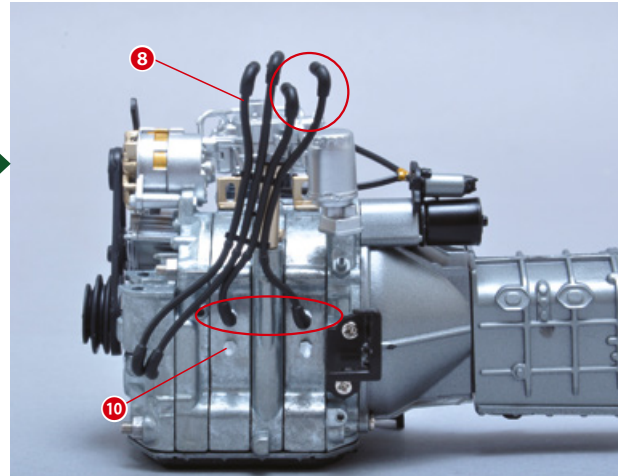

Start by attaching the two shorter bottom wires to the two spark plugs circled in the photo.

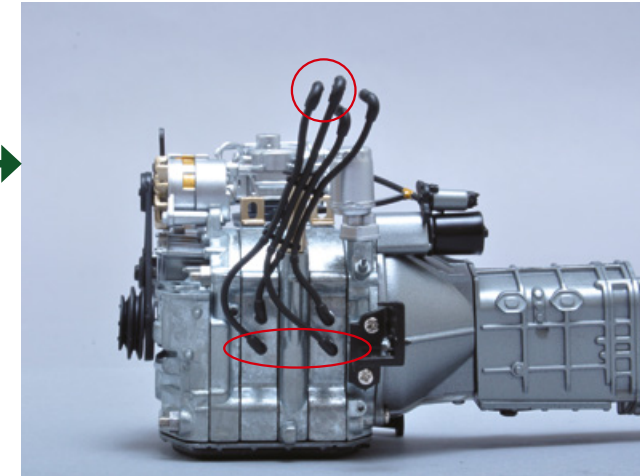

Attach the two longer bottom wires to the remaining two spark plugs.

COSMO SPORT

Step

3

Spark plug wires – 2

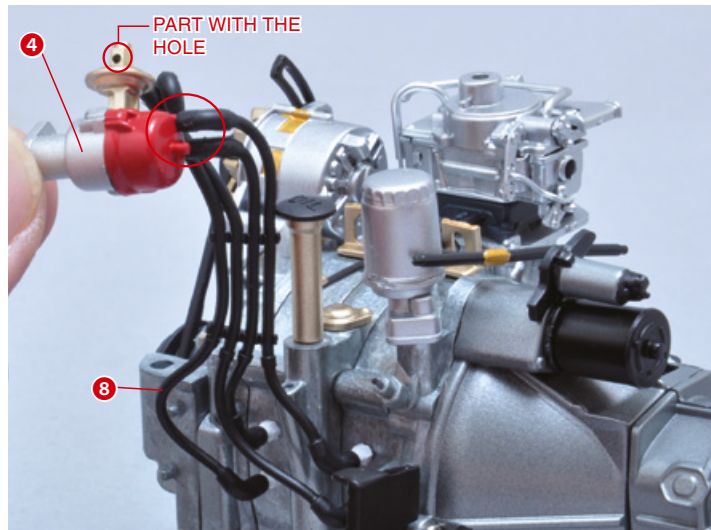

Attach the two wires on the top of the right half to the distributor cap A, as shown in the photo.

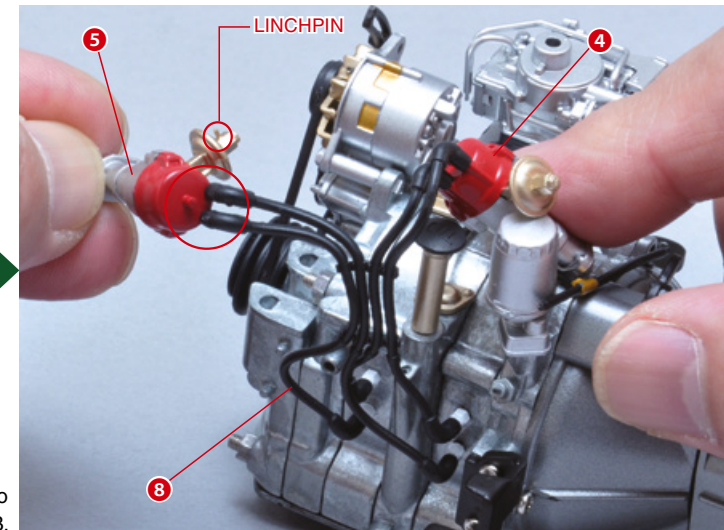

Attach the remaining two wires to distributor cap B.

COSMO SPORT

Step

4

The distributors – 1



If you like, you can apply a drop of glue to bottom of both distributors to secure the pieces.

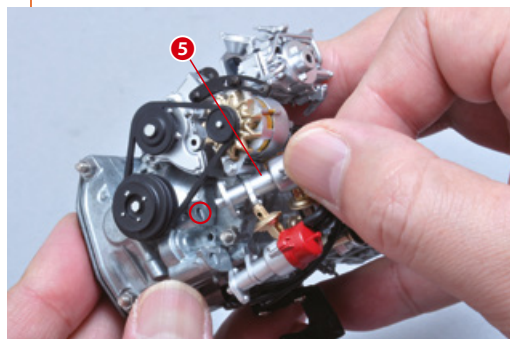
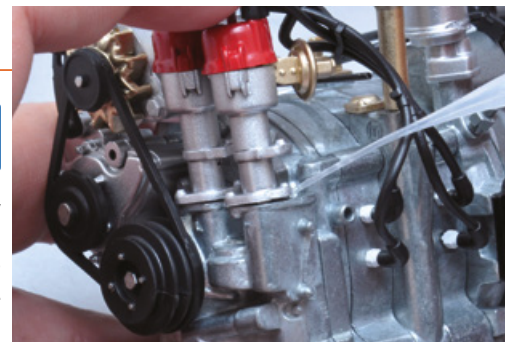

Attach distributor B to the engine block, using the interlocking elements circled in the photo.

Now attach distributor A to the engine block in the same way.

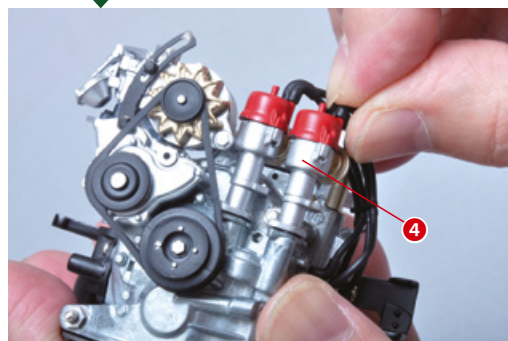

Ensure that the distributors and spark plug wires are facing the same way as those in the photo on the right.

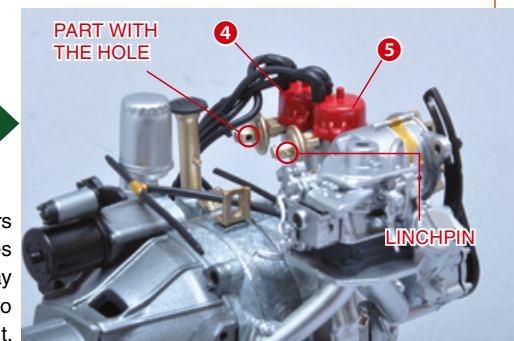

COSMO SPORT

Step

5

The distributors – 2

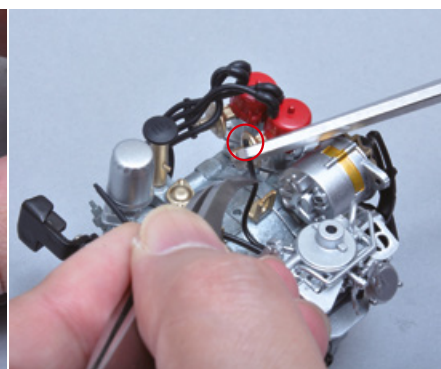
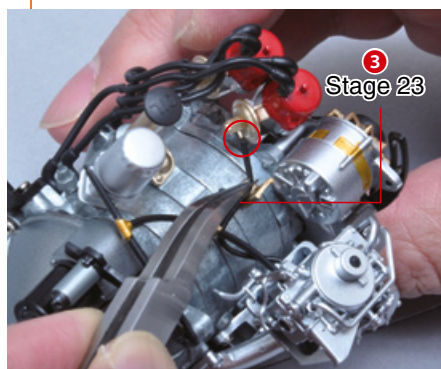

Find the two flexible hoses that come out of the carburettor mount plate (part 3 stage 23) and attach the one that isn't split to the linchpin on distributor B. If you find it difficult, you can shorten the end of the hose slightly.



Now insert the shorter end of the other flexible hose into the hole in distributor A, as shown in the photo.



Look carefully at the photo and attach the two spark plug wires A to the remaining the distributor caps.



COSMO SPORT

Step 6 The air duct

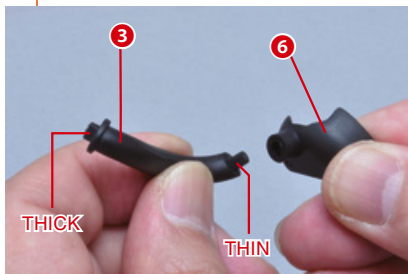

Attach the air intake hose to its duct, using the photo to help you.

Put the air duct on the right side of the engine block, as shown in the photo.

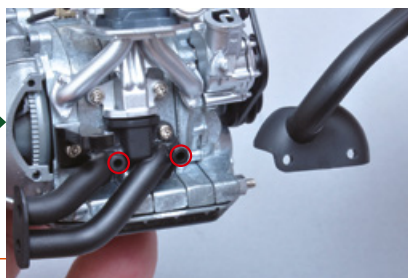

Insert and tighten two of the screws received with this stage to secure the pieces.

COSMO SPORT

Step 7 The water hoses

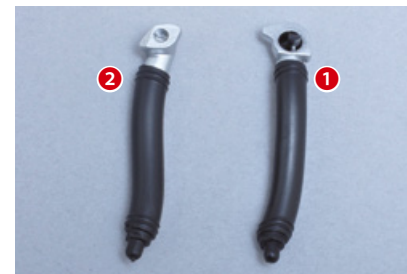

Place the two water hoses on your work surface.

Using the photo on the right to help you, attach hose A to the engine block.

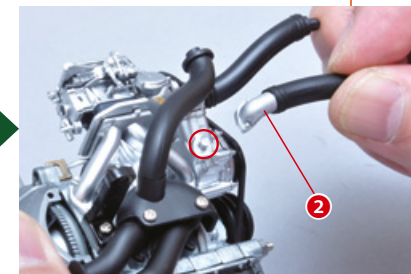
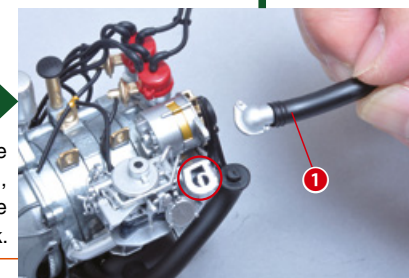

Attach hose B in the same way.

ROTARY ENGINE

Step 8 The rotor housing

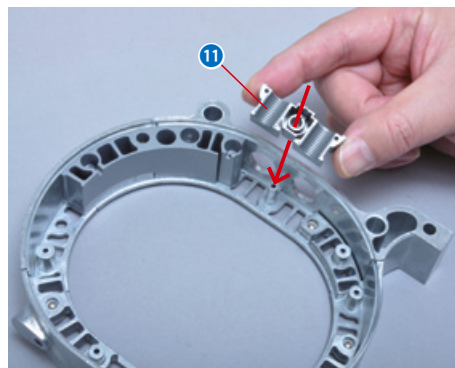

Attach piece P of the rotor housing to the part you assembled in the previous stages.



Check that you have attached all the components correctly.

FINAL RESULT

This is the result of this long and satisfying assembly session. Keep it in a safe place with the other pieces.

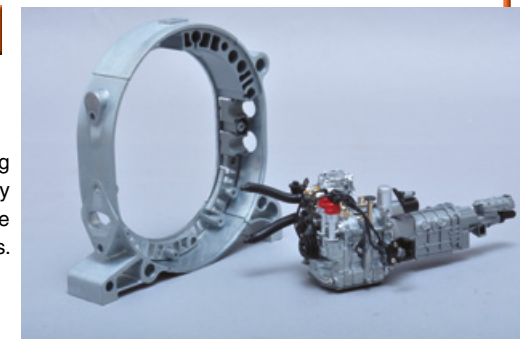

The next stage





26 THE FAN

In this stage you will attach the fan to the engine block, assemble the oil cooler and continue to work on the rotor housing you started in the previous stages.

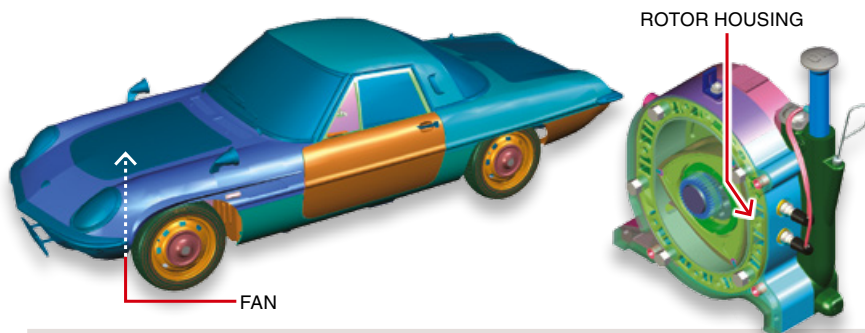

TOOLS NEEDED

- Cross screwdriver no. 1

RECOMMENDED TOOLS

- Hammer
- Board

LIST OF PIECES

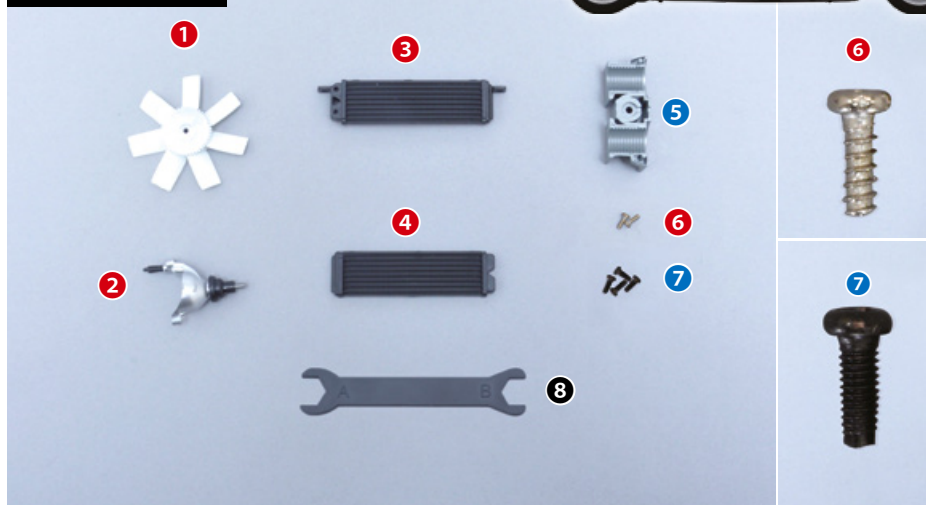

- 1 Fan
- 2 Fan mount bracket
- 3 Oil cooler A
- 4 Oil cooler B
- 5 Rotor housing piece Q
- 6 Screws A (1.7 x 5 mm) x2
- 7 Screws B (2.3 x 6 mm) x4
- 8 Spanner

• Parts for the 1:8 scale Mazda Cosmo Sport model car • Parts for the 1:2 scale rotary engine

COSMO SPORT

Step 1 The oil cooler

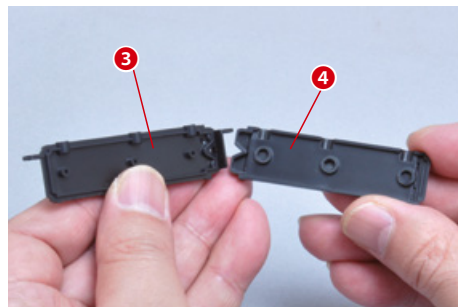

Using the photo to help you, join the two parts of the oil cooler.

You have now completed the oil cooler.



COSMO SPORT

Step 2 The fan – 1

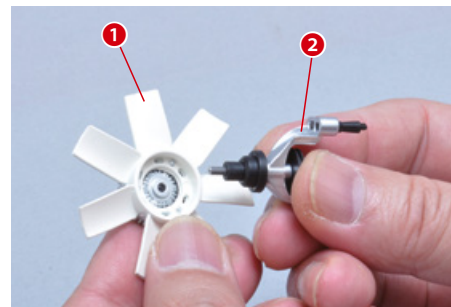

Insert the linchpin on the mount bracket in the hole in the middle of the fan, as shown in the photo.

If you find it difficult to insert the linchpin, use a board and hammer, as shown in the photo.



Once the fan is attached to its bracket, there should be a space of about 1 mm between the two pieces.



COSMO SPORT

Step 3 The fan – 2

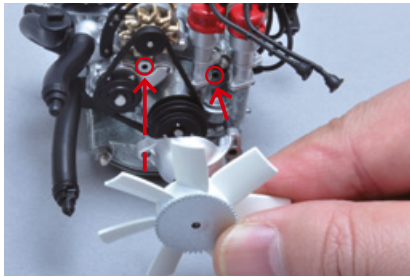

Attach the completed fan to the engine block, as shown in the photo.



Insert and tighten a type A screw in the hole indicated in the photo to secure the pieces.

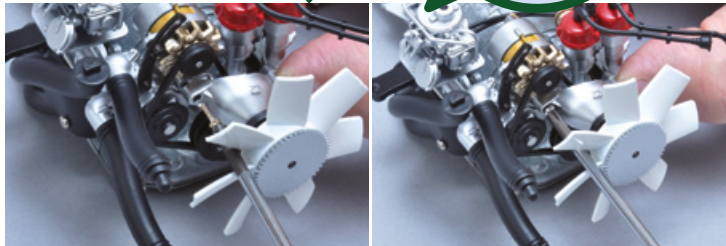

ROTARY ENGINE

Step 4 The rotor housing

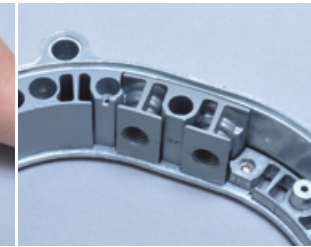
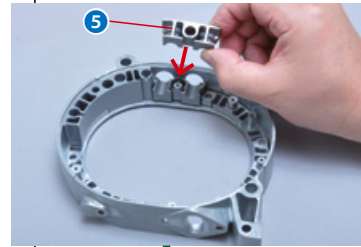

Attach piece Q of the rotor housing to the part you assembled in the previous stages.

Use a type B screw to secure the pieces.

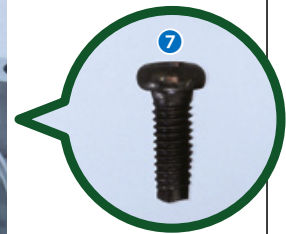
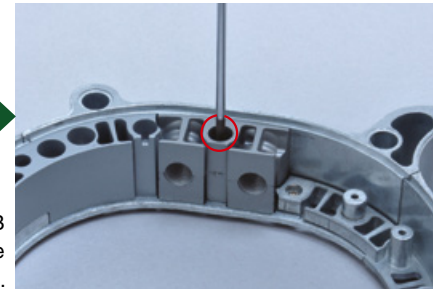

ROTARY ENGINE

Step 5 The spark plugs – temporary assembly



Try screwing a spark plug (part 4 stage 14 or part 4 stage 16) into the holes on the side of the housing to check for problems. Remove it after testing.



You can use the spanner you received with this stage to help you. Make sure you don't tighten the spark plug too much.

FINAL RESULT

This is the result of this assembly session. Keep everything in a safe place with the other pieces.



The next stage



27

THE RADIATOR

In this stage you will assemble the radiator of your 1:8 scale model of the Mazda Cosmo Sport. Before starting, get the front suspension that you worked on in the previous stages.

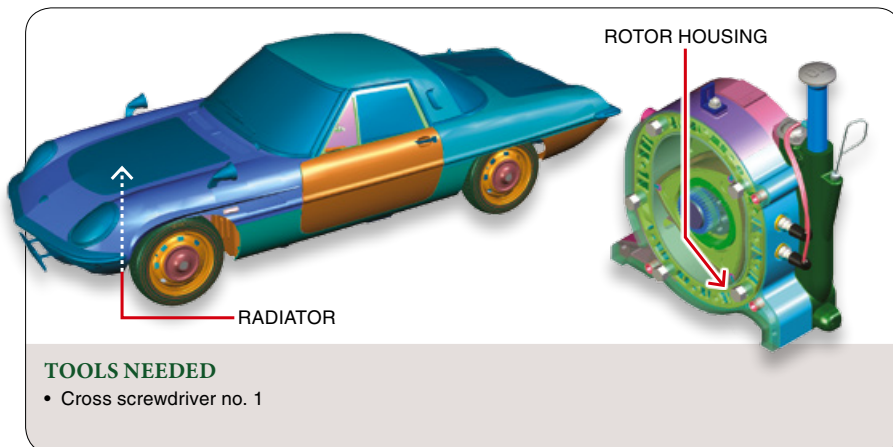

LIST OF PIECES

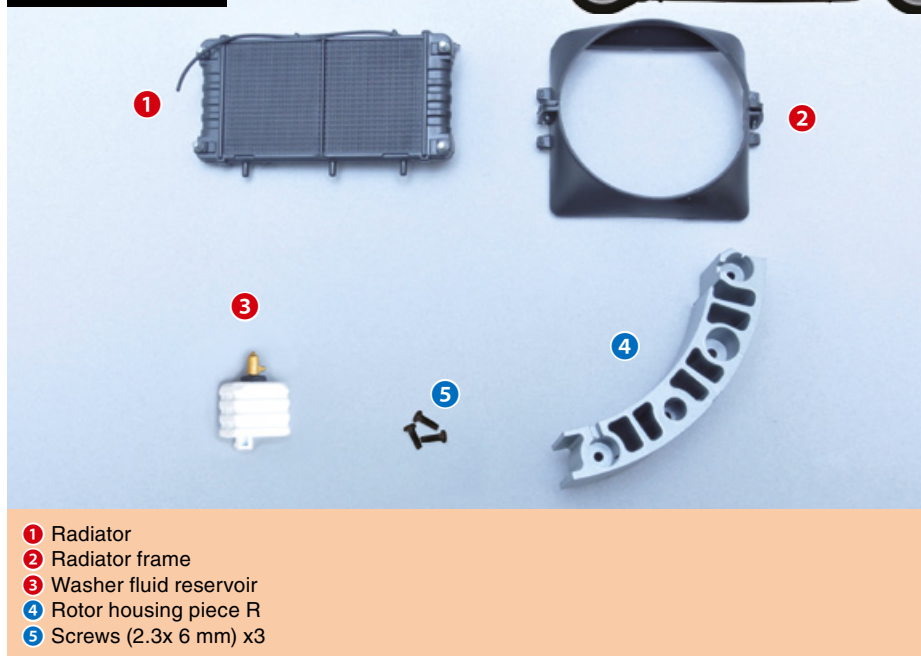

• Parts for the 1:8 scale Mazda Cosmo Sport model car • Parts for the 1:2 scale rotary engine

COSMO SPORT

Step

1

The radiator



Look at the radiator frame carefully. The side with the notch is the top.

Attach the frame to the radiator using the interlocking elements circled in the photo.

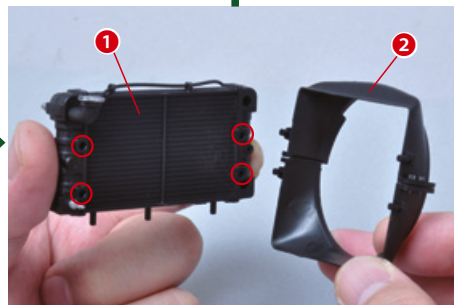

Click the pieces into place.

Get the oil cooler you assembled in stage 26 and check that there are no problems attaching it to the radiator, as shown in the photo. Once you've done this, separate the pieces: you will join them permanently later on.

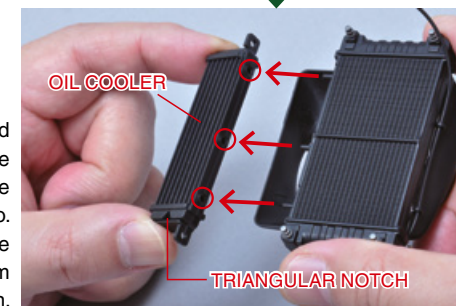



COSMO SPORT

Step

2 The oil cooler

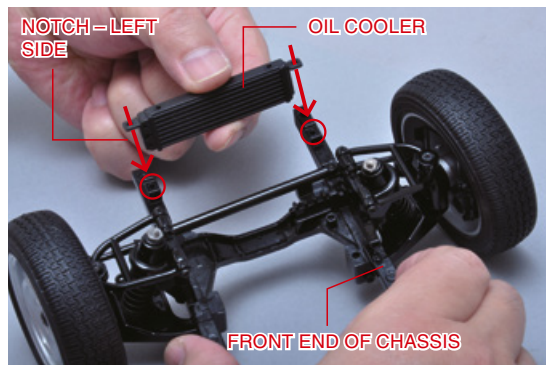

Attach the oil cooler to the chassis with the front suspension, as shown in the photo.

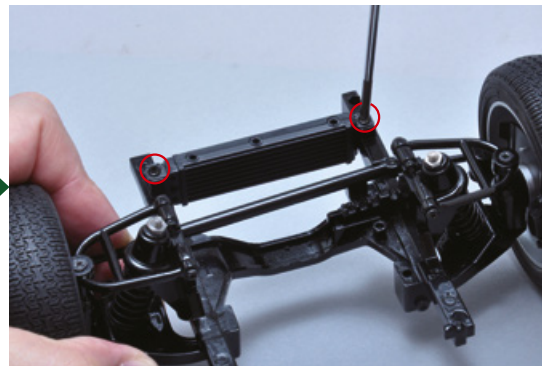

Secure the pieces with two of the remaining type B screws from the previous stage (part 7 stage 26).

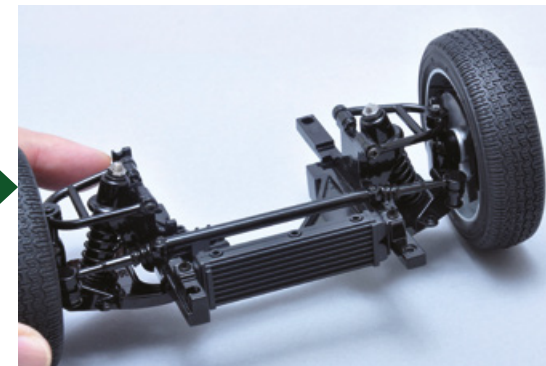

The oil cooler installed correctly.

ROTARY ENGINE

Step

3 The rotor housing

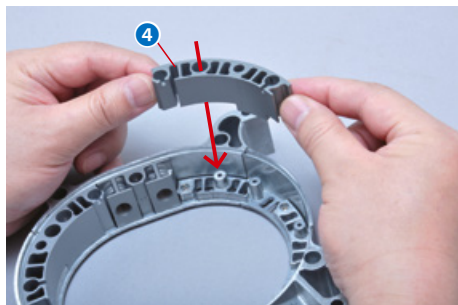

Attach piece R of the rotor housing to the part you assembled in the previous stages.



Secure the pieces with two of the screws you received with this stage.

FINAL RESULT

This is the result of this assembly session. Keep everything in a safe place with the rest of the pieces.

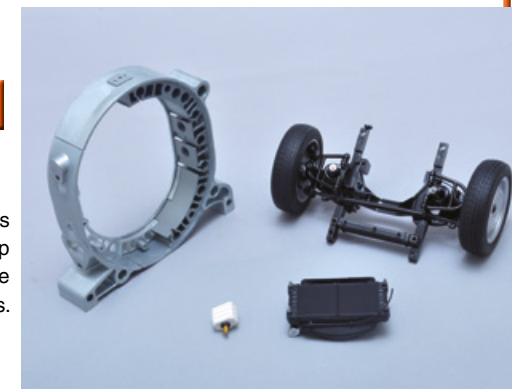

The next stage



28 THE BODY – FRONT END

In this assembly session you will start working on the front end of the body and continue assembling the rotor housing you started in the previous stages.

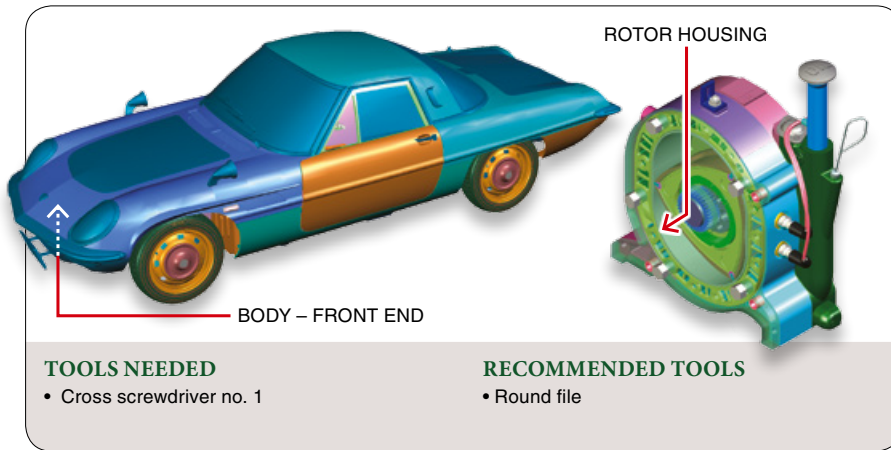

LIST OF PIECES

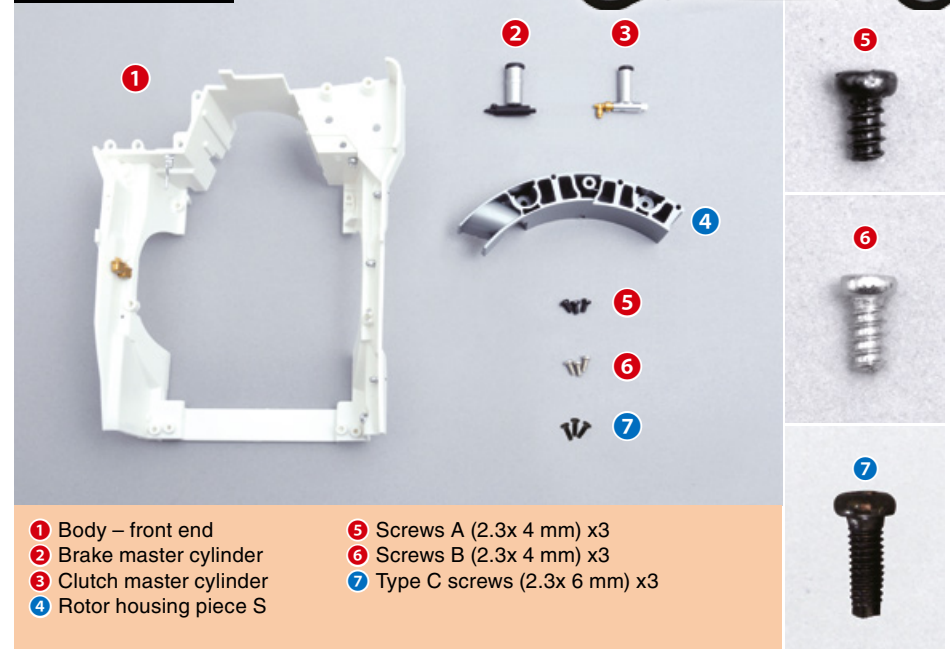

• Parts for the 1:8 scale Mazda Cosmo Sport model car • Parts for the 1:2 scale rotary engine

COSMO SPORT

Step

1

The washer fluid reservoir



If you find it difficult to insert the pieces, you can lightly file the edges of the holes with a round file.

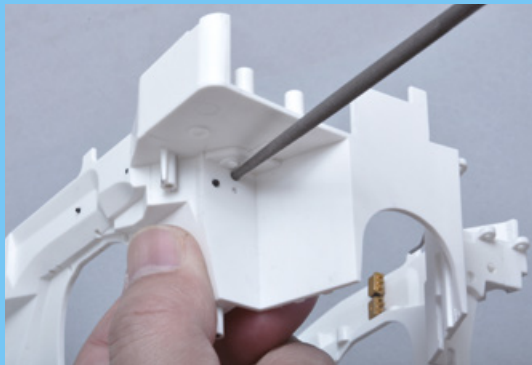

* NOTE: this is a temporary assembly. The pieces will be attached permanently later on.

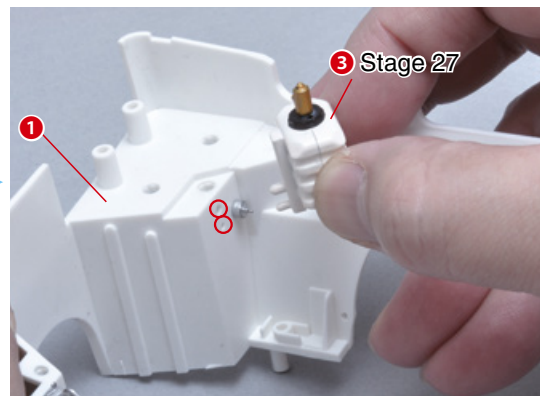

Insert the two linchpins on the washer fluid reservoir (part 3 stage 27) into the circled holes. This is a temporary assembly, so don't glue the pieces together yet.

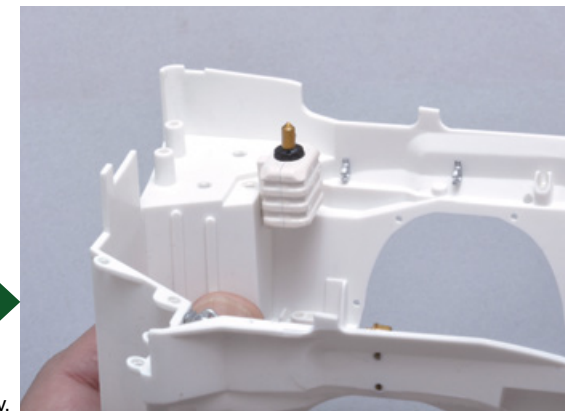

The reservoir installed correctly.



COSMO SPORT

Step

2

The brake and clutch master cylinders

* NOTE: this is a temporary assembly. The pieces will be attached permanently later on.

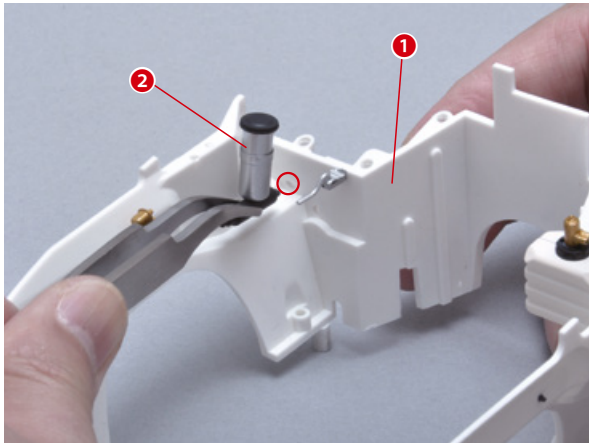

Attach the brake master cylinder to the body, as shown in the photo.

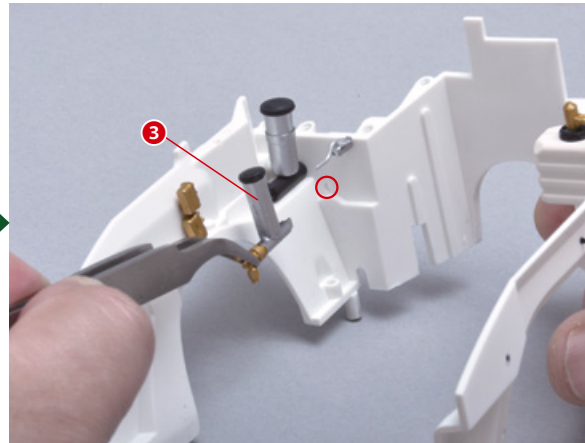

Now attach the clutch master cylinder in the same way.

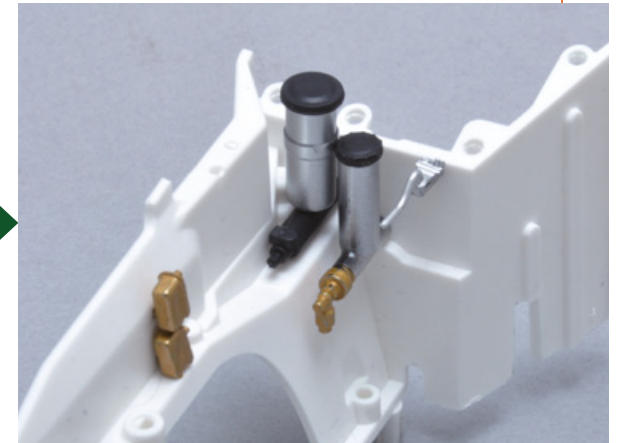

The two cylinders installed correctly.

ROTARY ENGINE

Step

3

The rotor housing

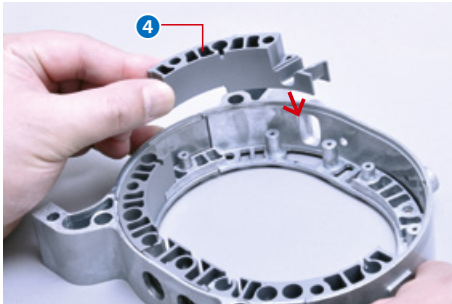

Attach piece S of the rotor housing to the part you assembled in the previous stages.



Secure the pieces with two type C screws.

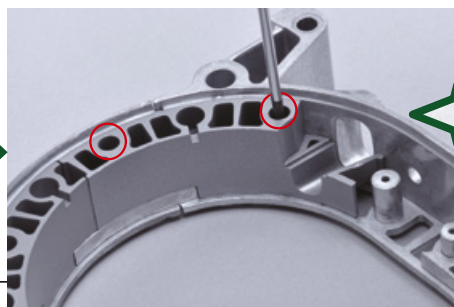

7

FINAL RESULT

This is the result of this assembly session. Keep everything in a safe place with the rest of the pieces.



The next stage



29 THE FRONT LEFT MUDGUARD

In this stage you will attach the first mudguard to the front end of the body and finish assembling the rotor housing.

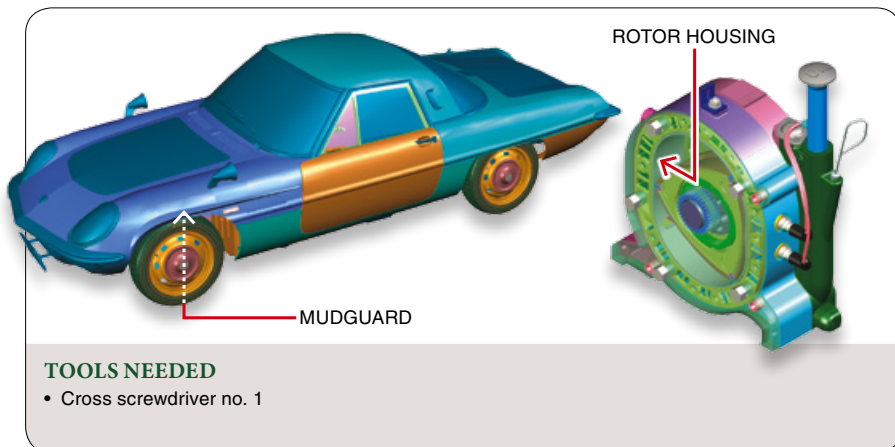

LIST OF PIECES

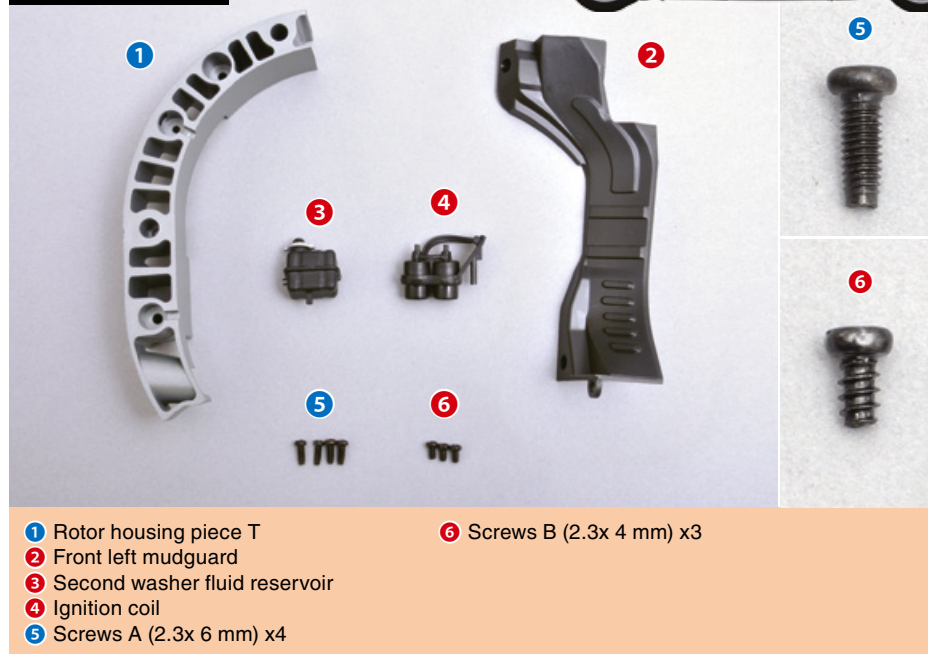

• Parts for the 1:8 scale Mazda Cosmo Sport model car • Parts for the 1:2 scale rotary engine

COSMO SPORT

Step

1

The front left mudguard

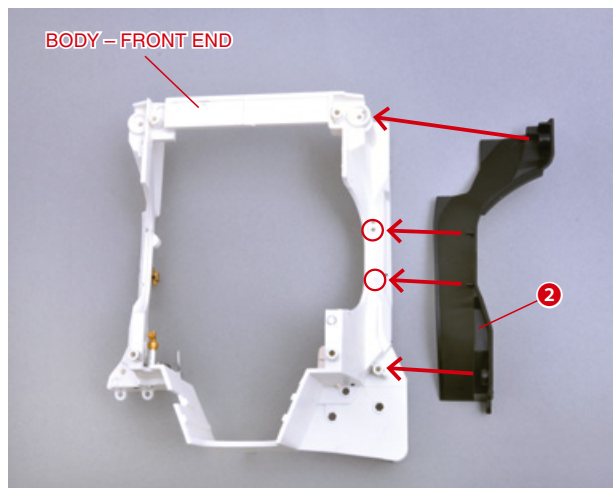

Using the photo to help you, attach the front left mudguard to the front end of the body, using the interlocking elements indicated in the first photo.

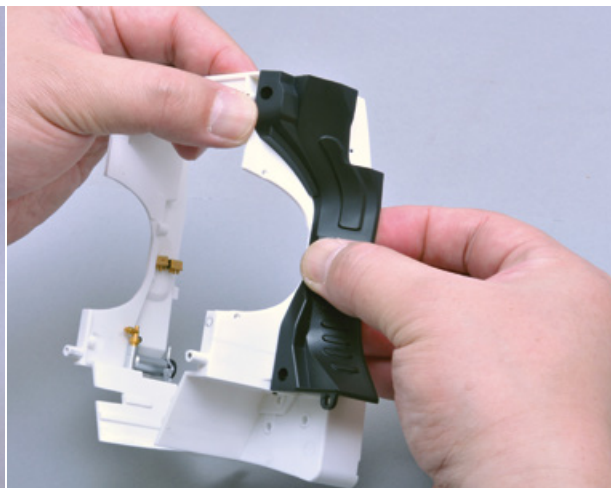

Insert and tighten two type B screws in the indicated holes to secure the pieces.



COSMO SPORT

Step 2 The ignition coil



Attach the ignition coil to the body, as shown in the photo.



* NOTE: this is a temporary assembly. The pieces will be attached permanently later on.

COSMO SPORT

Step 3 The second washer fluid reservoir

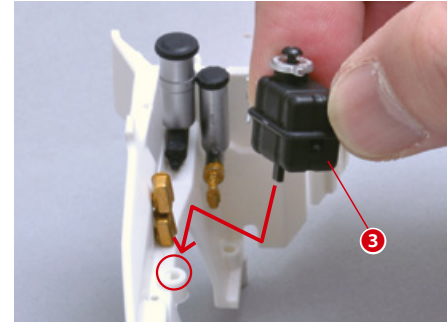

Now attach the second washer fluid reservoir to front end of the body.

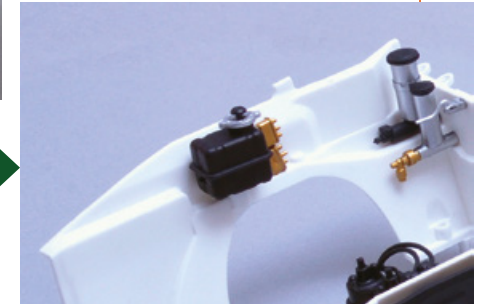

* NOTE: this is a temporary assembly. The pieces will be attached permanently later on.

ROTARY ENGINE

Step 4 The rotor housing

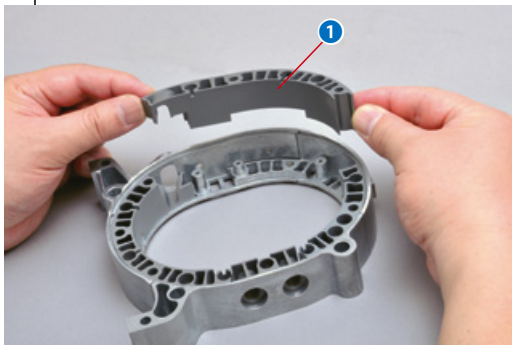

Attach piece T of the rotor housing to the part you assembled in the previous stages.



Secure the pieces with three type A screws.

FINAL RESULT

This is the result of this assembly session. Keep everything in a safe place with the rest of the pieces.

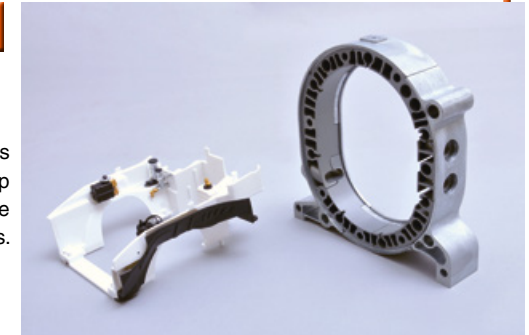

The next stage



30 THE FRONT RIGHT MUDGUARD

In this stage you will attach the front right mudguard and cooling system to the front end of the body; you will also attach a hook to the top of the rotor housing.

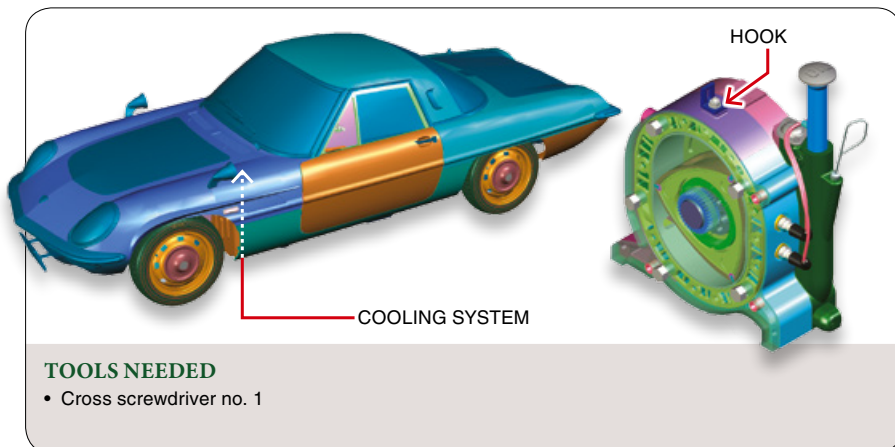

LIST OF PIECES



• Parts for the 1:8 scale Mazda Cosmo Sport model car • Parts for the 1:2 scale rotary engine

COSMO SPORT

Step

1

The front right mudguard

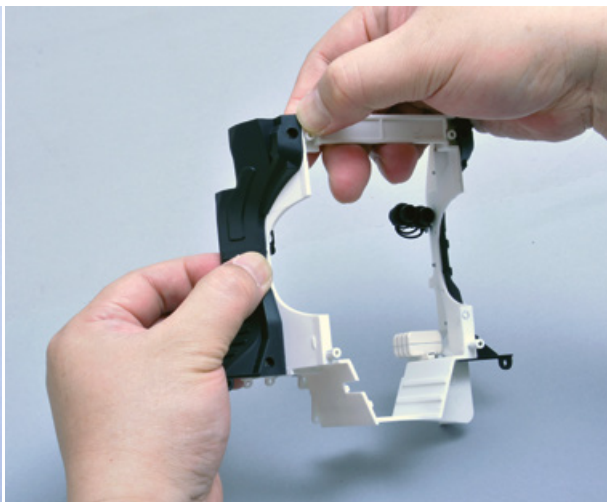
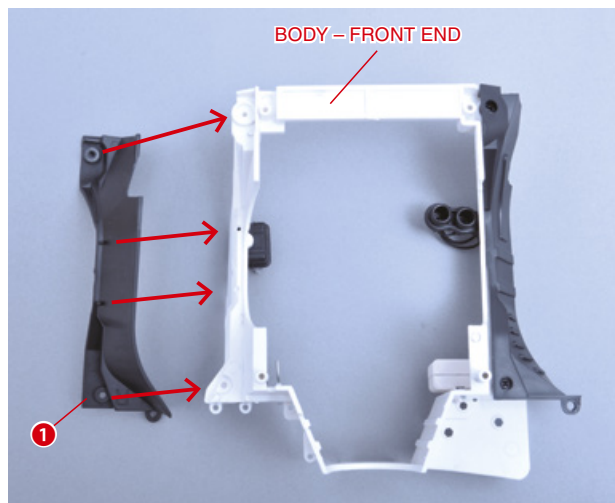

Use the photos on this page to help you attach the front right mudguard to front end of the body, as you did in the previous stage.

Insert and tighten two of the screws received with this stage to secure the pieces.



COSMO SPORT

Step

2

The cooling system

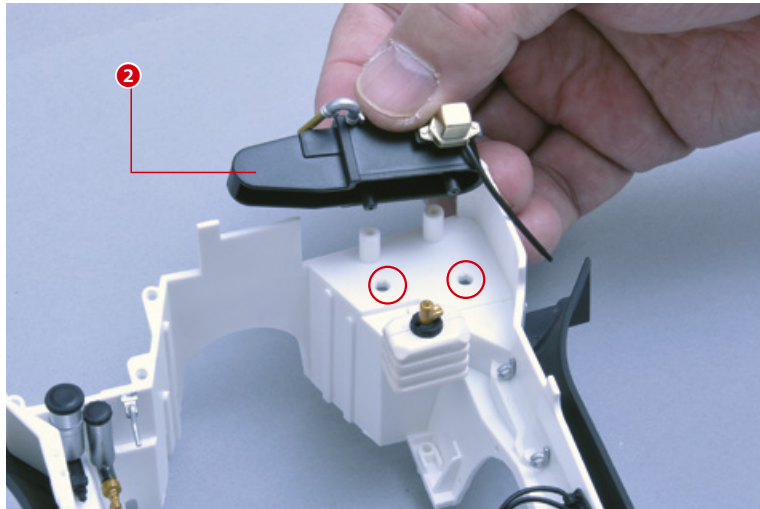

Position the cooling system on the body, as shown in the photo.

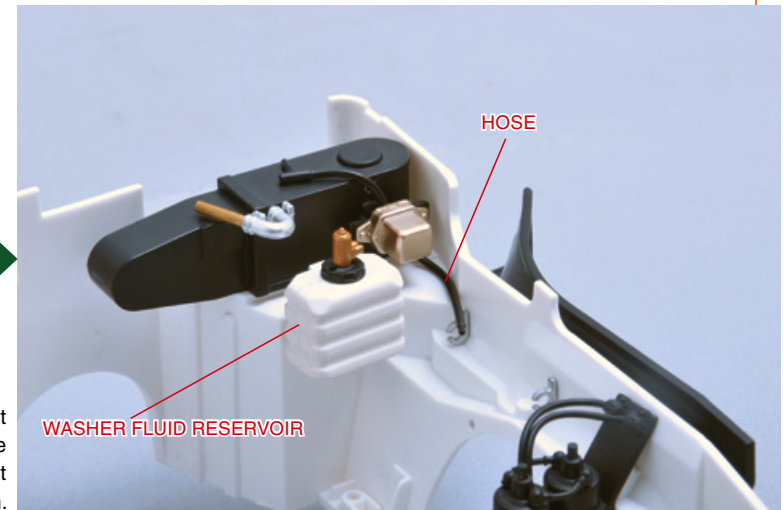

Arrange the hose coming out of the system as shown in the photo. You will be attaching it to other pieces later on.

ROTARY ENGINE

Step

3

The hook

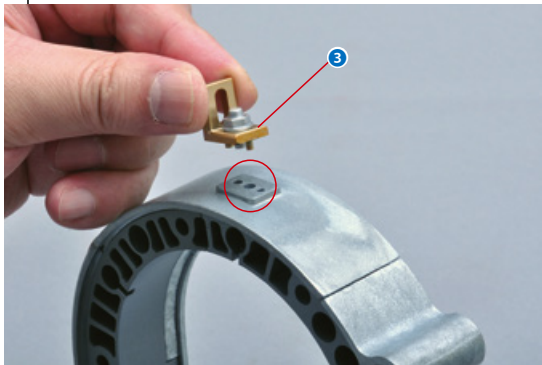

Position the hook on top of the rotor housing, as shown in the photo.



Press down until it clicks into place.

FINAL RESULT

This is the result of this simple, yet satisfying assembly session. Keep everything in a safe place with the rest of the pieces.

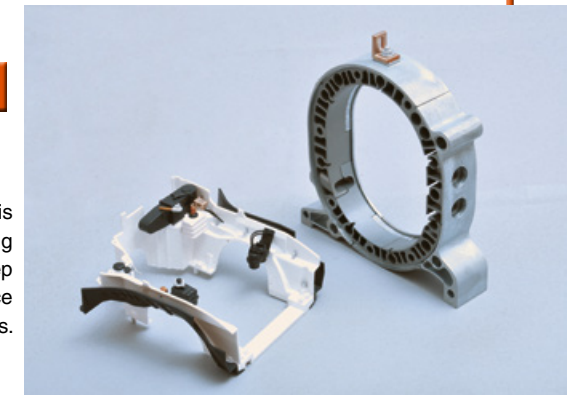

The next stage





31

THE FRONT SUSPENSION SYSTEM

In this stage you will attach the front end of the body to the front suspension system you worked on in the previous stages. Follow the instructions and accompanying photographs carefully.

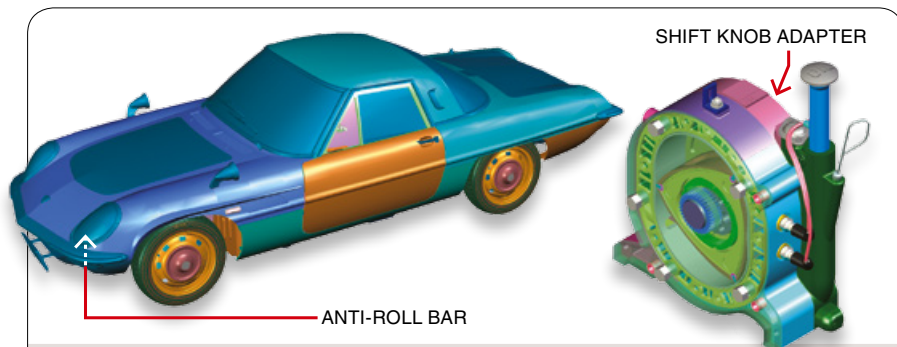

TOOLS NEEDED

- Cross screwdriver no. 1
- Instant glue
- Pliers and tweezers
- AAA batteries x2

RECOMMENDED TOOLS

- Small bowl
- Decal
- Cotton buds
- adhesive

LIST OF PIECES

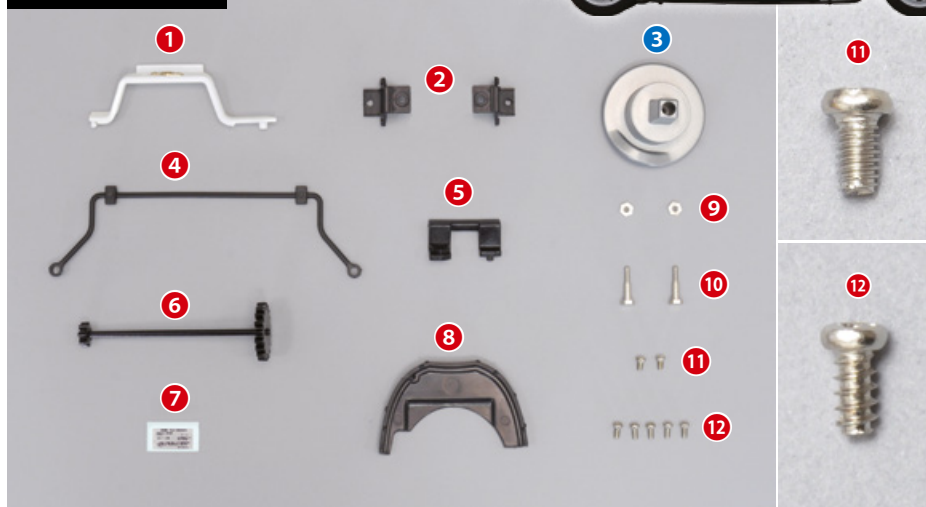

- | | | |
|----------------------------------|-------------------|----------------------------|
| 1 Boot reinforcement panel | 6 Steering column | 11 Screws A (2.3x 3 mm) x2 |
| 2 Transmission mount brackets x2 | 7 Decal | 12 Screws B (2.3x 4 mm) x5 |
| 3 Shift knob adapter | 8 Trim cover | |
| 4 Anti-roll bar | 9 Nuts x2 | |
| 5 Plate | 10 Bolts x2 | |

• Parts for the 1:8 scale Mazda Cosmo Sport model car • Parts for the 1:2 scale rotary engine

COSMO SPORT

Step

1

The boot reinforcement panel

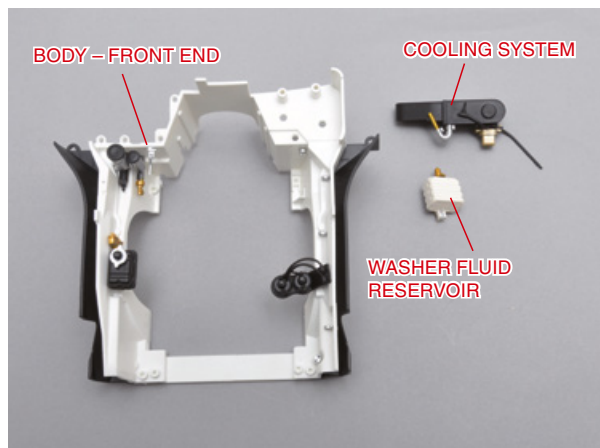

Remove, temporarily, the cooling system and the washer fluid reservoir from the body.

Position the boot reinforcement panel as shown in the photo.

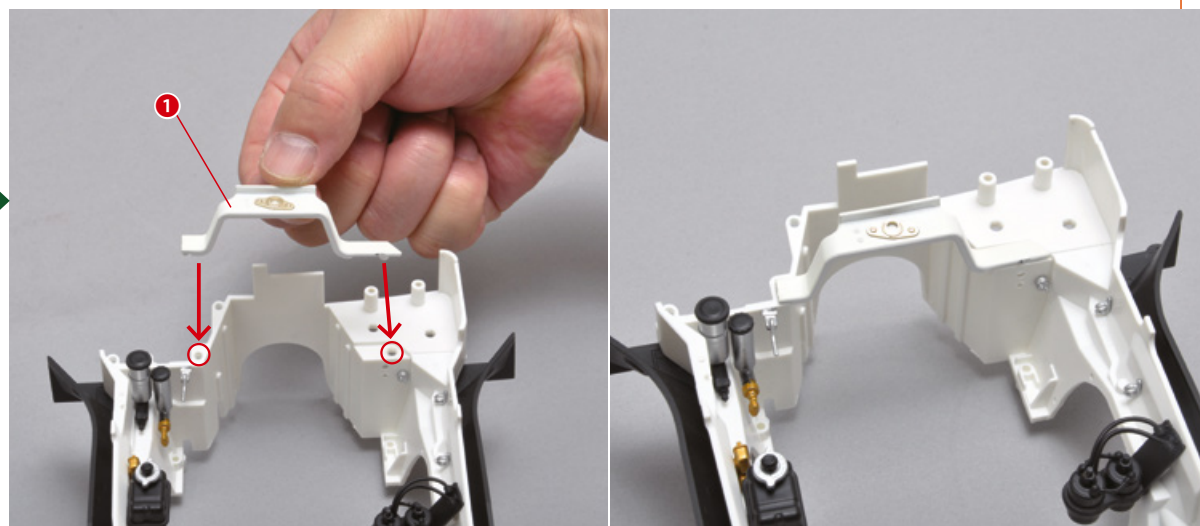



COSMO SPORT

Step
2

The decal



Soak the decal in water. When the sticker starts to come off the backing, you can start attaching it.



As long as the decal is wet, you can move it around to correct the direction and position. Once satisfied, dry with a cotton bud.



If you like, you can apply a drop of decal adhesive to the base before attaching the decal. That way there's no risk of the decal coming off.



Look carefully at the photos on this page and place the decal in exactly the same position as the one in the photo.



The decal, dry and in the correct position.



COSMO SPORT

Step
3

The steering column

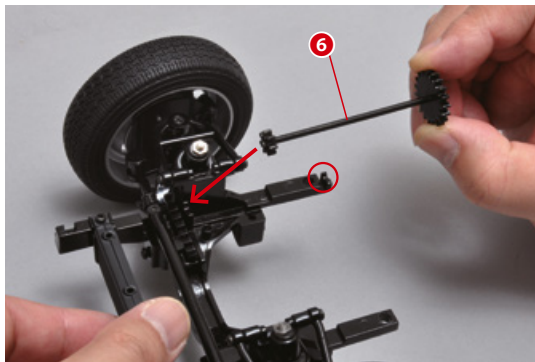

Attach the steering column to the front suspension system, ensuring the pieces face the same way as those in the photo.

Also position the plate, as shown in the photo.



Secure the pieces with a type A screw.

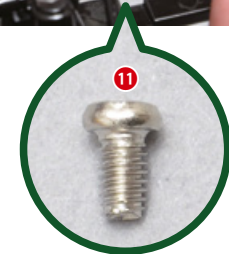



COSMO SPORT

Step

4

The anti-roll bar

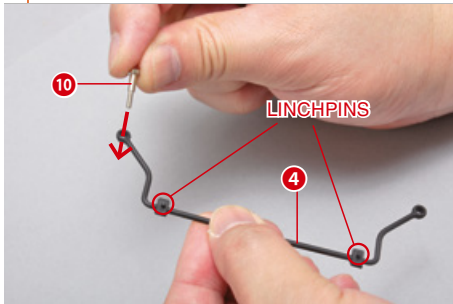

Insert a bolt into the hole in the anti-roll bar, indicated in the photo, ensuring the pieces face the same way as those in the photo.



Attach the anti-roll bar to the suspension by inserting the bolt into the hole in the lower control arm in the front suspension. Ensure the pieces face the same way as those in the photos on this page.



Tighten one of the nuts on the end of the bolt.



Apply a small amount of glue to secure the pieces, as shown in the photo.



Insert the two linchpins on the anti-roll bar into the circled holes.

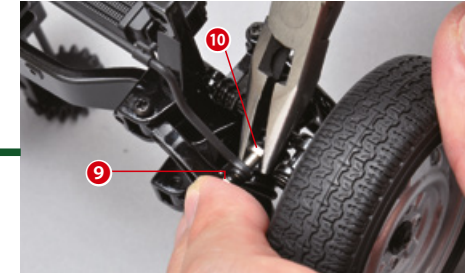

Now insert a bolt into the other end of the anti-roll bar and attach it in the same way; tighten a nut on the end of the bolt.

COSMO SPORT

Step

5

The trim cover

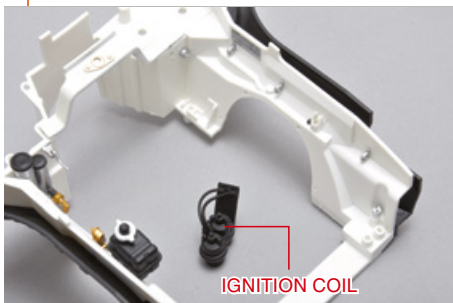

Remove, temporarily, the ignition coil from the body.

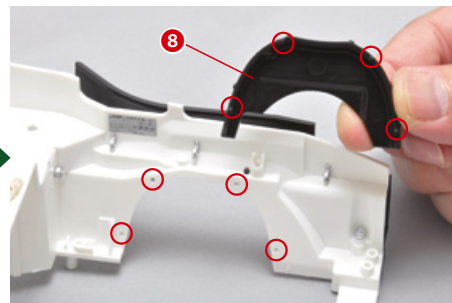

Install the trim cover as shown in the photo.



You can now reattach the cooling system, the washer fluid reservoir and the ignition coil. This is a temporary assembly so don't glue the pieces yet.



COSMO SPORT

Step

6

Attaching the body to the suspension

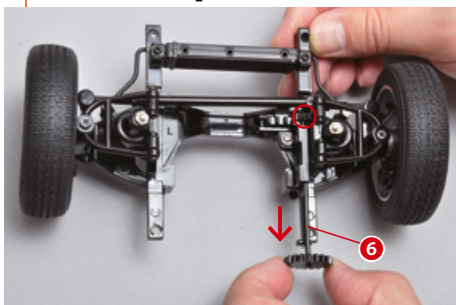

Position the steering column as shown in the photo.

Put the front end of the body on top of the front suspension system. Make sure that the slots and cogs are aligned, as shown in the photo.



Align the interlocking elements and holes, as shown in the photo.

Insert and tighten two of the type A screws you received with stage 28 into the circled hole.

The body and suspension system joined correctly.



Stage 28



ROTARY ENGINE

Step

7

Testing the spark plug ignition

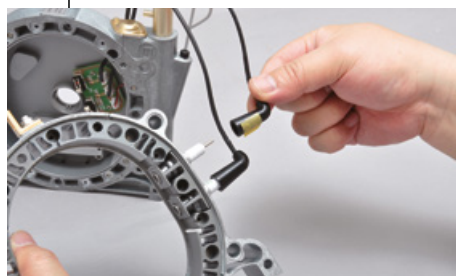

Temporarily insert the spark plugs into the rotor housing and connect the electric wires, as shown in the photo.

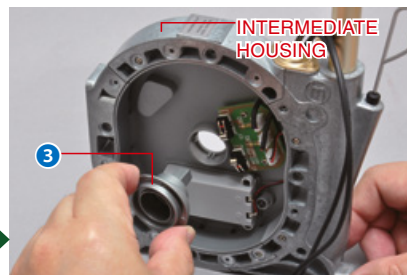

Insert the shift knob adapter into the middle of the intermediate housing, as shown in the photo.

If the LED lights don't switch on correctly, you can adjust the arms of the sockets in the control unit until they do. Be careful not to damage any of the components.

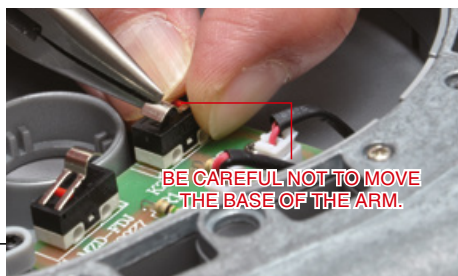

BE CAREFUL NOT TO MOVE THE BASE OF THE ARM.

Insert two AAA batteries into the battery holder. Turn the adaptor in the direction indicated by the arrow in the photo. Check that the LED lights switch on in the order indicated in the photo (the bottom one first). Remove the spark plugs when you've finished.

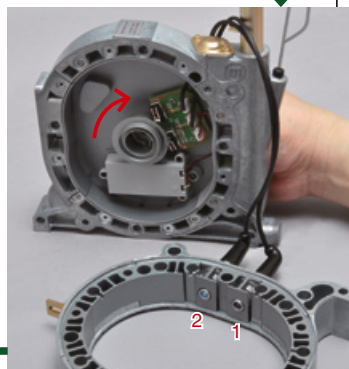

FINAL RESULT

This is the result of this satisfying assembly session. Keep everything in a safe place with the rest of the pieces.



The next stage





32 THE FRONT PLATFORM

In this stage you will install the engine in the front end of the body and attach the front platform. Be careful not to damage the pieces when handling them.

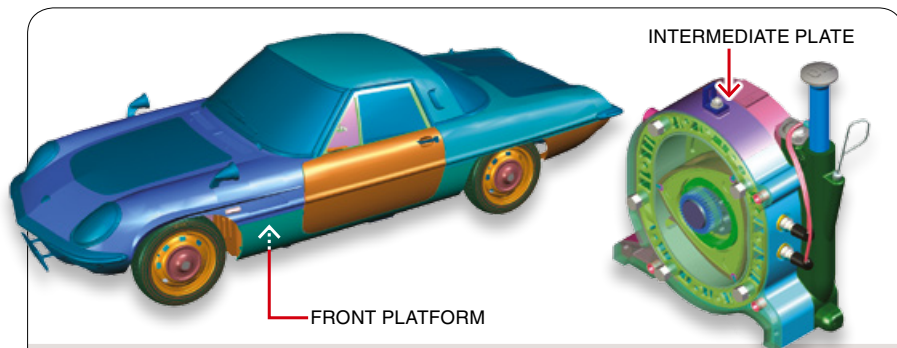

TOOLS NEEDED

- Cross screwdriver no. 1
- Instant glue

RECOMMENDED TOOLS

- Pliers
- Tweezers

LIST OF PIECES

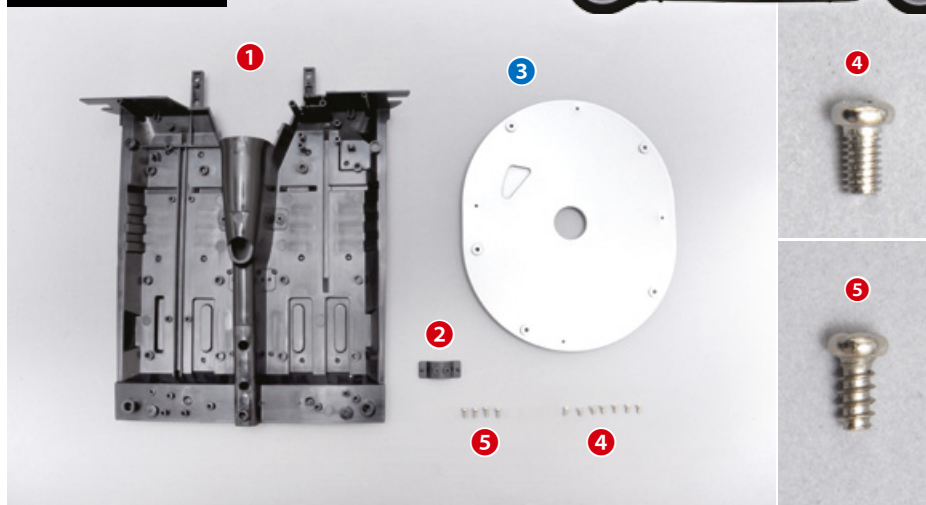

- 1 Front platform
- 2 Silencer mount bracket
- 3 Intermediate plate
- 4 Screws A (2.3x 4 mm) x7
- 5 Screws B (2.3x 4 mm) x4

• Parts for the 1:8 scale Mazda Cosmo Sport model car • Parts for the 1:2 scale rotary engine

COSMO SPORT

Step

1

The front platform



Remove, temporarily, the pieces in the photo from the body.



Feed the steering column through the slot indicated in the photo.

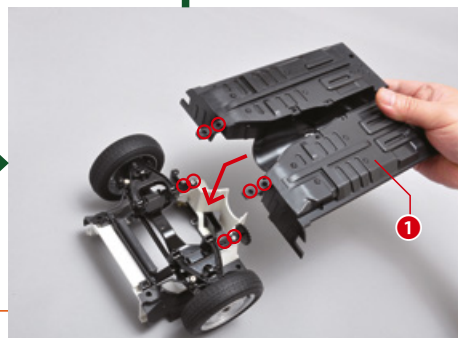

Position the pieces as shown in the photo and attach the front platform to the body.



Insert and tighten two type A screws in the circled holes.

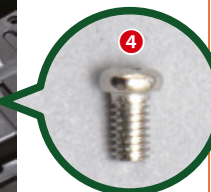

Insert and tighten two type B screws in the circled holes.





COSMO SPORT

Step 2 Engine details

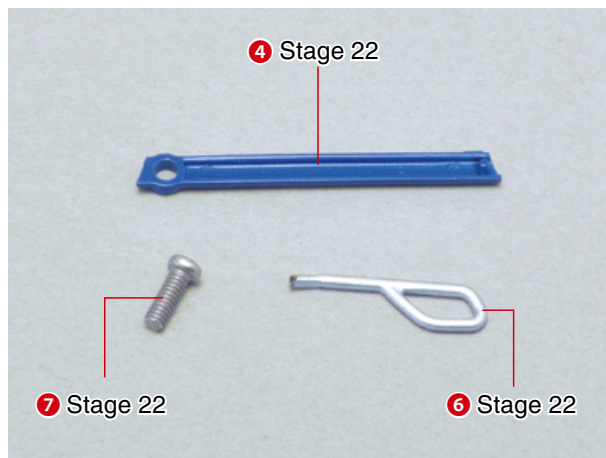

Put the pieces shown in the photo on your work surface; they are the pieces you removed in a previous stage.

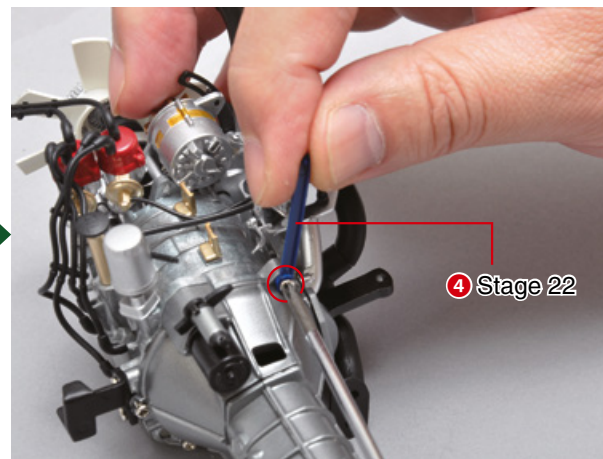

Start by reattaching the air filter mount, using the screws that you removed.

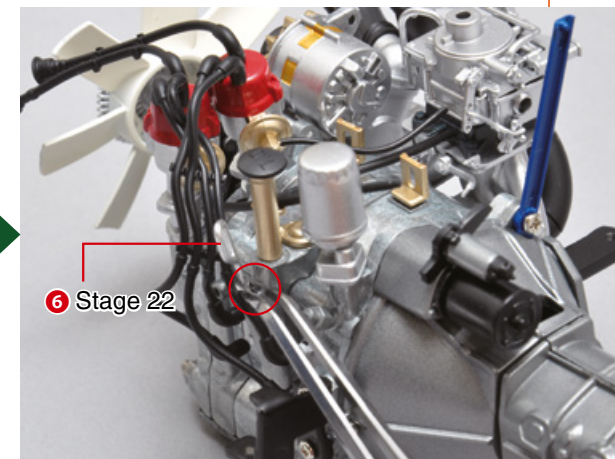

Now put the dipstick back in its housing.

COSMO SPORT

Step 3 The radiator

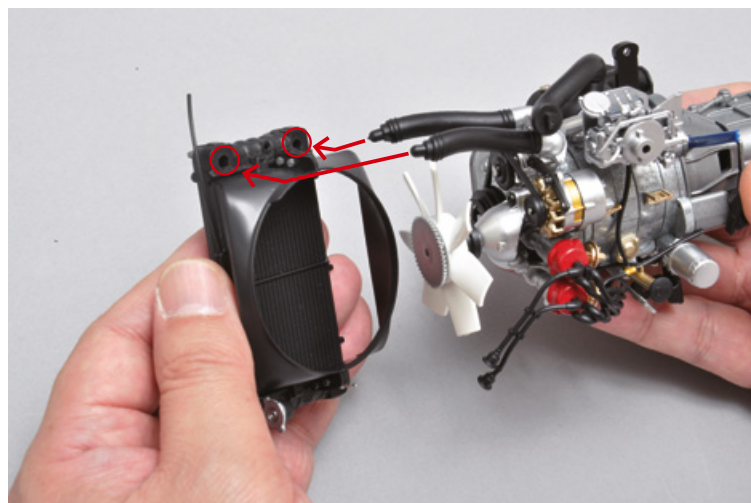

Attach the radiator to the engine unit, ensuring the pieces are facing the same way as those in the photo.



Look carefully at the photo to make sure you have put the pieces back correctly.

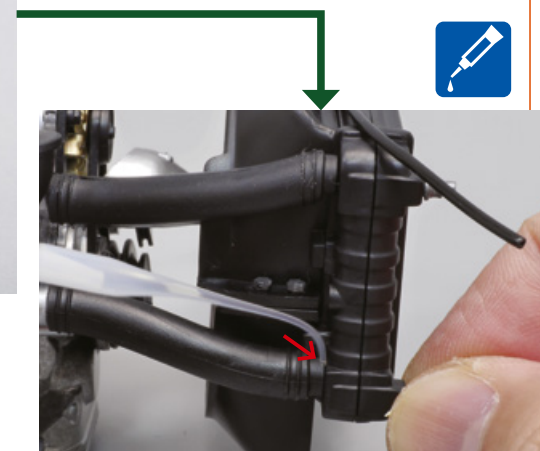

If you like, you can apply a drop of glue on the area indicated in the photo.



COSMO SPORT

Step

4

Installing the engine in the body



Insert the engine block into the body as shown in the photo.

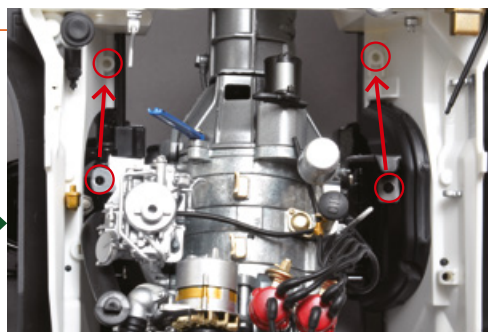

Align the holes circled in the photo.

Secure the pieces with two of the type B screws you received with stage 28.



6 Stage 28

Attach the radiator to the oil cooler, as shown in the photo.

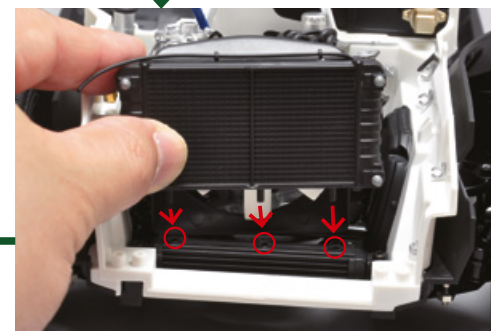

Press until the pieces click into place.

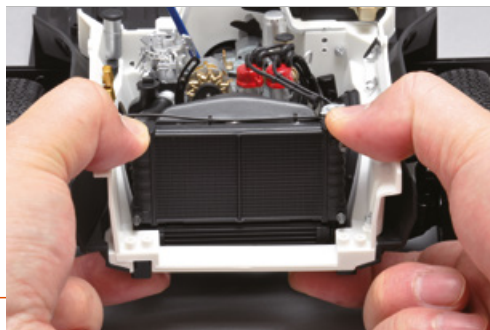

COSMO SPORT

Step

5

Transmission mount brackets

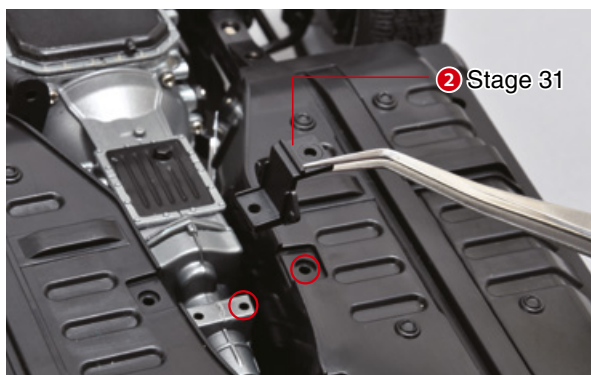

Position one of the transmission mount brackets (part 2 stage 31) as shown in the photo. This is how you will secure the platform to the engine unit.

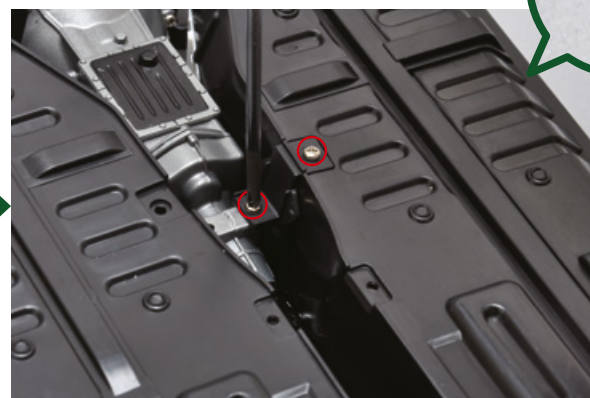

Secure the pieces with two of the type B screws you received with stage 31.



Attach the other mount bracket in the same way and secure the pieces with two type B screws from stage 31.

12 Stage 31



COSMO SPORT

Step

6

Finishing touches



Reattach the washer fluid reservoir and attach the hose from the cooling system to it.
* NOTE: do not use glue.

Reattach the ignition coil.
* NOTE: do not use glue.



Now reattach the second reservoir.
* NOTE: do not use glue.



Attach the free ends of the two wires A on the distributors to the ignition coil, as shown in the photo.

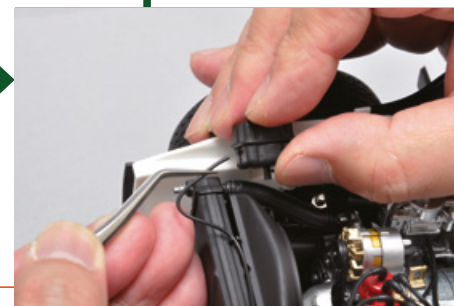

Slide the hose coming from the radiator onto the linchpin on the second washer fluid reservoir.
* NOTE: do not use glue.

ROTARY ENGINE

Step

7

The intermediate plate

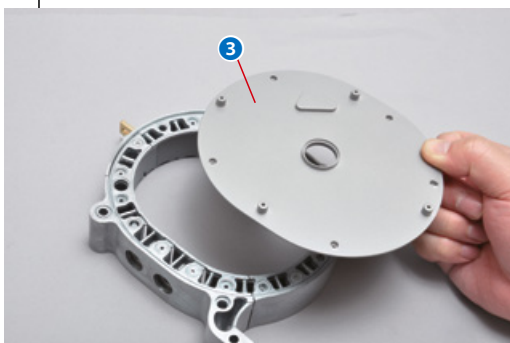

Position the pieces as shown in the photo and then attach the intermediate plate to the rotor housing.

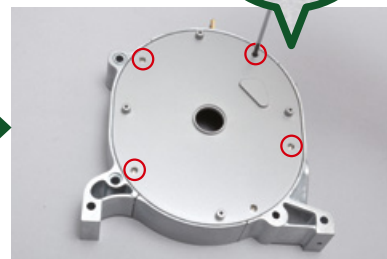
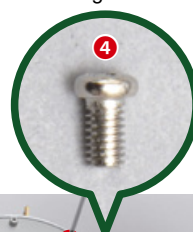

Insert and tighten four of the type A screws received with this stage in the circled holes.

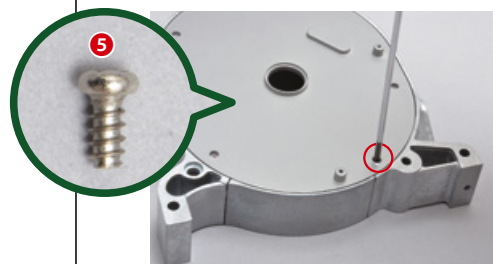

Insert and tighten one of the type B screws received with this stage in the circled hole.

FINAL RESULT

This is the result of this long and satisfying assembly session. Keep everything in a safe place with the rest of the pieces.



The next stage

