



Samurai Armor Set: Step by Step

Pack 1

Stages 1-4

Contents

Stage 1

Pages 1-3

**Begin assembling the mask
and your first tasset plate**

Stage 2

Pages 4-6

**The helmet bowl, mask and
tasset plates**

Stage 3

Pages 7-11

**The helmet bowl lip and
tasset plates**

Stage 4

Pages 12-14

**The cuirass and tasset
plates**



Photo credits All photographs copyright
© DeAgostini
Visit our website www.model-space.com

DeAGOSTINI
MODEL SPACE™

Editorial and design by Continuo Creative, 39-41 North Road, London N7 9DP
All rights reserved © 2013 De Agostini Publishing USA, 915 Broadway, Suite 609, NEW YORK, NY 10010

NOT SUITABLE FOR CHILDREN UNDER THE AGE OF 14. THIS PRODUCT IS NOT A TOY AND IS NOT DESIGNED OR INTENDED FOR USE IN PLAY. ITEMS MAY VARY FROM THOSE SHOWN.

Begin assembling the mask and your first tasset plate



Your parts

Helmet bowl (right)
Mask faceplate
Mask ears x 2
Securing post plates x 2
Drainage tube
Securing posts x 2
Lace (approximately 150cm long)
Tasset plate (first)
Tasset plate backing (first)

Tools & materials

Multi-purpose adhesive
Instant adhesive
Glue
Scissors
Toothpick
Cardboard
Ruler



The tasset plate

1 Peel away half of the paper of the tasset plate backing. Place the half with the exposed adhesive in the concave side of the tasset plate, aligning the holes.

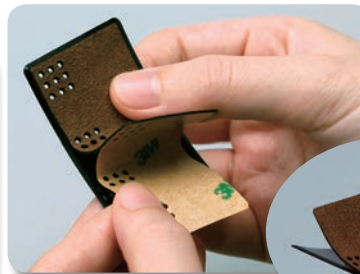
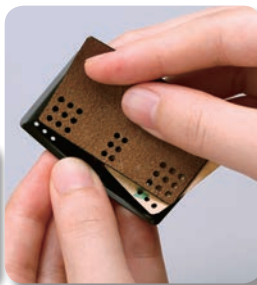

2 Remove the rest of the backing paper and stick the other half of the backing down. You may want to use a toothpick to help keep the holes aligned.



The mask parts

1 The left and right ears can be identified by the positions of the projections on the back of each one. The photo below shows how to tell them apart.

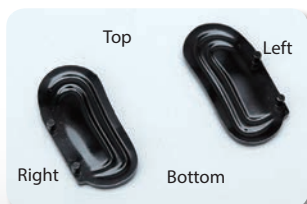

2 Place a small amount of multi-purpose glue on some cardboard. Using a toothpick, apply some glue to the area between the two holes on the right side of the faceplate, circled.

3 Glue the right ear in position by placing the projections into the holes of the faceplate.



4 Repeat Steps 2-3 to glue the left ear in place on the faceplate.

SAMURAI ARMOR SET: STEP BY STEP

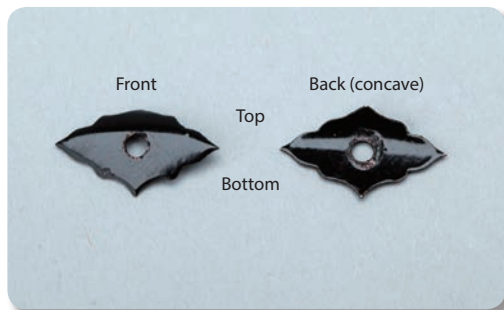

5 The photo shows the securing post plates, which are curved to fit the faceplate. Position them as shown to identify the top, bottom, front and back.

6 Place one of the securing posts into the hole in the plate, with the larger end of the post on the convex side of the plate.

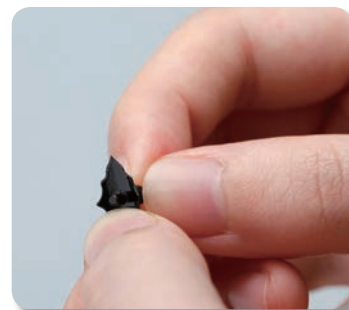

7 Test-fit the securing post and plate assembly into the holes on the underside of the faceplate. Then apply instant adhesive to the back of the securing post plate.

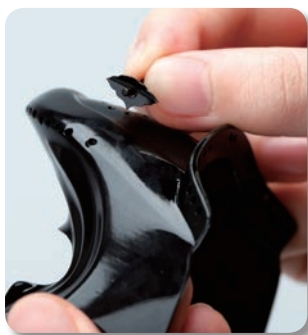

8 Glue the securing post assembly into the hole on the underside of the faceplate. It should appear as shown in the inset.

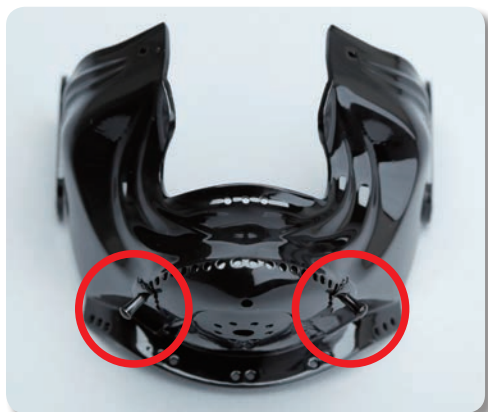

9 Repeat this process to glue the left securing post in place.

10 Test-fit the drainage tube in the central hole of the faceplate, between the two securing posts.



11 Remove the tube, apply a small amount of instant adhesive to the hole and then place the tube back in position.



SAMURAI ARMOR SET: STEP BY STEP

The armor laces

- 1** Cut three strips of lace approximately 50cm in length.

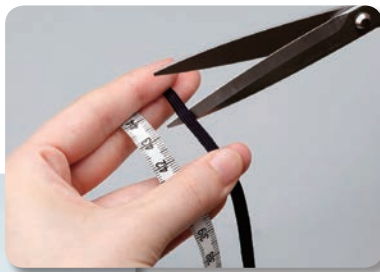

The actual amount needed is around 40cm, but cutting a longer strip allows for mistakes.

- 2** Cut the ends of the laces diagonally about 1cm from the end, as shown in the inset.

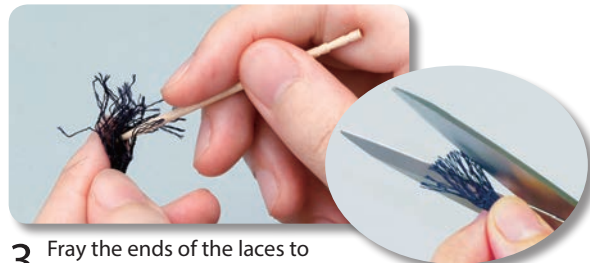

- 3** Fray the ends of the laces to about 2cm from the end. This will make it easier to twist the ends. After fraying, cut diagonally on the side opposite the one that was cut in the previous step, 1cm from the end.



- 4** Place a small amount of glue on your fingertip and run the end of one of the laces through it.

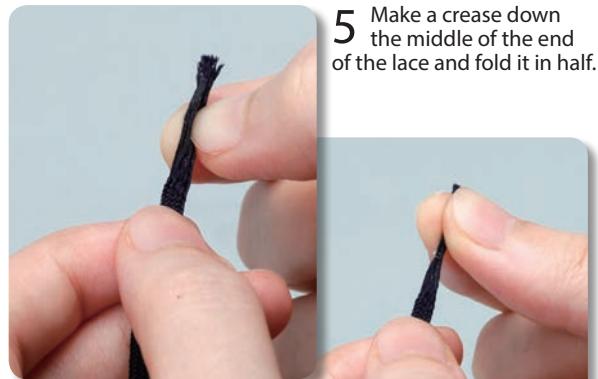
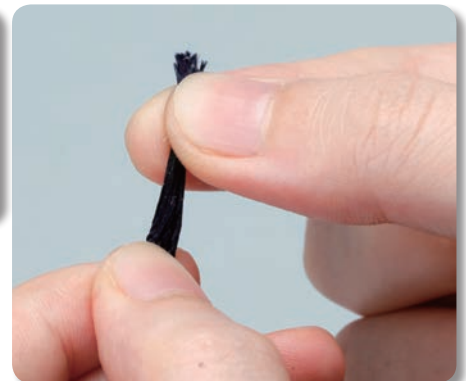

- 5** Make a crease down the middle of the end of the lace and fold it in half.

- 6** Twist the folded end of the lace to a point. Repeat the process for the other end of the lace, making sure that the recesses by the points are on the same side of the lace.

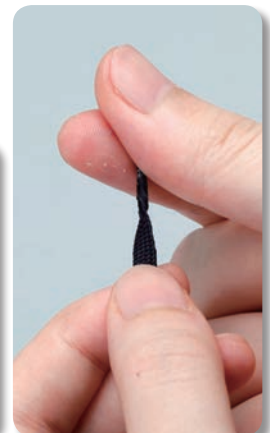
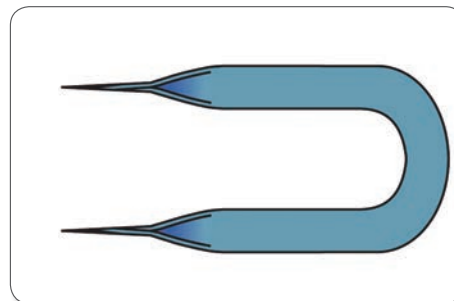

- 7** Repeat for the two other lengths of lace.



Assembled parts



The helmet bowl, mask and tasset plates



Your parts

Helmet bowl (left)
Mask nose
Tasset plate (second)
Tasset plate (third)
Tasset plate backing (second)
Tasset plate backing (third)
Screws x 3
Mask nose pins
Helmet bowl ring

Tools & materials

Instant adhesive
Toothpick
Phillips screwdriver (size 0)
Tweezers



The helmet bowl

- 1 Fit the left and right sides of the helmet bowl together.



- 2 Place the helmet bowl ring over the raised circular ridge in the center of the helmet bowl, aligning the two arrows (circled).



- 3 Tighten a screw into each of the holes in the ring to fix the two sides together.



The mask nose

- 1 Apply a small amount of instant adhesive to the small hole on the left side of the faceplate.



- 2 Place one of the nose pins into the hole on the left cheek, with the right-angled end facing in the direction of the arrow.

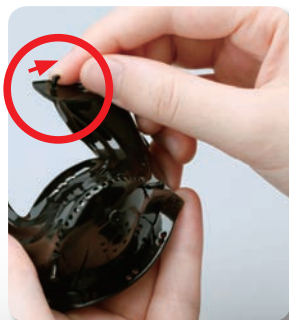

- 3 Then apply instant adhesive to the inside of the hole on the right cheek.



- 4 Hook the nose onto the left nail to test-fit it on the faceplate.

5 Insert the second nose pin into the hole on the right, through the nose and with the right-angled end facing in the same direction as the left one, as shown in the inset.



6 Your mask should now appear as above.



The tasset plates

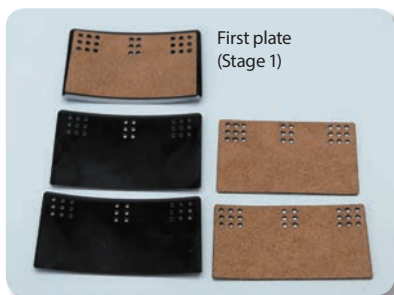

1 Position the plate from Stage 1 above the two plates from this stage, as shown.

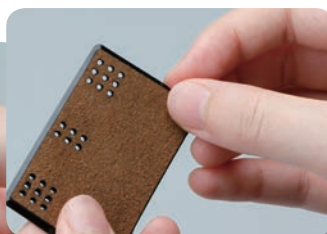

2 As on page 1, apply the corresponding backings to the two tasset plates from this stage.

3 Place the second and third plates as shown, to see the difference in their sizes.

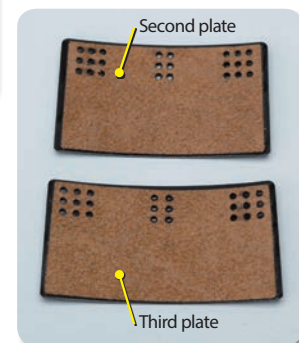

4 Take one of the laces prepared in Stage 1 and thread it through one of the bottom holes of the six central holes in the first plate. Insert the lace from behind.



5 Insert the other end of the lace into the remaining open hole at the bottom of the six central holes.

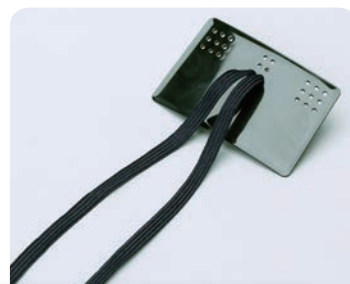

6 Pull both ends of the lace through the holes. Pull carefully to prevent the lace twisting. Refer to the diagram to see the correct position for the lace in the holes.



8 In the same way as for the two central holes, thread the remaining two laces through the bottom inner holes of the outer sets of holes, using the photos as a guide.



7 If you have trouble getting the laces to rest as shown in the diagram in Step 6, use tweezers to pull them back out and try again.

Correct (mountain fold)

Incorrect (valley fold)



9 Place the second plate over the first. Pass the lace furthest on the right straight down, under the second plate, and up through the first of the inner holes (arrowed), as shown. Pull the second plate up so that you can only see through the bottom row of holes.

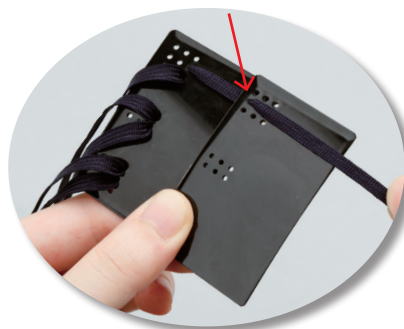
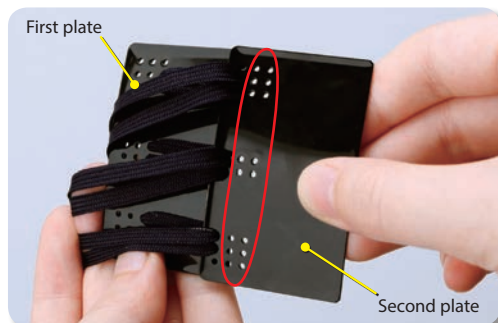

10 Pass the remaining ends of the three laces straight down to the inner holes, as shown. Adjust the height of the second plate so that you can see through the bottom two rows (circled).

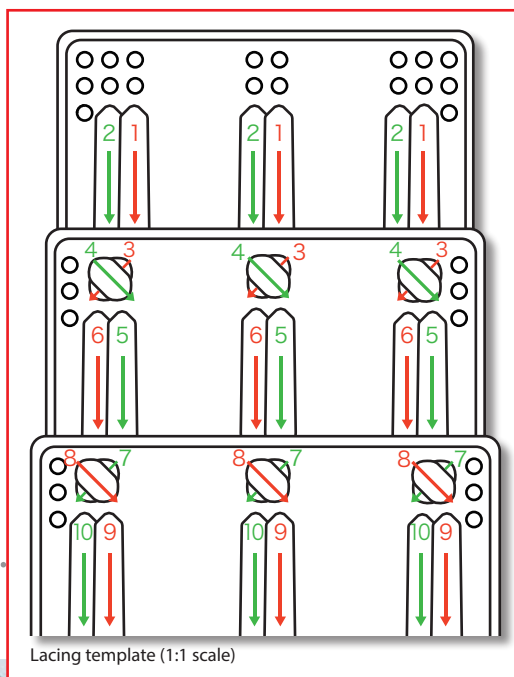

11 Confirm that your two tasset plates look the same as those in the photo, and that the lace is positioned correctly as in the diagram in Step 6.



12 Following the lacing template (top right of this page), cross lace 3 to the hole below lace 4 and pull it through the plate. Then cross lace 4 over lace 3 and pull it through to the back of the plate, as shown on the right.



13 Repeat the process described in Step 12 for the remaining laces.



14 Pass all six ends of the laces back through to the front of the second plate. Before proceeding, check that the laces are in the correct position (Step 6).

15 Repeat Steps 9-14, using the template to help you to lace the third plate to the second, as shown in the photos below.



Assembled parts



The helmet bowl lip and tasset plates

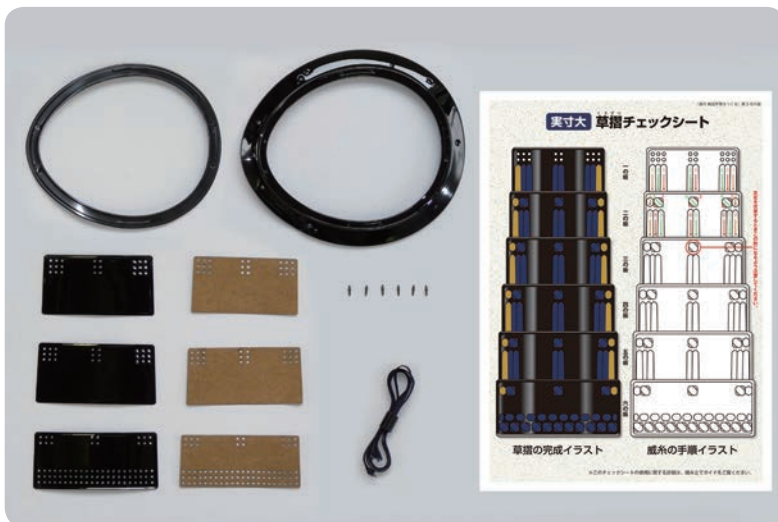

Your parts

Helmet bowl lip (upper)
Helmet bowl lip (lower)
Tasset plate and backing (fourth)
Tasset plate and backing (fifth)
Tasset plate and backing (sixth)
Helmet rivets x 6
Lace (approximately 60cm)
Plate check sheet

Tools & materials

Instant adhesive
Toothpick
White glue
Scissors
Tweezers
Masking tape
Cotton bud
Needle-nose pliers



The helmet rivets

1 Cut four 4cm strips of masking tape. Place a rivet in the center of one of the strips, with half of the rivet overlapping the edge, and fold the tape in half.

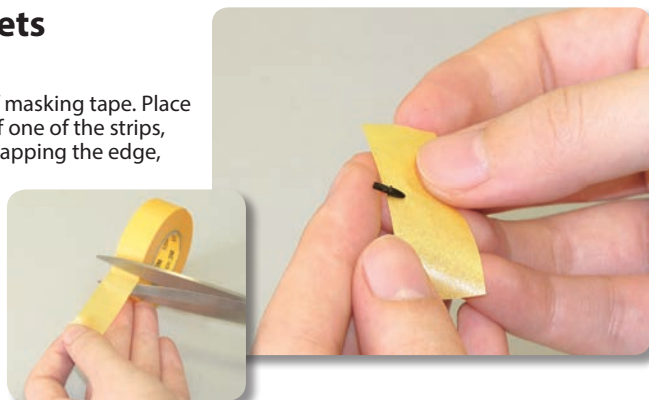

2 Repeat Step 1 to prepare three more rivets, as shown.

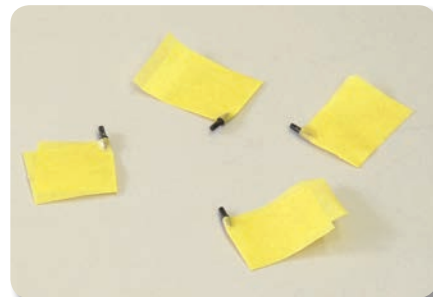

3 Place a small amount of instant adhesive onto some cardboard, and apply some to one of the holes on the inside of the helmet with a toothpick.

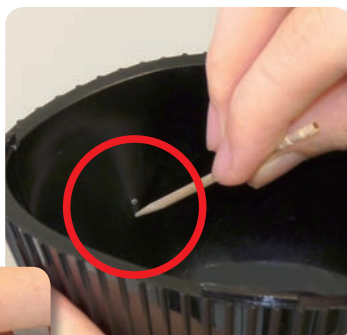

4 Place one of the rivets into the hole. You may find it easier to do this using pliers.



5 Repeat for the other three prepared rivets. When the adhesive is dry, remove the tape.



The helmet bowl lip

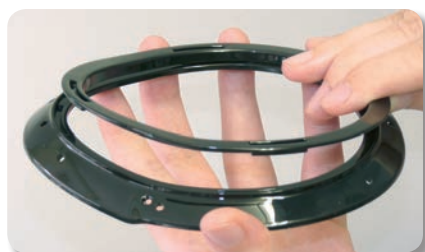

1 Temporarily assemble the upper and lower parts of the helmet lip to test-fit them.

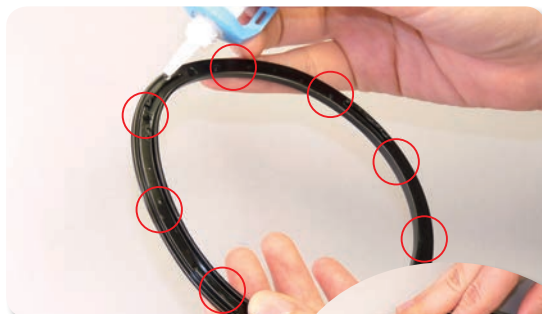

2 Apply instant adhesive to the upper lip at equal intervals around the circumference (red circles). Then glue the two halves of the lip together (right).

3 When the glue on the lip is dry, test-fit the helmet bowl in place to identify its correct orientation.



4 As with the lip, apply instant adhesive to the circumference of the helmet bowl.

5 Glue the bowl and lip of the helmet together.



The tasset plates

1 As with the previous tasset plates, fix the corresponding backings onto the fourth, fifth and sixth plates.

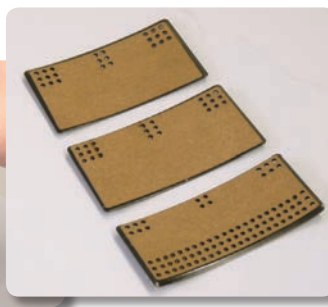

2 Prepare one end of the 60cm length of lace received with this stage in the same way as the laces on page 3.



How to seal the ends of the laces

1) When you have prepared one end of the lace, check the other end and cut off any frayed part.

2) Apply PVA to the end of the lace and fold over 5mm from the end.

5mm

Fold over

Make sure that the recesses at each end are on the same side of the lace.

Folded end

3) Apply more PVA to the end that was folded over, and fold in half in the other direction, as shown in the diagram below.

Fold

Folded over 5mm from the end.

Fold in half, bringing the sides in to meet in the center.

3 Thread the 60cm length of lace into the third hole on the front side of the sixth plate (inset). Pull it through so the sealed end is up against the hole.

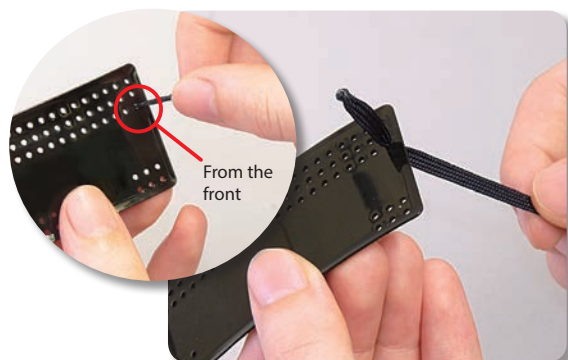

4 To secure the sealed end of the lace in place, mash it against the plate with your thumb.



5 Pass the lace through the back, in the hole next to the first one.

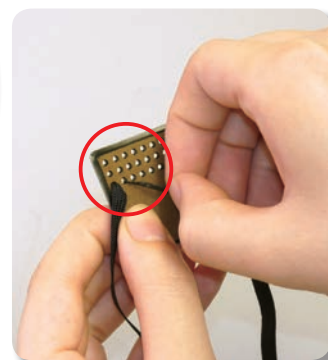

6 Bring the lace up and pass it down through the next hole. Repeat this process all along the third row of the tasset plate.

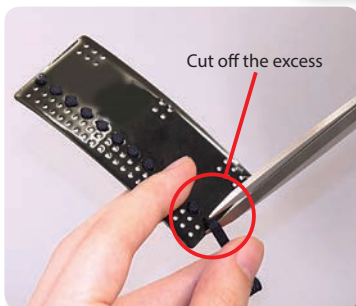

How to make a ball knot

Tie a knot in the end of the lace around a toothpick, up against the plate. Cut off the excess lace and apply white glue to the knot.

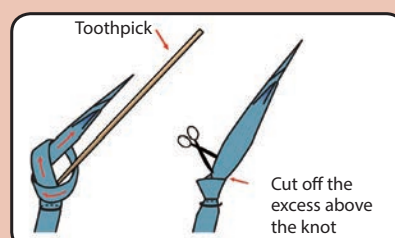

Apply glue to the knot



7 Tie a knot in the end of the lace as shown in the diagram above. Cut away any excess lace, and apply white glue to the knot.

8 Before the glue sets on the knot, adjust the way it sits, as shown in the photos.

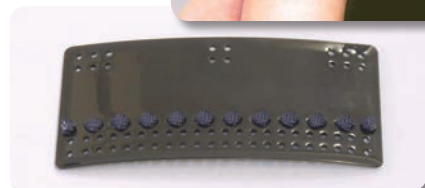

9 Prepare another length of lace and thread it through the bottom hole of the third column of the sixth plate. Leave about 5mm at the end of the lace on the back side and glue it into place (circled).

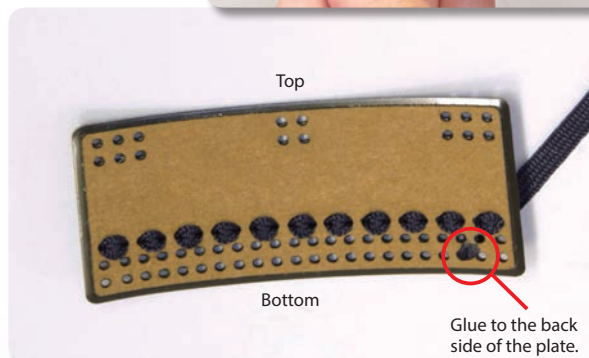

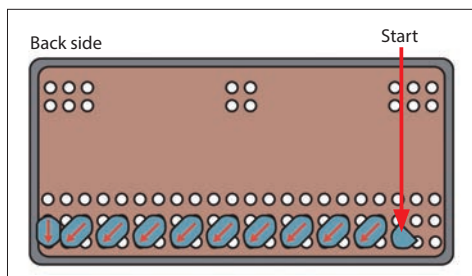

10 Thread the lace from the third column, bottom row hole to the fourth column, second row, passing through to the back of the plate.

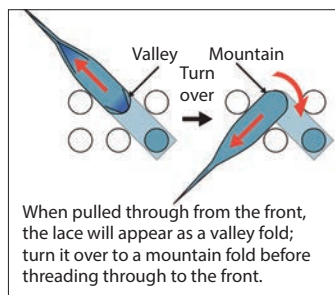

12 Continue to thread along the bottom two rows of the sixth plate, using the diagram in Step 10 as a guide.



Third hole (bottom row) to fourth hole (second row), as viewed from the front of the plate.

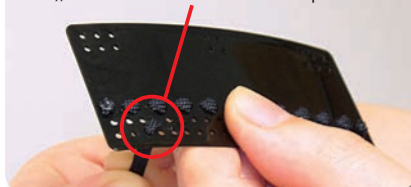

11 Take the lace from the fourth hole (second row) and pass it through the fifth hole (bottom row). Adjust the lace to the correct position (mountain fold) on both sides of the plate, using the diagram (above right) to help achieve this.

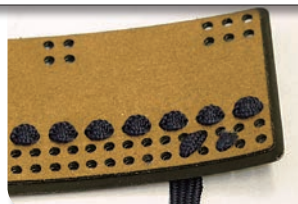

13 When you have finished threading the diagonals along the bottom two rows, the sixth tasset plate should appear as the one shown below.

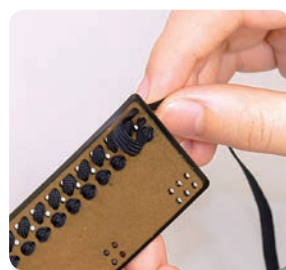
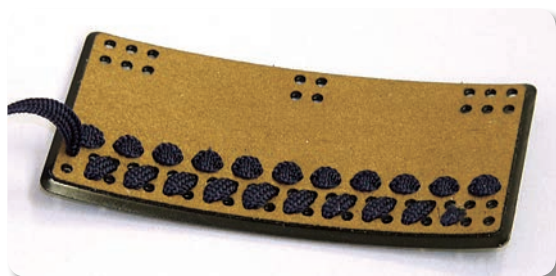

14 Now pass the lace through the hole in the bottom row, through the 21st hole of the second row and cross over to the 20th hole (bottom row). Repeat the process from Steps 10-13 in reverse until you reach the end of the plate.



15 Pass the end of the lace through the first hole of the bottom row, then under the loop between the second hole (bottom row) and the first hole (second row).

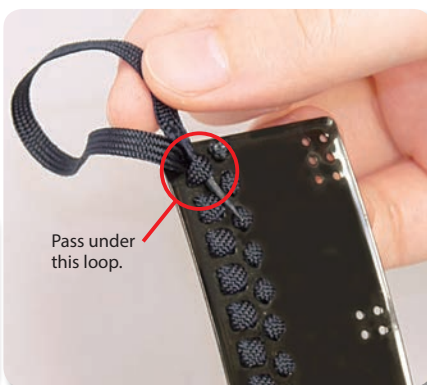

16 Pass the lace through the remaining hole (second hole, second row).

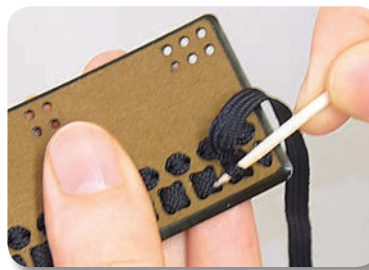
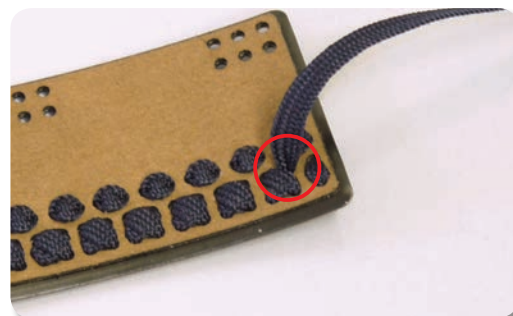

17 Use a toothpick to loosen the lace between the second hole (bottom row) and the third hole (second row) and pass the lace through.

18 Apply some PVA to the underside of the lace and flatten down into position. Cut away the excess, as illustrated in the diagram.

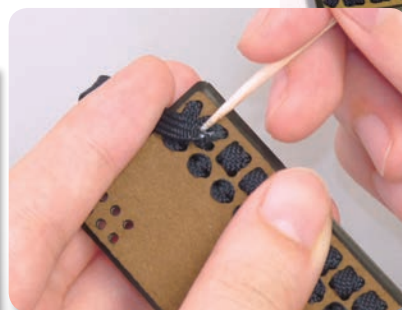
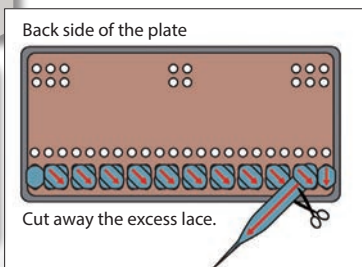
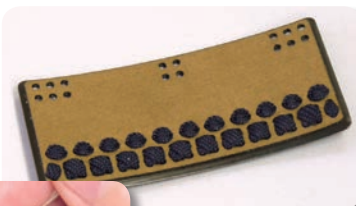



19 In this stage you received the 'plate check sheet.' Use it to confirm the correct position of the three plates assembled in Stage 2.

20 Attach the fourth plate to the previous three – see page 6 for detailed instructions on how to do so. Lay the four plates on the check sheet to ensure the position is correct.

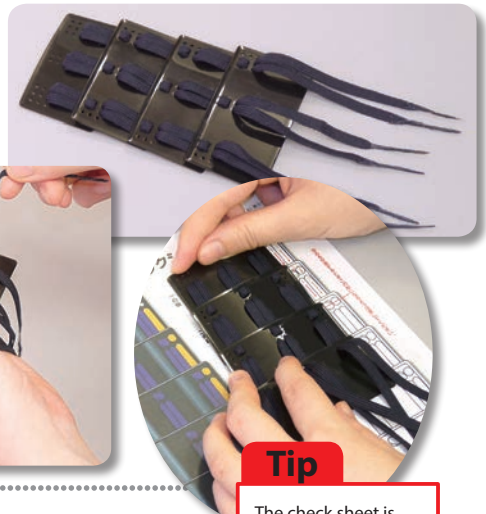

Tip

The check sheet is designed only as a guide, so if your plates are out of place by 2-3mm it will still be okay.



21 Repeat the previous step, fitting the fifth plate to the previous four.

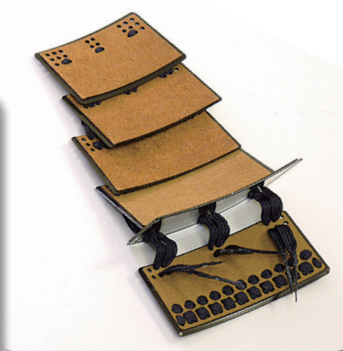

22 Attach the sixth plate in the same way. The ends of the laces should come through the innermost holes, leaving two at the sides.

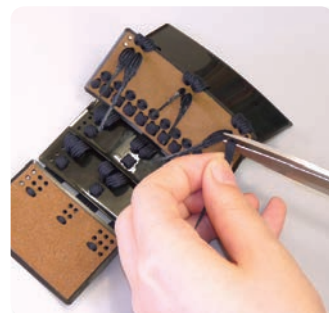

23 See the 'How to make a ball knot' box on page 11 to finish the lace, as shown in the photos. Cut away the excess lace and apply white glue to the knot to secure in place.

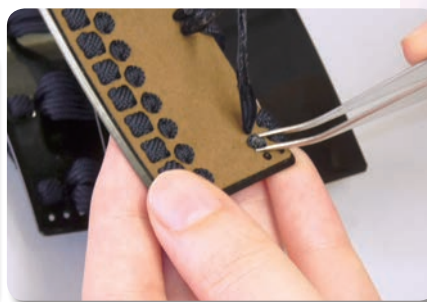

24 Finish the other five laces (red circles) in the same way.

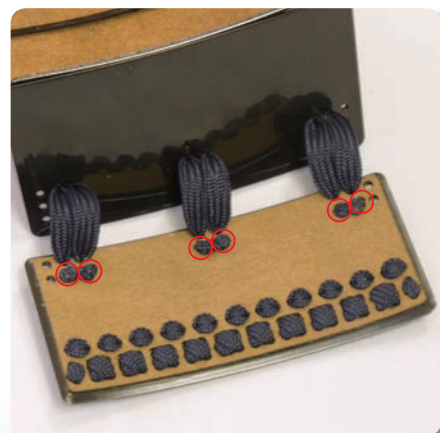

25 Using a cotton swab dampened with water, wet the crossed laces at the bottom of the sixth plate and flatten them with your thumb.

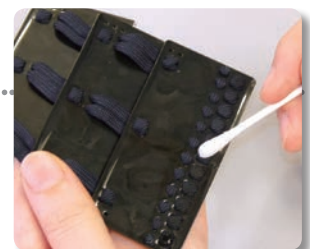

Assembled parts

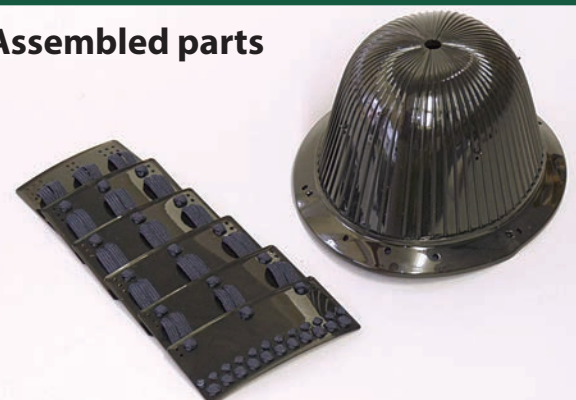

The cuirass and tasset plates



Your parts

Yellow lace (approximately 50cm)
Hinge (left)
Hinge (right)
Cuirass (front main)
Cuirass (front upper)

Tools & materials

Multi-purpose adhesive
Toothpick
Scissors
Pegs
Tweezers
Masking tape
White glue

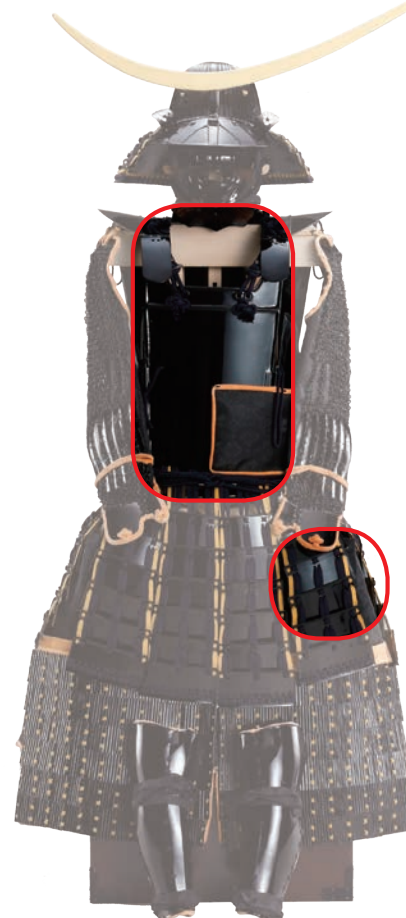

The cuirass

1 Apply some multi-purpose adhesive to the surface of the front upper part of the cuirass, along the area with the holes, placing the glue between the holes, as shown.

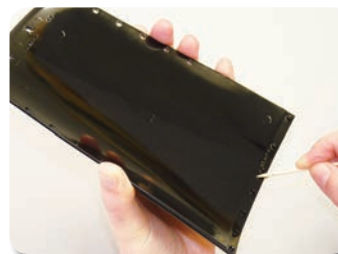
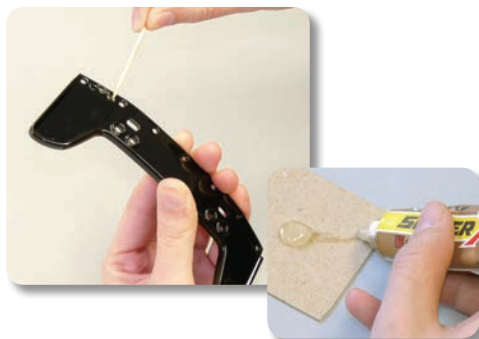

2 Apply multi-purpose adhesive to the top edge of the main cuirass, between the projections, and fit the upper part in place, engaging the holes and projections of both parts.



3 Hold the two pieces in place while the glue dries. You may prefer to use clothespins for this.



4 Locate the points along the edges of the cuirass where the hinges (labeled 'left' and 'right') connect to it. Test-fit them in place.



5 Apply multi-purpose adhesive to the right side of the cuirass where the right hinge fits, and to the right hinge.



- 6** Fit the right hinge into position and hold it in place with clothespins while the glue is drying. Then repeat for the left hinge.



- 7** Leave the pegs in place until the glue has dried.



Tip

You are likely to get grease and fingerprints on the surface of the armor parts, so use a microfiber cloth to remove them from the surfaces.

The tasset plates

- 1** Refer to the check sheet for details of where the yellow lace is fitted. Prepare the length of yellow lace as with previous laces.

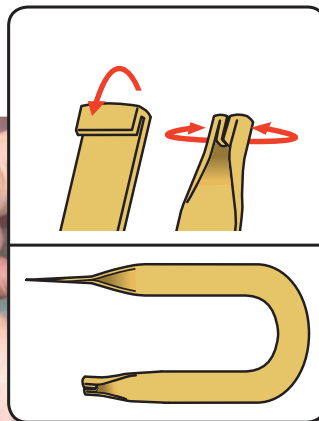
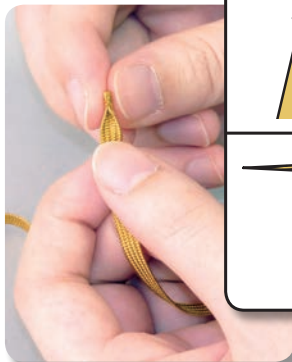

- 2** Thread the yellow lace through the outer hole of the third row of the first plate. Refer to the check sheet to help you.

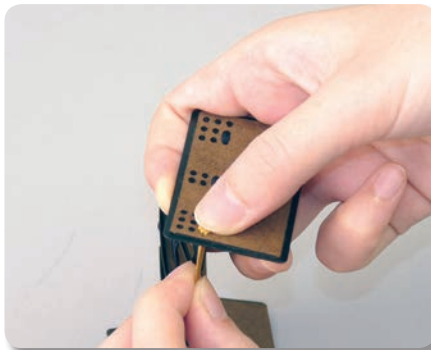
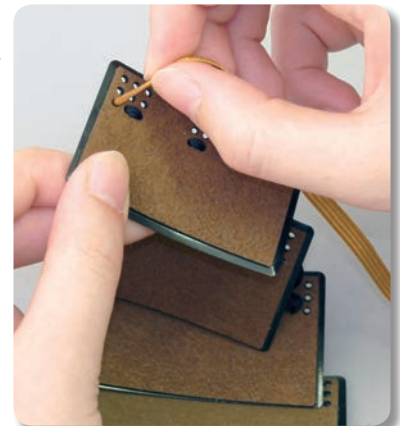

- 3** Pull the yellow lace all the way through the hole until it catches on the sealed end, then apply some white glue to the end and mash it against the backing with your thumb.

- 4** Pass the lace down and then through the top hole of the second plate from the back.

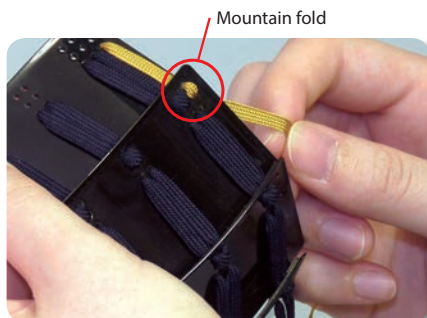
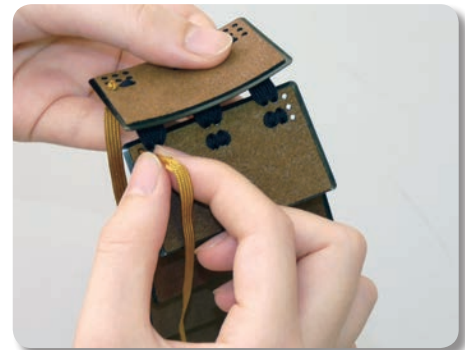

Mountain fold

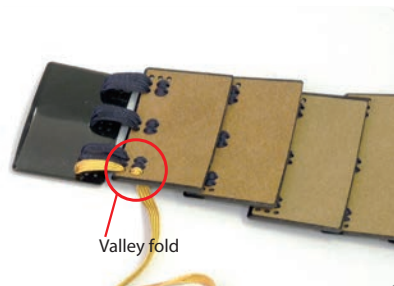

Valley fold

- 5** Thread the lace through to the back of the second plate, in the hole directly below the top one. Then pass the lace back through the second plate, pulling it through to the front (above right).

- 6** Repeat this process until you come to the sixth plate and your assembly looks like the one shown here on the right.

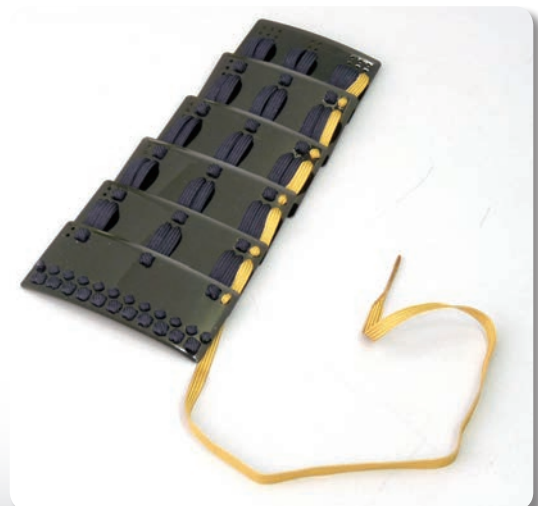

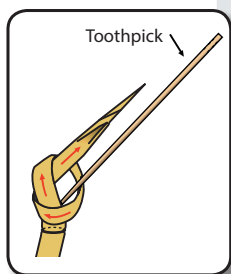

- 7** Tie a ball knot at the end of the lace, then cut off the excess and glue in place, as with previous ends.

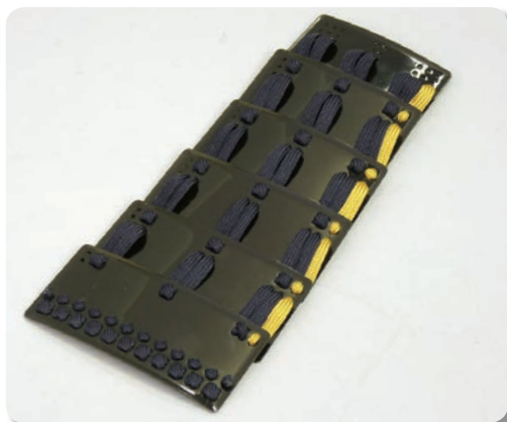

- 8** The lace is now completed on one side of your first tasset.

- 9** Prepare the remaining length of yellow lace, as in Step 1, page 13.

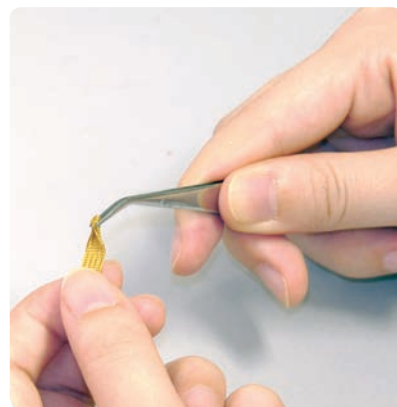

- 10** Repeat Steps 2-7 for the right side of the assembly. Your first tasset is now complete.

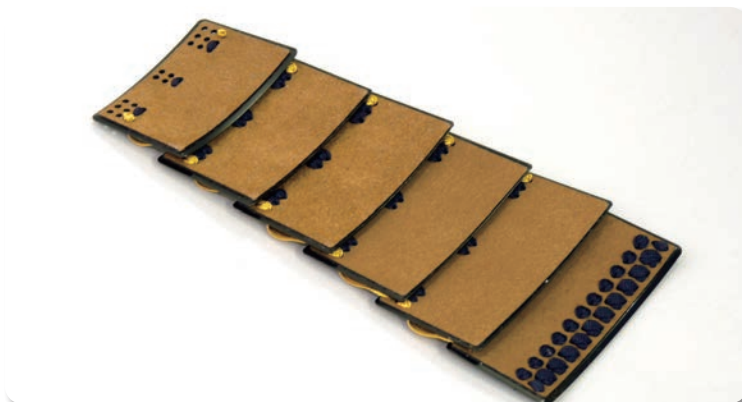

Assembled parts

