

Build the

C57

Steam  
Locomotive

Pack 02





# Build the **C57** Steam Locomotive

## Contents

Step by step	Pages
Stage 05: The front deck	13
Stage 06: The feedwater system	15
Stage 07: The release lever	17
Stage 08: The inspection lids	19
Stage 09: The front deck parts	21
Stage 10: The main underframe	23
Stage 11: The main underframe front	25
Stage 12: The cylinder plates	27

Editorial and design by Continuo Creative, 39-41 North Road, London N7 9DP.  
Published in the UK by De Agostini UK Ltd, Battersea Studios 2, 82 Silverthorne Road, London SW8 3HE.  
Published in the USA by De Agostini Publishing USA, Inc., 915 Broadway, Suite 609, New York, NY 10010.  
All rights reserved © 2015

Warning: Not suitable for children under the age of 14. This product is not a toy and is not designed or intended for use in play. Items may vary from those shown.

# The front deck

## Your parts

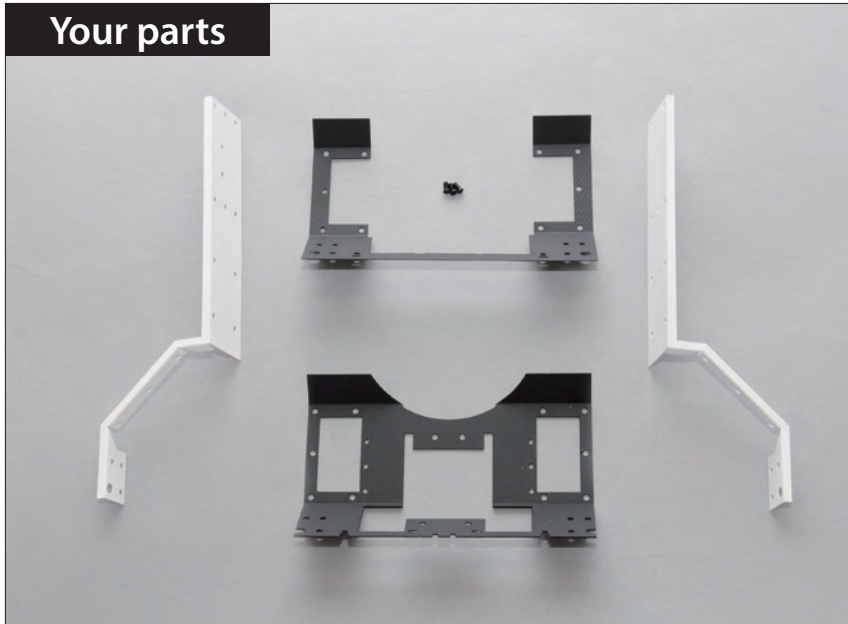

Front deck base  
Front deck upper plate  
Front left deck side  
Front right deck side  
3 screws 2 × 4mm

## Tools

Phillips screwdriver  
Multi-purpose adhesive  
Instant adhesive

## Where your parts fit

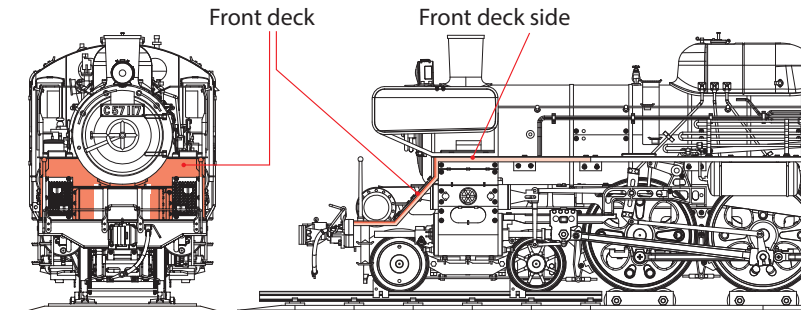

1



The front deck base fits onto the projecting tab at the bottom of the smokebox.



Test-fit the front deck base onto the tab, aligning the circled holes of both.

2



Remove the deck base and apply some multi-purpose adhesive to the tab.



Align the holes of the deck with those in the tab. Half-tighten a 2 x 4mm screw into each hole.

3



Before the glue dries, move the deck to the left and right, trying to get it as close to the smokebox as possible.

Once the deck is in its best position, fully tighten the screws into place.

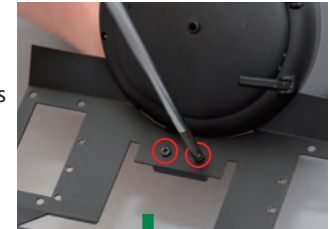

You can apply instant adhesive to the ends of the screws to ensure they stay in position.

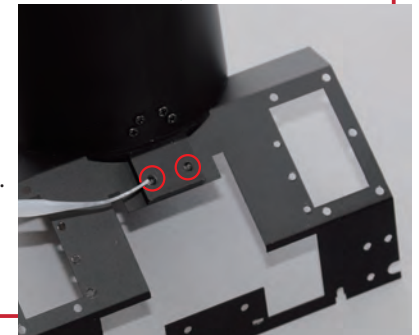

## Tip

The sides of the front deck and running board are painted white on the real C57. White pieces are supplied to recreate this paintwork on the model.



4



This stage is now complete. It is best to store the assembly on a raised surface, such as the top of a box, as shown above and on the far right. The photo on the right shows how the remaining parts will fit together.

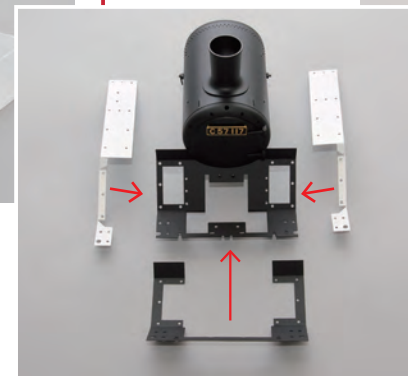

## Complete





# The feedwater system

## Your parts

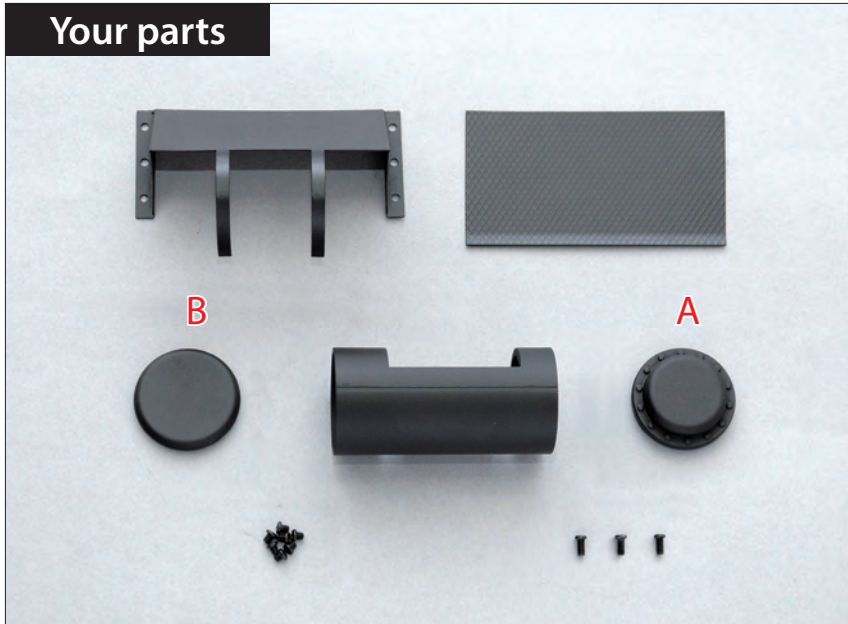

Feedwater heater body  
Feedwater heater end A  
Feedwater heater end B  
Feedwater heater holder  
Feedwater heater upper plate  
7 screws 2 × 2mm  
3 screws 2 × 4mm

### Tools

Phillips screwdriver  
Multi-purpose adhesive  
Epoxy adhesive

## Where your parts fit

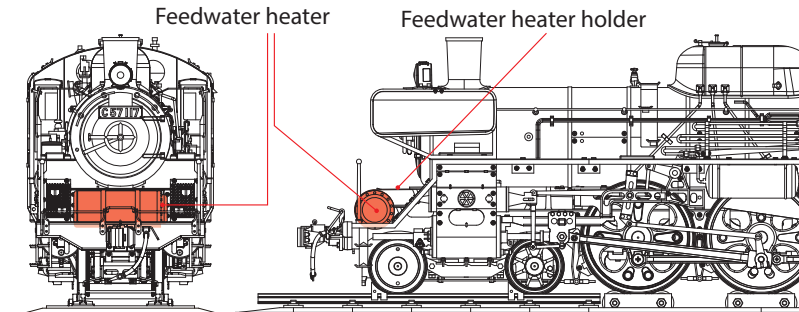

1

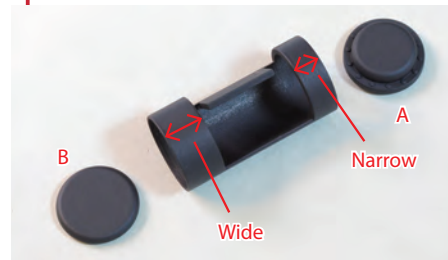

The feedwater heater body has a narrow end and a wide end, as indicated above. Feedwater heater end B goes in the wide end and feedwater heater end A fits into the narrow end.



Glue end B into the wide end of the feedwater heater with multi-purpose adhesive.



Glue end A to the narrow end of the feedwater heater.

You will now need the smokebox assembly from the previous stage.



# 2



Place the two bands of the feedwater heater holder over the feedwater heater.

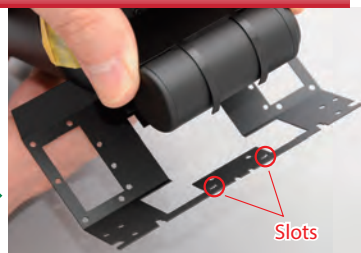

Slots



Pass the bands through the slots in the front deck.

Align the ends of the two bands with the two slots in the front deck.



If the bands won't enter the slots, bend them slightly.

# 3

Align the holes at the sides of the holder with the corresponding holes in the deck. Tighten a 2 x 2mm screw into the lowest of the three holes on the right-hand side of the holder.



Tighten a 2 x 4mm screw into the two circled holes in the underside of the deck, securing the heater.



Tighten a 2 x 2mm screw into each of the three holes on the left side of the holder.

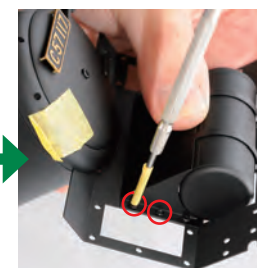

Tighten another two 2 x 2mm screws into the circled holes.

## Tips

If it is hard to tighten screws into any of the six screw holes in the front deck (circled), you can use the screwdriver to remove some of the paint from the surface.

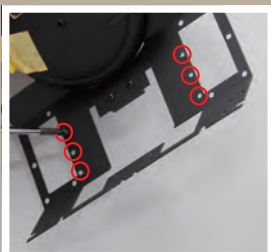

To avoid the screwdriver damaging any of the adjacent surfaces, you can cover the shank with masking tape, as shown.

# 4



Apply epoxy adhesive to the slots where the bands pass through.



Adjust the position of the bands to be flush with the heater.

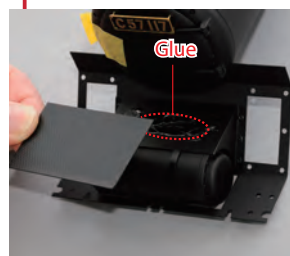

Apply glue to the top of the holder and place the holder upper plate onto it, with the raised lip at the front.

Before the adhesive dries, move the plate so it is up against the deck (dotted line), and in line with the inner edges of the gaps (red lines).

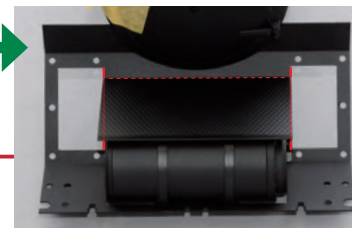

## Complete



# The release lever

## Your parts

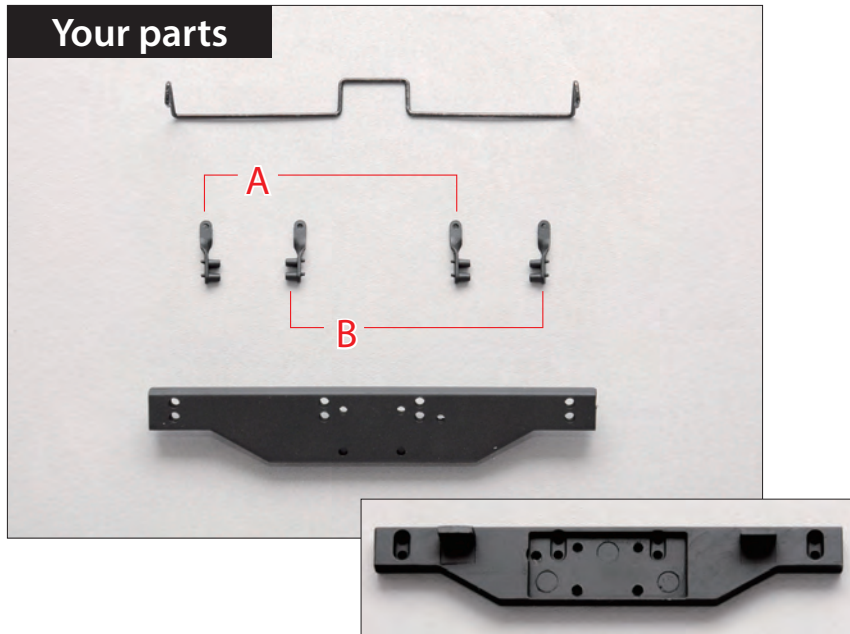

Release lever bar  
Release levers A × 2  
Release levers B × 2  
Front end beam

## Tools

Multi-purpose adhesive  
Instant adhesive

## Where your parts fit

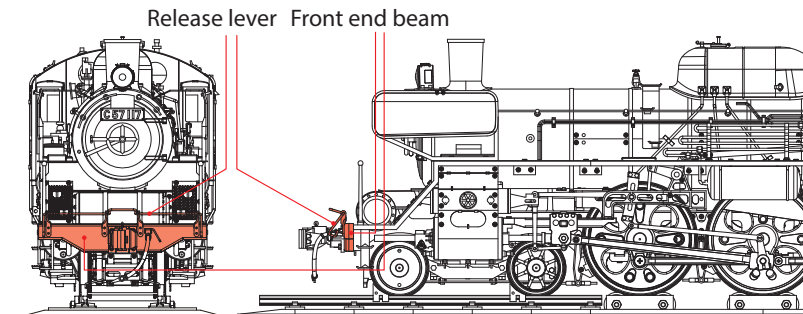

1



This picture shows the difference between a release lever A, on the left, and a release lever B, on the right.



Place the four release levers onto the release lever bar, alternating their order, as shown below.

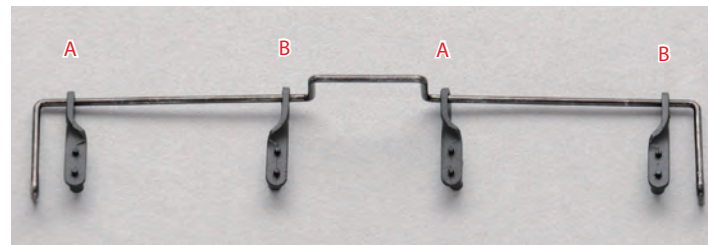

This is how the release lever bar should look, with the levers positioned A, B, A, B, from the left to right.



# 2



Apply some multi-purpose adhesive to the two pins on one of the levers.



Insert the pins of the lever into the corresponding holes in the front end beam. Then repeat for the other three levers.



If any excess adhesive is visible on the front end beam around the levers, use something pointed – such as a toothpick – to remove it before it dries.

## Tips

The three glues used in this series are all different, as detailed below:

**Multi-purpose adhesive**

This glue takes time to dry, and so remains malleable for a while after application. This also allows excess to be removed easily.

**Instant adhesive/superglue**

This liquid glue dries almost instantly, allowing you to place the parts in position and then apply it to the join between them.

**Epoxy adhesive**

This slow-drying glue is incredibly strong. As a result, you must remove any excess before it dries.

# 3

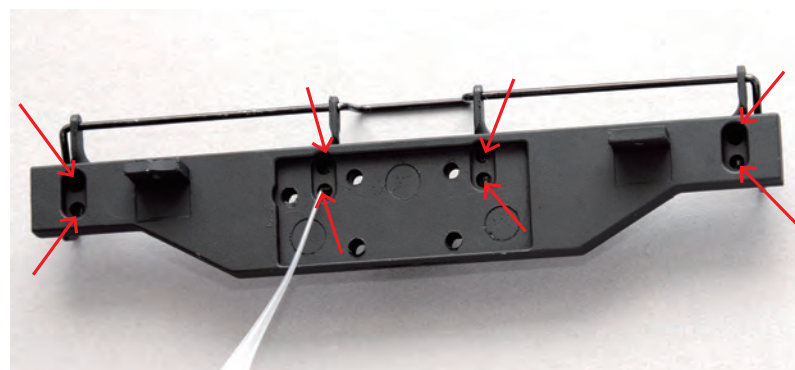

Apply some instant adhesive to the rear of the holes housing the pins of the levers, to make sure they are secured.

## Tips

When using instant adhesive/superglue, the excess can sometimes dry a whitish colour, and because it dries so quickly it can be hard to remove excess from the surface. You can use hand cream to remove the excess whitened superglue.



Sometimes instant adhesive/superglue will cause whitening when it dries, as shown above.



Apply a small amount of the hand cream to a cotton swab.

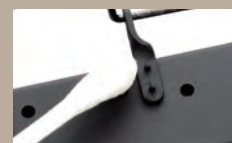

Gently apply the hand cream to the whitened areas.

## Complete

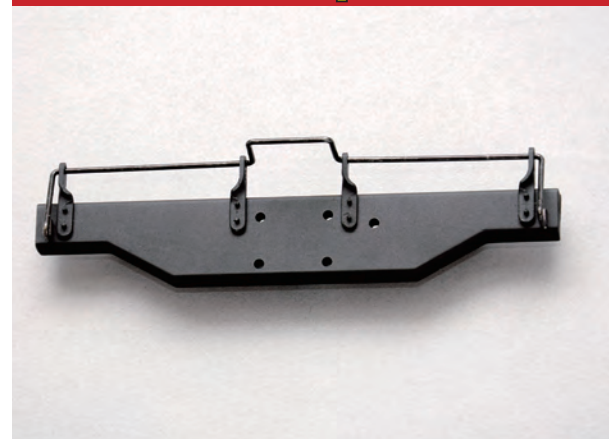



# The inspection lids

## Your parts

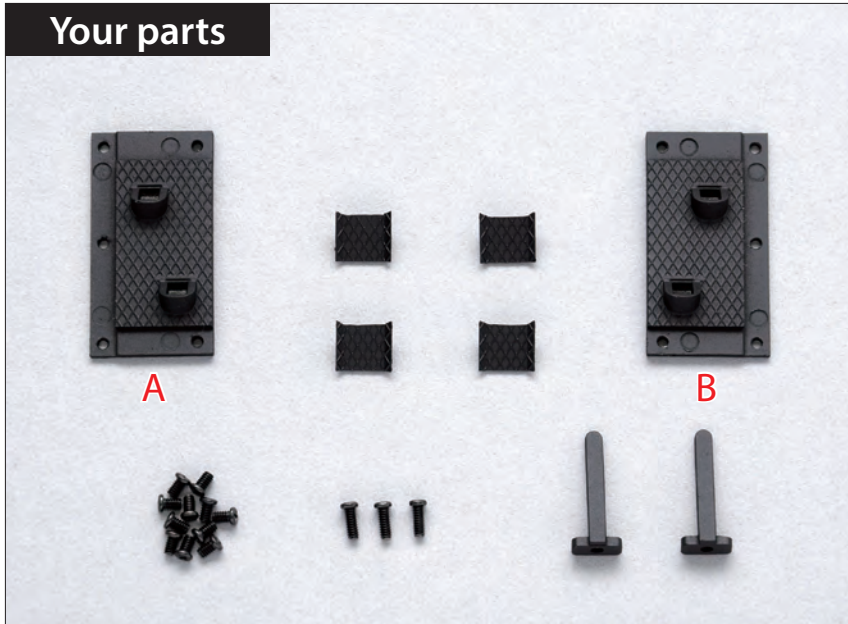

Inspection lid A  
Inspection lid B  
Steps × 4  
Hanging brackets × 2  
3 screws 2 × 5mm  
11 screws 2 × 3mm

## Tools

Phillips screwdriver  
Multi-purpose adhesive

## Where your parts fit

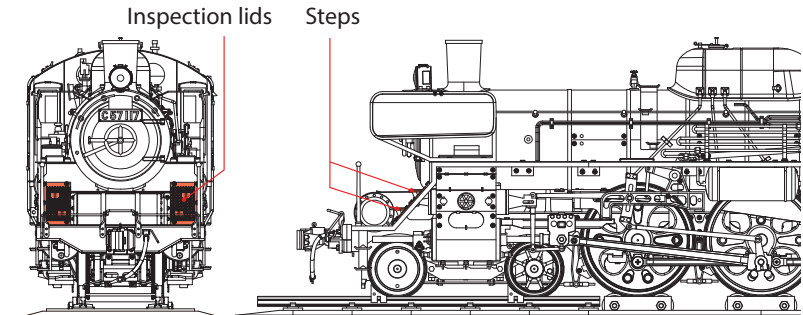

1

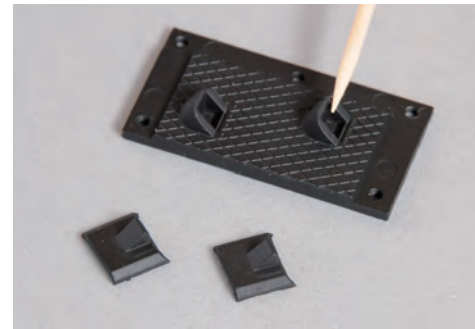

Apply a small amount of multi-purpose adhesive to the projecting parts of inspection lid A. Have two of the steps ready.

Place the two steps onto the projecting parts of the lid.

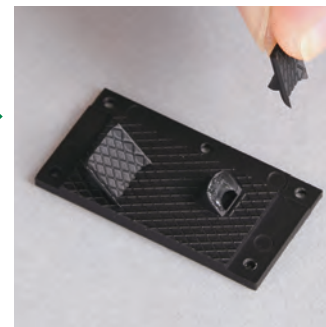

Repeat this process to prepare inspection lid B.



2



Place the front deck upper plate (Stage 5) onto the front deck.

Front deck base



Front deck upper plate

Position the upper plate so that the holes align with those in the front deck.

3

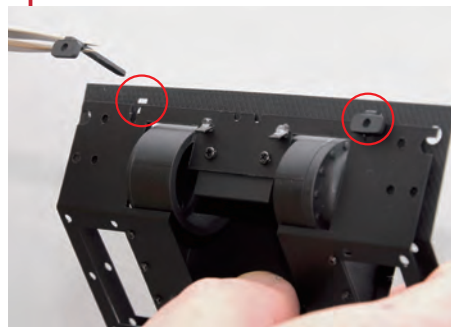

Align the holes at the rear of the front beam with those in the brackets.



Insert the two hanging brackets into the rectangular holes in the underside of the front deck.

Tighten a 2 x 5mm screw into the holes behind the bracket in the front deck (arrowed).

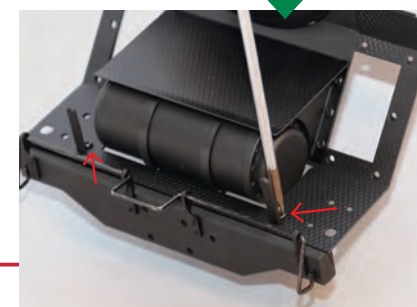

4



Place inspection lid B into place from behind the front deck.

Insert and partially tighten a 2 x 3mm screw into each of the two inner holes (arrowed) to hold the lid in place. Repeat for inspection lid A.

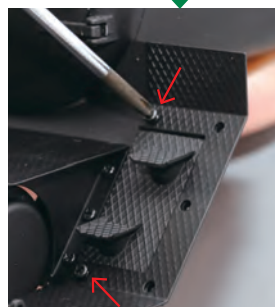

5



Insert the front left deck side (Stage 5) between the front deck and the inspection lid.



Align the three holes of the deck side with those in the front deck and inspection lid.

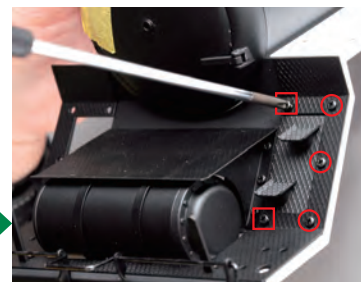

Tighten three 2 x 3mm screws into the holes at the side of the deck (circled) and then fully tighten the screws in the two inner holes (marked here with squares). Repeat this for the front right deck side.

Complete





# The front deck parts

## Your parts

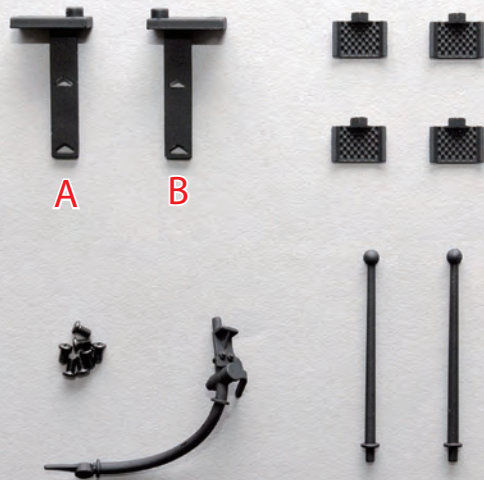

Step frame A  
Step frame B  
Steps × 4  
7 screws 2 × 3mm  
Air hose  
Grab bars × 2

## Tools

Phillips screwdriver  
Multi-purpose adhesive  
Instant adhesive

## Where your parts fit

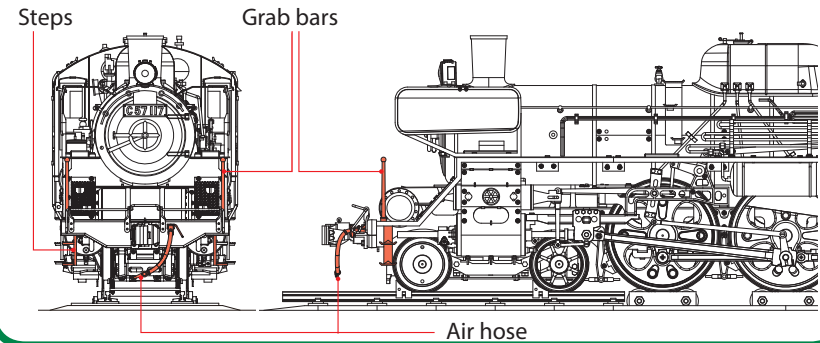

1



Insert the triangular projections of the steps into the holes in step frame A, identifiable by the position of the top projection (circled).

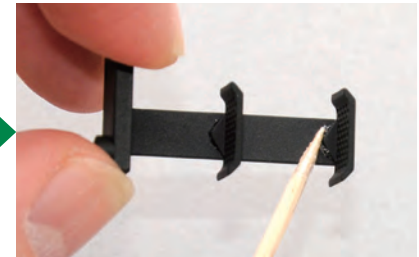

Fix the steps to the frame with instant adhesive, and remove any excess glue.



Apply a small amount of instant adhesive to the rear of the steps, as shown.



Repeat the process for step frame B. The step frames are distinguishable by the projections on top (arrowed).

2



Align the projection on the top of steps B with the circled hole in the underside of the deck.

Tighten three 2 × 3mm screws into the circled holes. Repeat for steps A.



Push the projection in and then align the holes.



3



Glue one of the grab bars into the circled hole on the left-hand side of the front deck with multi-purpose adhesive.

Glue the second grab bar into the hole on the right-hand side of the front deck.



Apply instant adhesive to the undersides of the grab bars.

Tip

During assembly, you may have scraped away some of the black paint on the parts. If that is the case, you can repair it by painting with a matching paint (matt black).



4



Test-fit the air hose into the circled hole in the front beam.



Apply multi-purpose adhesive to the points indicated in the photo.



Place the air hose into position and remove any excess adhesive.



Apply a small amount of instant adhesive to the air hose from the back of the front beam.

Complete





# The main underframe

## Where your parts fit

The main underframe

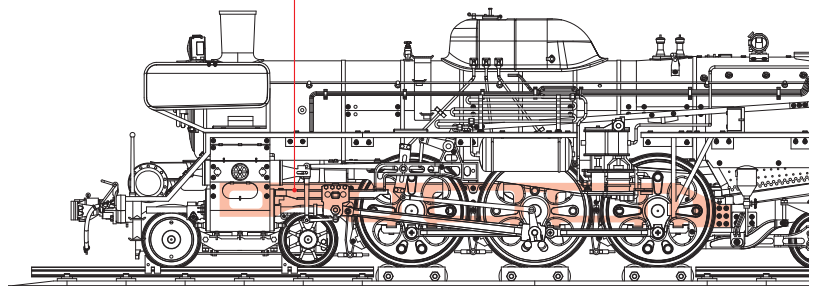

## Your parts

Left



Right



Left

Right

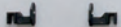

Main underframe (left)  
Main underframe (right)  
Brake support (left)  
Brake support (right)  
Main underframe brace  
3 screws 2 × 3mm  
5 screws 2 × 5mm

## Tools

Phillips screwdriver

1

Left



Right



Place the left and right brake supports together to identify them.

Right



Right brake support

Left



Left brake support

The right brake support fits to the right main underframe at the circled point, and the left brake support fits to the left main underframe at the circled point.

2



Fit the brake supports to the underframes with  $2 \times 3\text{mm}$  screws.

This is how the brake supports should appear when fitted to the underframes.



3



Position the main underframes and the brace as shown in the photo.

Tighten a  $2 \times 5\text{mm}$  screw into each of the two circled holes in the right main underframe to secure it to the brace.



4

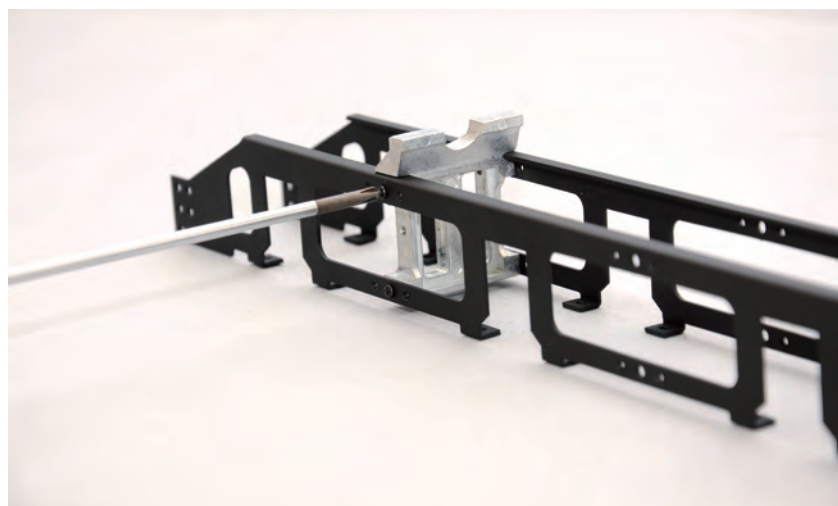

Secure the left main underframe to the free side of the brace with another two  $2 \times 5\text{mm}$  screws.

**Complete**





# The main underframe front

## Your parts

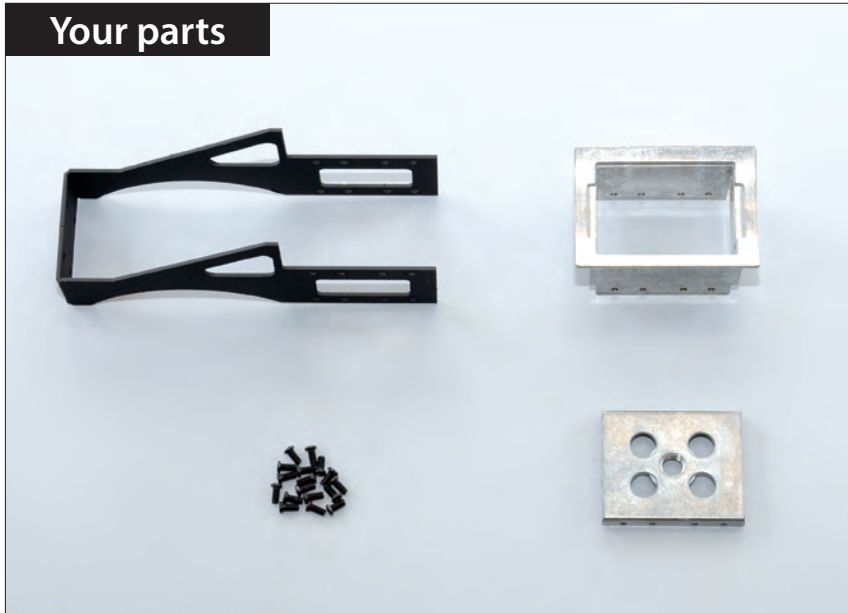

Main underframe front  
Smoke chamber support  
17 screws 2 × 4mm  
Truck support

## Tools

Phillips screwdriver

## Where your parts fit

Main underframe front

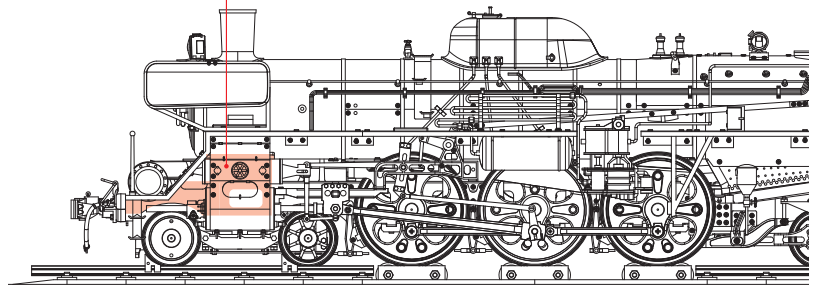

1



Position the main underframe front (Stage 10) as shown, together with the main underframe front, smoke chamber support and truck support.



Lightly squeeze the rear ends of the main underframe front together and place them between the front ends of the main underframe assembly.

2

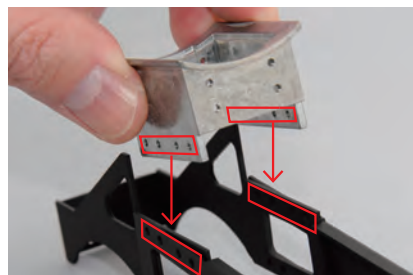

Position the smoke chamber support between the sections where the underframe components overlap, aligning the holes of all three parts.

Tighten four more 2 × 4mm screws into the holes in the right underframe, securing the parts together.

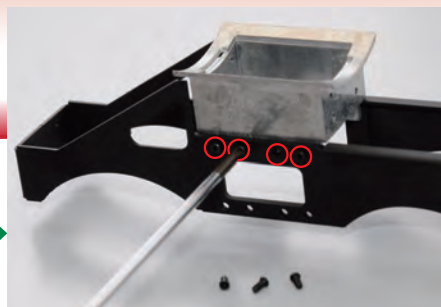

Tighten a 2 × 4mm screw into each of the four aligned holes in the left underframe.



3



Turn the underframe assembly over and place the truck support between the sides, below the smoke chamber support.

Tighten a 2 × 4mm screw into each of the four aligned holes on each side of the underframe assembly.

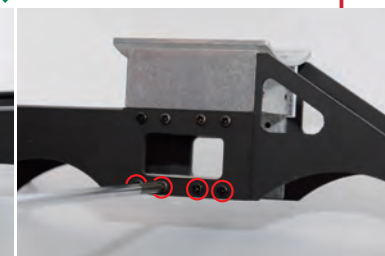

## FOCUS The underframe

The underframe structure of your C57 model authentically recreates the underframe of the real steam locomotive. The only differences are the size and the materials used.



4

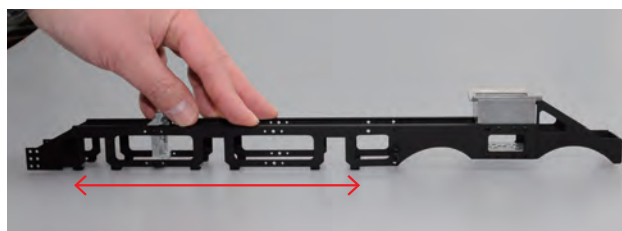

Place the underframe on a flat surface, as shown, and lightly press down on the top. Check that the bottom is resting flat in the area between the arrowheads.

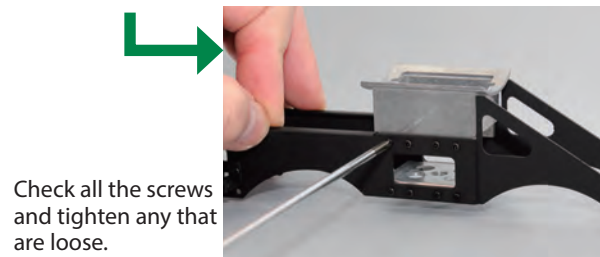

Check all the screws and tighten any that are loose.

Complete





# The cylinder plates

## Your parts

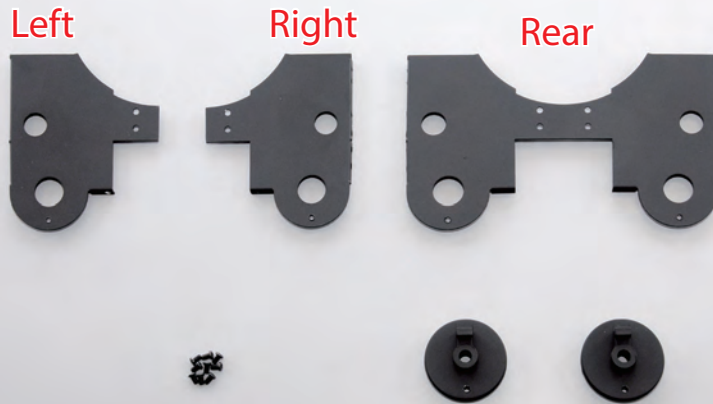

Cylinder front plate (left)  
Cylinder front plate (right)  
Cylinder rear plate  
9 screws 2 × 3mm  
Cylinder covers × 2

### Tools

Phillips screwdriver  
Multi-purpose adhesive

## Where your parts fit

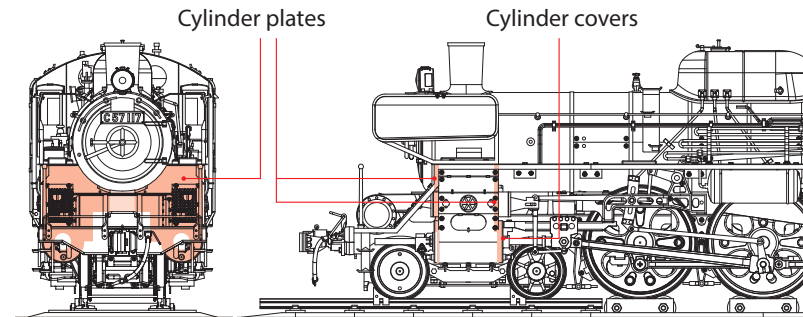

1

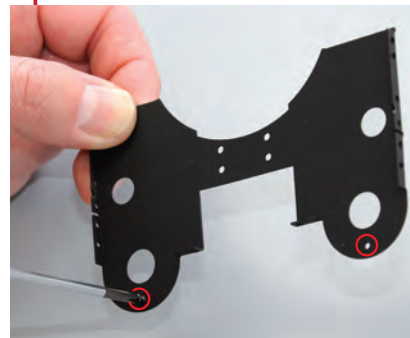

Tighten a 2 × 3mm screw into each of the two circled holes in the cylinder rear plate.



Apply multi-purpose adhesive to the rear of one of the cylinder covers. Then place it onto one arm of the cylinder rear plate, as shown, using the screw as a locating pin.

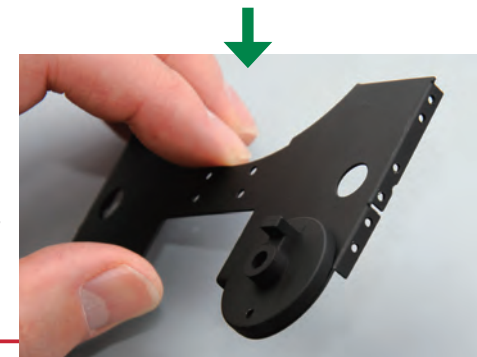

This is how the cylinder cover should look in place on the cylinder rear plate.



2



Fit the second cylinder cover to the cylinder rear plate in the same way as the first. Remove any excess glue from around the covers before they dry.

Remove the two screws from the cylinder rear plate.



3



The cylinder front plate is divided into two parts. The front faces of the plates are flat.

Insert the left cylinder front plate into the gap between the underframe and the smokebox support.

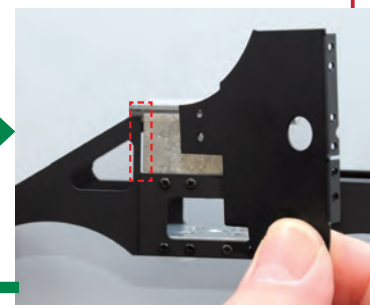

Align the holes of the left cylinder front plate with those in the smokebox support.

Fit the right cylinder front plate in the same way, and then secure both plates with 2 x 3mm screws.

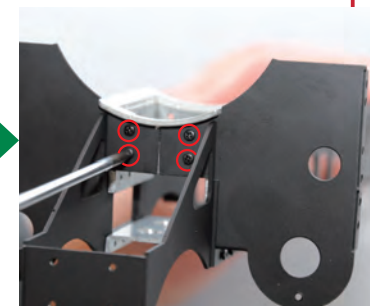

Tip

If either the cylinder front plates or rear plate doesn't fit into position, loosen the screws holding the smokebox support in place. Fit the plates and then retighten the screws.

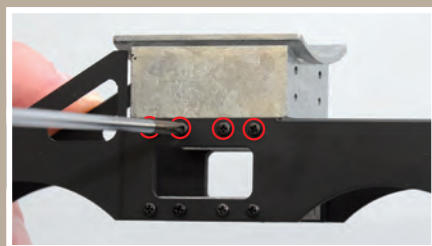

4

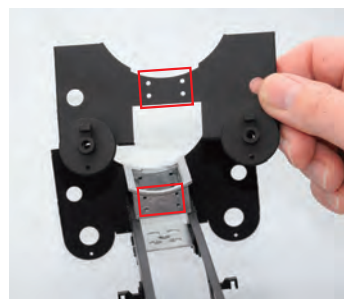

Align the four holes on the cylinder rear plate with those in the rear of the smokebox support.

Tighten a 2 x 3mm screw into each of the aligned holes.

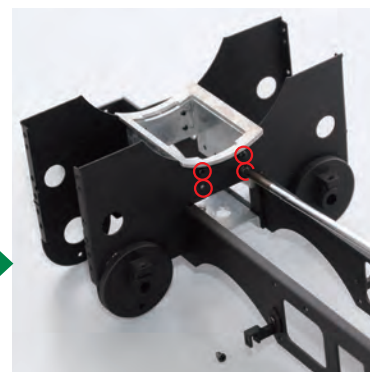

Complete

