



A Guide to Getting Around the Terry Campus



Charles L. Terry, Jr. Campus

BUILDING

Terry	100
Building 200	200
Science And Engineering Technology (SET)	300
Corporate Training Center (CTC)	400
Center For Energy Education & Training	400
Education And Technology (ETB)	700

KEY

100	200 Series
200	800 Series
300	100 Series
400	400 Series
400	400 Series
700	700 Series

BUILDING

White House (IT)	500
Facilities Machine Shop	600B
Office Of The President	1000

KEY

500	Parking
600B	Wifi Parking Lot
1000	Dart
	Public Safety Assistance Phones
	Gazebo
	Screening

SYMBOL KEY



Mailing Address: 100 Campus Drive, Dover, DE 19904 • For driving directions, visit www.dtcc.edu/our-campuses/dover/directions

Corporate Training Center/Center for Energy Education & Training (400 Bldg.)

The floor plan of the Corporate Training Center (400 Bldg.) includes the following areas:

- 438 Storage
- 432 Office, 433 Office, 434 Office, 428 Office
- 429 Engineering Department
- 427 Electronics Lab B, 426 Electronics Lab A
- 414, 412, 410, 408
- 402C, 402A
- 400A Conference Center, 400B Conference Center
- 437 Stairs
- 436 Electro Mechanical Lab
- 435, 425B, 424B, 424A
- 419 Office, 417
- 409 Office, 407B, 407A
- 403, 403A Stairs, 401
- 405A Office, 405B
- 405C Office, 405D Office, 405E Office
- 413, 405L, 415, 405M Office, 405N Office, 405O
- 416, 405K Staff Lounge, 405J Office, 405I Office, 405H Office, 405G Office
- 455 Energy Lab, 453, 451
- 459 III, 461
- 463
- 453A Energy Lab, 451A Energy Lab

Entrances are marked at several locations throughout the building.

Corporate Training Center
Energy and Engineering
Workforce Development and
Community Education



Science and Engineering Technology Center (SET-300 Bldg.)

200 Building

The floor plan of the Science and Engineering Technology Center (SET-300 Bldg.) includes the following areas:

- 302, 303 Office, 304A, 304B
- 320, 322, 324, 326, 328
- 350
- 305 Office, 306 Office, 307 Office
- 321, 323 VSC Mac Lab, 325 A, 325 C, 327 VSC Mac Lab, 329 VSC Mac Lab
- 351 Workforce Training Lab, 352
- 308 Office, 309 Office, 310 Office, 312 Office
- 330, 332, 334 Office, 336, 338A Office, 338
- 353
- 311 Office, 312 Office, 313 Office
- 331, 333 Computer Lab, 337, 339 Office, 355 Office
- 354 Nursing Skills Lab
- 314 Office, 315 Office, 316 Office
- 340 Office, 342 Science Lab, 344 Science Lab, 346 Science Lab, 348
- 317 Office, 318 Student Lounge, 341B, 341A
- 343, 345, 347
- 356 Nursing Simulation Lab
- Science Lab 364, 361, Science Lab 360
- 365, 363, 362

Main Entrance and Entrances are marked.

The floor plan of the 200 Building includes the following areas:

- 809, 810, 811, 816A
- 816
- 808, 807, 822
- 817
- 805, 806, 821
- 804, 801, 800, 819, 818
- 803, 802, Lobby

ABE/GED®
Workforce Training



Engineering
Nursing
Science Labs
Visual Communications

Terry Building (TER - 100 Bldg.)



FIRST FLOOR

- Admissions
- Advisement Center
- Assessment Center
- ATM
- Bookstore
- Business Office
- Cafeteria
- Career Center
- Dean of Student Affairs
- Financial Aid
- Human Resources
- Learning Commons/Library
- Registrar's Office
- Public Safety

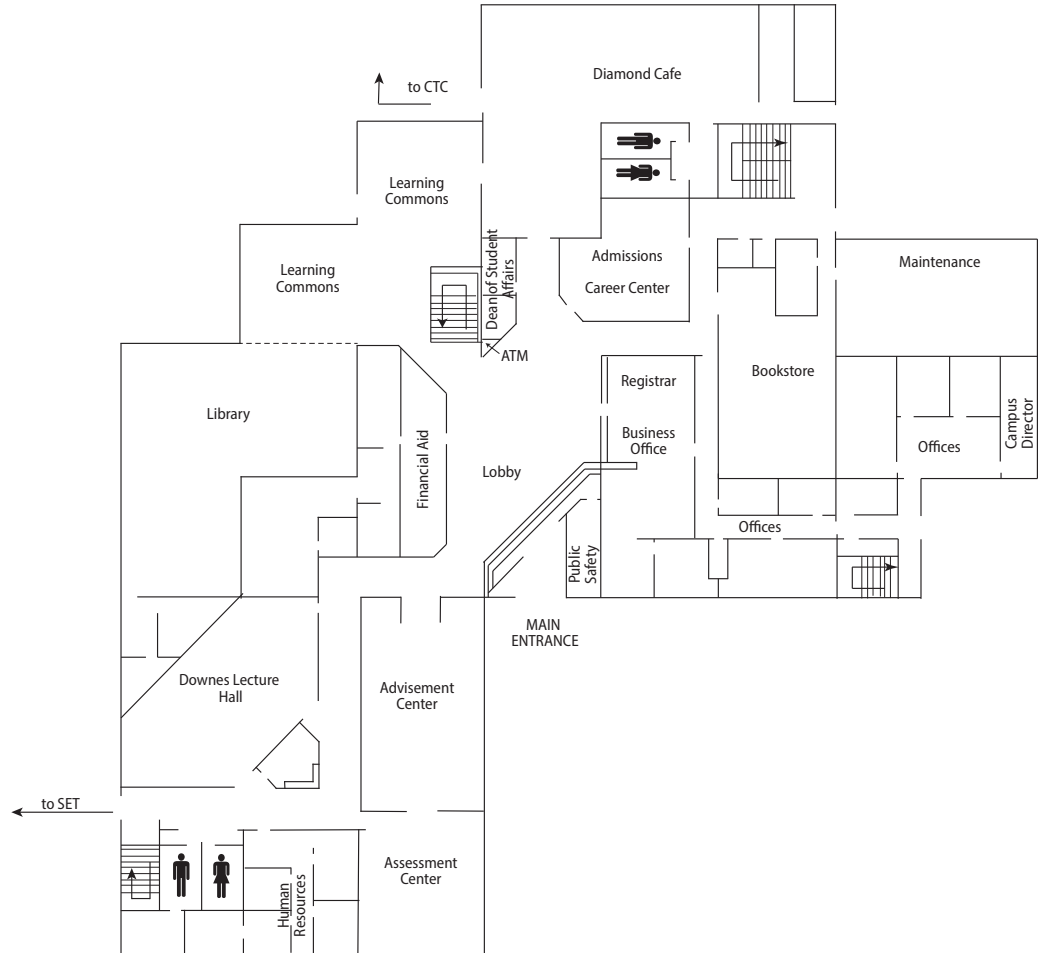

SECOND FLOOR

- Academic Center
- Center for Creative Instruction and Technology (CCIT)
- Dean of Instruction
- English Department
- Mathematics Department
- Math Success Center
- Student Life
- Testing Center
- Tutoring Center
- Veteran Resources
- Writing Center

