



Public Hearing

January 7, 2016

Proposed Closing of Lower
Southampton Elementary
School

Table of Contents

- Overview
- Questions to be addressed
- Overview of Lower Southampton Elementary School
- Consolidation and improvement goals
- Road Map timeline
- Enrollment information
- Renovation cost estimates

Why close Lower South?

The closure of Lower Southampton Elementary is part of an extensive Road Map plan already under way throughout the district to match building capacities with a student population that has declined considerably over the past 20 years. This plan also includes modernizing and increasing efficiency in the remaining school buildings to enhance comfort, efficiency and safety for all students and staff, while increasing educational resources without creating new burdens for taxpayers.

Why close Lower South?

- ◆ Lower Southampton Elementary School is the oldest in the district, and would require extensive renovations and upgrades to bring it to modern standards of efficiency and safety.
- ◆ The new Tawanka Elementary School on Brownsville Road (scheduled August 2016 opening) was planned to absorb the student population from Lower South.
- ◆ New Tawanka is in close proximity to neighborhoods currently served by Lower South, minimizing transportation challenges and costs.

Questions to be answered

- **How will elementary school feeder patterns change as a result of this closing?**

Feeder plans will be examined with the goal of preserving the current historical and geographic patterns, which now have all Lower South students attending Poquessing Middle School. Some students attending Tawanka from other parts of the district might feed into a different middle school based on their own geographic location and historic feeder patterns.

- **Will all current Lower Southampton ES neighborhoods attend the new Tawanka Elementary School?**

Yes, current plans call for all neighborhoods now served by Lower South to attend the new Tawanka Elementary School.

Questions to be answered

➤ **What will happen to the closed building?**

The District will seek to maximize usage and revenue from the building through a lease or sale under the direction of the School Board. The district will continue to maintain the building until a sale or lease is completed and other arrangements for maintenance made.

➤ **What will happen if Lower Southampton remains open?**

The Road Map was implemented with the closure of three existing elementary school buildings in mind, one of which has already been closed. Should one or both buildings currently proposed for closure not be closed, the district will face costly inefficiencies due to underutilization of school buildings. In addition, Lower Southampton Elementary School would require significant investment in renovation to bring it up to modern standards of efficiency, comfort and safety should it remain open.

Lower Southampton Elementary School

7



Site Size
15 acres

Building size
55,596 sq. ft.

Construction date
1950

Last renovation / expansion
1966

PDE regular capacity
550

Max practical capacity
554

7 School Lane
Trevose, PA 19053

Lower Southampton Elementary School was built in 1950, making it the oldest school building currently in use at Neshaminy School District. It has not been significantly renovated or expanded since 1966, when the gymnasium and extra classrooms were added to the building.

As of October 2015, the school serves 426 students in grades K-4. It is the second smallest school in the district after Oliver Heckman Elementary School.

The school is located between the Lower Southampton Township complex and Route 213 in Trevose.



Lower Southampton Elementary School

Floor Plan

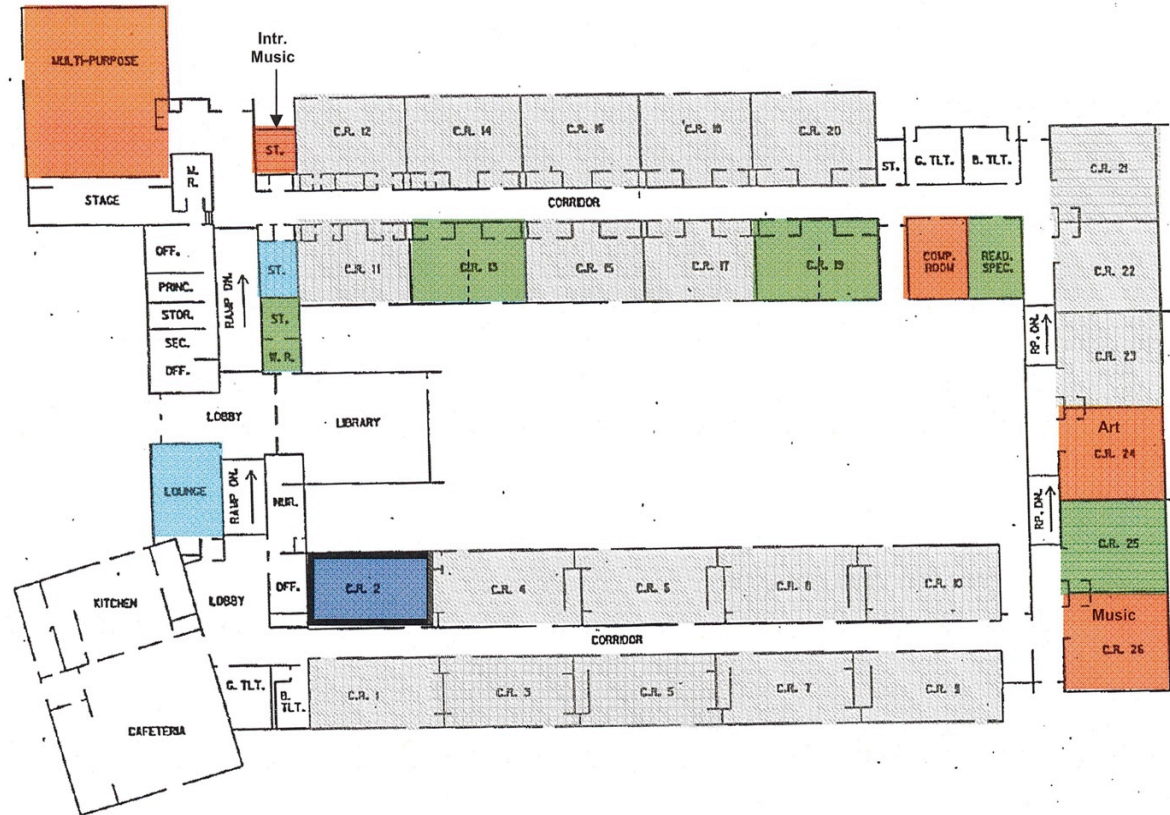

Legend/Notes:

- General Instruction (capacity)
- Special Instruction/use (non-capacity; full-size room)
- Self-contained SE; IU use (bold outline)
- Small Group/Specialized/Resource Special Ed
- Other



Neshaminy School District Consolidation and Improvement Goals

- ◆ Capture consolidation savings as soon as possible
- ◆ Upgrade facilities across the district
- ◆ Maximize improvements; minimize costs
- ◆ Minimize disruption to operations

Neshaminy School District Road Map timeline

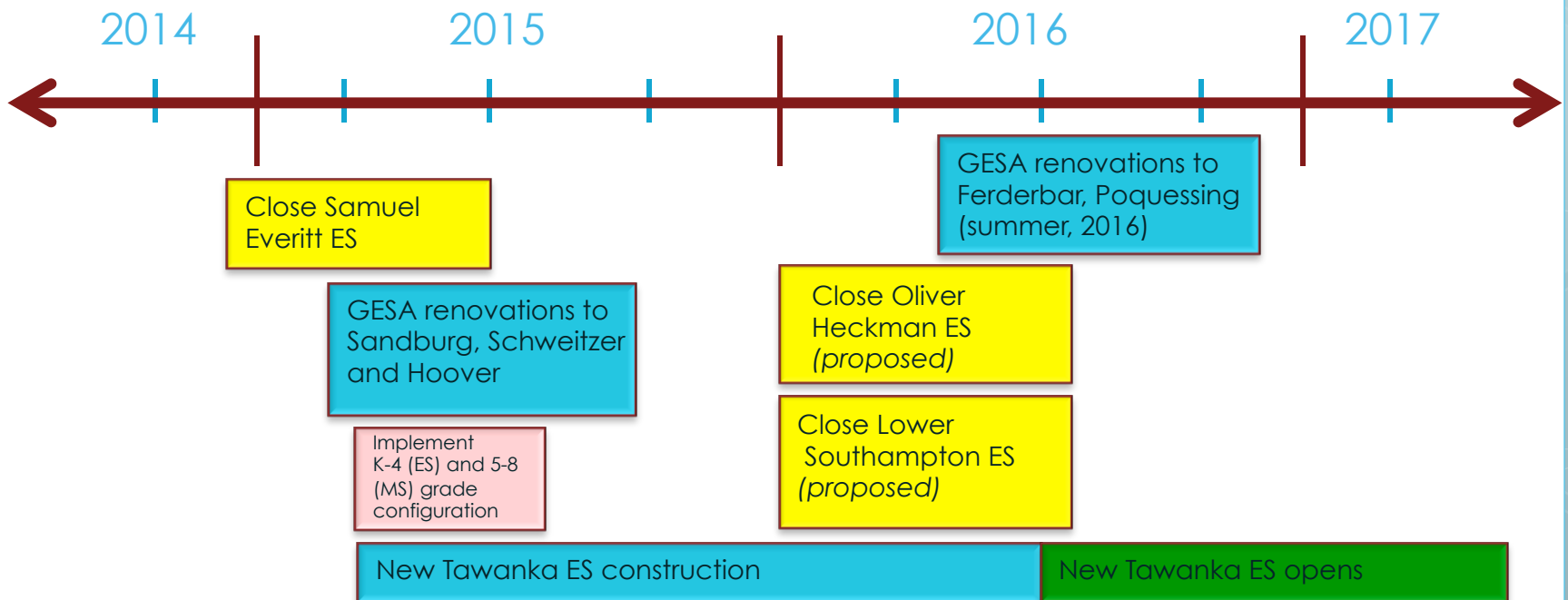

DISTRICT ENROLLMENT
2000 to December 2015

School	2000	2001	2002	2003	2004	2005	2006	2007	2008	2009	2010	2011	2012	3/1/2013	10/1/2014	12/21/2015
Pearl Buck	602	561	514	499	464	429	438	451	449	444	449	459	410	410	433	431
Samuel Everitt	500	478	456	377	388	369	374	368	403	396	391	397	387	371	395	
Joseph Ferderbar	542	499	521	513	520	513	525	536	516	540	527	539	564	564	585	538
Oliver Heckman	433	431	427	509	511	516	523	527	527	528	534	518	493	486	457	383
Herbert Hoover	657	637	606	654	666	655	641	631	620	626	607	617	635	637	695	561
Lower South	405	362	357	485	490	473	453	437	452	451	434	464	507	512	513	429
Walter Miller	473	470	471	461	446	443	451	443	406	384	383	384	408	413	415	468
Albert Schweitzer	321	332	310	352	362	344	342	375	374	367	340	360	372	382	374	442
Tawanka	372	351	344													
Maple Point	1121	1068	1043	1078	1099	1103	1046	957	930	1401	966	1005	992	979	935	1247
Nesh Middle	817	855	823	796	718	706	683	666	660							
Poquessing	610	599	605	651	666	662	648	616	606	706	554	580	528	529	585	802
Carl Sandburg	774	761	768	754	715	718	686	688	688	716	603	575	530	526	786	642
Neshaminy HS	2455	2317	2390	2317	2307	2282	2313	2300	2239	2170	2865	2850	2691	2638	2540	2506
Tawanka				42	50	61	67	57	59	60	39	53				
Neshaminy Bldgs	10082	9721	9635	9488	9402	9274	8752	9052	8929	8789	8692	8801	8517	8447	8413	8449
Other Educational Pl. (Includes Tech School)											628	547	470	483	529	560
											9320	9348	8987	8930	8942	9009

2009: NMS closed
2010: Grade 9 to HS
2014: Full-day K
2015: Everitt closed
2015: Grade 5 to MS

District-wide K-4 enrollment

YEAR	K	1	2	3	4	TOTAL
2008	427	723	616	646	636	3048
2009	449	630	655	635	669	3038
2010	489	653	594	653	635	3024
2011	510	699	627	605	661	3102
2012	505	707	641	626	617	3096
2013	515	659	667	637	641	3119
2014*	585	630	666	684	654	3219
2015	599	643	642	671	691	3246

** The total enrollment in 2014 and 2015 reflects an expansion of the kindergarten population due to the addition of a full-day kindergarten program in 2014.*

Renovation estimates

PlanCon Level Renovation – Low Case

GSF	55,596
Cost/GSF PlanCon Renov.	\$ 150
Net Cost Low Case	\$ 8,339,400
Sitework Allowance	\$ 250,000
Subtotal Renovation	\$ 8,589,400
Soft Cost with Mods.	\$ 3,006,290
Soft Cost	\$ 11,595,690

PlanCon Level Renovation – High Case

GSF	55,596
Cost/GSF PlanCon Renov.	\$ 170
Net Cost High Case	\$ 9,451,320
Sitework Allowance	\$ 250,000
Subtotal Renovation	\$ 9,701,320
Soft Cost with Mods.	\$ 3,395,462
Soft Cost	\$ 13,096,782

A major consideration in the decision of the Neshaminy School Board of Directors to construct the new Tawanka Elementary School is the age of the Lower Southampton Elementary School building and the projected cost of renovations.

Note: This estimate is limited to replacement of building systems such as HVAC, electrical, plumbing, life safety, roofing and repairs of deferred maintenance items. This estimate specifically excludes programmatic enhancements, sprinkler installation and ADA upgrades. Also, this estimate does not include inflationary costs from August, 2014 (the date it was developed) to the intended date of work.

This estimate includes phased construction and the use of temporary classrooms for an occupied renovation.