

JERUSALEM  
Sec. 20, 21, 28, 29, T 9 N, R 17 W

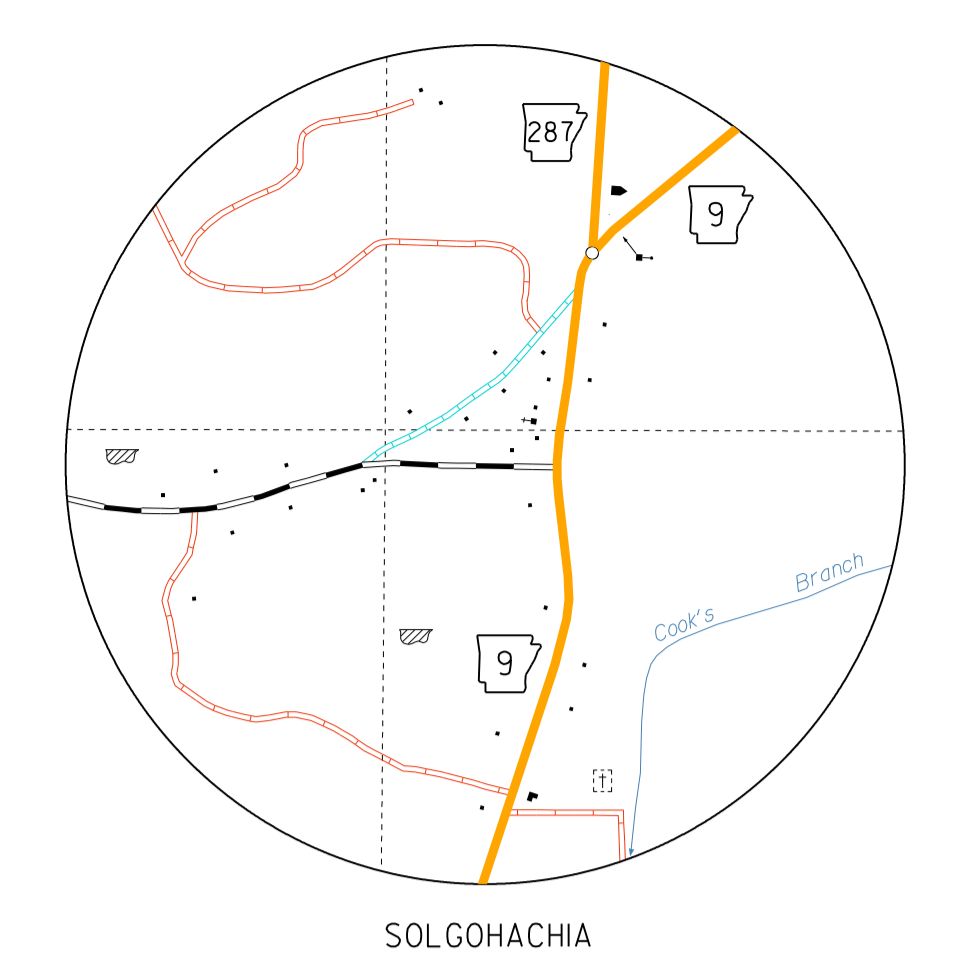

SOLDAHACHIA  
Sec. 10, 11, 14, 15, T 7 N, R 16 W

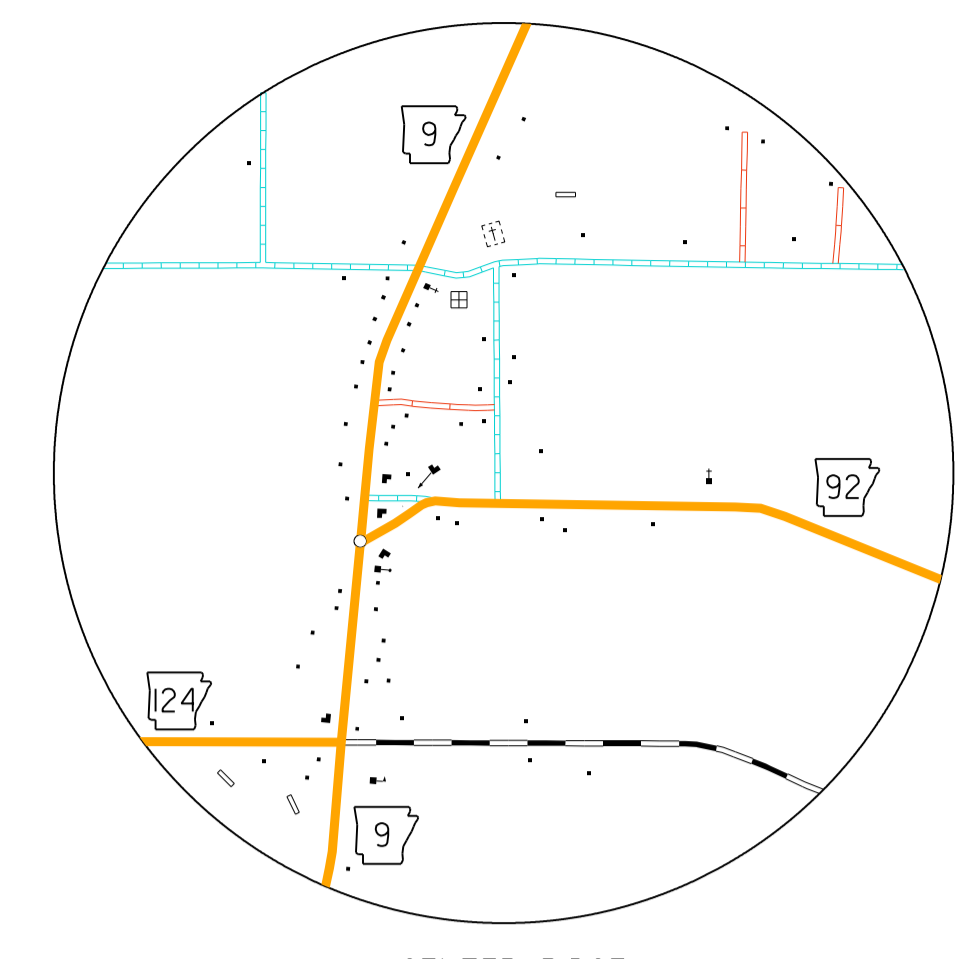

CENTER RIDGE  
Sec. 2, T 8 N, R 15 W  
Sec. 35, T 9 N, R 15 W

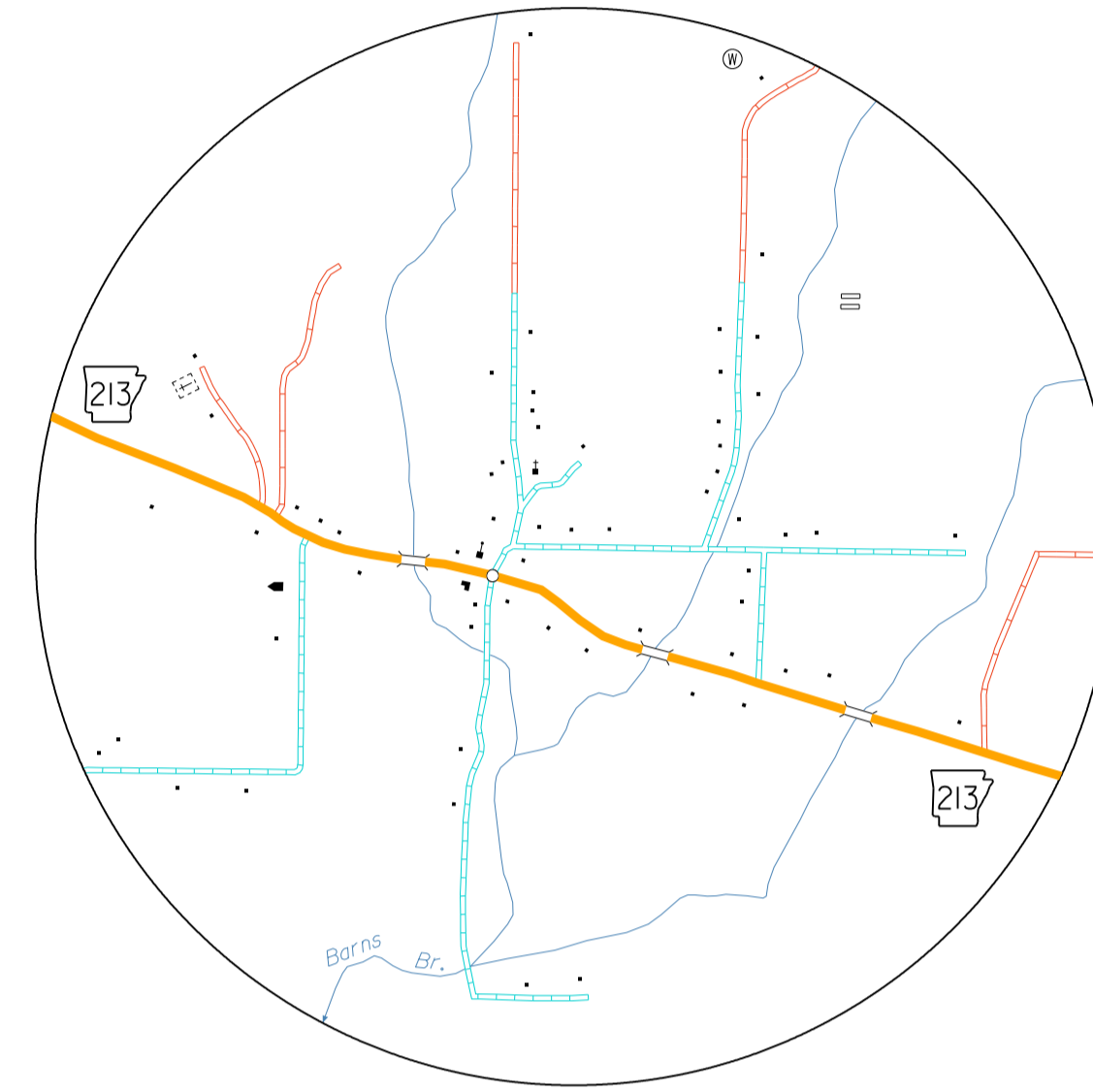

HATTEVILLE  
Sec. 2, 3, T 7 N, R 17 W  
Sec. 34, 35, T 8 N, R 17 W

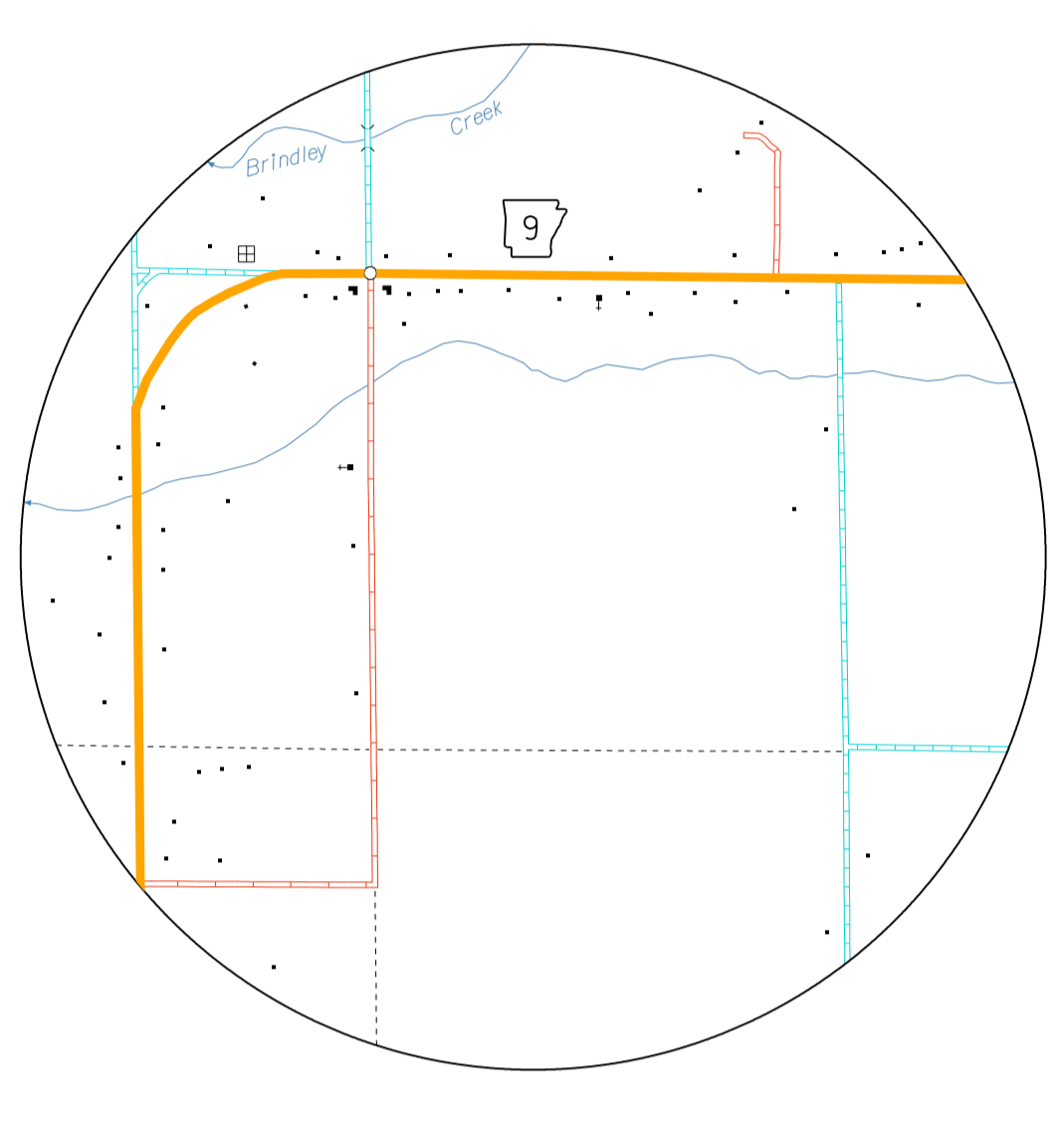

BIRDTOWN  
Sec. 28, 29, 32, 33, T 8 N, R 15 W

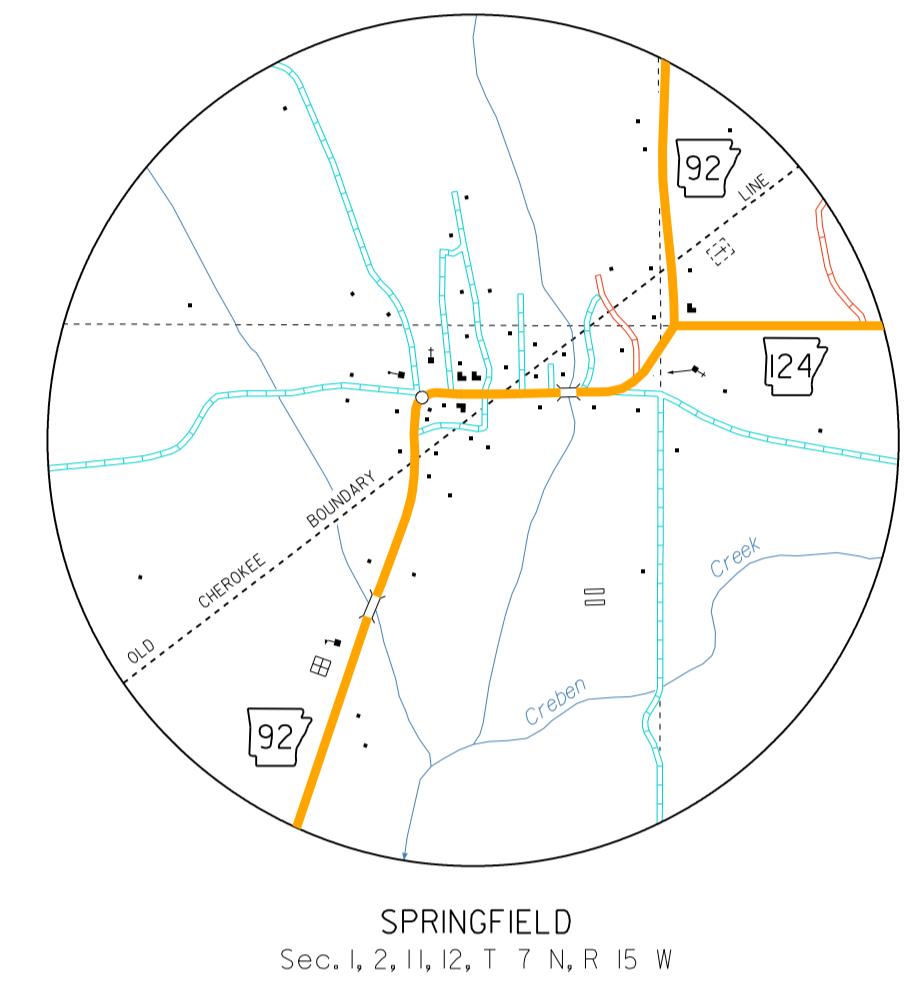

SPRINGFIELD  
Sec. 1, 2, 11, 12, T 7 N, R 15 W

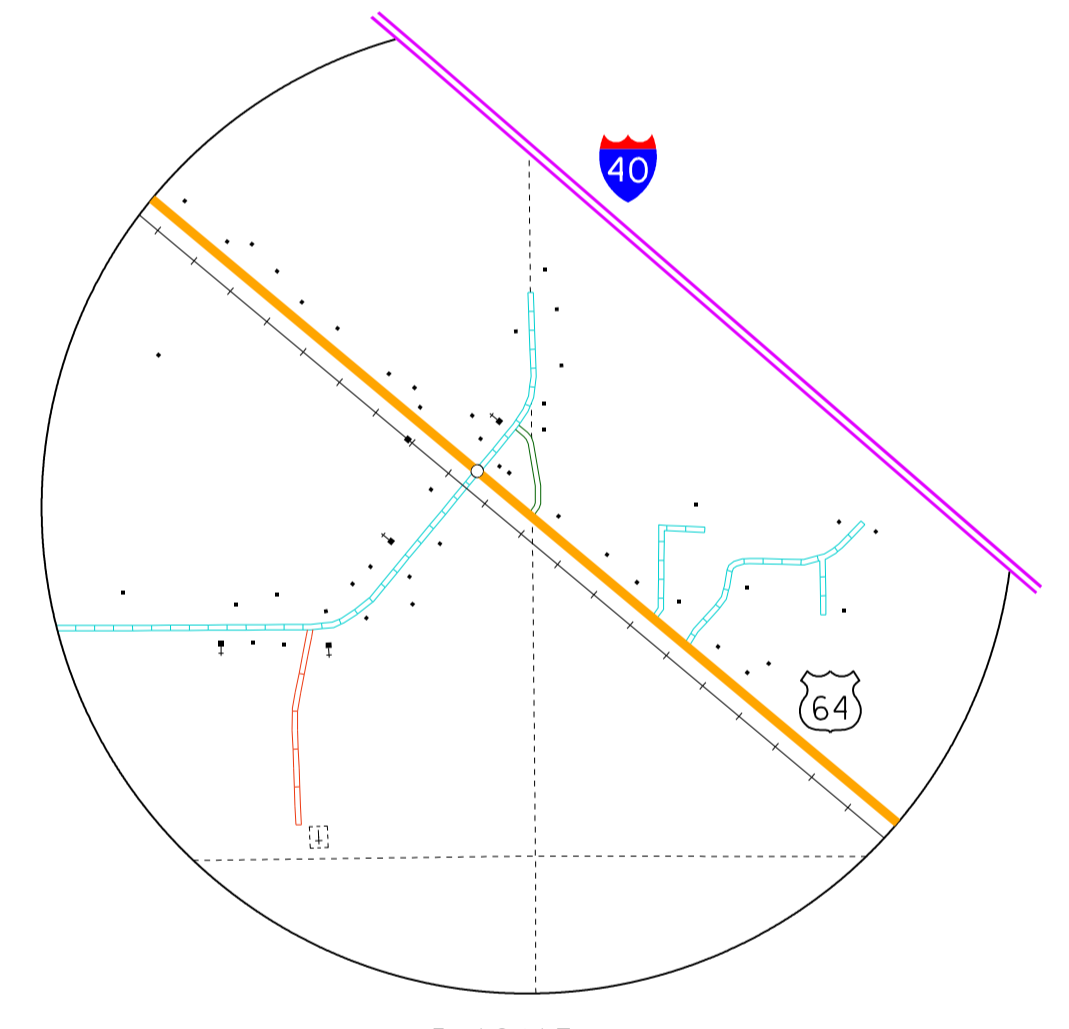

BLACKWELL  
Sec. 29, 30, 31, 32, T 7 N, R 17 W

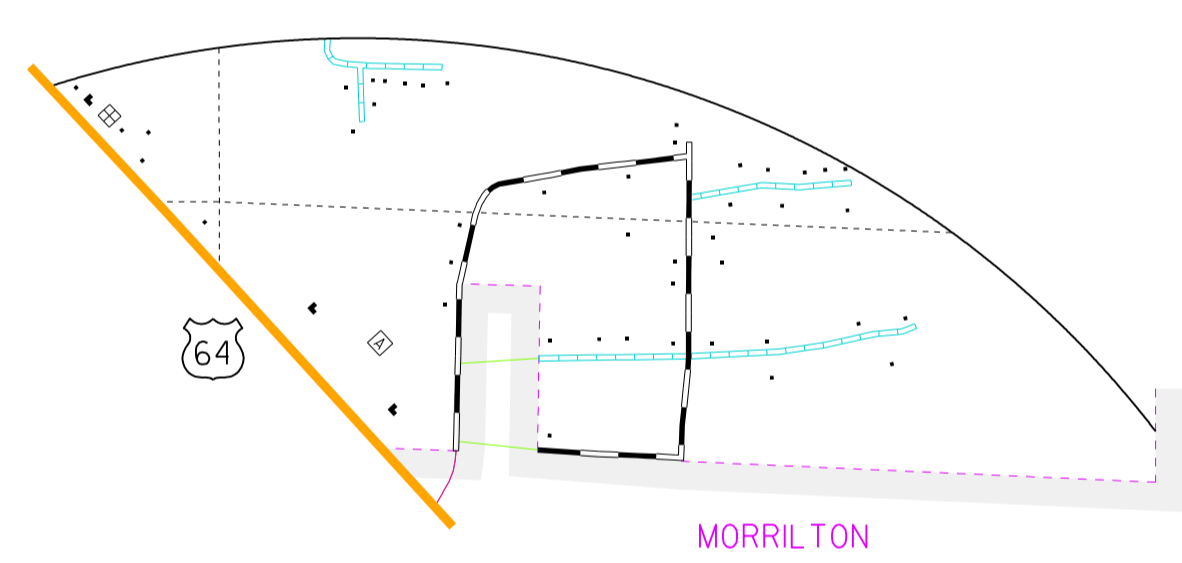

MORRILTON  
AREA WEST SIDE OF MORRILTON  
Sec. 11, 12, 13, T 6 N, R 15 W

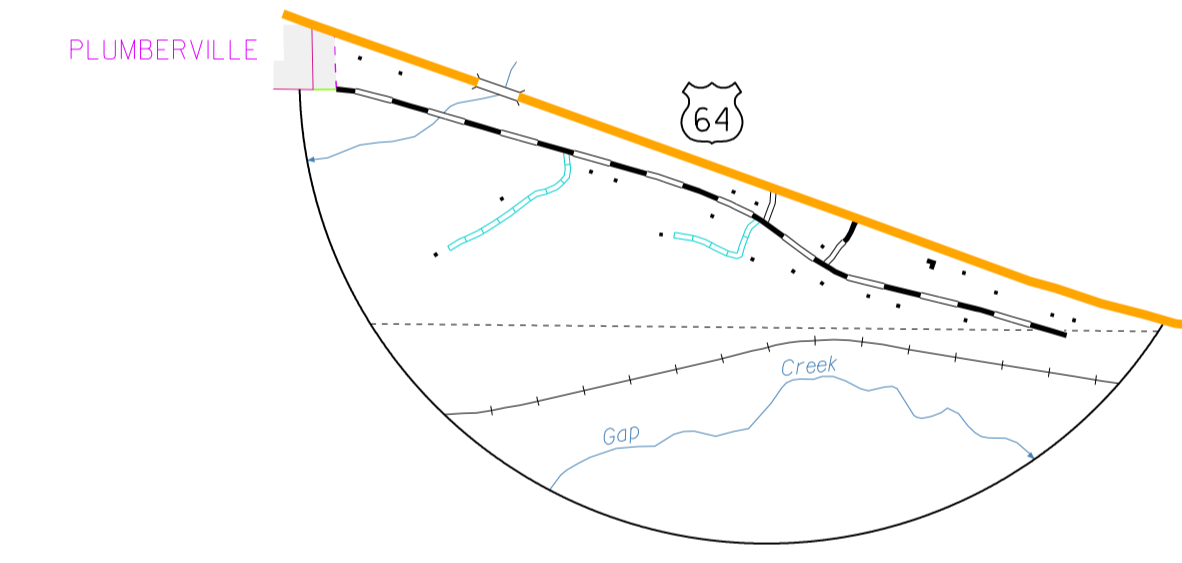

PLUMBERSVILLE  
AREA EAST OF PLUMBERSVILLE  
Sec. 17, 20, T 6 N, R 15 W

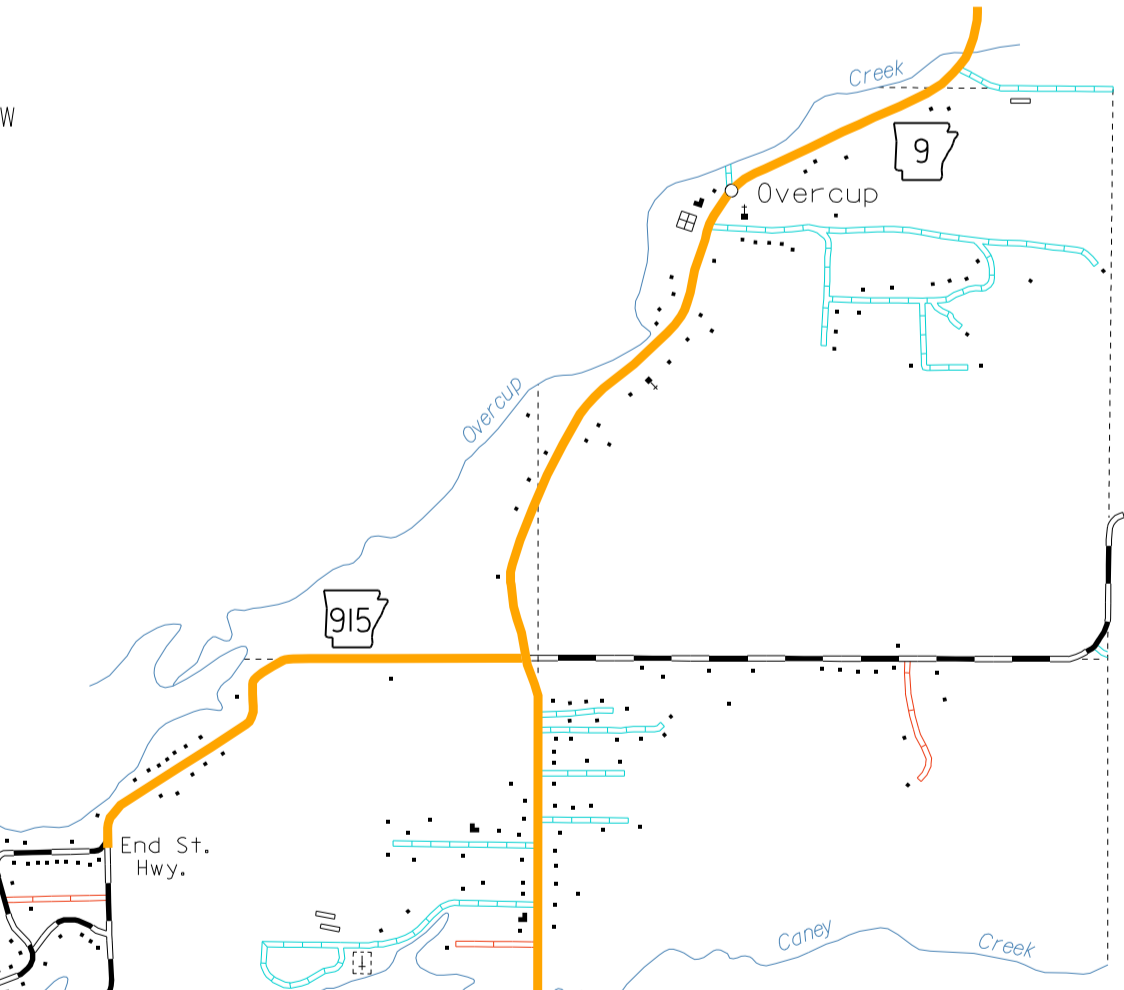

MORRILTON  
AREA NORTHEAST OF MORRILTON  
Sec. 4, 5, 8, 9, T 6 N, R 16 W  
Sec. 27, 28, 33, 34, T 7 N, R 16 W  
Scale: 3 times map scale

- LEGEND**
- COUNTY BOUNDARY
  - - - STATE OR COUNTY LINE INDETERMINATE
  - U.S. LAND TOWNSHIP LINE
  - SECTION LINE
  - NATIONAL FOREST BOUNDARY
  - PARK OR RESERVATION BOUNDARY
  - PAVED STATE OR U.S. HIGHWAY
  - INTERSTATE HIGHWAY
  - U.S. NUMBERED HIGHWAY
  - STATE HIGHWAY
  - PAVED LOCAL ROAD
  - GRAVEL LOCAL ROAD
  - GRADED & DRAINED LOCAL ROAD
  - UNIMPROVED LOCAL ROAD
  - RAILROAD (INDICATES NUMBER OF TRACKS USED BY RAILROAD) (SEE TRACKS USED BY RAILROAD STATION)
  - GRADE CROSSING
  - OVERPASS
  - UNDERPASS
  - HIGHWAY BRIDGE (SEE FEET OR MORE IN LENGTH)
  - PAVED FORD OR LOW WATER BRIDGE
  - LEVEE OR DIKE
  - MILEAGE BETWEEN POINTS
  - LAKE, RESERVOIR OR POND
  - LAKE, RESERVOIR OR POND WITH DAM
  - MARSH OR SWAMP
  - WIDE RIVER OR STREAM
  - DOCK, PIER OR LANDING
  - NAVIGABLE STREAM
  - HEAD OF NAVIGATION (SEE SEPARATE SECTION)
  - DAM WITH LOCK
  - SMALL STREAM
  - DRAINAGE DITCH
  - CORPORATE LIMITS AND ROADS THROUGH TOWN
  - COUNTY SEAT
  - OTHER CITIES AND TOWNS
  - MUNICIPAL AIRPORT
  - PRIVATE AIRFIELD
  - FARM UNIT OR DWELLING
  - GROUP OF CLOSELY SPACED DWELLINGS (IF NO HOUSE NUMBER)
  - APARTMENT COMPLEX or MOTEL
  - CHURCH OR OTHER RELIGIOUS INSTITUTION
  - SCHOOL
  - POST OFFICE + POST OFFICE AND BUSINESS
  - CEMETERY
  - CHURCH WITH CEMETERY ADJACENT
  - BUSINESS ESTABLISHMENT
  - FACTORY OR INDUSTRIAL PLANT-COTTON GIN
  - SAWMILL
  - GRAVEL PIT
  - QUARRY
  - TOWN OR COMMUNITY HALL
  - POWER PLANT
  - RADIO OR TELEVISION STATION AND CALL LETTERS
  - A.H.T.D., GARAGE OR COUNTY GARAGE
  - MUSEUM, GENERAL
  - FIRE ENGINE HOUSE
  - POWER SUBSTATION
  - GRAN ELEVATOR
  - TRAILER PARK
  - PUMPING STATION, OIL OR GAS
  - HISTORICAL MONUMENT
  - CAMP OR LODGE
  - ATHLETIC FIELD OR AMUSEMENT PARK
  - SMALL PARK (OR STATE, COUNTY, MUNICIPAL, OR NAVIGABLE)
  - WATER SUPPLY STANDPIPE OR TANK
  - SEWAGE DISPOSAL PLANT
  - GARBAGE DUMP OR SANITARY LANDFILL
  - AUTO SALVAGE YARD
  - CHICKEN HOUSE
  - PICNIC GROUND
  - SCENIC SITE OR OVERLOOK

# GENERAL HIGHWAY MAP CONWAY COUNTY ARKANSAS

PREPARED BY  
ARKANSAS DEPARTMENT OF TRANSPORTATION  
TRANSPORTATION PLANNING AND POLICY DIVISION  
IN COOPERATION WITH  
U.S. DEPARTMENT OF TRANSPORTATION  
FEDERAL HIGHWAY ADMINISTRATION  
SCALE 60/500  
MILES

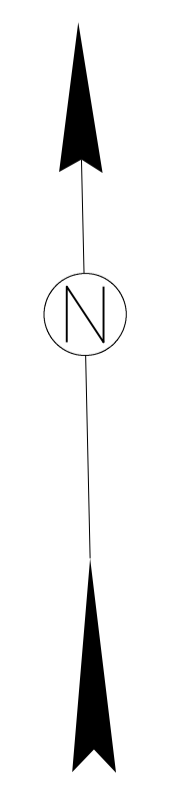
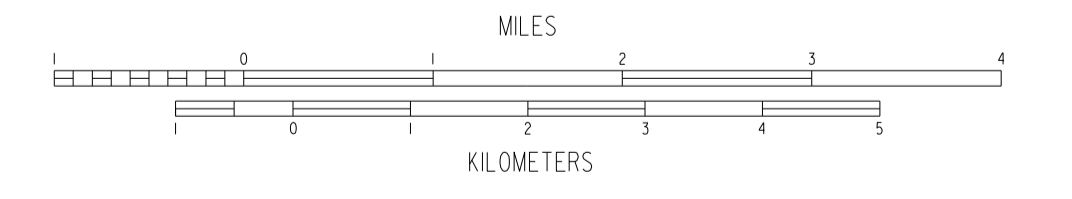

Copies of this map are available at a nominal fee from the Arkansas State Highway and Transportation Department, P.O. Box 2266 Little Rock, Ark. 72203

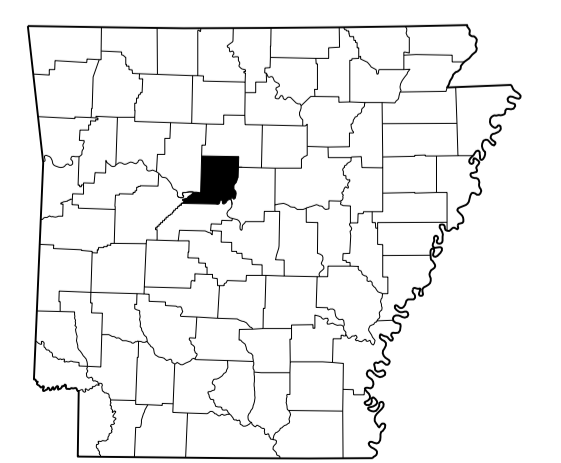

NOTE: Enlargements of all congested areas are five times map scale unless otherwise noted.  
Individual maps are available for all active incorporated cities.  
Area: 566.75 square miles  
Population: 2013: 2006 Census  
Map issued 7-19-00, replaces map issued 2-1-94  
Field Inventory 1976  
Map revisions made from aerial photographs taken 2-2-99  
Map compilation completed 1-9-00  
County map produced using Computer Assisted Cartography.  
Map Revised 9-02-2008, reconnection of S.A.115, Section 6, west of Morrilton, AR